

DATE January 13, 2007

TREY GRAYSON
SECRETARY OF STATE
COMMONWEALTH OF KENTUCKY
BY Frankie Odell

CITY OF ANCHORAGE

RESOLUTION OF THE CITY COUNCIL, SERIES 8, 2008

A RESOLUTION ADOPTING A MODERN AND ACCURATE LEGAL DESCRIPTION OF TERRITORY PREVIOUSLY ANNEXED BY ORDINANCE

WHEREAS, the City of Anchorage, Kentucky, has enacted numerous ordinances annexing property into the corporate limits of the City of Anchorage; and

WHEREAS, each individual annexation contains a prior survey oft prepared by now unknown individual, and further references documentation that is no longer in existence; and

WHEREAS, the City wishes to provide a modern, accurate, easily identifiable legal description reflecting bearings and coordinates based upon the state plane coordinate system, including relevant GPS and GIS data, same having been certified by a professional land surveyor for a prior annexation; and

WHEREAS, the City wishes to comply with the requirements of Amended KRS 81A.470 effective June 26, 2007; and

WHEREAS, The City does not intend to amend or replace its prior ordinance annexing, but rather to interpret the defined boundaries of the territory previously annexed and adopt a modern and accurate legal description of territory previously annexed;

NOW, THEREFORE, BE IT RESOLVED BY THE CITY COUNCIL OF THE CITY OF ANCHORAGE, KENTUCKY:

SECTION 1, That the City Council of the City of Anchorage hereby adopts the following legal description, and a plat attached hereto as prepared by George Brian Wyatt, Licensed Professional Land Surveyor No. 2328 by new survey as an accurate depiction of the property previously annexed into the corporate city limits of the City of Anchorage, by Ordinance 9, dated October 9, 1985, copy of which is attached hereto as Exhibit #2, and hereby adopts said new legal description and plat as the official legal description and plat to be adopted by the City for all purposes when referencing this prior annexation.

SECTION 2, The legal description and plat as prepared by George Brian Wyatt, a Licensed and Professional Land Surveyor No. 2328 follows, and becomes part of this resolution.

This resolution was passed by a vote of 5 yes and 0 no this 8th day of December, 2008.

W. Thomas Hewitt

W. Thomas Hewitt
Mayor
City of Anchorage

ATTEST:

Nan Schlindwein

Nan Schlindwein
City Clerk
City of Anchorage

CERTIFICATION

I, Nan Schlindwein, Clerk of the City of Anchorage, Kentucky, do hereby certify that the above Resolution, Series 8, 2008, is a true and correct copy as was presented to the City Council of the City of Anchorage at their regularly scheduled meeting dated December 8, 2008.

Given under my hand this 30th day of December, 2008.

Nan Schlindwein

Nan Schlindwein
City Clerk
City of Anchorage

(seal)

Surveyor's Description
City of Anchorage, Kentucky
Ordinance No. 9
Series 1985

Beginning at a point in the north right-of-way line of Ward Avenue and the west right-of-way line of Old Harrods Creek Road and being the southeasternmost corner of a tract of land conveyed to NTS/Owl Creek Investments Partnership, Ltd. aforementioned; thence with the north right-of-way line of Ward Avenue South 68° 06' 23" West, 280.00 feet to a point, thence leaving the north right-of-way line of Ward Avenue along a new division line North 22° 11' 54" West, 652.70 feet to a point in the south line of the Rt. Rev. Kelly aforementioned; thence with the south line of the Rt. Rev. Kelly South 73° 54' 26" West, 467.05 feet to a point; thence North 25° 07' 55" West, 1011.73 feet to a point in the northwesternmost corner of the Rt. Rev. Kelly; thence leaving the northwest corner of the Rt. Rev. Kelly and along a new division line the following courses:

- North 21° 30' 00" West, 602.00 feet to a point;
- North 40° 17' 02" West, 118.33 feet to a point;
- North 54° 40' 57" West, 360.00 feet to a point;
- North 42° 30' 00" West, 55.00 feet to a point;
- North 20° 30' 53" West, 50.00 feet to a point;
- North 05° 32' 36" East, 60.00 feet to a point;
- North 11° 16' 32" East, 205.00 feet to a point;
- North 07° 48' 04" East, 280.33 feet to a point;
- North 37° 16' 09" West, 410.91 feet to a point;
- North 32° 40' 42" West, 97.00 feet to a point;
- North 11° 59' 29" West, 114.00 feet to a point;
- North 07° 30' 00" East, 110.00 feet to a point;

North 22° 34' 55" East, 237.14 feet to a point in the southwest corner of a tract of land conveyed to Elayne Roose as recorded in Deed Book 5167, Page 402 in the aforementioned clerk's office, thence with the south line of Roose South 75° 04' 44" East, 906.66 feet to a point in the west right-of-way line of Old Harrods Creek Road; thence with the west right-of-way line of Old Harrods Creek Road the following courses:

- South 18° 18' 41" East, 500.72 feet to a point;
- South 16° 30' 42" East, 180.71 feet to a point;
- South 18° 22' 07" East, 164.93 feet to a point;
- South 21° 00' 36" East, 250.50 feet to a point;
- South 22° 19' 48" East, 886.04 feet to a point;
- South 26° 49' 06" East, 185.06 feet to a point;
- South 21° 41' 23" East, 591.73 feet to a point;
- South 11° 18' 17" East, 75.67 feet to a point;
- South 15° 54' 09" East, 129.19 feet to a point;
- South 22° 11' 54" East, 662.58 feet to the point of beginning containing 68.88 acres

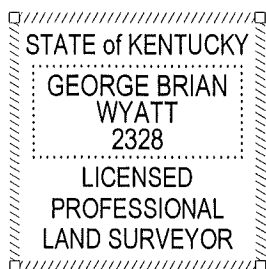

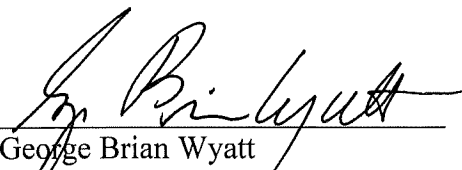
George Brian Wyatt
Professional Land Surveyor #2328

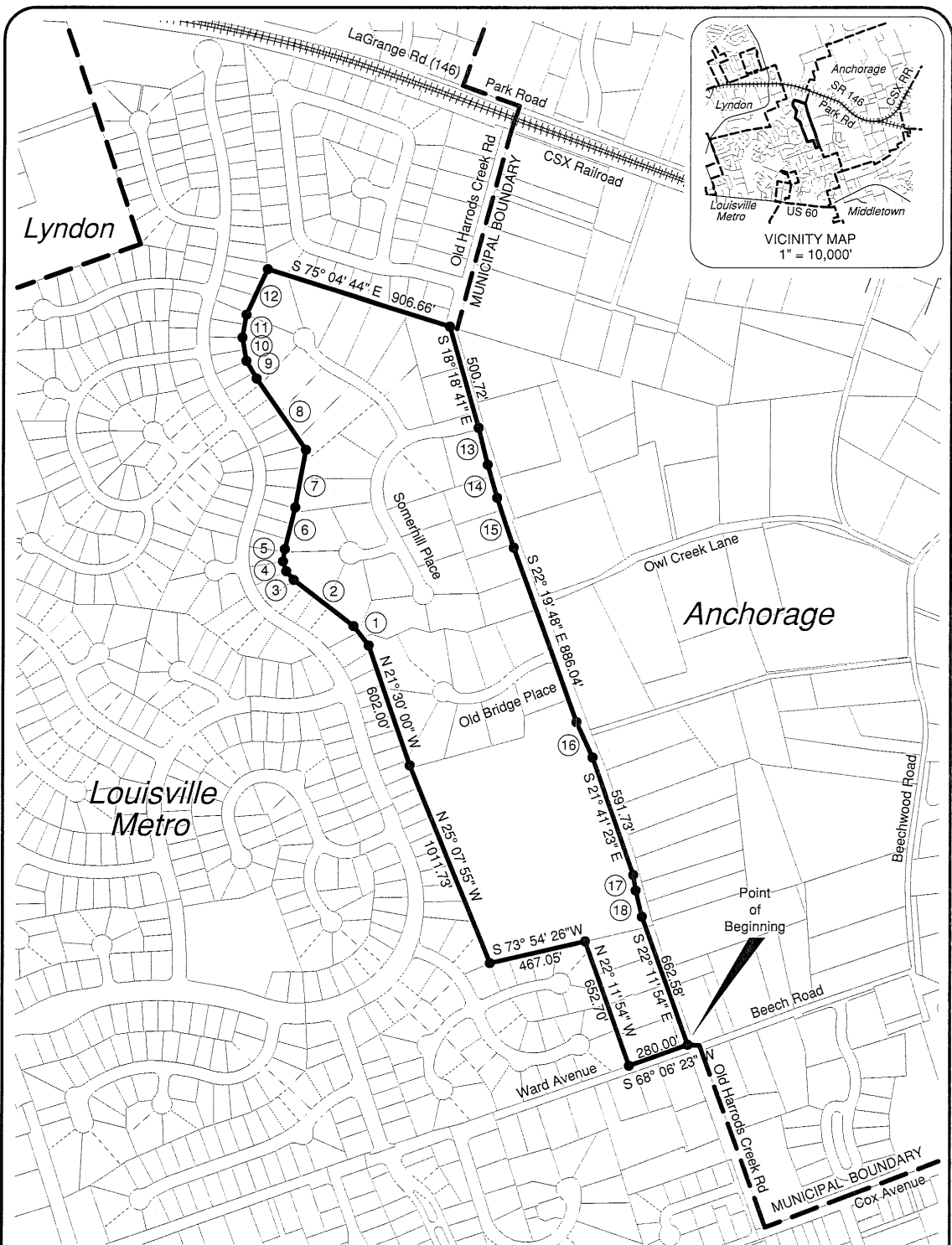

Line Table

1	North 40° 17' 02" West	118.33	10	North 11° 59' 29" West	114.00
2	North 54° 40' 57" West	360.00	11	North 07° 30' 00" East	110.00
3	North 42° 30' 00" West	55.00	12	North 22° 34' 55" East	237.14
4	North 20° 30' 53" West	50.00	13	South 16° 30' 42" East	180.71
5	North 05° 32' 36" East	60.00	14	South 18° 22' 07" East	164.93
6	North 11° 16' 32" East	205.00	15	South 21° 00' 36" East	250.50
7	North 07° 48' 04" East	280.33	16	South 26° 49' 06" East	185.06
8	North 37° 16' 09" East	410.91	17	South 11° 18' 17" East	75.67
9	North 32° 40' 42" West	97.00	18	South 15° 54' 09" East	129.19

Land Surveyors Certification

I hereby certify that this annexation plat was made under my supervision, and that the angular and linear measurements shown hereon, from the boundary description for Ordinance No. 9, Series 1985, are true and correct to the best of my knowledge and belief.

George Brian Wyatt 11/11/008
 George Brian Wyatt RLS# 2328 Date

STATE OF KENTUCKY
 GEORGE BRIAN WYATT
 2328
 LICENSED PROFESSIONAL LAND SURVEYOR

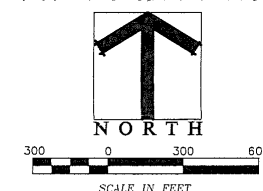

Annexation Plat
 of Ordinance No. 9, Series 1985
 City of Anchorage, Jefferson County, Kentucky

PREPARED BY:
Stantec
 1901 Nelson Miller Parkway
 Louisville, Kentucky 40223
 (502) 212-5000 (502) 212-5055 fax
 November 2008 Scale: 1"=600'