

CITY OF BEREA

DEPARTMENT OF CODES AND PLANNING

STEVEN CONNELLY  
MAYOR

212 CHESTNUT STREET • BEREA, KENTUCKY 40403  
(859) 986-8528 • FAX (859) 986-7657  
T.D.D.# 1-800-648-6057

PAUL SCHRADER, PLS  
GIS COORDINATOR-  
LAND SURVEYOR

April 21, 2004

Secretary of State  
700 Capital Avenue, Suite 152  
Frankfort, KY 40601  
Attn: Ms. Kandie Adkinson

Dear Ms. Adkinson,

Please find enclosed a certified copy of Ordinance No. 13-03, enacted August 05, 2003, annexing real property into the corporate limits of the City of Berea.

Enclosed with this ordinance is a copy of a plat of survey performed and certified by John Horne, PLS #1218 and entitled Walter & Mary Casey Property. This plat depicts the same parcel of land described by metes and bounds in exhibit "A" of the enclosed ordinance. I've also enclosed a copy of an exhibit we used for our newspaper ad to help show the position of this annexation relative to the overall existing city limits.

Please feel free to contact me if you should have any questions or concerns.

Sincerely,

Paul S. Schrader, PLS  
City Surveyor

cc: Mr. Billy Gabbard, Madison County Court Clerk  
cc: Mr. Steve Smith, Madison County PVA  
cc: Mr. Dan Yeast, KY Dept. for Local Government  
cc: Mr. Shane New, BGADD

RECEIVED AND FILED  
DATE April 23, 2004  
TREY GRAYSON  
SECRETARY OF STATE  
COMMONWEALTH OF KENTUCKY  
BY Kandie Adkinson

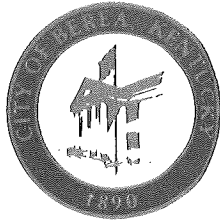

CITY OF BERA

CITY ADMINISTRATORS OFFICE

STEVEN CONNELLY  
MAYOR

212 CHESTNUT STREET • BERA, KENTUCKY 40403  
(859) 986-8528 • FAX (859) 986-7657  
T.D.D.# 1-800-648-6057

RANDY STONE  
CITY ADMINISTRATOR

**PROOF OF MUNICIPAL LEGISLATION**

**I, Randy Stone, City Clerk of the City of Berea, Kentucky, hereby certify that the attached is a true and accurate copy of Ordinance #13-03 adopted by the Berea City Council on August 5, 2003, and I am the custodian of the original, which is maintained at the City Clerk's Office, Berea City Hall, Berea, Kentucky.**

4/21/04  
Date

Randy Stone  
Randy Stone, City Clerk

RECEIVED AND FILED  
DATE April 23, 2004

TREY GRAYSON  
SECRETARY OF STATE  
COMMONWEALTH OF KENTUCKY  
BY Randy Adkins

ORDINANCE NO. 13 - 03

AN ORDINANCE OF THE CITY OF BEREAS, KENTUCKY, ANNEXING CERTAIN REAL PROPERTY LOCATED NEAR BEREAS, MADISON COUNTY KENTUCKY.

**WHEREAS**, interest has been evidenced in annexing a tract of land located near Berea, Madison County, Kentucky; and

**WHEREAS**, the City Council has determined that the corporate boundaries of the City should be extended to include this area; and

**WHEREAS**, the City wishes to be able to be in the position to extend certain municipal services to this area; and

**WHEREAS**, the tract described herein is not already incorporated; and

**WHEREAS**, the owners of the property agree to the annexation;

**NOW, THEREFORE**, the City of Berea, Kentucky, does ordain as follows:

**SECTION I**

That the City of Berea, Kentucky, pursuant to KRS 81A.420 and KRS 81A.412, hereby annexes and makes a part of the corporate area the certain tract of property described as follows:

SEE ATTACHED EXHIBIT A

**SECTION II**

Upon the enactment of this ordinance, the territory described in Exhibit A is part of the City of Berea for all purposes.

**SECTION III**

Pursuant to Section 81.402(6) of the Berea City Code, the Planning Commission shall hold a public hearing on the zoning classification to be assigned to the property annexed herein, and until the City Council acts on the Planning Commission's recommendation, the property annexed shall

be classified R-1.

**SECTION IV**

The City Clerk or any other officer having custody of official maps or records of the City is hereby directed to amend such maps or records to reflect the annexation provided for herein.

**SECTION V**

All ordinance or parts of ordinances in conflict with this ordinance are hereby repealed.

FIRST READING: July 15, 2003.

SECOND READING & ENACTMENT August 5, 2003.

CITY OF BEREA, KENTUCKY

ATTEST:

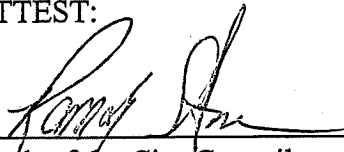
  
\_\_\_\_\_  
Clerk of the City Council

APPROVED:

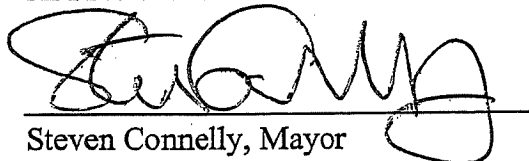
  
\_\_\_\_\_  
Steven Connelly, Mayor

PREPARED BY:

COY, GILBERT & GILBERT  
212 North Second Street  
Richmond, Kentucky 40475  
(859) 623-3877

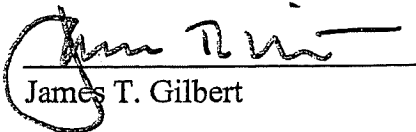
  
\_\_\_\_\_  
James T. Gilbert

RECEIVED  
MARY JANE GINTER

DEC 11 12 31 PM '94

A parcel of land west of and adjacent to Berea-Kingsston Pike (Old US-25) approximately 1.2 miles northeast of Berea, Madison County, Kentucky, said parcel being designated as Tract I of the Walter and Mary Casey property, as shown on plat prepared by John G. Horne & Associates, Inc., Registered Land Surveyor 1218, dated August 8, 1983, and recorded in Madison County Clerk's office in Plat Book 7 at page 54, and more particularly described as follows, to-wit:

Beginning at a set iron pin in the original line of Casey now being the line of Casey-Baker; thence a new division line of Casey for eleven (11) calls: S01° 59'00" E, 222.82 feet to an iron pin; S89°12'15"E, 155.17 feet to an iron pin, S39°17'42"E, 149.60 feet to an iron pin, S49°13'00"E, 99.77 feet to an iron pin, S63°39'02"E, 99.76 feet to an iron pin, S75°00'10"E, 99.98 feet to an iron pin, S85°27'30"E, 150.00 feet to an iron pin, N86°57'43"E, 100.06 feet to an iron pin, N76°58'07"E, 60.31 feet to an iron pin, N70°32'59"E, 140.63 feet to an iron pin, N70°48'42"E, 38.10 feet to a mine spike, said mine spike being in the center of KY-1016, Berea-Kingston Pike (Old US-25) an original boundary of Casey; thence with center of KY-1016, N07°17'17"E, 305.79 feet to a mine spike in center of roadway, being an original corner of Casey and Maupin (formerly Baker); thence with original line of Casey and Maupin (formerly Baker) for four (4) calls: N83°44'18"W, 44.27 feet to an existing iron pin, N84°34'00"W, 354.97 feet to an existing iron pin, N83°54'51"W, 119.84 feet to an existing iron pin, N83°50'34"W, 99.45 feet to an existing iron pin, said iron pin being a common corner to Maupin and Baker in boundary line of Casey; thence continuing with original line of Casey and Baker for two (2) calls: N83°53'59"W, 269.85 feet to a set iron pin, N84°04'04"W, 151.80 feet

to a set iron pin, said iron pin being the point of beginning, containing 8.04 acres, based on a survey by John G. Horne & Associates, Inc., dated August, 1983.

And being the same property conveyed to the Grantors by deed dated August 11, 1983, from Walter Casey and his wife, Mary Casey, and recorded in the Madison County Clerk's office, in Deed Book 353, at page 565.

STATE TAX \$ 180.00  
PAID 12-19-94  
MARY JANE GINTER, CLERK  
BY *[Signature]* M.J.G.C.

EXHIBIT A

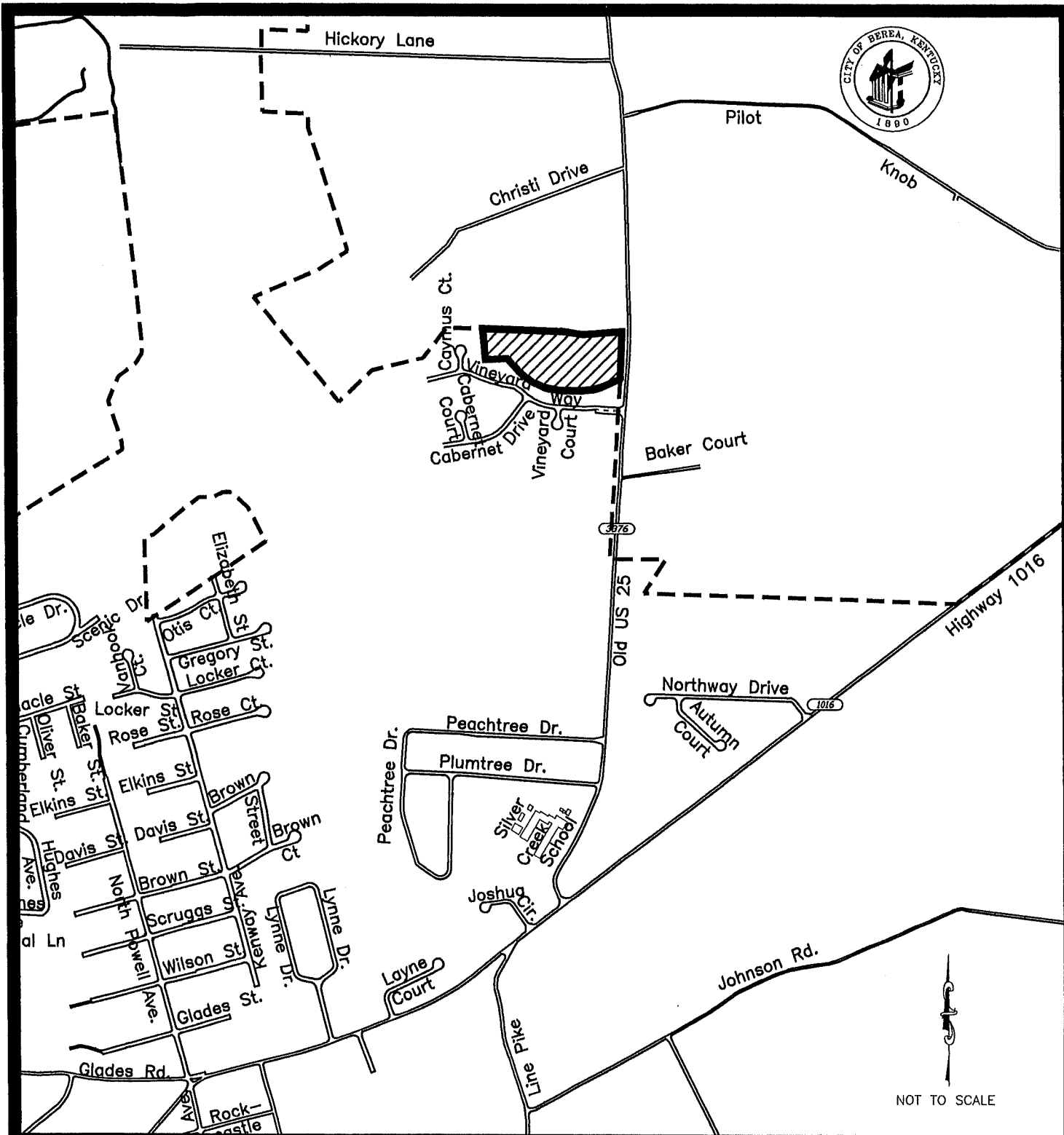

# CITY OF BEREA PROPOSED ANNEXATION

OVERSIZE MAP INCLUDED WITH  
SUBMISSION.

To research the map, contact the  
Office of Secretary of State  
or the County Clerk.