

RECEIVED AND FILED

DATE May 13, 2019

ALISON LUNDERGAN GRIMES  
SECRETARY OF STATE  
COMMONWEALTH OF KENTUCKY  
BY Heather Johnson

ORDINANCE NO. **BG2019 - 14**

ORDINANCE ANNEXING RIGHT-OF-WAY BY CONSENT

ORDINANCE ANNEXING 12.28 ACRES OF  
RIGHT-OF-WAY LOCATED ON THE I-65 TO U.S.  
31-W CONNECTOR ROAD FROM MIZPAH  
ROAD TO U.S. 31-W, PRESENTLY OWNED BY  
THE COMMONWEALTH OF KENTUCKY  
TRANSPORTATION CABINET WITH SAID  
TERRITORY BEING CONTIGUOUS TO  
EXISTING CITY LIMITS

WHEREAS, pursuant to KRS 81A.412, the City of Bowling Green may annex any area which meets the requirements for annexation if the owner of record of the land to be annexed gives prior consent in writing; and,

WHEREAS, the Commonwealth of Kentucky Transportation Cabinet has requested and consented in writing to the annexation of 12.28 acres of right-of-way located on the I-65 to U.S. 31-W Connector Road from Mizpah Road to U.S. 31-W (Louisville Road); and,

WHEREAS, the City of Bowling Green hereby declares it desirable to annex the right-of-way as described in the attachments to this Ordinance; and,

WHEREAS, the proposed right-of-way to be annexed is adjacent or contiguous to the City; and,

NOW, THEREFORE, BE IT ORDAINED by the City of Bowling Green, Kentucky pursuant to KRS 81A.412 as follows:

1. The right-of-way presently owned by the Commonwealth of Kentucky Transportation Cabinet located on the I-65 to U.S. 31-W Connector Road from Mizpah Road to U.S. 31-W, containing 12.28 acres of right-of-way, which right-of-way is identified on the attached map and further described in the attachments to this Ordinance, all of which is contiguous to existing city limits, shall be and is hereby annexed into the City of Bowling Green, Kentucky by consent of the owner, and the boundaries of the City are hereby extended so as to include and incorporate all of this right-of-way into the City of Bowling Green.

***BG2019-14***

(Ordinance No. BG2019 – 14)

2. A copy of this Ordinance shall be forwarded to the Public Works Department, Planning and Design Division and it is hereby authorized and directed to make the necessary changes to the territorial limits of the City in Chapter One of the City of Bowling Green Code of Ordinances to reflect this annexation.

3. The provisions of this Ordinance are hereby declared to be severable, and if any section, phrase or provision shall for any reason be declared invalid, such declaration of invalidity shall not affect the validity of the remainder of this Ordinance.

4. All prior Municipal Orders or Ordinances or parts of any Municipal Order or Ordinance in conflict herewith are hereby repealed.

5. This Ordinance is adopted pursuant to KRS 83A.060 in that it was introduced on April 16, 2019, and given final reading on May 7, 2019, and said Ordinance shall be in full force and effect upon signature, recordation and publication in summary pursuant to KRS Chapter 424.

ADOPTED: May 7, 2019

APPROVED: Brian Wickerson  
Mayor, Chairman of Board of Commissioners

ATTEST: Ashley Jackson  
City Clerk

SPONSORED BY: Jeffery B. Meisel, City Manager, 04/09/2019, 9:30 a.m.

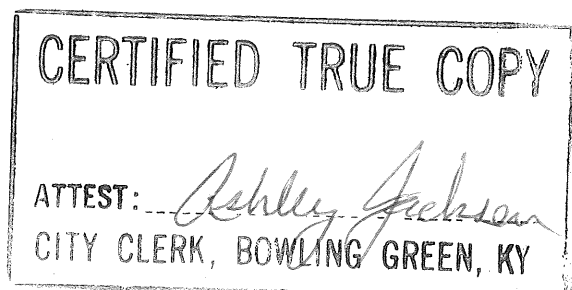

## LEGAL DESCRIPTION

### ANNEXATION US 31-W CONNECTOR (MIZPAH ROAD)

Being the right-of-way of the US 31-W Connector from Mizpah Road to US 31-W (Louisville Road) and being more particularly described as follows:

The following description was prepared by Robert S. Evans PLS # 3320 BG Public Works – Field Engineering. Sources of record KYTC Project HPP 0164 (007) fd52 144-0065 030-031. This annex description is oriented to State Plane Coordinates Kentucky South 1602. This description is counter-clockwise to match existing city limits. This is not a boundary survey and is for annex purposes only.

Beginning at a point in the existing city limits said point being in the west right-of-way of the US 31-W Connector and common with Clyde Spinks Jr. Deed Book 470 Page 339; thence crossing said right-of-way North 76 degrees 32 minutes 50 seconds East, 350.00 feet to a point in the east right-of-way and common with Clyde Spinks Jr. Deed Book 470 Page 339; thence with said right-of-way North 18 degrees 54 minutes 24 seconds West, 1033.79 feet to a point; thence North 29 degrees 44 minutes 17 seconds West, 559.91 feet to a point in the south right-of-way of US 31-W Louisville Road; thence with said right-of-way South 57 degrees 07 minutes 22 seconds West, 296.06 feet to a point in the west right-of-way of the US 31-W Connector; thence with said right-of-way South 22 degrees 10 minutes 37 seconds East, 517.49 feet to a point; thence South 19 degrees 04 minutes 11 seconds East, 480.70 feet to a point; thence South 20 degrees 28 minutes 41 seconds East, 481.82 feet to the point of beginning containing 12.28 acres.

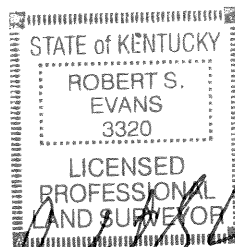

# **SURVEYOR**

ROBERT S. EVANS PLS # 3320  
1011 COLLEGE STREET  
BOWLING GREEN, KENTUCKY 42101  
PHONE # (270) 393-3229  
e-mail - rob.evans@bgky.org

# **CLIENT**

CITY OF BOWLING GREEN  
1001 COLLEGE STREET  
BOWLING GREEN, KENTUCKY 42101  
PHONE # (270) 393-3000

SCALE 1" = 300'

300' 150' 0' 300' 600'

# **NOTES**

- 1) TOTAL ANNEXED AREA = 12.28 ACRES
- 2) TOTAL PROPERTY ANNEXED = 0.00 ACRES
- 3) RIGHT-OF-WAY ANNEXED = 12.28 ACRES
- 4) SOURCE OF TITLE = KY HIGHWAY PROJECT HPP 0164 (007) FD52 114-0065 030-031
- 5) DESCRIPTION IS ORIENTED STATE PLANE COORDINATES KY SOUTH 1602

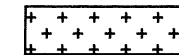

EXISTING CITY LIMITS



PROPOSED ANNEXATION

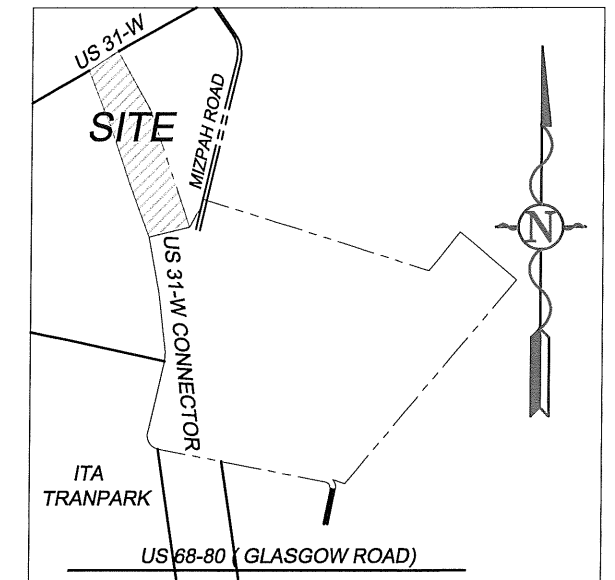

THIS DRAWING WAS PREPARED USING DEEDS AND PLATS OF RECORD IN THE WARREN COUNTY COURT CLERKS OFFICE AND FROM TAX MAPS AND RECORDS IN THE WARREN COUNTY PROPERTY VALUATION ADMINISTRATORS OFFICE. THIS IS NOT OR INTENDED TO BE A BOUNDARY SURVEY AND SHOULD NOT BE USED AS SUCH. THIS DRAWING IS FOR ANNEXATION PURPOSES ONLY.

ROBERT S. EVANS PLS# 3320 DATE 4/11/19

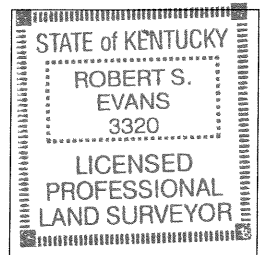

NOT VALID UNLESS STAMPED IN RED

PROJECT NUMBER  
HPP 0164 (0070)  
FD52 114 0065 030-031  
12.28 ACRES

CLYDE H. SPINKS JR.  
DB 470 PG 339

G.D. & NANCY GRIMES  
DB 1037 PG 552

INTER-MODAL TRANSPORTATION  
AUTHORITY, INC.  
DB 905 PG 866

PROPOSED ANNEX  
12.28 ACRES

CLYDE H. SPINKS JR.  
DB 470 PG 339

S 72°39'46" E - 50.50'

EXISTING CITY LIMITS

GARY & VICKIE COUNTS  
DB 732 PG 790

WENDELL & JANIS STRO  
DB 729 PG 691

POINT OF BEGINNING

EXISTING CITY LIMITS

OF OLD MIZPAH ROAD  
ABANDONED & REMOVED

LOT 1  
INTER-MODAL TRANSPORTATION  
AUTHORITY, INC.  
159,073 +/- SQ. FT.  
3.65 +/- ACRES  
DB 900 PG 361, MINOR PB 18 PG 117

PREVIOUS ANNEXED  
BG 2018-20



CITY OF BOWLING GREEN

PUBLIC WORKS DEPARTMENT

R/W ANNEXATION  
US 31-W CONNECTOR (MIZPAH)

SHEET 1 OF 1

JOB NO. 19032 SCALE 1" = 300' DATE 04/08/2019