

RECEIVED AND FILED
DATE May 28, 2019

ALISON LUNDERGAN GRIMES
SECRETARY OF STATE
COMMONWEALTH OF KENTUCKY
BY Gandrie Adkins

ORDINANCE NO. **BG2019 - 21**

ORDINANCE ANNEXING RIGHT-OF-WAY BY CONSENT

ORDINANCE ANNEXING 3.436 ACRES OF
RIGHT-OF-WAY LOCATED ON LOVERS LANE
BETWEEN OLD LOVERS LANE AND
STEEPLECHASE WAY, PRESENTLY OWNED
BY THE COMMONWEALTH OF KENTUCKY
TRANSPORTATION CABINET WITH SAID
TERRITORY BEING CONTIGUOUS TO
EXISTING CITY LIMITS

WHEREAS, pursuant to KRS 81A.412, the City of Bowling Green may annex any area which meets the requirements for annexation if the owner of record of the land to be annexed gives prior consent in writing; and,

WHEREAS, the Commonwealth of Kentucky Transportation Cabinet has requested and consented in writing to the annexation of 3.436 acres of right-of-way located on Lovers Lane (KY-880) from approximately 273 feet south of Old Lovers Lane to approximately 62 feet north of Steeplechase Way; and,

WHEREAS, the City of Bowling Green hereby declares it desirable to annex the right-of-way as described in the attachments to this Ordinance; and,

WHEREAS, the proposed right-of-way to be annexed is adjacent or contiguous to the City; and,

NOW, THEREFORE, BE IT ORDAINED by the City of Bowling Green, Kentucky pursuant to KRS 81A.412 as follows:

1. The right-of-way presently owned by the Commonwealth of Kentucky Transportation Cabinet located on Lovers Lane between Old Lovers Lane and Steeplechase Way, containing 3.436 acres of right-of-way, which right-of-way is identified on the attached map and further described in the attachments to this Ordinance, all of which is contiguous to existing city limits, shall be and is hereby annexed into the City of Bowling Green, Kentucky by consent of the owner, and the boundaries of the City are hereby extended so as to include and incorporate all of this right-of-way into the City of Bowling

BG2019-21

(Ordinance No. BG2019 - 21)

Green.

2. A copy of this Ordinance shall be forwarded to the Public Works Department, Planning and Design Division and it is hereby authorized and directed to make the necessary changes to the territorial limits of the City in Chapter One of the City of Bowling Green Code of Ordinances to reflect this annexation.

3. The provisions of this Ordinance are hereby declared to be severable, and if any section, phrase or provision shall for any reason be declared invalid, such declaration of invalidity shall not affect the validity of the remainder of this Ordinance.

4. All prior Municipal Orders or Ordinances or parts of any Municipal Order or Ordinance in conflict herewith are hereby repealed.

5. This Ordinance is adopted pursuant to KRS 83A.060 in that it was introduced on May 7, 2019, and given final reading on May 21, 2019, and said Ordinance shall be in full force and effect upon signature, recordation and publication in summary pursuant to KRS Chapter 424.

ADOPTED: May 21, 2019

APPROVED: Bruce Wickham
Mayor, Chairman of Board of Commissioners

ATTEST: Ashley Jackson
City Clerk

SPONSORED BY: Jeffery B. Meisel, City Manager, 04/29/2019, 10:00 a.m.

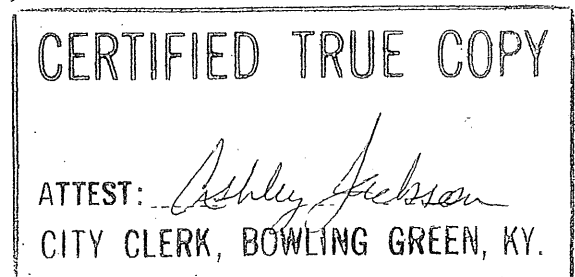

LEGAL DESCRIPTION

ANNEXATION KY 880 LOVERS LANE

Being the right-of-way of KY 880 Lovers Lane and being more particularly described as follows:

The following description was prepared by Robert S. Evans PLS # 3320 BG Public Works – Field Engineering. Sources of record; KYTC Project KY 880 Lovers Lane Hwy Plans FD04 114 0880 003-007, Plat Books 17/132, 17/181, 17/106, 17/22, 19/34, 24/46, 26/89, and 30/33 as recorded in the Warren County Court Clerk's Office. This annex description is oriented to State Plane Coordinates Kentucky South 1602. This is not a boundary survey and is for annex purposes only.

Beginning at a point in the existing city limits and in the west right-of-way of KY 880 Lovers Lane said point being 54.53 feet left of centerline station 135+93.06; thence crossing Lovers Lane and with the existing city limits South 89 degrees 25 minutes 41 seconds East, 94.68 feet to a point in the east right-of-way; thence with said right-of-way South 03 degrees 50 minutes 01 seconds West, 28.45 feet to a point; thence crossing Steeplechase Court South 03 degrees 50 minutes 01 seconds West, 125.00 feet to a point; thence South 02 degrees 11 minutes 49 seconds West, 175.07 feet to a point; thence North 86 degrees 09 minutes 59 seconds West, 5.00 feet to a point; thence South 03 degrees 50 minutes 01 seconds West, 581.79 feet to a point; thence South 00 degrees 20 minutes 55 seconds East, 132.83 feet to a point; thence South 11 degrees 24 minutes 30 seconds West, 108.08 feet to a point; thence South 10 degrees 31 minutes 56 seconds West, 100.29 feet to a point; thence South 19 degrees 12 minutes 28 seconds West, 14.74 feet to a point; thence with a curve to the right having a radius of 1290.00 feet, an arc length of 235.49 feet, a chord bearing of South 19 degrees 12 minutes 28 seconds West, and a chord length of 235.16 feet to a point; thence South 19 degrees 12 minutes 56 seconds West, 23.59 feet to a point in the existing city limits and in the line of The Corbin Irrevocable Trust, DB 680 PG. 428; thence crossing KY 880 Lovers Lane North 64 degrees 29 minutes 35 seconds West, 111.74 feet to a point in the west right-of-way and in the line of the Warren County School Board Plat Book 30 Page 33; thence with said right-of-way North 29 degrees 53 minutes 53 seconds East, 69.27 feet to a point; thence North 15 degrees 06 minutes 53 seconds East, 144.51 feet to a point; thence North 24 degrees 07 minutes 23 seconds East, 106.85 feet to a point; thence; North 00 degrees 02 minutes 14 seconds West, 125.35 feet to a point; thence North 05 degrees 58 minutes 30 seconds East, 171.35 feet to a point; thence North 05 degrees 58 minutes 30 seconds East, 228.91 feet to a point; thence North 05 degrees 58 minutes 30 seconds East, 140.29 feet to a point;

thence North 01 degrees 51 minutes 21 seconds West, 201.00 feet to a point; thence North 05 degrees 51 minutes 35 seconds East, 185.77 feet to a point; thence crossing Steeplechase Way North 05 degrees 52 minutes 03 seconds East, 50.14 feet to a point; thence North 05 degrees 51 minutes 34 seconds East, 61.37 feet to the point of beginning containing 3.436 acres.

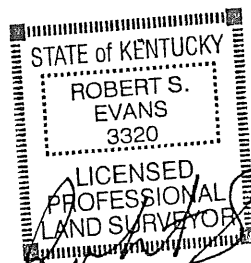

4/23/19

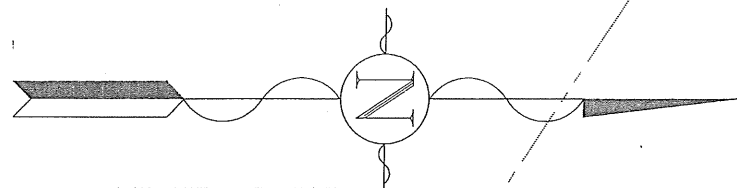

LOVERS LANE SOCCER COMPLEX
CITY OF BOWLING GREEN
CEED BOOK 985 PAGE 281

WARREN COUNTY SCHOOL BOARD
TRACT #2
BRIARWOOD MANOR SEC# 17
PLAT BOOK 30 PAGE 33

WARREN COUNTY SCHOOL BOARD
TRACT #3
BRIARWOOD MANOR SEC# 17
PLAT BOOK 30 PAGE 33

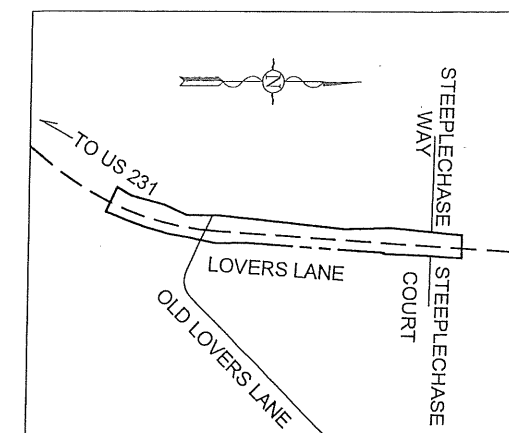

VICINITY MAP
NOT TO SCALE

NOTES

- 1) PROPOSED ANNEXATION 3.436 ACRES
- 2) R/W ANNEXED 3.436 ACRES
- 3) SOURCES PLAT BOOKS 17/132, 17/181, 17/106, 17/22, 19/34, 24/46, 26/89, AND 30/33, KY 880 LOVERS LANE HWY PLANS FD04 114 0880 003-007
- 4) ANNEX IS ORIENTED TO STATE PLANE COORDINATES KY SOUTH 1602

CORBIN IRREVOCABLE TRUST
DEED BOOK 680 PAGE 428

WILLIAM PEARCE DERMODY TRUST
DEED BOOK 1046 PAGE 10

STEEPLECHASE SUBDIVISION
PLAT BOOK 19 PAGE 34

STEEPLECHASE SUBD.
SEC III
PLAT BOOK 26 PAGE 89

LOVERS LANE ACRES SEC. III
PLAT BOOK 17 PAGE 181

LOVERS LANE ACRES SEC. III
PLAT BOOK 17 PAGE 132

PREVIOUS
ANNEXATION
BG 2018-19

PREVIOUS
ANNEXATION
BG 2007-5

CURVE	RADIUS	ARC LENGTH	CHORD LENGTH	CHORD BEARING	DELTA ANGLE
C1	1290.00'	235.49'	235.16'	S 19°12'28" W	10°27'33"

LINE	BEARING	DISTANCE
L1	S 89°25'41" E	94.68'
L2	S 03°50'01" W	28.45'
L3	S 03°50'01" W	125.00'
L4	S 02°11'49" W	175.07'
L5	N 86°09'59" W	5.00'
L6	S 03°50'01" W	581.79'
L7	S 00°20'55" E	132.83'
L8	S 11°24'30" W	108.08'
L9	S 10°31'56" W	100.29'
L10	S 19°12'28" W	14.74'
L11	S 19°12'56" W	23.59'
L12	N 64°29'35" W	111.74'
L13	N 29°53'53" E	69.27'
L14	N 15°06'53" E	144.51'
L15	N 24°07'23" E	106.85'
L16	N 00°02'14" W	125.35'
L17	N 05°58'30" E	171.35'
L18	N 05°58'30" E	228.91'
L19	N 05°58'30" E	140.29'
L20	N 01°51'21" W	201.00'
L21	N 05°51'35" E	185.77'
L22	N 05°52'03" E	50.14'
L23	N 05°51'34" E	161.37'

THIS DRAWING WAS PREPARED USING DEEDS AND PLATS
OF RECORD IN THE WARREN COUNTY COURT CLERKS OFFICE
AND FROM TAX MAPS AND RECORDS IN THE WARREN COUNTY
PROPERTY VALUATION ADMINISTRATORS OFFICE.
THIS IS NOT OR INTENDED TO BE A BOUNDARY SURVEY AND
SHOULD NOT BE USED AS SUCH. THIS DRAWING IS FOR
ANNEXATION PURPOSES ONLY.

ROBERT S. EVANS PLS# 3320 DATE

Robert S. Evans 4/23/19

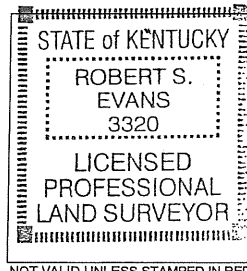

SURVEYOR

ROBERT S. EVANS PLS # 3320
1011 COLLEGE STREET
BOWLING GREEN, KENTUCKY
42101
PHONE # (270) 393-3229
e-mail - rob.evans@bgky.org

CLIENT

CITY OF BOWLING GREEN
1001 COLLEGE STREET
BOWLING GREEN, KENTUCKY
42101
PHONE # (270) 393-3000

SCALE 1" = 200'

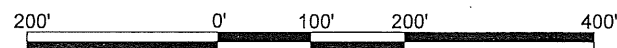

CITY OF BOWLING GREEN

PUBLIC WORKS DEPARTMENT

R/W ANNEXATION
LOVERS LANE

SHEET 1 OF 1

JOB NO. 19030 SCALE 1" = 200' DATE 04/15/2019