

# City of Bowling Green

## OFFICE OF THE CITY CLERK

P. O. BOX 430

BOWLING GREEN, KENTUCKY 42102-0430

LINDA TAYLOR LEIGH, CMC  
CITY CLERK

PHONE  
(502) 782-2489 EXT. 633  
FAX: (502) 843-5698



September 9, 1996

Mr. John Y. Brown, III  
Kentucky Secretary of State  
Capitol Building  
Frankfort KY 40601

Dear Mr. Brown:

As a result of the adoption and publication of Ordinance No. BG96 - 33, unincorporated territory has been annexed by the City of Bowling Green effective upon publication on September 6, 1996.

A certified ordinance, a property description and a map are enclosed for the annexed area.

Sincerely,

Linda Taylor Leigh, CMC  
City Clerk

LTL/jag

Enclosure

RECEIVED  
SEP 12 1996  
CITY CLERK  
BOWLING GREEN, KY

ORDINANCE NO. BG96 - 33

ORDINANCE ANNEXING PROPERTY

ORDINANCE ANNEXING 58.51 ACRES LOCATED ON HOBSON LANE, PRESENTLY OWNED BY C. HENRY ENGLISH ESTATE AND STONEHENGE CORPORATION, WITH SAID TERRITORY BEING CONTIGUOUS TO EXISTING CITY LIMITS

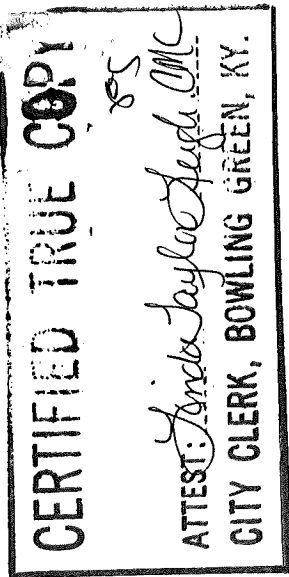

WHEREAS, the C. Henry English Estate and Stonehenge Corporation have requested and consented in writing to annexation into the City of Bowling Green pursuant to KRS 81A.412 of property containing 58.51 acres located on Hobson Lane, more particularly described on the attached description; and,

WHEREAS, the C. Henry English Estate and Stonehenge Corporation, are the owners of record of the land to be annexed; and,

WHEREAS, the City of Bowling Green wishes to annex that property being 58.51 acres located on Hobson Lane, with all such property being contiguous to existing city limits.

NOW, THEREFORE, BE IT ORDAINED by the City of Bowling Green, Kentucky, pursuant to KRS 81A.412 as follows:

1. That the entire tract of real estate containing 58.51 acres located on Hobson Lane which is contiguous to existing city limits, presently owned by the C. Henry English Estate and Stonehenge Corporation, which is more particularly described in the attached description, Exhibit A, shall be and is hereby annexed into the City of Bowling Green, Kentucky, and the boundaries of the City are hereby extended so as to include and incorporate all of said real estate into the City of Bowling Green.

2. A certified copy of this Ordinance shall be forwarded to Public Works Department, Engineering Division and it is hereby authorized and directed to make the necessary changes to the territorial limits of the City in Chapter One of the City of Bowling Green Code of Ordinances to reflect this annexation.

(Ordinance No. BG96 - 33)

3. This Ordinance is adopted pursuant to KRS 83A.060 in that it was introduced on August 20, 1996, and given final reading on September 3, 1996, and said Ordinance shall be in full force and effect upon signature, recordation and publication in summary pursuant to KRS Chapter 424.

ADOPTED: September 3, 1996

APPROVED: Eldon J. Renaud  
Mayor, Chairman of Board of Commissioners

ATTEST: Lyndee Taylor Leigh, CMC  
City Clerk

SPONSORED BY: Charles W. Coates, City Manager, 08/15/96, 11:15 a.m.

"EXHIBIT A"

Beginning at a point in the existing city limits line, said point is also in the west right-of-way line of Hobson Lane 2480' +/- from the right-of-way of US 231, thence with said right-of-way S 01 degrees 54' 27" W 184.00 feet to a point; thence S 03 degrees 03' 12" W 500.10 feet to a point; thence S 07 degrees 37' 05" W 77.29 feet to a point; thence S 57 degrees 34' 38" W 16.12 feet to a point in the west right-of-way line and a corner common with the City of Bowling Green (Preston Miller Park) and Jennings Creek; thence along said creek N 80 degrees 50' 19" W 48.99 feet to a point; thence N 65 degrees 14' 10" W 134.42 feet to a point; thence N 56 degrees 58' 10" W 134.56 feet to a point; thence N 43 degrees 53' 38" W 47.24 feet to a point; thence N 46 degrees 24' 34" W 87.44 feet to a point common with the City of Bowling Green (Preston Miller Park) and the property owned by Edward and Geri Whaley, thence with the Whaley's property N 47 degrees 24' 35" W 77.15 feet to a point; thence N 69 degrees 33' 48" W 50.85 feet to a point; thence N 56 degrees 22' 44" W 48.35 feet to a point; thence N 43 degrees 24' 49" W 68.84 feet to a point; thence N 52 degrees 14' 36" W 95.76 feet to a point; thence N 15 degrees 54' 45" W 79.11 feet to a point; thence N 36 degrees 39' 13" W 204.38 feet to a point; thence N 49 degrees 45' 53" W 42.58 feet to a point; thence N 58 degrees 35' 50" W 91.66 feet to a point; thence N 46 degrees 51' 51" W 176.90 feet to a point; thence N 61 degrees 02' 02" W 113.73 feet to a point; thence N 86 degrees 52' 51" W 67.98 feet to a point; thence N 41 degrees 55' 26" W 337.62 feet to a point; thence N 23 degrees 40' 41" W 36.43 feet to a point; thence N 35 degrees 59' 13" W 167.79 feet to a point; thence N 50 degrees 29' 47" W 238.53 feet to a point; thence N 46 degrees 52' 33" W 78.34 feet to a point; thence N 31 degrees 44' 20" W 271.22 feet to a point; thence N 00 degrees 42' 06" E 96.39 feet to a point; thence N 16 degrees 39' 29" E 124.24 feet to a point; thence N 50 degrees 25' 30" E 106.54 feet to a point; thence N 25 degrees 54' 02" E 106.80 feet to a point; thence N 23 degrees 36' 26" E 128.27 feet to a point; thence N 30 degrees 22' 40" E 69.41 feet to a point; thence S 58 degrees 56' 55" E 21.90 feet to a point; thence N 24 degrees 51' 15" E 16.92 feet to a point common with Edward & Geri Whaley and J. Wayne Redden. Thence with the Redden Line S 71 degrees 46' 41" E 1407.66 feet to a point common with J. Wayne Redden and the property owned by the Fraternal Order of Police Lodge #13. Thence with the Fraternal Order of Police line S 13 degrees 13' 19" W 126.57 feet to a point; thence S 74 degrees 00' 26" E 424.61 feet to a point in the west right-of-way of Hobson Lane. Thence with said right-of-way S 04 degrees 46' 12" W 34.54 feet to a point; thence S 00 degrees 57' 18" E 500.62 feet to a point; thence S 04 degrees 11' 53" W 250.20 feet to a point; thence S 01 degrees 54' 27" W 116.00 feet to the point of beginning containing 58.51 acres +or -.

EDWARD & GERRI WHALEY  
DEED BOOK 636 PAGE 78

J. WAYNE REDDEN  
DEED BOOK 686 PAGE 6

FRATERNAL ORDER OF POLICE  
LODGE # 13  
DEED BOOK 472 PAGE 165

BARRY & VIRGINIA CRUTCHER  
DEED BOOK 536 PAGE 792

58.51 ACRES

EDWARD & GERRI WHALEY  
DEED BOOK 636 PAGE 78

CITY OF BOWLING GREEN  
(PRESTON MILLER PARK)  
DEED BOOK 596 PAGE 240

TO RUSSELLVILLE ROAD

- 1 S 24°45'12"E - 34.54'
- 2 S 07°33'03"E - 77.23'
- 3 S 77°34'36"E - 18.12'
- 4 N 80°50'10"E - 44.89'
- 5 S 08°45'10"E - 51.90'
- 6 N 26°51'10"E - 14.85'

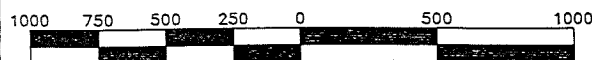
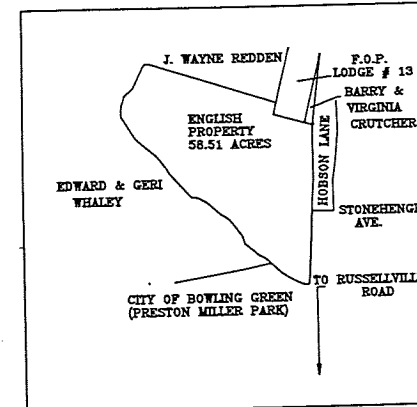
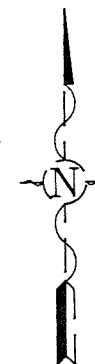

BOWLING GREEN PUBLIC WORKS

No.	DATE	REVISION

ENGLISH PROP. ANNEXATION  
HOBSON LANE

SHEET 1/1			
DRAWING NAME AND PREFIX J:\PUBWORKS\DWG\ENGLISH			
JOB NO.	DATE	SCALE	DRAWN BY J.R.W.
	08/02/96	1" = 500'	CHKD. BY J.T.L.