

CITY OF BOWLING GREEN
F O U N D E D 1 7 9 8

RECORDED AND FILED

DATE

March 12, 2002

JOHN Y. BROWN III
SECRETARY OF STATE
COMMONWEALTH OF KENTUCKY

BY *K. Ashmore*

KATIE E. SCHALLER
City Clerk

DEPARTMENT OF CITIZEN INFORMATION AND ASSISTANCE

270.393.3632
email: schak13@bgky.org

March 8, 2002

Honorable John Y. Brown, III
Kentucky Secretary of State
Capitol Building, 700 Capitol Avenue
Frankfort, Kentucky 40601

IN RE: Annexation of 4.75 acres located in Greenwood Heights Subdivision
Off Scottsville Road and Peachtree Lane, known as Lots 12, 13, 14, 15 and 16

Dear Sir:

As a result of the adoption and publication of Ordinance No. BG2002-10, unincorporated territory has been annexed by the City of Bowling Green effective upon publication date of March 8, 2002.

A certified copy of the above-referenced ordinance, a description of the property and a map are enclosed for this annexed area.

Sincerely,

Katie Schaller

Katie E. Schaller
City Clerk

KES/tsw
Enclosures

DATE

March 12, 2002

ORDINANCE NO. BG2002 - 10

ORDINANCE ANNEXING PROPERTY BY CONSENT

JOHN V. BROWN III
SECRETARY OF STATE

COMMONWEALTH OF KENTUCKY

ORDINANCE ANNEXING 4.75 ACRES OF
PROPERTY LOCATED IN GREENWOOD
HEIGHTS SUBDIVISION OFF SCOTTSVILLE
ROAD AND PEACHTREE LANE KNOWN AS LOT
#12, 13, 14, 15 AND 16, WITH PROPERTY
PRESENTLY OWNED BY CLAUDENE WHEELER,
AND SAID TERRITORY BEING CONTIGUOUS TO
EXISTING CITY LIMITS

WHEREAS, pursuant to KRS 81A.412, the City of Bowling Green may annex any area which meets the requirements for annexation if the owner of record of the land to be annexed gives prior consent in writing; and,

WHEREAS, Claudene Wheeler has requested and consented in writing to the annexation of 4.75 acres of land located at 169 Peachtree Lane (Lot #15), 185 Peachtree Lane (Lot #16) and Lot #12, 13 and 14 located off Scottsville Road in the Greenwood Heights Subdivision, as identified in Plat Book 5, Page 23 in the Warren County Court Clerk's office and identified on the attached map; and,

WHEREAS, the City of Bowling Green hereby declares it desirable to annex this property as described in the attachment to this Ordinance; and,

WHEREAS, the proposed property to be annexed is adjacent or contiguous to the City and the property is urban in character and suitable for development for urban purposes without unreasonable delay.

NOW, THEREFORE, BE IT ORDAINED by the City of Bowling Green, Kentucky pursuant to KRS 81A.412 as follows:

1. The property located at 169 Peachtree Lane (Lot #15), 185 Peachtree Lane (Lot #16) and Lots #12, 13 and 14 located off Scottsville Road in the Greenwood Heights Subdivision, and identified on the attached map and further described in the attachment to this Ordinance containing approximately

BG2002-10

(Ordinance No. BG2002 – 10)

4.75 acres, which is contiguous to existing City limits and presently owned by Claudene Wheeler shall be and is hereby annexed into the City of Bowling Green, Kentucky by consent of the owner, and the boundaries of the City are hereby extended so as to include and incorporate all of this real estate into the City of Bowling Green.

2. A copy of this Ordinance shall be forwarded to the Public Works Department, Engineering Division and it is hereby authorized and directed to make the necessary changes to the territorial limits of the City in Chapter One of the City of Bowling Green Code of Ordinances to reflect this annexation.

3. All prior Municipal Orders or Ordinances or parts of any Municipal Order or Ordinance in conflict herewith are hereby repealed.

4. This Ordinance is adopted pursuant to KRS 83A.060 in that it was introduced on February 19, 2002, and given final reading on March 5, 2002, and said Ordinance shall be in full force and effect upon signature, recordation and publication in summary pursuant to KRS Chapter 424.

ADOPTED: March 5, 2002

APPROVED: *Janet Jones*
Mayor, Chairman of Board of Commissioners

ATTEST: *Katie Schaller*
City Clerk

SPONSORED BY: Charles W. Coates, City Manager, 02/04/2002, 10:30 a.m.

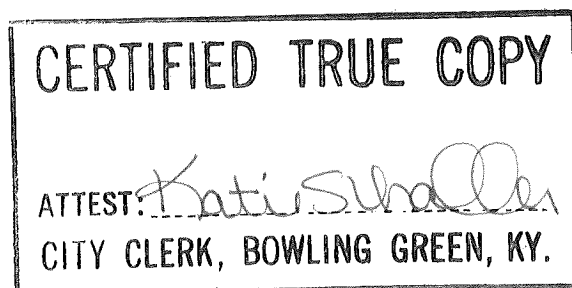

A certain tract of land located in Bowling Green , Warren County, Kentucky, and more particularly described as follows:

Beginning at a point in the existing city limits of Bowling Green , Kentucky. said point being a common corner to Lot # 16 and Lot # 17 of the Greenwood Heights Subdivision, Plat Book 5 Page 23 ; thence with the line of Lot # 16 South 21 degrees 00 minutes East, 463.53' feet to a point in the north right of way of Peachtree Lane ; thence crossing Peachtree Lane South 21 degrees 00 minutes East, 50.00' feet to a point in the south right of way line of said road ; thence with said right of way South 67 degrees 09 minutes 31 seconds West, 483.75 feet to a point in the south right of way of Peachtree Lane, said point is also in the east right of way Scottsville Road ; thence crossing Peachtree Lane and continuing with the right of way of Scottsville Road North 21 degrees 15 minutes 00 seconds West, 375.45' feet to a point in said right of way and a common corner to Lot # 12 and Lot # 11 Greenwood Heights Subdivision ; thence with the line of Lot # 12 North 68 degrees 45 minutes East, 306.61' feet to a point ; thence North 21 degrees 00 minutes West, 156.17' feet to a point in the existing city limits ; thence with said city limits North 70 degrees 00 minutes East, 179.95' feet to the point of beginning and containing 4.75 acres.

This description was prepared by Robert S. Evans PLS # 3320 from deeds and plats of record as recorded in Deed Book 366 Page 540, Deed Book 366 Page 615, and Deed Book 701 Page 22. Also in Plat Book 5 Page 23 in the Warren County Court Clerk's Office

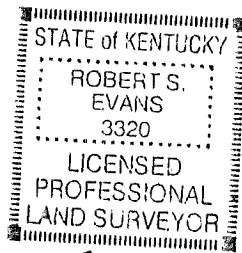

DOCS # 78819

A handwritten signature in cursive script, appearing to read "Robert S. Evans".

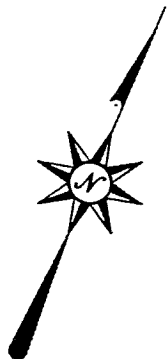

↑
TO BOWLING
GREEN

U.S. 231 SCOTTSVILLE ROAD
80' R/W

N 21°15' W
50.00'

↓
TO ALVATON

EXISTING CITY LIMITS

EXISTING CITY LIMITS

BARRY & LISA CUMMINGS
DB. 752 PG. 825

GREENWOOD HEIGHTS SUBD.
PLAT BOOK 5 PAGE 23

GREENWOOD HEIGHTS SUBDIVISION
PLAT BOOK 5 PAGE 23

FRANK OTTE NURSERY
OF BOWLING GREEN
DB. 581 PG. 188

FRED AND SHIRLEY
LEATH
DB. 441 PG. 24



RESIDENTIAL AREA ANNEXED
4.19 ACRES



RIGHT OF WAY
PEACHTREE LANE
0.56 ACRES

TOTAL AREA ANNEXED= 4.75 ACRES

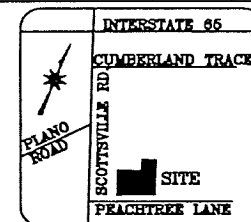

VICINITY MAP
N.T.S.

THIS DRAWING WAS PREPARED USING DEEDS AND PLATS
RECORDED IN THE WARREN COUNTY COURTHOUSE
AND SHOULD NOT BE CONSIDERED A BOUNDARY SURVEY



CITY OF BOWLING GREEN
PUBLIC WORKS
FIELD ENGINEERING

ANNEXATION

CLAUDENE WHEELER PROPERTY
LOTS 12,13,14,15, AND 16 GREENWOOD HEIGHTS SUBD.
PLAT BOOK 5 PAGE 23
DB 368 PG 540, DB 368 PG 615, DB 701 PG 22
LOCATED AT INTERSECTION US 231 AND PEACHTREE LANE

SHEET 1 OF 1

JOB # _____ SCALE _____ DATE _____
WHEELER ANNEX 1" = 200' FEBRUARY 1, 2002