

R. KIM VOCKE
ATTORNEY AT LAW
526 GREENUP STREET
COVINGTON, KENTUCKY 41011

PHONE (859) 491-8595
FAX (859) 261-6567

RECEIVED

JUN 15 2001

June 12, 2001

Kentucky Secretary of State
Frankfort, KY 40601

Dear Official:

Pursuant to Kentucky Revised Statutes, enclosed please find a copy of an Annexation Ordinance that was adopted by the City of Bromley along with a map and a metes and bounds description of the property involved. Please accept these documents for your records.

Please feel free to contact me if you have any questions.

Sincerely,



R. Kim Vocke
Attorney at Law

Enclosure
RKV/lnl

ORDINANCE NO. 3-1-01

AN ORDINANCE OF THE CITY OF BROMLEY, KENTUCKY ANNEXING CERTAIN PARCELS OF REAL ESTATE IN UNINCORPORATED KENTON COUNTY INTO THE CITY OF BROMLEY, KENTUCKY.

WHEREAS: the owners of three (3) certain parcels of real estate in unincorporated Kenton County, all of which are adjacent to the City of Bromley, have requested to become annexed into the City of Bromley, and

WHEREAS: the three (3) parcels of real estate, by reason of population density, commercial, industrial, institutional or governmental use of land, or subdivision of land, are urban in character or suitable for development for urban purposes without unreasonable delay, and

WHEREAS: the City of Bromley desires to annex the three (3) parcels of real estate referred to herein, and

WHEREAS: pursuant to KRS 81A.412, Bromley may annex the three (3) parcels,

NOW, THEREFORE, BE IT ORDAINED BY THE CITY OF BROMLEY, KENTUCKY, AS FOLLOWS:

SECTION I

That the City of Bromley, Kentucky, hereby annexes into the confines of the City of Bromley those three (3) parcels of real estate adjoining the City of Bromley and described in Exhibit A, attached hereto and incorporated herein by reference, pursuant to KRS 81A.412.

SECTION II

All Ordinances and parts of Ordinances in conflict herewith are hereby repealed to the extent of such conflict.

SECTION III

The invalidity of any Section, sub-section, or sentence of this Ordinance shall not effect the validity of the other portions of this Ordinance.

SECTION IV

This Ordinance shall take affect and be in full force from and after its passage, publication and recording according to law.

CITY OF BROMLEY, KENTUCKY
A municipal corporation of the fifth class.

By *James Miller*
MAYOR

3/3/01
FIRST READING

4/7/01
SECOND READING

ATTEST:

Janet M. Hredenic
CITY CLERK

PUBLISHED: *Mailed to Citizens April 2001*

ATTACHMENT A

PAGE 1 OF 2

Leslie and Brenda Keel Property
 1769 Highwater Road, Bromley, Kentucky
 PIDN # 027-10-00-230.00
 Group # 3040

GROUP NO. 3040FLAT BOOK

PARCEL 1. Being Lot 18 of the Highwater Heights Subdivision (unrecorded) of Kenton County, Kentucky, said subdivision located one-half (1/2) mile south-west of Bromley, Kentucky, on the High Water Road and said lot being more particularly described as follows: Beginning at a point in the southerly line of High Water Road, 1673.72 feet south and west of the northerly boundary line of the D. Collins Lee Property, as recorded in Deed Book 303 Page 401 of the Kenton County Records at Covington, Kentucky, said measurement being made along the curved easterly or southerly line of road, having a degree of curvature of 9° 57.2' and a radius of 575.6 feet for a distance of 773.72' and then continuing along the south line of the road, N. 86° 24' W. 900' to the place of beginning; thence south 3° 36' W. 332.6', more or less to a point in the southerly line of the Lee Property; thence N. 68° 05' W. along the southerly line of the Lee Property, 105.34' to a point; thence N. 3° 36' E. 299.5', more or less, to a point in the southerly line of High Water Road; thence S. 86° 24' E. along the southerly line of the road, 100' to the place of beginning.

PARCEL 2. Being Lot Seventeen (17) of the High Water Heights Subdivision (unrecorded) and more particularly described as follows: Beginning at a point in the southerly line of High Water Road, 1773.72' south and west of the northerly boundary line of the D. Collins Lee Property as recorded in Deed Book 303 Page 401 of the Kenton County records at Covington, said measurement being made easterly or southerly line of the road, having a degree of curvature of 9° 57.2' and a radius of 575.6', for a distance of 773.72 feet and then continuing along the south line of the road, N. 86° 24' W. 1000' to the place of beginning, S. 3° 36' W., 299.5 feet more or less, to a point in the southerly line of the Lee Property; thence N. 68° 05' West along the southerly line of the Lee Property; 140.33' to a point; thence northwardly, 260', more or less to a point in the southerly line of the High Water Road, thence eastwardly along the southerly line of the road as it curves, having a degree of curvature of 13° 41.6' and a radius of 418.38', 53.83' to a point; thence continuing along the southerly line of the road, South 86° 24' East, 37.16' to the place of beginning.

ATTACHMENT A

PAGE 2 OF 2

Orlan and Imogene Holliday Property
1774 Highwater Road, Bromley, Kentucky
PIDN # 027-10-00-213.00
Group # 3040

Being lot number thirteen (13) of the High Water Heights Subdivision (unrecorded) of Kenton County, Kentucky, said subdivision being located one-half mile southwest of Bromley, Kentucky, on the High Water Road, and said lot being more particularly described as follows:

Beginning at a point in the north line of the High Water Road, 1684.76 feet south and west of the northerly boundary line of the D. Collins Lee property, as recorded in Deed Book 303, page 401, of the Kenton County records at Covington, Kentucky, said measurement being made along the curved westerly or northerly line of the road, having a degree of curvature of 11 deg. - 13 $\frac{1}{2}$ ', and a radius of 510.6 feet, for a distance of 684.76 feet, and then continuing along the north line of the road, north 86 deg. - 24' west, 1000 feet to the place of beginning as stated above; thence north 86 deg. 24' west along the north line of the High Water Road, 37.16 feet to a point; thence continuing along the north line of the High Water Road as it curves, 122.32 feet to a point, said curve having a degree of curvature of 16 deg. - 12.6' and a radius of 353.38 feet; thence north 23 deg. - 26' east, 247.51 feet to a point; thence north 87 deg. - 43' east, 73.43 feet to a point; thence south 3 deg. - 36' west, 261.3 feet, more or less, to the place of beginning.

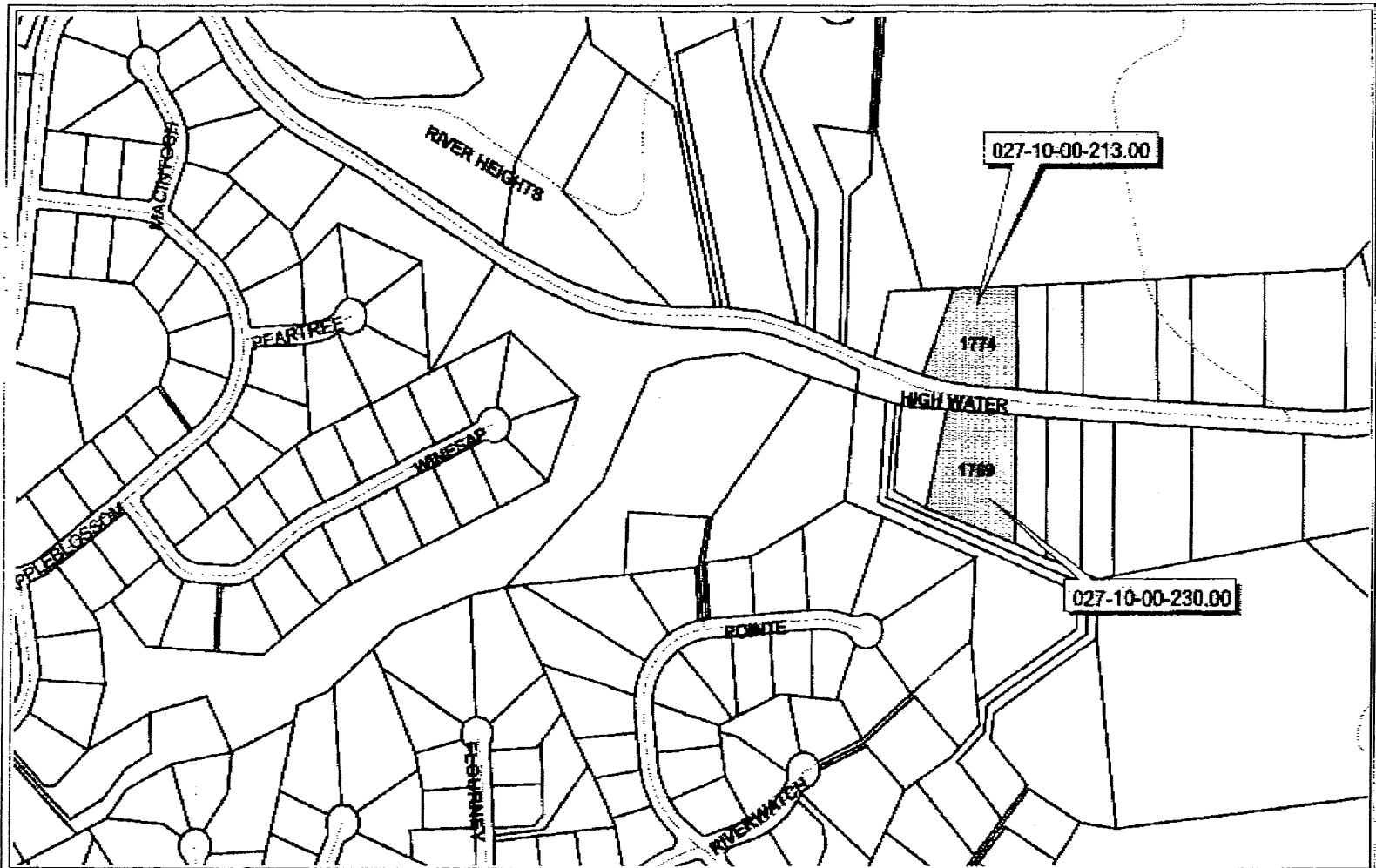

This map was prepared by the
 City of River Heights, Alaska
 using data provided by the
 Alaska Department of Transportation
 and Public Safety, Division of
 Aerial Photography and Mapping
 Services. The City of River Heights
 is not responsible for any errors
 or omissions on this map.

 Cntrline
 Parcel

