

# CITY OF BROWNSBORO FARM

8455 BROWNSBORO ROAD  
LOUISVILLE, KENTUCKY 40222

June 1, 1981

Frances Jones Mills, Secretary of State  
Capitol Building  
Frankfort, Kentucky 40601

Attention: Libby Horn

Dear Ms. Horn:

For the purpose of bringing the City of Brownsboro Farm into compliance with KRS 81.045, please find enclosed a statement showing the official name, year of incorporation and present classification of the City. Also enclosed are two maps showing the present boundaries of the City: 1) taken from the Bureau of the Census Map Series 4520, Map Sheet 3; and 2) free-drawn, not-to-technical-scale, showing detail of City roads and the extent of City park land.

SECRETARY OF STATE  
**RECEIVED**

JUN 3 1981

COMMONWEALTH OF KENTUCKY

Sincerely,

  
LeeAnn E. Ford  
City Clerk/Treasurer

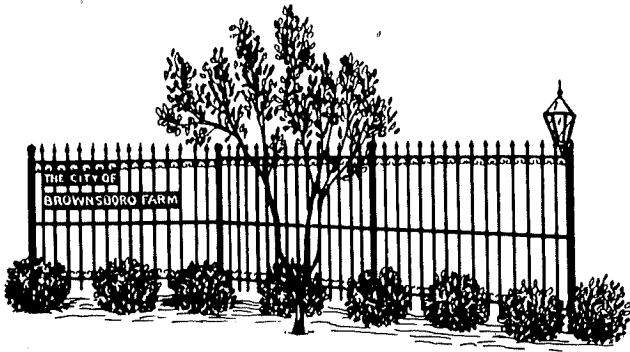

# CITY OF BROWNSBORO FARM

8455 BROWNSBORO ROAD  
LOUISVILLE, KENTUCKY 40222

OFFICIAL NAME: City of Brownsboro Farm, Kentucky

YEAR OF INCORPORATION: 1966 - Dec. 2, 1966

PRESENT CLASSIFICATION: Sixth-class

*Jefferson County*

ATTEST:

Seal

*B. Ann C. Ford*  
\_\_\_\_\_  
City Clerk

(USS)

DO 2519 #1

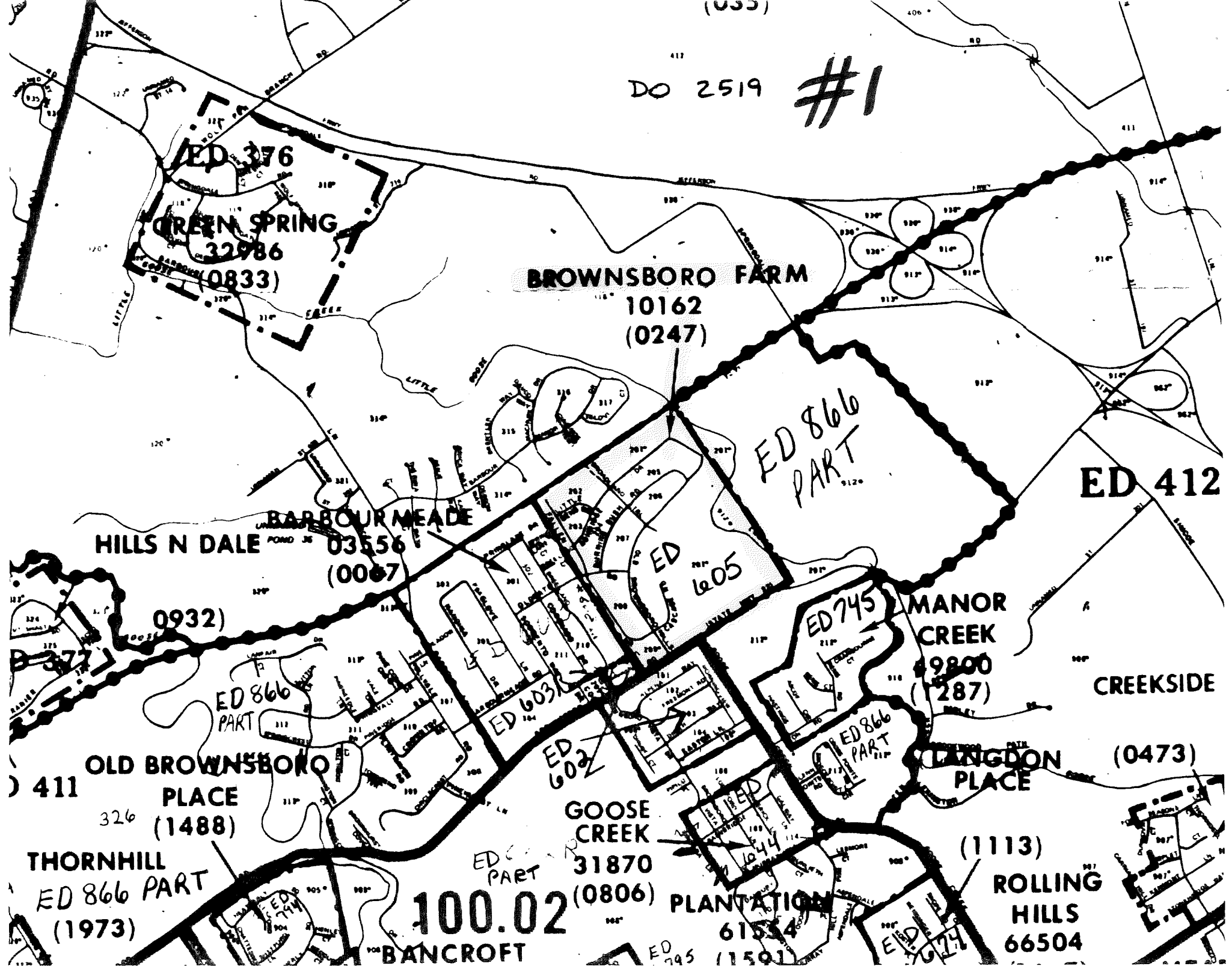

ED 376

GREEN SPRING  
32986  
(0833)

BROWNSBORO FARM  
10162  
(0247)

HILLS N DALE  
03556  
(0067)

ED 866  
PART

ED 412

ED  
605

MANOR  
CREEK  
49800  
(287)

CREEKSIDE

ED 866  
PART

ED 603

ED 745

LANGDON  
PLACE  
(0473)

411  
OLD BROWNSBORO  
PLACE  
326  
(1488)

ED 602

GOOSE  
CREEK  
31870  
(0806)

(1113)  
ROLLING  
HILLS  
66504

THORNHILL  
ED 866 PART  
(1973)

100.02  
BANCROFT

PLANTATION  
61534

ED 745  
(1591)

#2

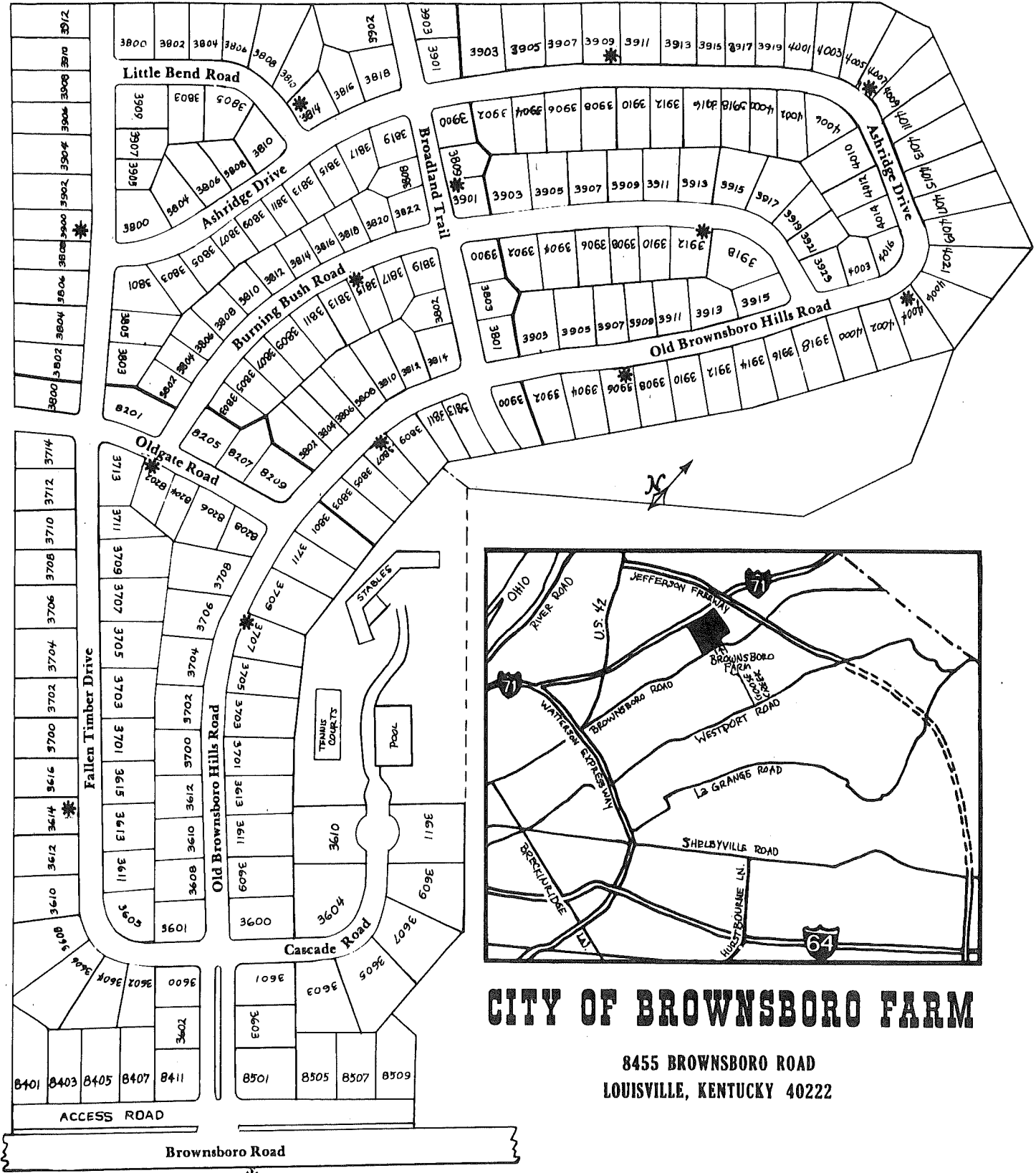

# CITY OF BROWNSBORO FARM

8455 BROWNSBORO ROAD  
LOUISVILLE, KENTUCKY 40222

NOTE: Stars (\*) on map indicate locations of fire hydrants.

VOTING PRECINCT MAP

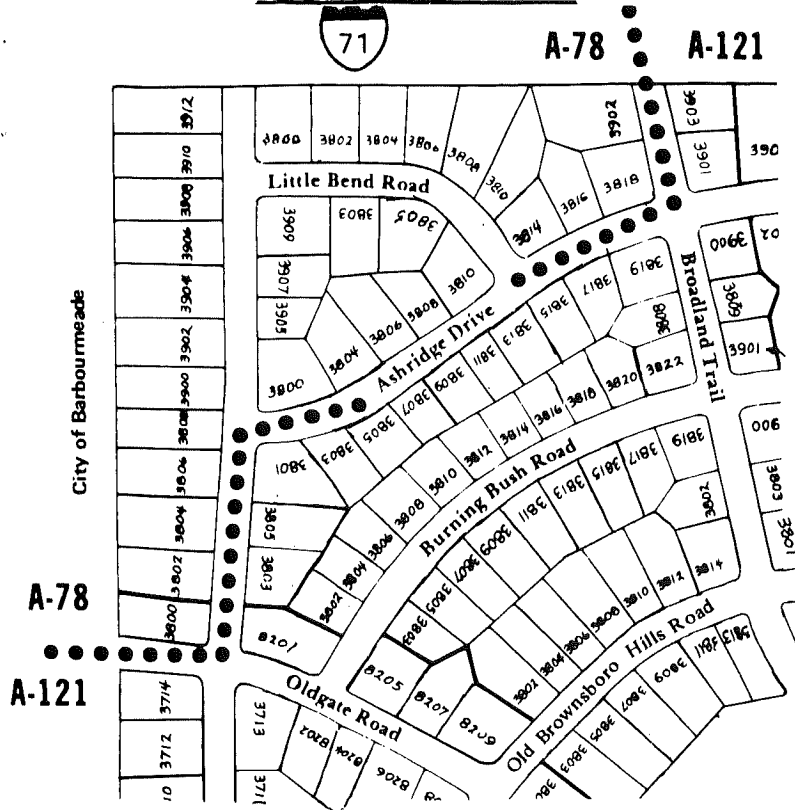

CITY GOVERNMENT

Brownsboro Farm was incorporated as a Sixth Class City under Kentucky law in 1966. The City is governed by a nonpartisan Board of Trustees whose members are elected for two-year terms in odd-numbered years. The next election for the Board will be in November 1981. The Board elects one of its five members as Chairman.

The Board meets at 7:30 p.m. on the second Tuesday of each month at the Worthington Volunteer Fire Dept. station house, 8412 Brownsboro Road.

The current tax rate for Brownsboro Farm is 30 cents per \$100 of assessed valuation. Tax bills are due September 1.

VOTING INFORMATION

Brownsboro Farm is in Jefferson County's District "A". Most of the City is in Precinct A-121. The western corner of the City is in Precinct A-78. The boundary runs in the middle of Oldgate Road to Fallen Timber Dr., up Fallen Timber Dr. to Ashridge, along the middle of Ashridge Dr. to Broadland Trail, then up the middle of Broadland Trail to its termination.

To vote in Kentucky elections you must be 18 years of age and have lived in the state for 30 days. For information on voter registration call 581-6026.

POLLING PLACES

- A-121 Worthington Fire Department
- A-78 Norton Elementary School

PRECINCT CAPTAINS

Democratic

- A-121 Gertrude Nahinsky 426-3035
- A-78 Edward Gold 425-5561

Republican

- A-121 Heni Owens 425-2304
- A-78 Brad Wilcox 426-7649