

RESOLUTION 09 – 09

A RESOLUTION ADOPTING A MODERN AND ACCURATE LEGAL DESCRIPTION OF TERRITORY PREVIOUSLY ANNEXED BY ORDINANCE

WHEREAS, the City of Campbellsville has enacted numerous ordinances annexing property into the corporate limits of the City of Campbellsville; and

WHEREAS, each individual annexation contains a prior survey oft prepared by now unknown individual, and further references documentation that is no longer in existence; and

WHEREAS, the City wishes to provide a modern, accurate, easily identifiable legal description reflecting bearings and coordinates based upon the state plane coordinate system, including relevant GPS and GIS data, same having been certified by a professional land surveyor for each prior annexation; and

WHEREAS, the City wishes to comply with the requirements of Amended KRS 81A.40 effective July 13, 2004, and

WHEREAS, the City does not intend to amend or replace its prior ordinance annexing, but rather to interpret the defined boundaries of the territory previously annexed and adopt a modern and accurate legal description of territory previously annexed.

NOW THEREFORE, BE IT RESOLVED BY THE CITY COUNCIL OF THE CITY OF CAMPBELLSVILLE, KENTUCKY:

SECTION 1. That the City Council of the City of Campbellsville hereby adopts the following legal description, and a plat attached hereto as prepared by Robert L. Miller Jr., Licensed Professional Land Surveyor No. 2282 by new survey as an accurate depiction of the property previously annexed into the corporate city limits of the City of Campbellsville by Ordinance 91-01 dated April 1st, 1991, a copy of which is attached hereto as Exhibit "2", and hereby adopts said new legal description and plat as the official legal description and plat to be adopted by the City for all purposes when referencing this prior annexation.

SECTION 2. This new legal description as prepared by Robert L. Miller Jr., a Licensed Professional Land Surveyor No. 2282 is as follows:

PROPERTY DESCRIPTION FOR ALAN CHANDLER AND GARY MONEY
AREA TO BE ANNEXED BY CITY OF CAMPBELLSVILLE

Beginning at an iron pin in the line of Tract 3 of the Elizabeth G. Sanders Estate-Plat 2, corner of Tract 2 of the Elizabeth G. Sanders Estate-Plat 3 (Plat Book 2, Page 59); thence with the line of said Tract 2 and then with the line of Tract 3 of said Elizabeth G. Sanders Estate-Plat 3 North 55 degrees 43 minutes East 571.3 feet to an iron pin, corner of the Western Heights Subdivision (Deed Book 47, Page 636); thence with the lines of said Western Heights Subdivision as follows: North 76 degrees 18 minutes East 126.7 feet; South 70 degrees 29 minutes East 95.7 feet to a point in the line of said Western Heights Subdivision, said point being a corner of the existing City Limits of the City of Campbellsville; thence with the existing City Limits of the City of Campbellsville and crossing Tract 4 of said Elizabeth G. Sanders Estate-Plat 3 South 34 degrees 46 minutes West 624.2 feet to a point in the line of Tract 3 of said Elizabeth G. Sanders Estate-Plat 2, and being in the line of said City Limits of the City of Campbellsville; thence with the line of said Tract 3 North 59 degrees 38 minutes West 381.8 feet to the beginning containing 3.60 acres.

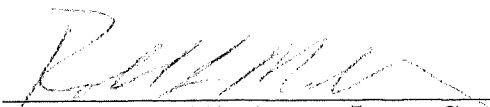
Robert L. Miller, Jr., Surveyor
Kentucky #2282

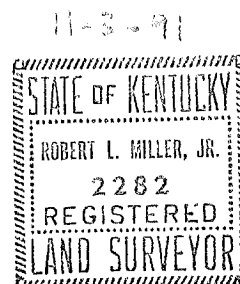

NOW THEREFORE, this resolution will take effect upon approval and adoption by the City Council this 13th day of April, 2009.

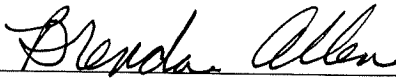

Mayor Brenda Allen

ATTEST:

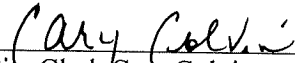

City Clerk Cary Colvin

CERTIFICATION

I, Cary Colvin, certify that I am the duly qualified City Clerk of the City of Campbellsville, Kentucky, and that the above Resolution 09 – 09 is a true, correct, and complete copy as was presented to the City Council of the City of Campbellsville at their regular schedule meeting dated April 13th, 2009.

WITNESS, my hand and Seal, this 13th day of April, 2009.

Cary Colvin
Signature of City Clerk

Seal:

RECEIVED AND FILED
DATE April 27, 2009

TREY GRAYSON
SECRETARY OF STATE
COMMONWEALTH OF KENTUCKY
BY Handie Adkins

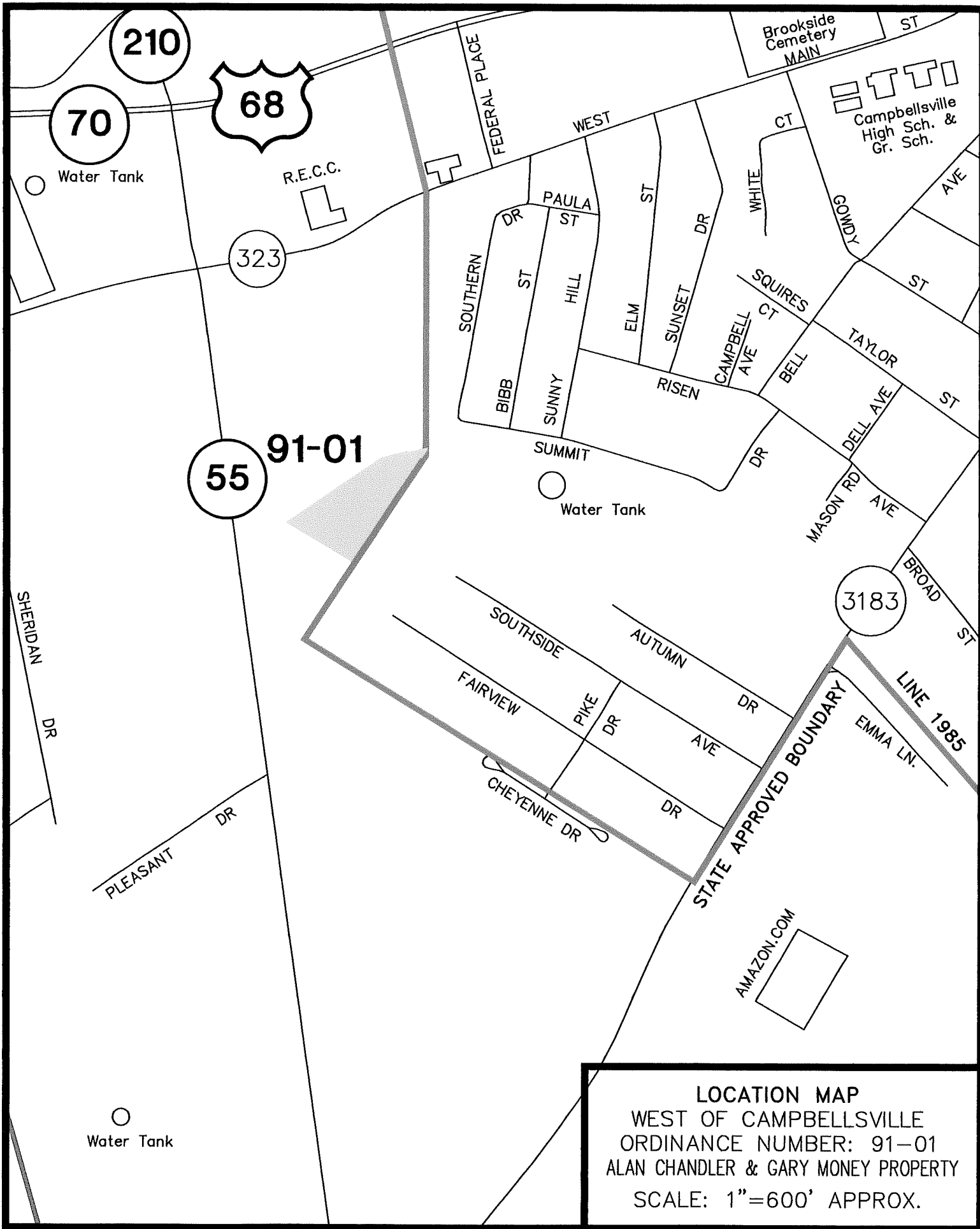

OVERSIZE MAP INCLUDED WITH
SUBMISSION.

To research the map, contact the
Office of Secretary of State
or the County Clerk.