

**AN ORDINANCE ANNEXING INTO THE CORPORATE BOUNDARIES OF THE CITY OF CAMPBELLSVILLE, KENTUCKY, CERTAIN TRACTS OR PARCELS OF LAND LYING ON WEST MAIN STREET BELONGING TO MOORMAN BEARD AND HIS WIFE, BETTY JO BEARD, AND ~~HIS WIFE, BETTY JO BEARD, AND W.C. WARREN.~~**

WHEREAS, the City of Campbellsville has heretofore proposed an Ordinance to annex the within described area, said Ordinance being read on the 7th day of March, 1988; and the 21st day of March, 1988; and thereafter said proposed Ordinance annexing the within described property having been advertised in toto in the Central Kentucky News Journal on the 9th day of June, 1988.

NOW, THEREFORE, BE IT ORDAINED BY THE CITY COUNCIL OF THE CITY OF CAMPBELLSVILLE, KENTUCKY AS FOLLOWS:

Pursuant to the provisions of KRS Chapter 81A, the City Council of the City of Campbellsville, Kentucky, does hereby annex into the corporate boundaries of the City of Campbellsville, Kentucky, the hereinafter described properties, and further the City Council does hereby declare that the annexation is desirable to the needs of the City of Campbellsville, Kentucky; does further state that the area to be annexed is urban in character and that prior to the annexation it was an unincorporated territory.

The land hereby annexed is described as follows:

Beginning at a concrete right of way marker on the North side of West Main Street and corner to W.C. Warren; thence with the North right-of-way of West Main Street S 71 deg. 30 min. W 118.0 feet to a P.K. nail corner to Norman and Bonnie Sullivan; thence with Sullivan N 21 deg. 30 min. W 248.0 feet to an iron pipe corner to Sullivan in the line of Union Underwear; thence with Union Underwear N 70 deg. 30 min. E 118.0 feet to a steel rod; thence with Union Underwear and then the line of W.C. Warren S 21 deg. 30 min. E 250.0 feet to the beginning and containing 0.67 acres by this description.

A certain tract or parcel of land lying and being in Taylor County, Kentucky, and being further described as follows: Beginning at an iron stake, corner to the Ashland Oil Co., and in the line of the Union Underware Company, thence with the line of Ashland Oil Company, S 20-3/4 E 188 feet to a stake, corner to the Ashland Oil Company, and on the north side of State Highway #68, thence with the line of said highway, S 69 1/2 W 129 feet to an iron stake; thence N 24 W 189 feet to a stake, corner to Union Underware Company; thence with their line N 69 1/2 E 140 feet to the beginning.

This property is hereby zoned B-2.

This Ordinance was introduced and given a first reading and passage at a regular meeting of the City Council held on the 15th day of August, 1988; it received its second reading, passage and became effective at a regular meeting of the City Council held on the 6th day of September, 1988.

ATTEST:

  
DONALD GAINES, City Clerk

  
ROBERT L. MILLER, Mayor

**CERTIFICATION  
KRS 81A.470 FILINGS**

I certify I am the duly qualified City Clerk of the City of Campbellsville, Kentucky, and the foregoing Ordinance #88-10 dated September 6<sup>th</sup>, 1988, is a true, correct and complete copy duly adopted by the City Council at a duly convened meeting held on September 6<sup>th</sup>, 1988 all as appears in the official records of said City.

WITNESS, my hand and seal, this 13th day of December, 2010.

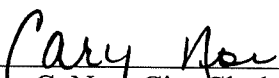
  
\_\_\_\_\_  
Cary C. Noe, City Clerk

SEAL

**RECEIVED AND FILED**  
DATE December 20, 2010  
\_\_\_\_\_  
\_\_\_\_\_  
**TREY GRAYSON**  
**SECRETARY OF STATE**  
**COMMONWEALTH OF KENTUCKY**  
BY Tiffany Turner

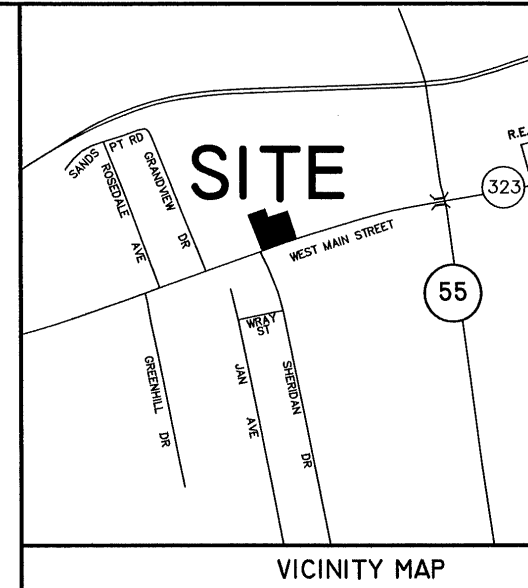
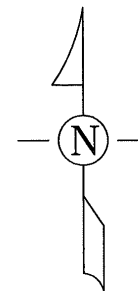

NOTE:  
THIS PLAT IS FOR ANNEXATION PURPOSES

ANNEXATION MAP  
(NOT FOR LAND TRANSFER)  
**ORDINANCE 88-10**  
CITY OF CAMPBELLSVILLE  
TAYLOR COUNTY, KENTUCKY

SCALE: 1 INCH = 50 FEET

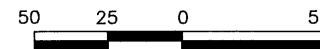

GRAPHIC SCALE

PREPARED BY

**MILLER LAND SURVEYING, INC.**  
ROBERT L. MILLER, JR.  
110 E. FIRST STREET  
CAMPBELLSVILLE, KY 40201  
PHONE: (270) 465-2800  
FAX: (270) 465-4740

#### CERTIFICATION

I hereby certify that this plat was prepared by me or under my direct supervision. The information shown hereon was prepared using the following sources: Deed Book 162, Page 533 and Deed Book 76, Page 449 all in the Taylor County Clerk's office.

This plat is not a boundary survey and is not to be used for land transfer. This plat is for annexation purposes only.

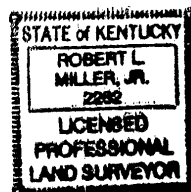

Robert L. Miller, Jr., Surveyor  
Kentucky 2282

6-29-10

Date