



# Kentuckiana Regional Planning and Development Agency

914 EAST BROADWAY  
LOUISVILLE, KENTUCKY 40204

PHONE  
(502) 589-4406

May 13, 1981

Ms. Libby Horn  
Land Office  
Office of the Secretary of State  
Capital Building  
Frankfort, Kentucky 40601

RECEIVED  
MAY 14 1981  
SECRETARY OF STATE  
COMMONWEALTH OF KY.

Dear Ms. Horn:

On behalf of the City of Crossgate, I hereby submit information in compliance with KRS 81.045.

Sincerely,

Sue Duvall  
Public Administration Specialist

SD/kh

Enclosure

cc: File

*Jefferson County*

*enc. Dec. 3, 1968*

*6th Class*

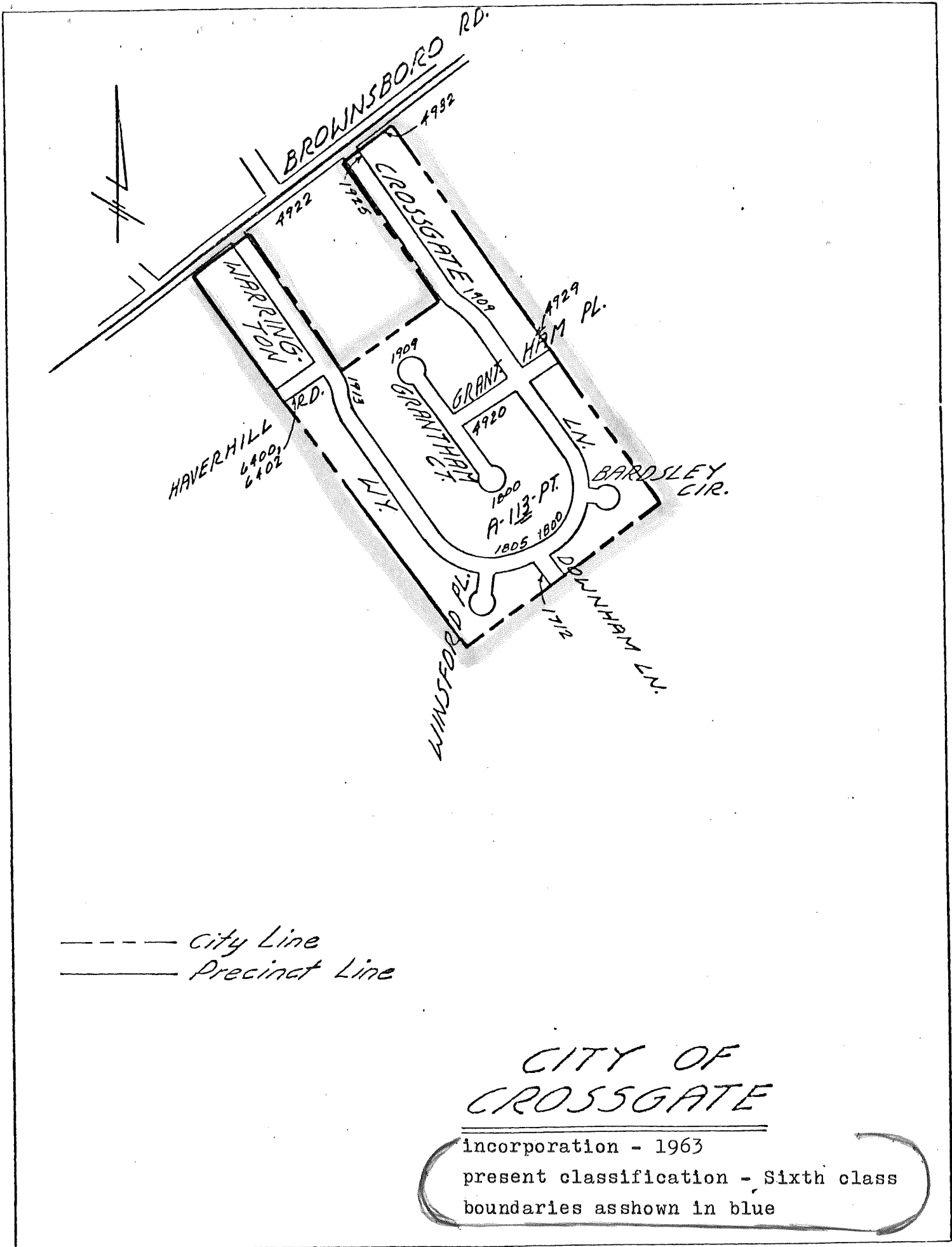

- - - - - City Line  
 \_\_\_\_\_ Precinct Line

## CITY OF CROSSGATE

incorporation - 1963  
 present classification - Sixth class  
 boundaries as shown in blue

Scale: 1" = 500'  
 Drawn: 2-13-80