

ORDINANCE NO. 10-16-89-1

ORDINANCE DECLARING INTENT TO ANNEX

WHEREAS, there has been a continual development of property in Eddyville, Kentucky; and

WHEREAS, a certain area outside the city hereinafter described is now joined on two sides and is contiguous with the City of Eddyville and is bounded on the south by the West Kentucky Parkway and on the east by Riley Road; and

WHEREAS, said hereinafter described property is suitable for development for city purposes without unreasonable delay; and

WHEREAS, it is desirable and necessary for the consistent well-ordered growth of the City of Eddyville, Kentucky, that the herein described property be annexed and brought into the City of Eddyville; and

WHEREAS, a public hearing has been conducted by the Lyon County Joint Planning Commission and its recommendations made to the City of Eddyville concerning the appropriate zoning of the property proposed to be annexed;

BE IT HEREBY ORDAINED AND ESTABLISHED in accordance to KRS 81A.420 that the hereinafter described property is intended to be annexed by the City of Eddyville, Kentucky.

All of that area not already in the city limits of Eddyville, Kentucky, west of Riley Road, (same road as Reiley Road) bounded on the north and west by the City of Eddyville, Kentucky, and south by the West Kentucky Parkway, and being all that area outlined in blue on the attached copy of the pertinent portion of the official map of the City of Eddyville, Kentucky, said map as well as the proposed area highlighted in blue and which is intended to be annexed being now posted for public examination at the Eddyville City Hall, Commerce Street, Eddyville, Kentucky, from 8:00 a.m. to 4:00 p.m., Monday through Friday.

The zoning classifications proposed by the Lyon County Joint Planning Commission are approved and are given to the annexed property as follows:

1. Property owned by Jent Company be zoned Planned Unit Development--Residential.
2. Property owned by others (Sutton, Harper, Willet, Butler, and Second Baptist Church) be zoned R-2, which conforms to adjoining city limits.

This ordinance declaring intent to annex shall become effective upon the second reading and appropriate publication in accordance to law, all in compliance with KRS 81A.420.

1st Reading October 16, 1989

2nd Reading Nov 1, 1989

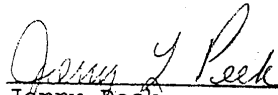
  
\_\_\_\_\_  
Jerry Peek  
Mayor

ATTEST:

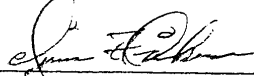
  
\_\_\_\_\_  
Irvin Gilson  
City Clerk

RESOLUTION

WHEREAS, the City of Eddyville, Kentucky, intends to annex the hereinafter described territory into the City of Eddyville, Kentucky; and

WHEREAS, zoning classification is required to be included in any ordinance of intent to annex;

BE IT RESOLVED that the Lyon County Joint Planning Commission is hereby requested to make recommendation as to zoning of the hereinafter described property, after a public hearing and other procedures required by law.

The property is as follows: All that area not already in the city limits of Eddyville, Kentucky, west of Reiley Road, bounded on the north and west by the City of Eddyville, Kentucky, and south by the West Kentucky Parkway, and being all that area outlined in blue on the attached extract from the City of Eddyville, Kentucky official city map.

This 18 day of September, 1989.

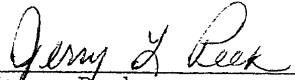
  
\_\_\_\_\_  
Jerry Peek  
Mayor

ATTEST:

  
\_\_\_\_\_  
Irvin Gilson

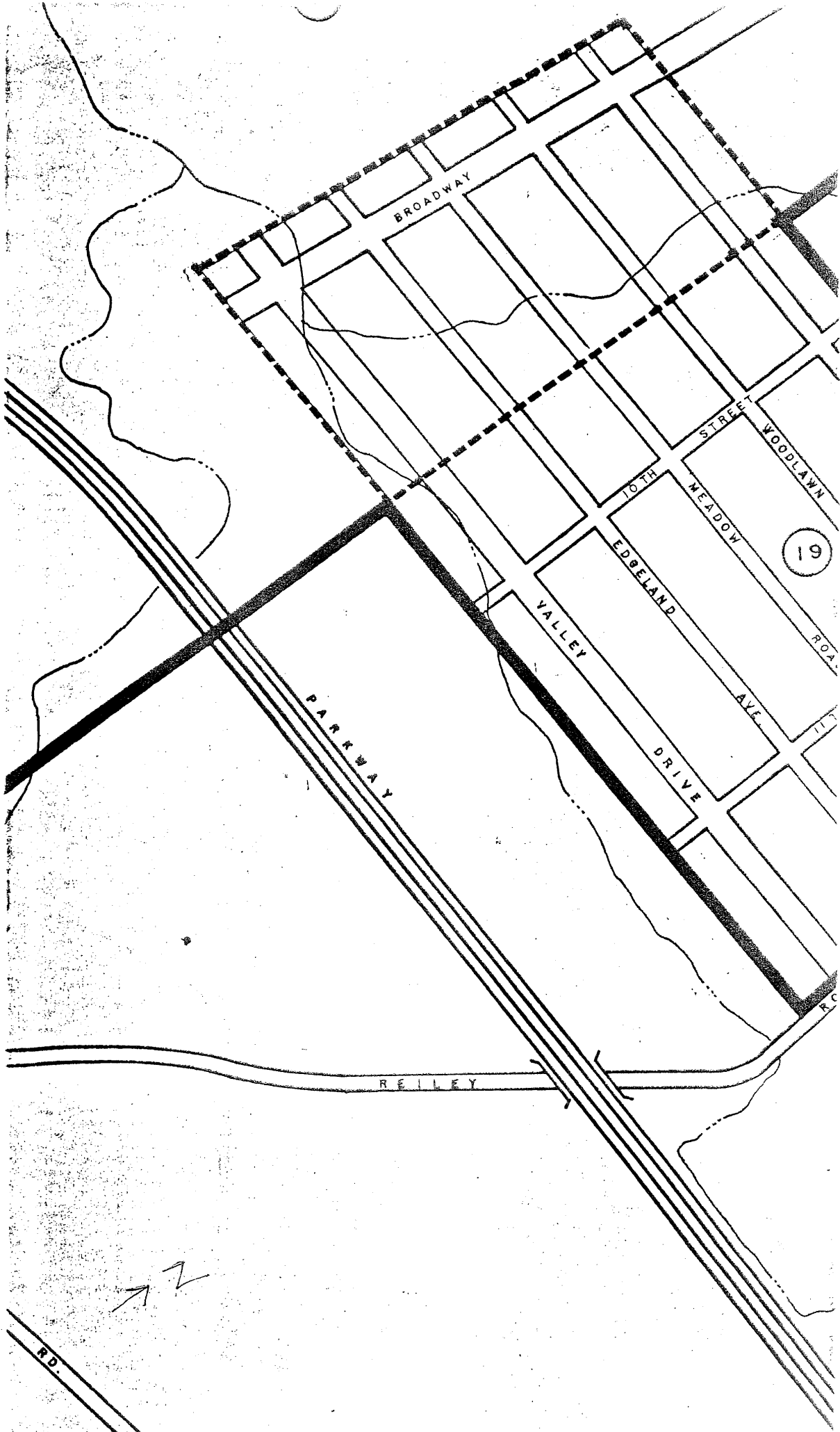

BROADWAY

10TH

EDGELAND

VALLEY

DRIVE

AVE

MEADOW

STREET

WOODLAWN

19

PARKWAY

REILEY

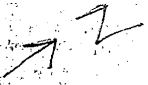

RD.