

**CERTIFICATION**

I, the undersigned, Mary Chaudoin, do hereby certify that I am the duly qualified and acting City Clerk of the City of Elizabethtown, Kentucky, and as such Clerk I further certify that the attached is a true, correct and complete copy of Ordinance No. 1 - 1999 series duly adopted by the City Council of said City at a duly convened meeting held on Jan 4, 1999 and thereafter signed by the Mayor as evidence of his approval, and now in full force and effect, all as appear from the official records of said City Council in my possession and under my control.

WITNESS my hand and Seal of the City, as of this 15<sup>th</sup> day of February, 2002.

Mary Chaudoin  
CITY CLERK

(Seal of the City)

RECEIVED AND FILED  
DATE March 1, 2002  
JOHN Y. BROWN III  
SECRETARY OF STATE  
COMMONWEALTH OF KENTUCKY  
BY K. Adkinson

RECEIVED AND FILED  
DATE March 1, 2002  
JOHN Y. BROWN III  
SECRETARY OF STATE  
COMMONWEALTH OF KENTUCKY  
BY K. Adkinson

ORDINANCE NO. 1 - 1999

**AN ORDINANCE OF THE CITY OF ELIZABETHTOWN, KENTUCKY, ANNEXING  
PENCE LEASING AND CONSTRUCTION PROPERTY LOCATED ON SOUTH WILSON  
ROAD**

WHEREAS, the City of Elizabethtown, Kentucky, pursuant to KRS 81A.412 has received prior written consent of each owner of record of the land to be annexed, said written consent is attached hereto and made a part hereof as Exhibit "A", and

BE IT ORDAINED by the City of Elizabethtown that from and after the passage, approval, and publication of this Ordinance, that the City of Elizabethtown hereby annexes the following described real estate into the City of Elizabethtown Kentucky for all legal purposes.

IT IS HEREBY FOUND that the real estate below is adjacent to and contiguous to the City's boundaries at the time the annexation proceeding is begun and which by reason by population density, commercial, industrial, institutional or governmental use of land or subdivision of land, is urban in character and suitable for development for urban purposes without unreasonable delay. It is further found that no part of the area proposed to be annexed hereby, is included within the boundary of another incorporated city.

The real estate that the City of Elizabethtown, Kentucky is annexing hereby into the City is more particularly described as set out in Exhibit "B" attached hereto and made a part hereof.

Attached hereto and made a part hereof is the map of the area being annexed into the City of Elizabethtown, Kentucky, as Exhibit "C".

Based upon a recommendation from the Elizabethtown Planning and Zoning Commission and after a hearing on December 8, 1998, upon annexation, this property shall be zoned as Residential-1

(R-1).

BE IT FURTHER ORDAINED that the Mayor of the City of Elizabethtown and/or his designatee be and he is authorized and directed to take all steps necessary to perfect this Ordinance.

READ THE FIRST TIME this 21ST day of DECEMBER, 1998.

READ, ADOPTED AND APPROVED this 4TH day of JANUARY, 1999.

  
MAYOR, DAVID WILLMOTH, JR.

ATTESTED TO:

  
MARY CHAUDOIN, CITY CLERK

ORDINANCE NO. 1 - 1999, EXHIBIT A

**HOWARD W. PENCE, INC.**  
**P. O. Box 2005**  
**Building 4031, Highway 31W**  
**Elizabethtown, Kentucky 42701**  
**ph. 502-737-8723 fax 502-765-5713**

October 5, 1998

Ed Poppe  
City Planner  
Elizabethtown, Kentucky 42701

Dear Mr. Poppe:

Request is respectfully made that a certain parcel of land, as described in the attached deed and plat (deed book 796, page 428) be annexed into the City of Elizabethtown.

Sincerely,

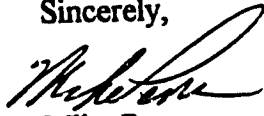
  
Mike Pence

enclosures: deed  
Plat

ORDINANCE NO. 1 - 1999, EXHIBIT B

LEGAL DESCRIPTION

Subject property being located on the west right-of-way of Wilson Road (KY 447) in Elizabethtown approximately 0.3 miles north of its intersection with U.S. 31-W (Dixie Highway) in Hardin County, Kentucky and being more particularly bounded and described as follows:

Beginning at an existing T-bar on the west right-of-way of Wilson Road (KY 447), a corner to Brown (DB 763 Pg 727); Thence with said right-of-way, S35-46-34E 667.55' to a set pin a corner to Wise (DB 404 Pg 118); Thence with the line of Wise, S54-05-58W 237.69' to an existing wood post; Continuing, S33-54-34W 379.71' to an existing pin a corner to Pendleton (DB 586 Pg 198); thence with the line of Pendleton, N60-19-06W 1043.17' to an existing pin a corner to Cox (DB 691 Pg 316); Thence with the line of Cox, Bethel Baptist (DB 358 Pg 116) and Brown (DB 763 Pg 727), N62-28-49E 1037.84' to the beginning. Subject tract containing 14.6381 acres per survey by G Sturner & Associates.

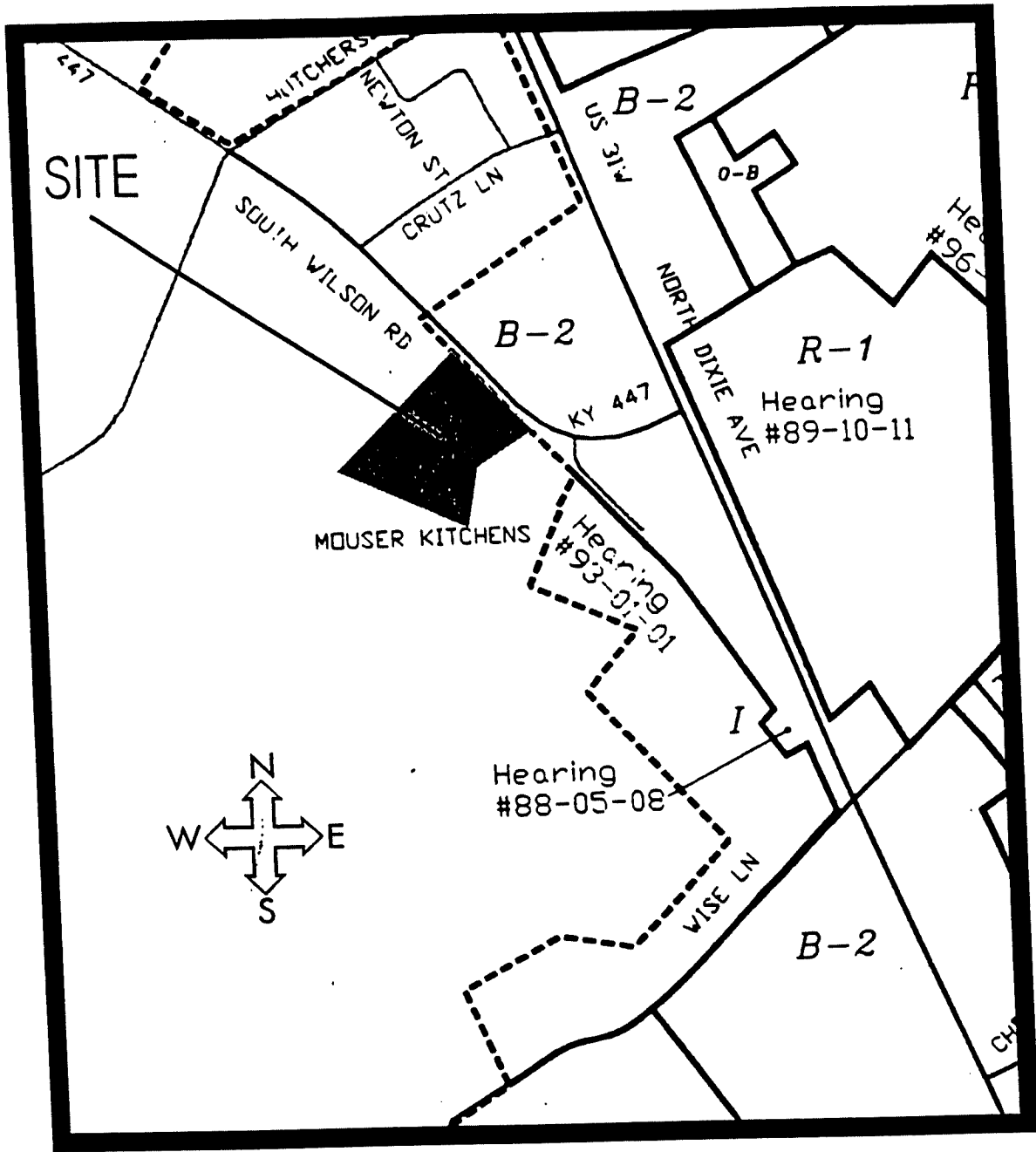

VICINITY MAP  
NO SCALE

# PENCE PROPERTY ANNEXATION RESIDENTIAL-1 (R-1) PROPOSED