

**Georgetown Annexation
 Information**

TREY GRAYSON
 SECRETARY OF STATE
 COMMONWEALTH OF KENTUCKY
 BY Janice Adkinson

Year	Acreage	Ordinance Number	Comments
1951	37.2	609	
1955	83	724	Ord 724 Amended Ord 723
1956	48.7	733	
1957	26.1	767	
1957	18.6	769	
1957	*	776	*Adoption of proposed annexation 769
1959	118.4	812	
1959	74.3	819	
1959	*	824	*Adoption of proposed annexation 819
1960	95	853	
1960	67.5	855	
1961	*	863B	*Adoption of proposed annexation 855
1963	116.4	910	
1963	*	911	*Adoption of proposed annexation 910
1968	2	1010	
1968	*		*Adoption of proposed annexation 1010
1970	102	1044	
1970	*		*Adoption of proposed annexation 1044
1973	334.5	1096	
1973	*		*Adoption of proposed annexation 1096
1974	722.3	1116	
74 - '75	*		*Adoption of proposed annexation 1116
1977	172.5	77-004	
1977	*		*Adoption of proposed annexation 77-004
1977	50.3	77-013	
1977	*	77-014	*Identical to 77-004
1977	*		*Adoption of proposed annexation 77-013
1977	*		*Adoption of proposed annexation 77-014
1978	59	78-002	
1978	*		*Adoption of proposed annexation 78-002
1979	50.5	79-001	
1979	*		*Adoption of proposed annexation 79-001
1981	72.4	81-011	
1982	*		*Adoption of proposed annexation 81-011 (K)
1983	46	83-001 ⁸³⁻⁰⁰⁵ Truck Parking	
1983	*	83-010	*Adoption of proposed annexation 83-001
1987	1946.9	87-004	*1983 by deed - 1946.9 by survey (see 87-006)
1987	*	87-006	*Adoption of proposed annexation 87-004
1987		87-017	
1987	10.9	87-018	
1988	*	88-005	*Repealed 87-017
1988	*	88-007	*Adoption of proposed annexation 88-005
1988	*	88-009	*Adoption of proposed annexation 87-018
1988	*	454.8 88-010	*Adoption of proposed annexation 88-005
1988	13.1	88-027	
1988	*	88-029	*Adoption of proposed annexation 88-027

City of Georgetown

GEORGETOWN, KENTUCKY

SUE LEWIS, CITY CLERK

CERTIFICATION: KRS 81A.470 FILINGS

I certify I am the duly qualified City Clerk of the City of Georgetown, Kentucky,
and the foregoing 8 pages of Ordinance No. 88-027 is a true, correct and
complete copy duly adopted by the City Commission at a duly convened meeting held on
October 31, 1988, all as appears in the official records of said City.

WITNESS, my hand and Seal of the City of Georgetown, this 18th day of
October, 2005.



Sue Lewis
Signature of City Clerk

CITY OF GEORGETOWN
ORDINANCE NO. 88-027

AN ORDINANCE STATING THE INTENTION OF THE CITY OF
GEORGETOWN TO ANNEX CERTAIN UNINCORPORATED TERRITORY
TO THE CITY OF GEORGETOWN.

WHEREAS, there is certain unincorporated real property contiguous and adjacent to the City of Georgetown which is located south of Highland Court and along the eastern boundary of Indian Hills Subdivision, which is more particularly described herein; and,

WHEREAS, said unincorporated property is surrounded by residential development, and due to population density, said land is urban in character and is suitable for development for urban purposes without unreasonable delay; and,

WHEREAS, the Georgetown-Scott County Planning and Zoning Commission, after a public hearing, has recommended that the subject unincorporated territory be assigned the zone classifications of R-1A for 10.376 acres and R-2 for 2.73 acres; and

WHEREAS, no part of the area proposed to be annexed is included within the boundary of another incorporated city;

NOW, THEREFORE, BE IT ORDAINED by the City of Georgetown, as follows:

Section One: That it is deemed desirable and is hereby proposed to annex to the City of Georgetown, Kentucky (hereinafter the City) thereby extending the boundaries of the City to include that certain tract of land which is now embraced within the County of Scott, and which is adjacent to and contiguous with the present

city boundary and which, by reason of population density, use and proposed use, is urban in character, and suitable for immediate development for urban purposes without unreasonable delay, and which tract is more particularly described as follows:

A tract of land lying within the city of Georgetown, Scott County, Kentucky.

Beginning in the southern line of Highland Court; thence along the eastern line of Indian Acres Subdivision S 02 30 01 W 1355.41 feet to a fence corner; thence N 89 36 57 E 333.23 feet; thence N 02 55 06 E 631.29 feet; thence N 01 55 38 E 291.15 feet to an iron bar corner; thence N 02 30 01 E 419.95 feet to a point in the south line of Highland Court; thence with same N 88 08 08 W 334.52 feet to the beginning. Containing 10.376 acres.

and;

A tract of land lying within the City of Georgetown, Scott County, Kentucky.

From a point in the southern line of Highland Court, the northeast corner of the Hambrick property (formerly), and along line of same S 02 30 01 W 419.95 feet to the beginning; thence S 87 28 54 E 355.13 feet; thence S 01 56 44 W 83.43 feet; thence S 87 39 29 E 200.00 feet to a set iron bar; thence S 01 50 13 W 75.00 feet to a set iron bar; thence N 87 39 26 W 200.00 feet; thence S 01 50 13 W 135.49 feet; thence N 87 02 09 W 355.48 feet; thence N 01 55 38 E 291.15 feet to the beginning. Containing 2.73 acres.

Basis of the above bearings from previous survey of adjoining property for Billy Vance.

SECTION TWO: After a public hearing, the Georgetown-Scott County Planning and Zoning Commission recommended that the proposed land to be annexed be assigned the zone classification of R-1A for 10.376 acres and R-2 for 2.73 acres as shown on the exhibit attached hereto, and incorporated herein by reference.

SECTION THREE: This Ordinance shall become effective upon its passage and publication.

WHEREUPON, the foregoing Ordinance was read for the first time on October 12, 1988, read for the second time, passed and approved on October 25, 1988.

Publication date: 10-31-88

GEORGETOWN CITY COUNCIL

By: Tom Prather

Tom Prather, Mayor

Attest:

Glenwood C. Williams
Glenwood C. Williams,
Georgetown City Clerk

EXHIBIT

PROPOSED ZONING FOR ANNEXED TERRITORY



**

** (ANNEXED TERRITORY)

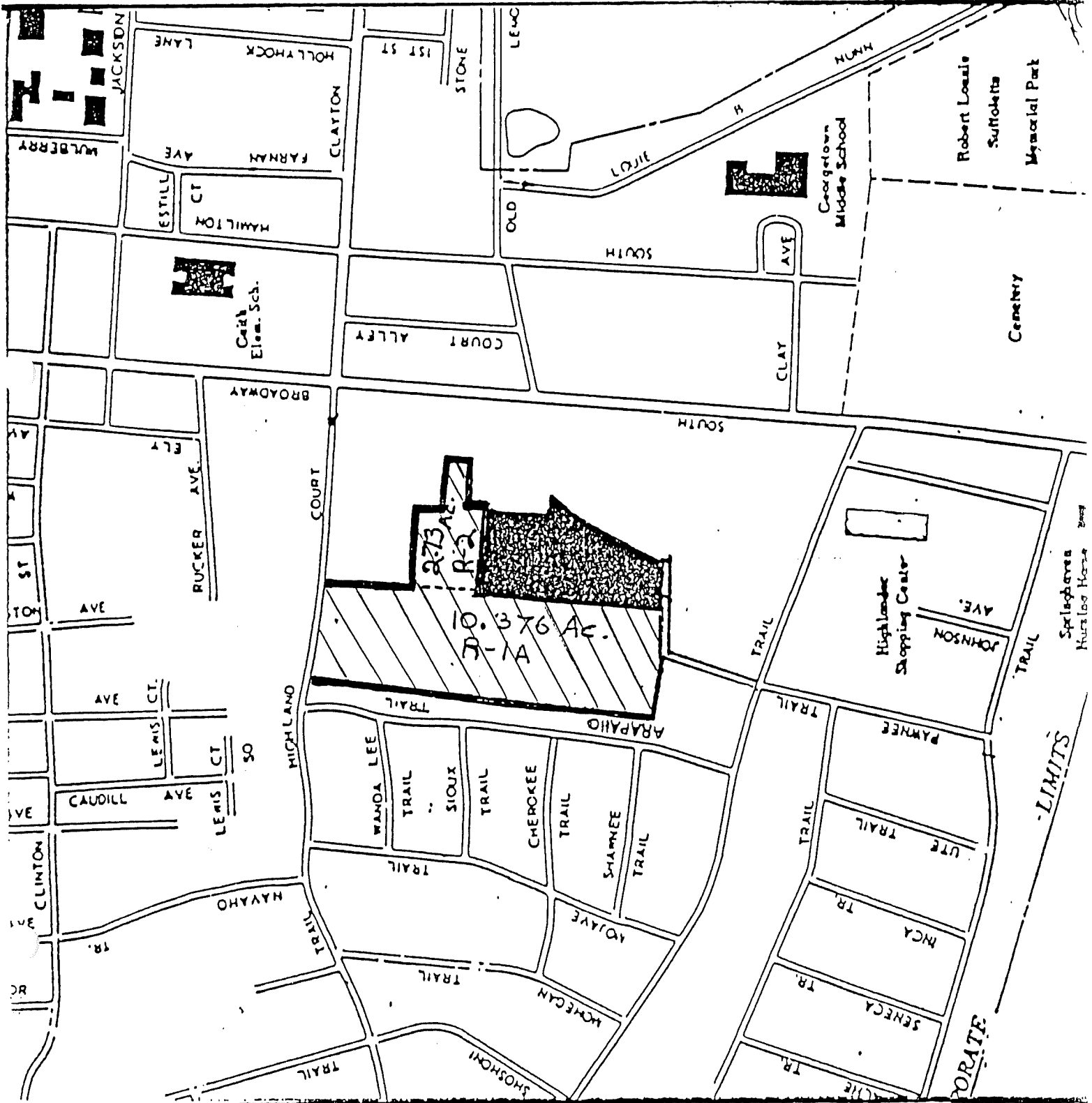

IN WITNESS WHEREOF, the Party, acting by and through its duly authorized agent pursuant to authority granted to him by the remaining partners has executed this Consent to Annexation this 26 day of October, 1988.

MARCUM, MURPHY AND VANCE,
a Kentucky General Partnership

By:

Billy F. Vance, Partner

ACKNOWLEDGEMENT

Acknowledged before me, this 26 day of October, 1988, by Billy F. Vance, partner and authorized agent for Marcum, Murphy and Vance, a Kentucky general partnership.

NOTARY PUBLIC

MY COMMISSION EXPIRES:

May 19, 1991

CONSENT TO ANNEXATION

THIS CONSENT TO ANNEXATION made by Marcum, Murphy and Vance, a Kentucky general partnership, by and through its authorized partner, Billy F. Vance, (hereinafter called the "Party").

PREAMBLE: The Georgetown City Council has expressed its desire and intent to annex certain unincorporated territory located in Scott County, Kentucky, through the adoption of Ordinance 88-027. The Party is the Owner in fee simple of the real property to be annexed pursuant to Ordinance 88-027, said property being more particularly described in the Exhibit attached hereto.

The Party now desires to unilaterally and unconditionally consent to the annexation by the City of Georgetown of the unincorporated territory which is more fully described in the attached exhibit.

NOW, THEREFORE, the Party hereby consents, pursuant to KRS 81A.500, to the annexation by the City of Georgetown of that certain unincorporated territory which is depicted on the map attached hereto and which is particularly described in the attached Description.

The Party further agrees that the City of Georgetown may enact an ordinance annexing the subject real property to the City of Georgetown. The Party further covenants and agrees that it will not sue the City of Georgetown or any of its officers, agents, employees or representatives or prosecute any action to which the City of Georgetown or any City officer, agent, employee or representative is a party for or on account of the annexation of the subject property and that it hereby waives the requirements for annexation.

EXHIBIT

LEGAL DESCRIPTION FOR PROPOSED ANNEXATION TERRITORY

A tract of land lying within the city of Georgetown, Scott County, Kentucky.

Beginning in the southern line of Highland Court; thence along the eastern line of Indian Acres Subdivision S 02 30 01 W 1355.41 feet to a fence corner; thence N 89 36 57 E 333.23 feet; thence N 02 55 06 E 631.29 feet; thence N 01 55 38 E 291.15 feet to an iron bar corner; thence N 02 30 01 E 419.95 feet to a point in the south line of Highland Court; thence with same N 88 08 08 W 334.52 feet to the beginning. Containing 10.376 acres.

and;

A tract of land lying within the city of Georgetown, Scott County, Kentucky.

From a point in the southern line of Highland Court, the northeast corner of the Hambrick property (formerly), and along line of same S 02 30 01 W 419.95 feet to the beginning; thence S 87 28 54 E 355.13 feet; thence S 01 56 44 W 83.43 feet; thence S 87 39 29 E 200.00 feet to a set iron bar; thence S 01 50 13 W 75.00 feet to a set iron bar; thence N 87 39 26 W 200.00 feet; thence S 01 50 13 W 135.49 feet; thence N 87 02 09 W 355.48 feet; thence N 01 55 38 E 291.15 feet to the beginning. Containing 2.73 acres.

Basis of the above bearings from previous survey of adjoining property for Billy Vance.

