

RECEIVED AND FILED
 DATE November 2, 2005

**Georgetown Annexation
 Information**

TREY GRAYSON
 SECRETARY OF STATE
 COMMONWEALTH OF KENTUCKY
 BY Gardie Adkinson

Year	Acreage	Ordinance Number	Comments
1951	37.2	609	
1955	83	724	Ord 724 Amended Ord 723
1956	48.7	733	
1957	26.1	767	
1957	18.6	769	
1957	*	776	*Adoption of proposed annexation 769
1959	118.4	812	
1959	74.3	819	
1959	*	824	*Adoption of proposed annexation 819
1960	95	853	
1960	67.5	855	
1961	*	863B	*Adoption of proposed annexation 855
1963	116.4	910	
1963	*	911	*Adoption of proposed annexation 910
1968	2	1010	
1968	*		*Adoption of proposed annexation 1010
1970	102	1044	
1970	*		*Adoption of proposed annexation 1044
1973	334.5	1096	
1973	*		*Adoption of proposed annexation 1096
1974	722.3	1116	
74 - '75	*		*Adoption of proposed annexation 1116
1977	172.5	77-004	
1977	*		*Adoption of proposed annexation 77-004
1977	50.3	77-013	
1977	*	77-014	*Identical to 77-004
1977	*		*Adoption of proposed annexation 77-013
1977	*		*Adoption of proposed annexation 77-014
1978	59	78-002	
1978	*		*Adoption of proposed annexation 78-002
1979	50.5	79-001	
1979	*		*Adoption of proposed annexation 79-001
1981	72.4	81-011	
1982	*		*Adoption of proposed annexation 81-011 (K)
1983	46	83-001 83-005 Truck Parking	
1983	*	83-010	*Adoption of proposed annexation 83-001
1987	1946.9	87-004	*1983 by deed - 1946.9 by survey (see 87-006)
1987	*	87-006	*Adoption of proposed annexation 87-004
1987		87-017	
1987	10.9	87-018	
1988	*	88-005	*Repealed 87-017
1988	*	88-007	*Adoption of proposed annexation 88-005
1988	*	88-009	*Adoption of proposed annexation 87-018
1988	*	88-010	*Adoption of proposed annexation 88-005
1988	13.1	88-027	
1988	*	88-029	*Adoption of proposed annexation 88-027

City of Georgetown

GEORGETOWN, KENTUCKY

SUE LEWIS, CITY CLERK

CERTIFICATION: KRS 81A.470 FILINGS

I certify I am the duly qualified City Clerk of the City of Georgetown, Kentucky,
and the foregoing 4 pages of Ordinance No. 96-028 is a true, correct and
complete copy duly adopted by the City Commission at a duly convened meeting held on
February 5, 1997, all as appears in the official records of said City.

WITNESS, my hand and Seal of the City of Georgetown, this 18th day of
October, 2005.



Sue Lewis
Signature of City Clerk

CITY OF GEORGETOWN
ORDINANCE NO. 96-028

AN ORDINANCE RELATING TO THE ANNEXATION OF CERTAIN PROPERTY LYING CONTIGUOUS TO THE NORTH BOUNDARY OF THE CITY OF GEORGETOWN AND CONTAINING 80.86 GROSS ACRES (78.86 NET) ACRES.

WHEREAS, the owner of the property described in Exhibit A, which is attached hereto and incorporated by reference herein, has requested that the property be annexed to the City of Georgetown; and

WHEREAS, all property owners in the proposed annexation area have consented to the proposed annexation pursuant to KRS 81A.412, copy of said consent having been made part of the record in this matter and available for review with the minutes of this meeting; and

WHEREAS, the property is contiguous to the existing city limits and, having urban character and suitability for further urban development, is appropriate for annexation to the City of Georgetown and meets all the requirements of KRS 81A.410; and

WHEREAS, pursuant to KRS 81A.412, the property is appropriate for immediate annexation.

NOW, THEREFORE, BE IT ORDAINED BY THE CITY OF GEORGETOWN:

Section 1 - Purpose. The property described in the attached exhibit is urban in character, is suitable for further urban land use development without unreasonable delay, and is contiguous to the existing city limits of the City of Georgetown. It is, therefore, desirable to annex this property to the City of Georgetown, extending the boundaries of the city to include this property.

Section 2 - Annexation. The property described in the attached exhibit is hereby annexed into the City of Georgetown, the property owners, having consented to said annexation, said consent to be filed with the minutes of the Georgetown City Council meeting of October 17, 1996.

Section 3 - Zone Classification. The annexation of this property shall not affect its zoning classification.

Section 4 - Effective Date. This Ordinance shall become effective upon publication.

WHEREUPON, the foregoing Ordinance was read for the first time October 17, 1996, read for the second time, passed and approved on the 7th day of November, 1996.

APPROVED:

BY: Alan Powers
MAYOR

ATTEST:

Glennwood L. Williams
CITY CLERK

361\whitaker\ordlnance.001

Published February 5, 1997

WHITAKER LAND COMPANY, LTD. PROPERTY
THOROUGHbred ACRES
CHAMPION WAY
GEORGETOWN, SCOTT COUNTY, KENTUCKY

Beginning at a point, said point being the intersection of the centerline of Champion Way and the extension of the northern property line of Lot 12 as recorded on the final record plat of Unit 1 of the Whitaker Property (Thoroughbred Acres) located in Scott County, Kentucky, Plat #1576; thence with said property line S 27° 36' 51" W, 277.58 feet to a point in the line with Jones; thence with Jones N 47° 45' 25" W, 579.92 feet to a point lying on the eastern right of way of Turkey Foot Road; thence with said right of way N 47° 28' 02" W, 49.37 feet to a point on the western right of way of Turkey Foot Road; thence leaving said right of way with the western line of Whitaker N 18° 35' 07" W, 252.44 feet to a point; thence S 69° 55' 58" W, 163.17 feet to a point; thence N 33° 51' 30" W, 196.29 feet to a point; thence N 52° 53' 05" W, 161.80 feet to a point; thence N 73° 19' 05" W, 135.60 feet to a point; thence N 86° 42' 38" W, 173.75 feet to a point; thence S 76° 58' 56" W, 143.49 feet to a point; thence S 62° 05' 03" W, 108.81 feet to a point; thence leaving said property line N 29° 18' 02" W, 190.00 feet to a point; thence N 47° 26' 14" W, 519.15 feet to a point; thence N 37° 25' 54" E, 1350.00 feet to a point in the centerline of Champion Way (Future); thence with the said centerline S 20° 23' 09" E, 120.00 feet to a point; thence leaving said centerline S 82° 56' 40" E, 750.00 feet to a point; thence S 67° 28' 01" E, 892.20 feet to a point in the Interstate 75 right of way; thence leaving said right of way N 73° 31' 59" E, 145.00 feet to a point in the centerline of Interstate 75; thence with the centerline of Interstate 75 S 16° 52' 34" E, 595.10 feet to a point; thence leaving said centerline S 72° 52' 04" W, 145.00 to a point of the Interstate 75 right of way; thence leaving said right of way S 26° 17' 22" W, 280.00 feet to a point; thence S 26° 17' 22" W, 295.85 feet to a point; thence S 26° 10' 03" W, 271.64 feet to a point; thence S 26° 10' 11" W, 276.24 feet to a point; thence S 27° 36' 52" W, 56.53 feet to the POINT OF BEGINNING and containing square or 80.86 acres gross, and 78.86 acres net.



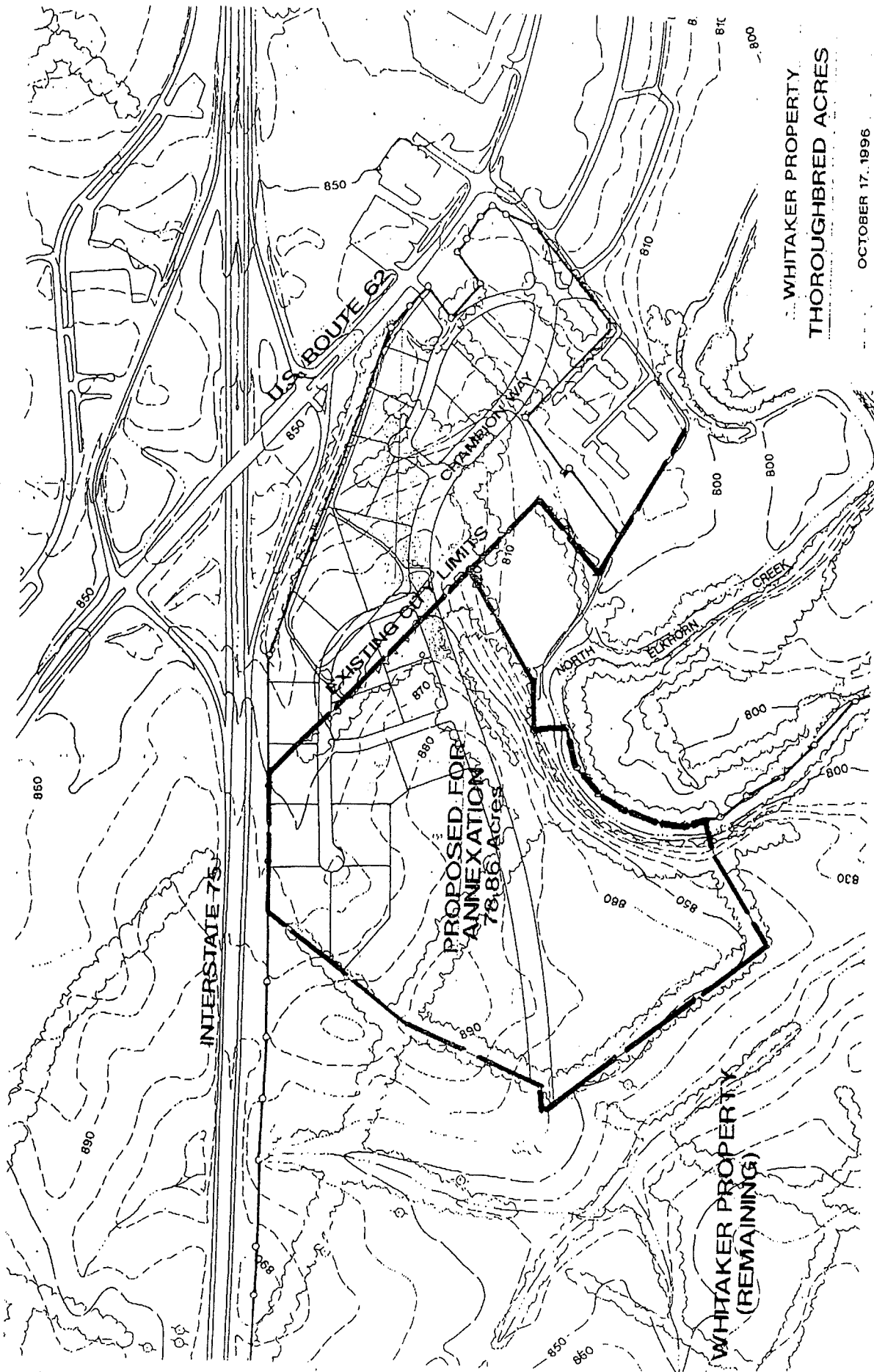

WHITAKER PROPERTY
THOROUGHbred ACRES

OCTOBER 17, 1996

PROPOSED FOR
ANNEXATION
78.86 Acres

WHITAKER PROPERTY
(REMAINING)

STOLL, KEENON & PARK, LLP

ROBERT F. HOULIHAN
LESLIE W. MORRIS II
LINDSEY W. INGRAM, JR.
WILLIAM L. MONTAGUE
BENNETT CLARK
SPENCER D. NOE
WILLIAM T. BISHOP III
JOSEPH M. SCOTT, JR.
RICHARD C. STEPHENSON
CHARLES E. SHIVEL, JR.
ROBERT M. WATT III
J. PETER CASSIDY, JR.
SAMUEL D. HINKLE IV**
R. DAVID LESTER
ROBERT F. HOULIHAN, JR.
WILLIAM M. LEAR, JR.
GARY L. STAGE
HERBERT A. MILLER, JR.
GARY W. BARR
DONALD P. WAGNER
DOUGLAS P. ROMAINE
FRANK L. WILFORD
HARVIE B. WILKINSON
ROBERT W. KELLERMAN*
LIZBETH ANN TULLY
J. DAVID SMITH, JR.
EILEEN O'BRIEN
DAVID SCHWETSCHENAU
ANITA M. BRITTON
RENA GARDNER WISEMAN
DENISE KIRK ASH
BONNIE HOSKINS
C. JOSEPH BEAVIN
DIANE M. CARLTON
LARRY A. SYKES
P. DOUGLAS BARR

201 EAST MAIN STREET
SUITE 1000
LEXINGTON, KENTUCKY 40507-1380

(606) 231-3000

FAX: (606) 253-1093

*FRANKFORT OFFICE:
307 WASHINGTON STREET
FRANKFORT, KY. 40601-1823
(502) 875-6220
FAX: (502) 875-6235

**LOUISVILLE OFFICE:
2650 PROVIDIAN CENTER
400 WEST MARKET
LOUISVILLE, KY. 40202-3377
(502) 568-9100
FAX: (502) 568-5700

PERRY MACK BENTLEY
MARY BETH GRIFFITH
DAN M. ROSE
GREGORY D. PAVEY
J. MEL CAMENISCH, JR.
LAURA DAY DELCOTTO
JOHN W. WALTERS, JR.
LEA PAULEY GOFF**
CULVER V. HALLIDAY**
JAMES L. THOMERSON
DAVID E. FLEENOR
R. DOUGLAS MARTIN*
JAMES D. ALLEN
SUSAN BEVERLY JONES
MELISSA A. STEWART
TODD S. PAGE
JOHN B. PARK
PALMER G. VANCE II
RICHARD A. NUNNELLEY
ROGER W. MADDEN
WILLIAM L. MONTAGUE, JR.
CHARLES R. BAESLER, JR.
STEVEN B. LOY
GREGORY L. TAYLOR**
RICHARD B. WARNE
T. CHRISTOPHER DANIEL
LINDSEY W. INGRAM III

WALLACE MUIR (1878 - 1947)
RICHARD C. STOLL (1876 - 1949)
WILLIAM H. TOWNSEND (1890 - 1984)
RODMAN W. KEENON (1882 - 1986)
JAMES PARK (1892 - 1970)
JOHN L. DAVIS (1813 - 1870)
GLADNEY HARVILLE (1921 - 1978)
GAYLE A. MOHNEY (1908 - 1980)
C. WILLIAM SWINFORD (1921 - 1988)

October 30, 1996

Mayor Warren Powers
City of Georgetown
100 Court Street
Georgetown, Kentucky 40324

Dear Mayor:

Please find enclosed a copy of a map depicting the portion of the Whitaker property which is proposed for annexation into the City of Georgetown. The Ordinance annexing this property was given first reading at the meeting held on October 17 and is scheduled for second reading on November 7, 1996. The enclosed map is a larger and clearer version of the maps we previously provided to you at the October meeting.

Thank you for your consideration of this matter.

Very truly yours,

STOLL, KEENON & PARK, LLP

BY: Rena Wiseman
Rena G. Wiseman

RGW/lcj
Enclosure
361\whitaker\council.ltl