

Georgetown Annexation  
 Information

TREY GRAYSON  
 SECRETARY OF STATE  
 COMMONWEALTH OF KENTUCKY  
 BY Gandie Adkinson

Year	Acreage	Ordinance Number	Comments
1951	37.2	609	
1955	83	724	Ord 724 Amended Ord 723
1956	48.7	733	
1957	26.1	767	
1957	18.6	769	
1957	*	776	*Adoption of proposed annexation 769
1959	118.4	812	
1959	74.3	819	
1959	*	824	*Adoption of proposed annexation 819
1960	95	853	
1960	67.5	855	
1961	*	863B	*Adoption of proposed annexation 855
1963	116.4	910	
1963	*	911	*Adoption of proposed annexation 910
1968	2	1010	
1968	*		*Adoption of proposed annexation 1010
1970	102	1044	
1970	*		*Adoption of proposed annexation 1044
1973	334.5	1096	
1973	*		*Adoption of proposed annexation 1096
1974	722.3	1116	
74 - '75	*		*Adoption of proposed annexation 1116
1977	172.5	77-004	
1977	*		*Adoption of proposed annexation 77-004
1977	50.3	77-013	
1977	*	77-014	*Identical to 77-004
1977	*		*Adoption of proposed annexation 77-013
1977	*		*Adoption of proposed annexation 77-014
1978	59	78-002	
1978	*		*Adoption of proposed annexation 78-002
1979	50.5	79-001	
1979	*		*Adoption of proposed annexation 79-001
1981	72.4	81-011	
1982	*	83-005	*Adoption of proposed annexation 81-011 (K)
1983	46	<del>83-001</del> Truck Parking	
1983	*	83-010	*Adoption of proposed annexation 83-001
1987	1946.9	87-004	*1983 by deed - 1946.9 by survey (see 87-006)
1987	*	87-006	*Adoption of proposed annexation 87-004
1987		87-017	
1987	10.9	87-018	
1988	*	88-005	*Repealed 87-017
1988	*	88-007	*Adoption of proposed annexation 88-005
1988	*	88-009	*Adoption of proposed annexation 87-018
1988	*	88-010	*Adoption of proposed annexation 88-005
1988	454.8	88-010	
1988	13.1	88-027	
1988	*	88-029	*Adoption of proposed annexation 88-027

# City of Georgetown

GEORGETOWN, KENTUCKY

SUE LEWIS, CITY CLERK

## CERTIFICATION: KRS 81A.470 FILINGS

I certify I am the duly qualified City Clerk of the City of Georgetown, Kentucky,  
and the foregoing 6 pages of Ordinance No. 05-026 is a true, correct and  
complete copy duly adopted by the City Commission at a duly convened meeting held on  
October 20, 2005, all as appears in the official records of said City.

WITNESS, my hand and Seal of the City of Georgetown, this 21st day of  
October, 2005.



Sue Lewis  
Signature of City Clerk

CITY OF GEORGETOWN  
ORDINANCE NO. 05 - 026

AN ORDINANCE RELATED TO THE ANNEXATION OF CERTAIN REAL PROPERTY CONTAINING 56.7 ACRES, MORE OR LESS, OWNED BY VIRGINIA LOWE ADAMS AND HAMPTON C. ADAMS, JR., HER HUSBAND, AND HENRY G. WELLS AND SUSAN M. WELLS, HIS WIFE, SITUATED, IN PART (5.5 ACRES), NORTH OF US 460 BY-PASS AND, IN PART (51.2 ACRES), SOUTH OF US 460 BY-PASS AND SOUTH OF THE CITY LIMITS OF THE CITY OF GEORGETOWN IN SCOTT COUNTY, KENTUCKY.

---

WHEREAS, the owners, Virginia Lowe Adams and Hampton C. Adams, Jr., her husband, and Henry G. Wells and Susan M. Wells, his wife, have consented to the annexation of certain real property consisting of a total of 56.7 acres, more or less, situated adjacent to and south of the City Limits of Georgetown and on the north and south sides of the By-Pass in Scott County, Kentucky; and

WHEREAS, all appropriate steps required under Chapter 81A of the Kentucky Revised Statutes have been performed or waived; and

WHEREAS, a copy of said consent having been made a part of the record in this matter and available for review with the minutes of this meeting; and

WHEREAS, said real property is now embraced within the County of Scott, Kentucky, and is contiguous to the existing City Limits and, having urban character, is appropriate for annexation in its entirety to the City of Georgetown.

**NOW, THEREFORE, BE IT ORDAINED BY THE CITY OF  
GEORGETOWN:**

SECTION I. PURPOSE: The hereinafter described real property is urban in character and is contiguous to the existing City Limits of the City of Georgetown. It is, therefore, desirable to annex this property to the City of Georgetown, extending the boundaries of the City to include this real property described as follows:

SEE LEGAL DESCRIPTION OF REAL PROPERTY ANNEXED,  
ATTACHED HERETO, INCORPORATED HEREIN, AND  
MADE A PART HEREOF BY REFERENCE AS EXHIBIT "A".

SECTION II. ANNEXATION: The above described real property is hereby annexed into the City of Georgetown, all technical requirements having been

satisfied or waived by consent being filed with the minutes of the Georgetown City Council meeting dated the 6<sup>TH</sup> day of OCTOBER, 2005.

SECTION III. ZONE CLASSIFICATION: The annexation of this property shall not affect its zoning classification.

SECTION IV. EFFECTIVE DATE: This Ordinance shall become effective upon its publication on the 26<sup>TH</sup> day of OCTOBER, 2005.

WHEREUPON, the foregoing Ordinance was read for the first time on the 6<sup>TH</sup> day of OCTOBER, 2005, read for the second time, passed and approved on the 20<sup>TH</sup> day of OCTOBER, 2005.

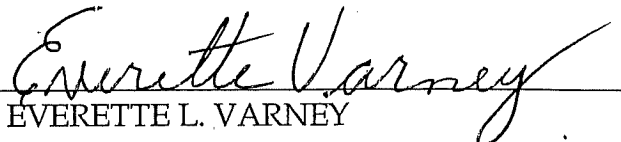
  
EVERETTE L. VARNEY  
Mayor

ATTEST:

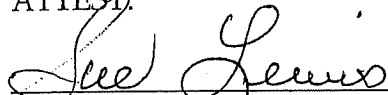
  
SUE LEWIS, City Clerk  
Georgetown, Kentucky

STATE OF KENTUCKY)  
( SCT.  
COUNTY OF SCOTT )

I, Clerk of the City of Georgetown, Kentucky, and as such custodian of the Seal and all the records of or pertaining to said City, do hereby certify the foregoing to be a true and accurate copy of Ordinance No. 05-026 relating to the annexation of certain real property consisting of a total of 56.7 acres, more or less, owned by Virginia Lowe Adams and Hampton C. Adams, Jr., her husband, and Henry G. Wells and Susan M. Wells, his wife, situated adjacent to and south of the City Limits of Georgetown and on the north and south sides of the By-Pass in Scott County, Kentucky.

IN TESTIMONY WHEREOF, witness my hand, the Seal of said City, on this the 20<sup>TH</sup> day of OCTOBER, 2005.

  
SUE LEWIS, City Clerk

**Legal Description  
For Annexation  
of a Portion of the  
Wells Property**

**Parcel North of the US 460 Bypass, Georgetown, Scott County, Kentucky**

All that tract or parcel of land situated on the north side of US 460 Bypass in Georgetown, Scott County, Kentucky and being more fully described and bounded as follows, to-wit:

Beginning at a point in the north right-of-way of the US 460 Bypass and being corner to the Nette Bridge Property; thence with the Nette Bridge Property S60°16'E 913.7 feet more or less to a point corner to the William Bevins Property; thence with the William Bevins Property for three calls S24°05'W 114.2 feet more or less, S32°33'W 345.3 feet more or less, and S31°28'W 70.1 feet more or less to a point in the above said north right-of-way of US 460 Bypass; thence with the north right-of-way of US 460 Bypass for six calls N52°55'W 82.1 feet more or less, N52°51'W 62.1 feet more or less, N46°18'W 255.0 feet more or less, N44°15'W 244.8 feet more or less, N44°07'W 110.9 feet more or less, and N44°09'W 91.2 feet more or less to the beginning and containing 5.5 Acres more or less.

**Parcel South of the US 460 Bypass, Georgetown, Scott County, Kentucky**

All that tract or parcel of land situated on the south side of US 460 Bypass in Georgetown, Scott County, Kentucky and being more fully described and bounded as follows, to-wit:

Beginning at a point in the south right-of-way of the US 460 B Bypass and being corner to the Gano Baptist Church Property; thence with the Gano Baptist Church Property for five calls S34°04'W 191.8 feet more or less, S32°31'W 181.9 feet more or less, S32°04'W 387.4 feet more or less, S32°04'W 53.6 feet more or less, and S57°00'E 275.9 feet more or less to a point corner to the William Bevins Property; thence with the William Bevins S57°33'E 322.2 feet more or less to a point corner to Giles Farm Equipment Property; thence with the Giles Farm Equipment Property S57°10'E 425.1 feet more or less to a point corner to Etterwood Subdivision; thence with Etterwood Subdivision for three calls S57°27'E 586.7 feet more or less, S57°43'E 295.2 feet more or less, and S57°43'E 160.2 feet more or less to a point in the west right-of-way of Etter Lane; thence with the west right-of-way of Etter Lane two calls S23°05'W 147.9 feet more or less and S21°53'W 424.9 feet more or less to a point; thence through the land of the Wells Property and being with the 820 contour for twenty nine calls N19°15'W 96.3 feet more or less, N58°00'W 903.7 feet more or less, N65°23'W 229.9 feet more or less, N67°53'W 300.8 feet more or less, N41°36'W 80.2 feet more or less, N22°07'W 71.8 feet more or less, N10°00'W 35.9 feet more or less, S83°40'W 56.4 feet more or less, S46°38'W 51.4 feet more or less, N11°41'W 61.5 feet more or less, N77°17'W 66.0 feet

more or less, N27°46'W 44.6 feet more or less, N21°48'W 67.1 feet more or less, N02°44'E 43.7 feet more or less, N16°42'W 21.7 feet more or less, N43°02'W 42.6 feet more or less, N02°15'W 106.0 feet more or less, N24°09'W 66.0 feet more or less, N34°20'W 103.2 feet more or less, S25°01'W 103.2 feet more or less, N07°46'W 92.3 feet more or less, N12°20'E 68.1 feet more or less, N32°28'E 81.3 feet more or less, N34°50'E 258.2 feet more or less, N81°00'W 84.4 feet more or less, S62°29'W 437.8 feet more or less, N61°31'W 361.6 feet more or less, N11°07'W 118.6 feet more or less, and N39°06'W 42.8 feet more or less to a point in the line of the Lewis Bradley Property; thence with the Lewis Bradley Property for three calls N24°28'E 426.4 feet more or less, N24°40'E 714.6 feet more or less, and N23°22'E 115.7 feet more or less to a point the above said south right-of-way of US 460 Bypass; thence with the south right-of-way of US 460 Bypass for nine calls S45°00'E 117.4 feet more or less, S49°46'E 14.3 feet more or less, S43°01'E 199.0 feet more or less, S40°42'E 246.7 feet more or less, S40°41'E 30.1 feet more or less, S40°06'E 74.7 feet more or less, S50°12'E 251.4 feet more or less, S53°19'E 75.3 feet more or less, and S55°48'E 108.3 feet more or less to the beginning and containing 51.2 Acres

See drawing of Wells property attached hereto and made a part hereof.

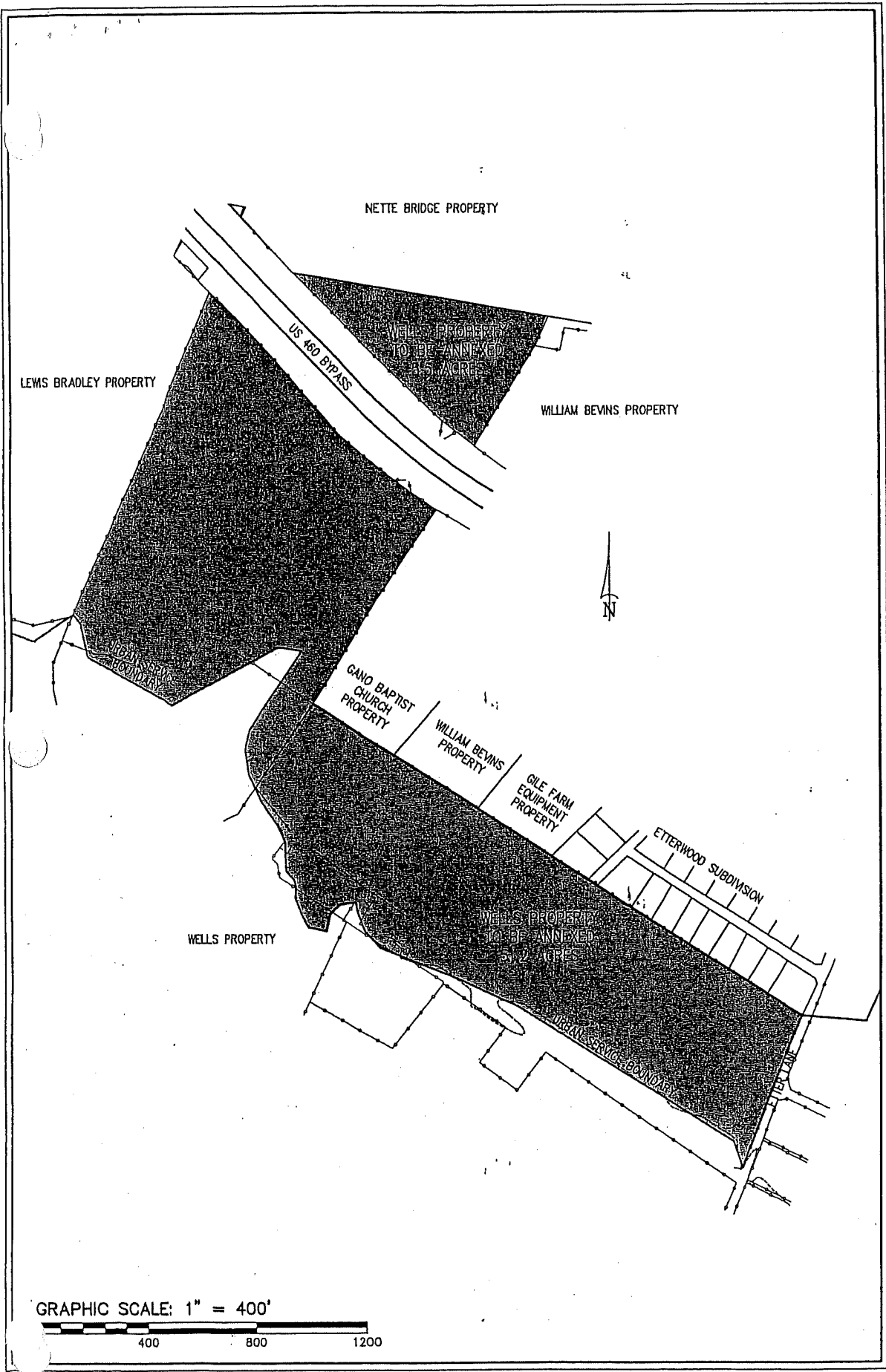

EXHIBIT

*Sherman Carter Barnhart* PSC  
 ARCHITECTURE • LANDSCAPE ARCHITECTURE • CIVIL ENGINEERING

DATE	08/08/05	PROJECT NO.	0572
DRAWN	SEG, FRE		
PROJECT NAME	WELLS PROPERTY ANNEXATION		

