

City of Minor Lane Heights

8710 East Glenwood Circle Louisville, Ky 40219
Phone & Fax (502) 968-7149

Mayor: Fred D. Williams
City Clerk/Treasurer: Jan Skeeters
Chief of Police: Almon Pevy

June 12, 2000

John Brown III, Secretary of State
700 Capitol Avenue
Suite 152
Frankfort, Kentucky 40601

RECEIVED

JUN 20 2000
SECRETARY OF STATE
COMMONWEALTH OF KY

Re: Annexation Notification
City of Minor Lane Heights

Dear Sir,

Enclosed please find a certified copy of an Ordinance of the City of Minor Lane Heights, Jefferson County, Kentucky, which annexes real estate into the City of Minor Lane Heights, along with a copy of the plat.

This real estate when annexed did not have any individuals residing on it.

This notification is being given pursuant to the provisions of KRS 81A.470.

Yours Truly,

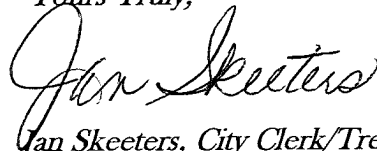

Jan Skeeters, City Clerk/Treasurer

ORDINANCE NO. 05 -1999

AN ORDINANCE ANNEXING UNINCORPORATED TERRITORY ADJOINING THE CITY OF MINOR LANE HEIGHTS, JEFFERSON COUNTY, KENTUCKY.

The City Council of the City of Minor Lane Heights, Jefferson County, Kentucky, does hereby ordain as follows:

SECTION I: The City Council of the City of Minor Lane Heights, Jefferson County, Kentucky, does hereby annex certain unincorporated territory to the City of Minor Lane Heights, Jefferson County, Kentucky, and such territory shall become a part of the City for all purposes under the laws of the Commonwealth of Kentucky, and such territory annexed is described as follows:

TRACT 1: Beginning at a P.K. Nail in the center line of Cedar Creek Road, also known as Maddox Lane, a 30 foot wide right-of-way referred to in Deed Book 4903 Page 972, of record in the Office of the Clerk of the County Court of Jefferson County, Kentucky, said point also being the southeast corner of a tract of land conveyed to Jefferson County Kentucky by deed of record in Deed Book 4394 Page 356 in the Office, aforesaid; thence leaving said centerline north 04 degrees 35 minutes 00 seconds east 2418.11 feet to an iron pipe in the south line of a tract of land conveyed to Bernard and Catherine Toebbe by deed of record in Deed Book 2623 Page 484 in the Office, aforementioned; thence with said south line south 84 degrees 20 minutes 04 seconds east 1430.83 feet to a stone; thence leaving said south line south 03 degrees 18 minutes 30 seconds west 375.46 feet to an iron rod near a fence post; thence south 84 degrees 08 minutes 39 seconds east 275.90 feet to a P.K. Nail in the centerline of said Cedar Creek Road; thence with said centerline south 03 degrees 37 minutes 13 seconds west 1194.04 feet to a P.K. Nail; thence south 05 degrees 33 minutes 00 seconds west 946.92 feet to an iron rod; thence continuing with said centerline north 80 degrees 50 minutes 00 seconds west 471.86 feet to a P.K. Nail; thence north 80 degrees 18 minutes 26 seconds west 223.99 feet to a P.K. Nail; thence north 78 degrees 54 minutes 53 seconds west 404.40 feet to a P.K. Nail; thence north 80 degrees 49 minutes 06 seconds west 91.62 feet to a P.K. Nail; thence north 83 degrees 14 minutes 20 seconds west 532.66 feet to the point of beginning and continuing 94.94068 acres.

TRACT 2: Beginning at P.K. Nail in the centerline of the Cedar Creek Road, also known as Maddox Lane, a 30 foot wide right-of-way referred to in Deed Book 4903 Page 972, of record in the Office of the Clerk of the County Court of Jefferson County, Kentucky, said point also being the southwest corner of a tract of land conveyed to Virgil M. Slaughter, Jr. and Frankie Slaughter by deed of record in Deed Book 6439 Page 358 in

the Office, aforesaid, thence leaving said centerline and with the south line, aforementioned, south 86 degrees 51 minutes 43 seconds east 1940.74 feet to a iron pin; thence north 18 degrees 46 minutes 19 seconds east 967.34 feet to an iron pin; thence north 65 degrees 13 minutes 48 seconds west 1178.82 feet to a point in the center of Cedar Creek; thence with the center of Cedar Creek the following calls: south 23 degrees 05 minutes 19 seconds east 331.80 feet, south 11 degrees 31 minutes 41 seconds east 327.39 feet, south 18 degrees 32 minutes 28 seconds west 129.81 feet, south 61 degrees 20 minutes 41 seconds west 149.69 feet, north 81 degrees 06 minutes 19 seconds west 44.27 feet, north 88 degrees 31 minutes 52 seconds west 45.16 feet, south 27 degrees 45 minutes 32 seconds west 41.86 feet, south 20 degrees 52 minutes 42 seconds west 245.61 feet, south 55 degrees 44 minutes 47 seconds west 259.61 feet; south 30 degrees 11 minutes 43 seconds west 141.97 feet, south 81 degrees 14 minutes 05 seconds west 346.06 feet to a point; thence leaving said centerline south 86 degrees 52 minutes 06 seconds east passing an iron pipe at 133.56 feet in all 2614.11 feet to an iron rod in the centerline of Cedar Creek Road, aforesaid; thence with said centerline north 05 degrees 33 minutes 00 seconds east 946.92 feet to the point of beginning and containing 92.35363 acres.

TRACT 3: Beginning at a P.K. Nail in the center line of Cedar Creek Road, also known as Maddox Lane, a 30 foot wide right-of-way referred to in Deed Book 4903 Page 972, of record in the Office of the Clerk of the County Court of Jefferson County, Kentucky, said point also being the northeast corner of a tract of land conveyed to Richard Y. and Sandra L. Vreeland by deed of record in Deed Book 5955 Page 762 in the Office, aforesaid, thence with said centerline south 80 degrees 50 minutes 00 seconds east 471.86 feet to an iron rod; thence leaving said centerline south 86 degrees 52 minutes 06 seconds east, passing an iron pin at 2,480.55 feet, in all 2614.11 feet to a point in the centerline of Cedar Creek; thence with the center of Cedar Creek, the following calls: south 81 degrees 14 minutes 05 seconds west 83.93 feet, south 64 degrees 31 minutes 11 seconds west 133.17 feet, south 26 degrees 31 minutes 57 seconds west 83.66 feet, south 16 degrees 02 minutes 40 seconds west 689.59 feet, south 50 degrees 32 minutes 07 seconds west 742.43 feet, south 66 degrees 16 minutes 37 seconds west 217.31 feet, south 36 degrees 37 minutes 48 seconds west 623.14 feet, south 79 degrees 04 minutes 59 seconds west 110.74 feet, north 54 degrees 37 minutes 23 seconds west 228.62 feet, north 69 degrees 52 minutes 03 seconds west 716.69 feet, south 87 degrees 37 minutes 41 seconds west 258.00 feet, south 63 degrees 14 minutes 59 seconds west 61.06 feet; thence leaving said centerline north 84 degrees 37 minutes 15 seconds west 363.95 feet to an iron pin at a fence post; thence north 04 degrees 40 minutes 45 seconds

east 1736.78 feet to a P.K. Nail in the centerline of Cedar Creek Road and the point of beginning containing 101.28765 acres.
As shown by survey of DEI, License No. 2975

SECTION II: This Ordinance shall be published according to law.

SECTION III: This Ordinance is enacted pursuant to KRS 81A.400, et.seq.

SECTION IV: This property having been proposed to be annexed by Ordinance No. 01-1999 and the sixty (60) day period having expired and no property owner or registered voter of the real property within the limits of the territory proposed to be annexed filing a petition with the Mayor requesting this issue be placed on the ballot, the City does hereby annex the above described property.

SECTION V: Any ordinance or part of ordinance in conflict with this Ordinance or any part of this Ordinance is hereby repealed.

SECTION VI: Should any section, clause, line, paragraph or part of this Ordinance be held unconstitutional or invalid for any reason, the same shall not affect the remainder of the Ordinance.

Given first reading at a Special meeting of the City Council of the City of Minor Lane Heights, Jefferson County, Kentucky on the 23rd day of June, 1999.
Given second reading, voted upon and passed at a Special meeting of the City Council of the City of Minor Lane Heights, Jefferson County, Kentucky, on the 28th day of June, 1999.

Votes For 6; Votes Against 0; Not Voting _____.

Fred Williams
FRED WILLIAMS, Mayor

ATTEST:

Jan Sketers
CITY CLERK

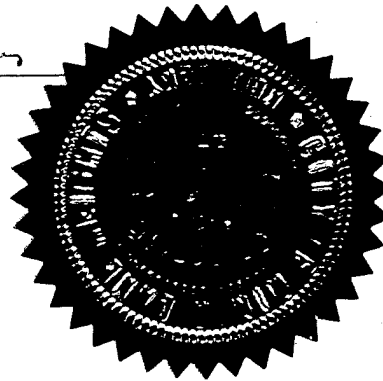

City of Minor Lane Heights

8710 East Glenwood Circle Louisville, Ky 40219

Phone & Fax (502) 968-7149

Mayor: Fred D. Williams

City Clerk/Treasurer: Jan Skeeters

Chief of Police: Alman Perry

I, the undersigned, being duly appointed, qualified and acting City Clerk of the City of Minor Lane Heights, Kentucky, hereby certify that the foregoing Ordinance No. 5-1999 is a true, correct and accurate copy as duly and lawfully passed and adopted by the City Council of the City of Minor Lane Heights on the 28th day of June, 1999.



Jan Skeeters, City Clerk/Treasurer

LEGAL DESCRIPTION TRACT 1

Beginning at a P.K. Nail in the center line of Cedar Creek Road, also known as Maddox Lane, a 30 foot wide right-of-way referred to in Deed Book 4903 Page 972, of record in the Office of the Clerk of the County Court of Jefferson County, Kentucky, said point also being the southeast corner of a tract of land conveyed to Jefferson County Kentucky by deed of record in Deed Book 4394 Page 356 in the Office, aforesaid; thence leaving said centerline north 04 degrees 35 minutes 00 seconds east 2418.11 feet to an iron pipe in the south line of a tract of land conveyed to Bernard and Catherine Toebe by deed of record in Deed Book 2623 Page 484 in the Office, aforementioned; thence with said south line south 84 degrees 20 minutes 04 seconds east 1430.63 feet to a stone; thence leaving said south line south 03 degrees 18 minutes 30 seconds west 375.46 feet to an iron rod near a fence post; thence south 84 degrees 08 minutes 39 seconds east 275.90 feet to a P.K. Nail in the centerline of said Cedar Creek Road; thence with said centerline south 03 degrees 37 minutes 13 seconds west 1194.01 feet to a P.K. Nail; thence south 05 degrees 35 minutes 00 seconds west 946.92 feet to an iron rod; thence continuing with said centerline north 80 degrees 50 minutes 00 seconds west 471.85 feet to a P.K. Nail; thence north 80 degrees 18 minutes 26 seconds west 223.99 feet to a P.K. Nail; thence north 78 degrees 54 minutes 53 seconds west 404.40 feet to a P.K. Nail; thence north 80 degrees 49 minutes 06 seconds west 91.62 feet to a P.K. Nail; thence north 83 degrees 14 minutes 20 seconds west 532.66 feet to the point of beginning and containing 94.94068 acres.

Being the same property acquired by Anita L. Miles, Linda E. Arnold, Jacqueline Ann Bischoff and David H. Miles, by deed dated December 29, 1976, of record in Deed Book 4903 Page 972 in the Office of the Clerk of the County Court of Jefferson County, Kentucky.

STATE OF KENTUCKY
 STEVEN R. BROWN
 3476
 LICENSED PROFESSIONAL LAND SURVEYOR

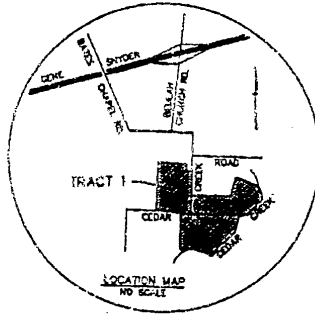
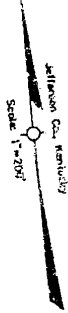

10882,
Dennis & Catherine
D.B. 2612, PG. 484

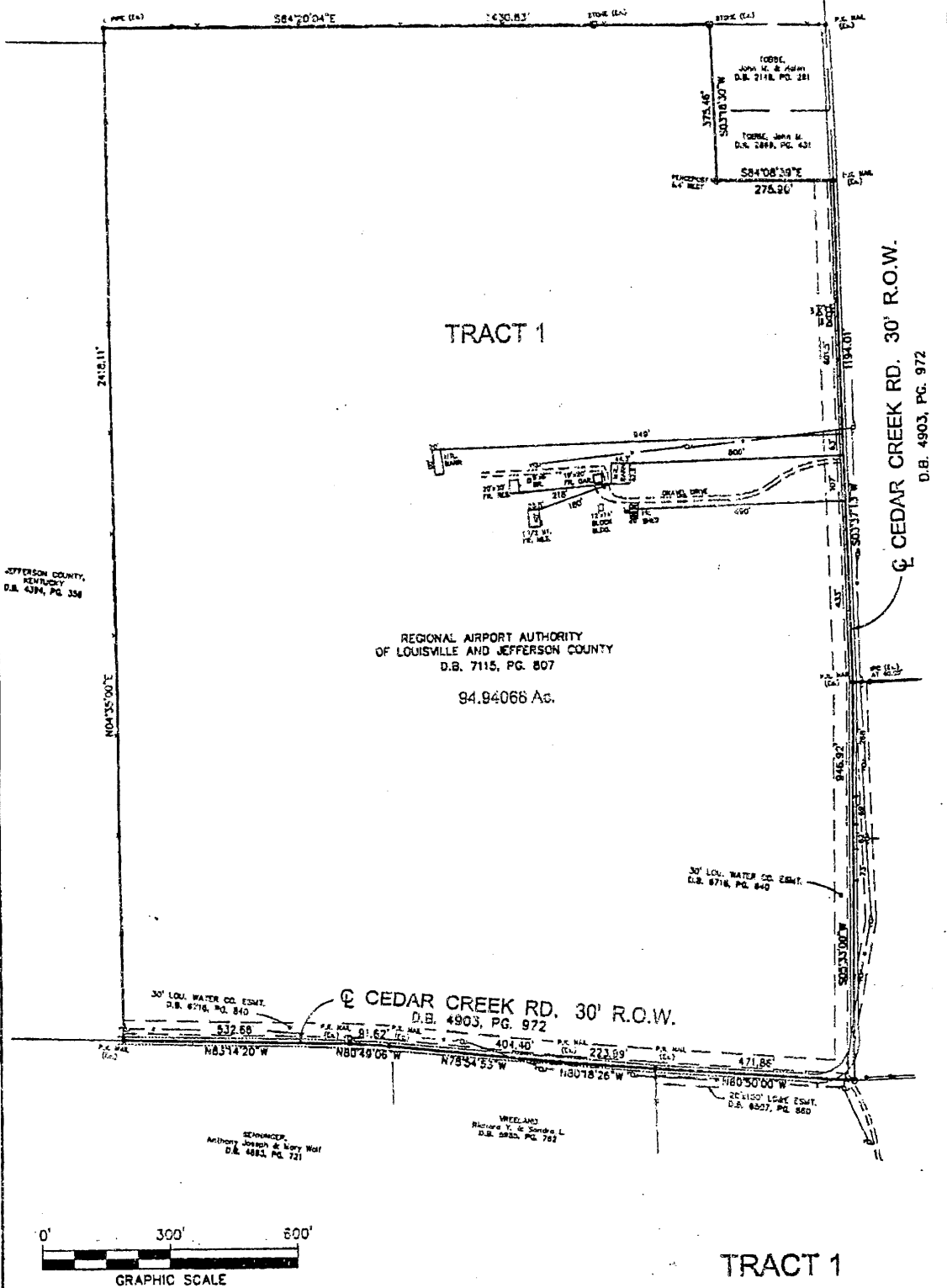

JEFFERSON COUNTY,
KENTUCKY
D.B. 439, PG. 356

2418.11'
N04°35'00"E

584°20'04"E 7430.83' 576.48' 50210.30' W 584°08'39"E 275.90'

10882,
John H. & Helen
D.B. 2148, PG. 281

10882,
TERRY, John &
D.B. 2888, PG. 431

30' CEDAR CREEK RD. 30' R.O.W.
D.B. 4903, PG. 972

REGIONAL AIRPORT AUTHORITY
OF LOUISVILLE AND JEFFERSON COUNTY
D.B. 7115, PG. 807

94.94066 Ac.

30' LOC. WATER CO. ESMT.
D.B. 6716, PG. 840

30' CEDAR CREEK RD. 30' R.O.W.
D.B. 4903, PG. 972

30' LOC. WATER CO. ESMT.
D.B. 6716, PG. 840

SEANNORCE,
Anthony, Joseph & Mary Wolf
D.B. 4882, PG. 721

WHEELANS
Richard Y. & Sandra L.
D.B. 5822, PG. 782

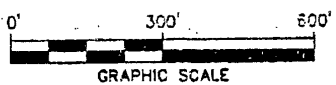

TRACT 1

LEGAL DESCRIPTION TRACT 2

Beginning at a P.K Nail in the centerline of the Cedar Creek Road, also known as Maddox Lane, a 30 foot wide right-of-way referred to in Deed Book 4903 Page 972, of record in the Office of the Clerk of the County Court of Jefferson County, Kentucky, said point also being the southwest corner of a tract of land conveyed to Virgil M. Slaughter, Jr. and Frankie Slaughter by deed of record in Deed Book 6439 Page 358 in the Office, aforesaid, thence leaving said centerline and with the south line, aforementioned, south 86 degrees 51 minutes 43 seconds east 1240.74 feet to an iron pin; thence north 18 degrees 46 minutes 19 seconds east 967.34 feet to an iron pin; thence north 65 degrees 13 minutes 48 seconds west 1178.83 feet to a point in the center of Cedar Creek; thence with the center of Cedar Creek the following calls: south 23 degrees 05 minutes 19 seconds east 331.80 feet, south 11 degrees 31 minutes 41 seconds east 327.39 feet, south 18 degrees 32 minutes 28 seconds west 129.81 feet, south 61 degrees 20 minutes 41 seconds west 149.69 feet, north 81 degrees 36 minutes 19 seconds west 44.27 feet, north 88 degrees 31 minutes 52 seconds west 45.16 feet, south 27 degrees 45 minutes 32 seconds west 41.86 feet, south 20 degrees 52 minutes 42 seconds west 245.61 feet, south 55 degrees 44 minutes 47 seconds west 259.61 feet; south 30 degrees 11 minutes 43 seconds west 141.97 feet, south 81 degrees 14 minutes 05 seconds west 346.06 feet to a point; thence leaving said centerline south 86 degrees 52 minutes 06 seconds east passing an iron pipe at 133.56 feet in all 2614.11 feet to an iron rod in the centerline of Cedar Creek Road, aforesaid; thence with said centerline north 05 degrees 33 minutes 00 seconds east 946.92 feet to the point of beginning and containing 92.35363 acres.

Being the same property conveyed to William F. Miles by deed dated October 14, 1994 of record in Deed Book 6514 Page 78 in the Office of the Clerk of the County Court of Jefferson County, Kentucky.

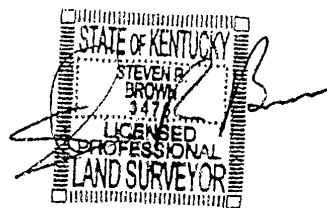

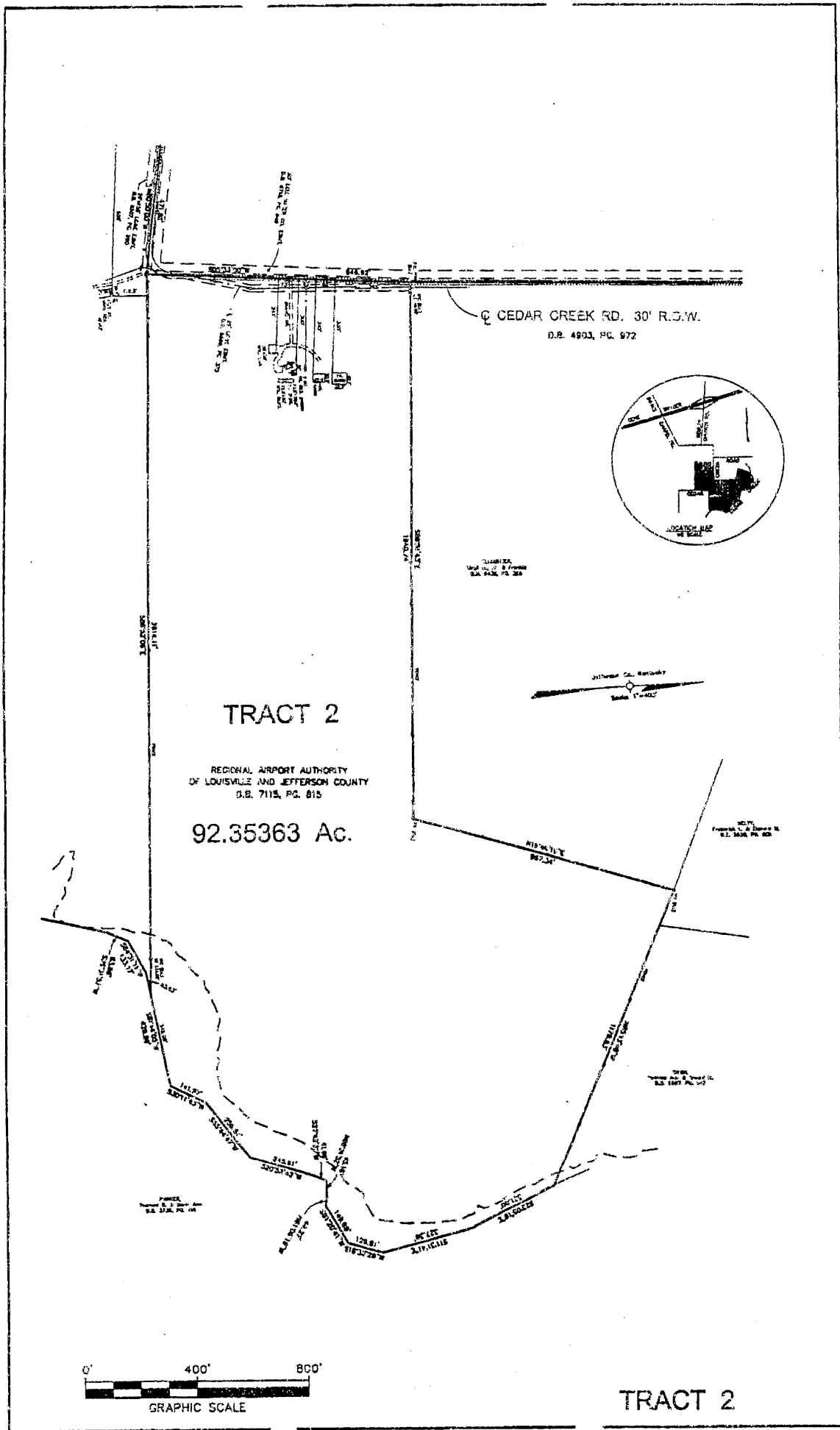

TRACT 2

REGIONAL AIRPORT AUTHORITY OF LOUISVILLE AND JEFFERSON COUNTY D.B. 7115, PG. 815

92.35363 Ac.

CEDAR CREEK RD. 30' R.O.W. D.B. 4903, PG. 972

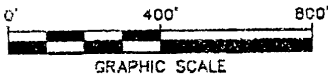
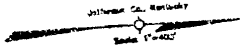
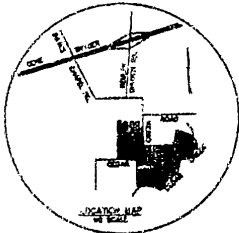

TRACT 2

LEGAL DESCRIPTION TRACT 3

Beginning at a P.K. Nail in the center line of Cedar Creek Road, also known as Maddox Lane, a 30 foot wide right-of-way referred to in Deed Book 4903 Page 972, of record in the Office of the Clerk of the County Court of Jefferson County, Kentucky, said point also being the northeast corner of a tract of land conveyed to Richard Y. and Sandra L. Vreeland by deed of record in Deed Book 5955 Page 762 in the Office, aforesaid, thence with said centerline south 80 degrees 50 minutes 00 seconds east 471.86 feet to an iron rod; thence leaving said centerline south 86 degrees 52 minutes 05 seconds east, passing an iron pin at 2,480.55 feet, in all 2614.11 feet to a point in the centerline of Cedar Creek; thence with the center of Cedar Creek, the following calls: south 51 degrees 14 minutes 05 seconds west 83.93 feet, south 64 degrees 31 minutes 11 seconds west 133.17 feet, south 25 degrees 31 minutes 57 seconds west 83.66 feet, south 16 degrees 02 minutes 40 seconds west 689.58 feet, south 50 degrees 32 minutes 07 seconds west 742.43 feet, south 66 degrees 16 minutes 37 seconds west 217.31 feet, south 36 degrees 37 minutes 48 seconds west 623.14 feet, south 79 degrees 04 minutes 59 seconds west 110.74 feet, north 54 degrees 37 minutes 23 seconds west 228.52 feet, north 69 degrees 52 minutes 03 seconds west 716.69 feet, south 87 degrees 37 minutes 41 seconds west 258.00 feet, south 63 degrees 14 minutes 59 seconds west 61.06 feet; thence leaving said centerline north 84 degrees 37 minutes 15 seconds west 363.95 feet to an iron pin at a fence post; thence north 04 degrees 40 minutes 45 seconds east 1736.78 feet to a P.K. Nail in the centerline of Cedar Creek Road and the point of beginning containing 101.26765 acres.

Being the same property acquired by Almerine Stout, Jr. and Sheryl Stout, his wife, by Deed dated April 24, 1996, of record in Deed Book 6732 Page 11; in the Office of the Clerk of the County Court of Jefferson County, Kentucky.

