

# City of Hillview

Jim Eadens • Mayor

283 Crestwood Lane  
Louisville, Kentucky 40229  
(502) 957-5280 • Fax (502) 955-5673

## CERTIFICATION

I, the undersigned, being duly appointed, qualified and acting as the City Clerk of the City of Hillview, Kentucky, hereby certify that the foregoing Resolution No. 2016-10 is a true, correct and accurate copy as duly and lawfully passed by the Hillview City Council on the 19th day of September, 2016 all as appears in the official records of said City.

WITNESS, my hand and (Seal or the Seal of said City), this 20th day of September, 2016.

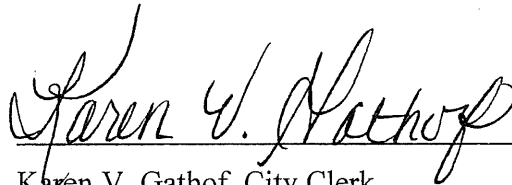

Karen V. Gathof, City Clerk

Seal

RECEIVED AND FILED

DATE November 14, 2016

ALISON LUNDERGAN GRIMES  
SECRETARY OF STATE  
COMMONWEALTH OF KENTUCKY  
BY Handie Admon

## Resolution 2016-10

### A RESOLUTION ADOPTING A MODERN AND ACCURATE LEGAL DESCRIPTION OF TERRITORY PREVIOUSLY ANNEXED BY ORDINANCE 98-15.

WHEREAS, the City of Hillview has enacted numerous ordinances annexing property into the corporate limits of the City of Hillview; and

WHEREAS, each individual annexation contains a prior survey of prepared by now unknown individual, and further references documentation that is no longer in existence; and

WHEREAS, the City wishes to provide a modern, accurate, easily identifiable legal description reflection bearings and coordinates based upon the state plane coordinate system, including relevant GPS and GIS data, same having been certified by a professional land surveyor for each prior annexation; and

WHEREAS, the city wishes to comply with the requirements of Amended KRS 81A.4 70 effective July 12th, 2004, and

WHEREAS, the city does not intend to amend or replace its prior ordinance annexing, but rather to interpret the defined boundaries of the territory previously annexed and adopt a modern and accurate legal description of territory previously annexed.

NOW THEREFORE, BE IT RESOLVED BY THE CITY COUNCIL OF THE CITY OF HILLVIEW, KENTUCKY:

SECTION 1. That the City Council of the City of Hillview hereby adopts the following legal description, and a plat attached hereto as prepared by Brad Armstrong Licensed Professional Land Surveyor No. 3334 by new plat as an accurate depiction of the property previously annexed into the corporate city limits of the City of Hillview by Ordinance 98-15 dated October 19, 1998, a copy of which is attached hereto and hereby adopts said new legal description and plat as the official legal description and plat to be adopted by the City for all purposes when referencing this prior annexation.

SECTION 2. This new legal description as prepared by Brad Armstrong a Licensed Professional Land Surveyor No. 3334 is attached as Exhibit A labeled "*Resolution for Original Ordinance 98-15*". The Plat is attached as Exhibit B on plat labeled "*RESOLUTION PLAT DEPICTING Original Ordinance 98-15*" as prepared by Brad Armstrong Land Surveying & Engineering, Inc. dated September 14, 2016.

Adopted by a vote of 6 in favor, 0 against, 0 abstentions this 19<sup>th</sup> day of September, 2016.

Votes:

yes Jo-Ann Wick  
yes Karen Johnson  
yes David Conn  
yes Kim Whitlock  
yes Lisa Boggs  
yes Randall Hill

  
\_\_\_\_\_  
HON. JIM EADENS  
MAYOR

Attested by:

  
\_\_\_\_\_  
KAREN GATHOF  
CITY CLERK

APPROVED AS TO FORM AND LEGALITY:

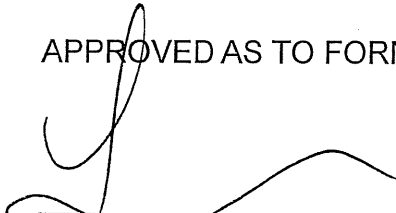
  
\_\_\_\_\_  
TAMMY R. BAKER  
CITY ATTORNEY  
295 South Buckman Street  
P.O. Box 1158  
Shepherdsville, KY 40165  
(502) 543-1883

# Brad Armstrong Land Surveying, Inc.

5870 S. Preston Hwy.  
Lebanon Junction, KY 40150  
Phone/Fax (502) 543-4607

September 14, 2016

---

**Client:**

**City of Hillview**

**283 Crestwood Lane**

**Louisville, Kentucky 40229**

**METES AND BOUNDS DESCRIPTION FOR:**

**Resolution for Original  
Annexation Ordinance 98-15**

Description of a **0.92+/- Acre** tract located in the State of Kentucky, County of Bullitt & located adjacent to the City of Hillview, **Annexation Ordinances #89-09 & 2008-08**, lying to the west of Interstate 65, and to the east of E. Blue Lick Rd (KRS #1603).

Said tract being more particularly described as follows:

**Beginning** at a point with Kentucky North Zone State Plane coordinates:

**Northing: 204640.14'** and **Easting: 1222988.65'** that is located in the east right of way line of E Blue Lick Rd (KSR #1603) and in the east line of **Ordinance 2008-08**;

**Thence** leaving the east right of way line of E. Blue Lick Rd and the east line of **Ordinance 2008-08**, **N 84°46'03" W** a distance of **15.83'** to a point near the east side of E Blue Lick Rd out in **Ordinance 2008-08**;

**Thence** along the east side of E Blue Lick Rd **N 23°51'57" E** crossing the east right of way line of E Blue Lick Rd and the west right of way line of I-65 a total distance of

**574.98'** to a point near the west side of I-65 out in **Ordinance 89-09**;

**Thence** along the west side of I-65 **S 02°11'08" E** a distance of **549.44'** to a point on the west side of I-65;

**Thence N 84°46'03" W** a distance of **50.71'** to a point in the west right of way line of I-65;

**Thence** leaving the west right of way line I-65 **N 84°46'03" W** a distance of **188.10'** to the **Point of Beginning**;

There is **EXCEPTED** from, and not included in the above described tract the following:

**Beginning** at a point with Kentucky North Zone State Plane coordinates:

**Northing: 204640.14'** and **Easting: 1222988.65'** that is located in the east right of way line of E Blue Lick Rd (KSR #1603) and in the east line of **Ordinance 2008-08**;

**Thence** leaving the east right of way line of E. Blue Lick Rd and the east line of **Ordinance 2008-08, N 84°46'03" W** a distance of **15.83'** to a point near the east side of E Blue Lick Rd out in **Ordinance 2008-08**;

**Thence** along the east side of E Blue Lick Rd **N 23°51'57" E** crossing the east right of way line of E Blue Lick Rd and the west right of way line of I-65 a distance of **574.98'** to a point near the west side of I-65 out in **Ordinance 89-09**;

**Thence** along the west side of I-65 **S 02°11'08" E** a distance of **549.44'** to a point on the west side of I-65;

**Thence N 84°46'03" W** a distance of **50.71'** to a point in the west right of way line of I-65;

**Thence** following said west right of way line of I-65 **N 00°40'36" W** a distance of **429.11'** to a point on the west right of way line of I-65 and the east right of way line of E Blue Lick Rd;

**Thence** leaving the west right of way line of I-65 along the east right of way line of E Blue Lick Rd **S 23°51'57" W** a distance of **450.44'** to the **Point of Beginning**;

Above described Ordinance of 1.59 acres, minus the 0.67 acres exception, **containing 0.92 ± acres**, more or less, as shown on plat labeled "**RESOLUTION PLAT DEPICTING Original Ordinance #98-15**" as prepared by Brad Armstrong Land Surveying, Inc. dated 9/14/2016.

**Note:** The purpose of this description is to provide information for the annexation of the 0.92 ± acres described herein to The City of Hillview. This description does not represent a boundary survey and is not intended for land transfer nor to establish property boundary lines, zoning changes or ownership.

STATE OF KENTUCKY  
PAUL BRADLEY  
ARMSTRONG  
#3334  
LICENSED  
PROFESSIONAL  
LAND SURVEYOR

*Paul Bradley Armstrong* PLS #3334  
9-14-16

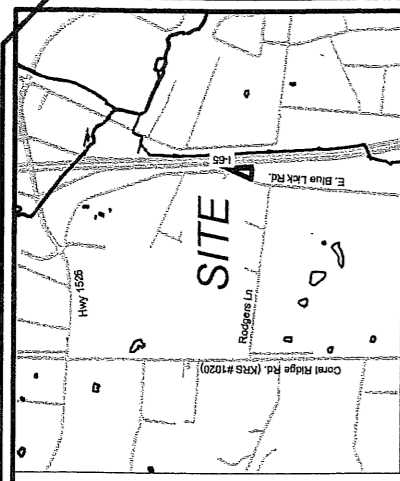

**VICINITY MAP (No Scale)**

NOTE:  
ALL BEARINGS AS SHOWN ON THIS MAP ARE REFERENCED TO GRID NORTH, KENTUCKY NORTH ZONE 1801.

W. Hebron Ln. (KSR #1450)

Existing City of Hillview Boundary  
\*ANX ORD.\* 89-09 (1989-07-20) City (2015-10-20) SOS

Property Excluded to KYTC in DB 245, Pg 223 & by Ordinance 98-15

UNINCORPORATED AREA

INTERSTATE #65



**CITY OF HILLVIEW, KY.**  
Corporate Limits

RESOLUTION PLAT DEPICTING  
Original Ordinance #98-15

**BRAD ARMSTRONG**  
Land Surveying, Inc.

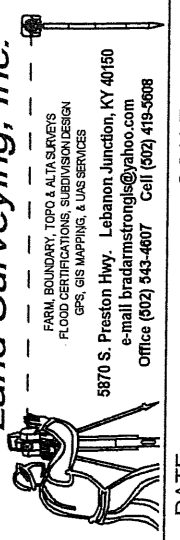

3870 S. Preston Hwy. Lebanon, Junction, KY 40150  
e-mail: bradarmstrong@yahoo.com  
office (602) 343-4007 Cell (602) 419-5608

DATE: 9-14-16 SCALE: 1" = 100'

PROJECT #14-052

S 02°11'08" E 549.44'  
N 00°40'36" W 429.11'

N 23°51'57" E 574.98'  
S 23°51'57" W 450.44'  
N 84°46'03" W 254.65'  
188.10'  
50.71'

Existing City of Hillview Boundary  
\*ANX ORD.\* 2008-08 (2008-06-16) City (2015-08-27) SOS

0.92 ACRES  
RESOLUTION FOR  
ORDINANCE 98-15  
Existing City of Hillview Boundary  
(1998-10-19) City (---) SOS

Existing City of Hillview Boundary  
\*ANX ORD.\* 2003-05 (2003-05-01) City (2003-06-16) SOS

**Point of Beginning**  
**State Plane Coordinate**  
**North Zone**  
**N: 204640.14'**  
**E: 1222988.65'**

UNINCORPORATED AREA

Rodgers Lane  
(30' RM)

Existing City of Hillview Boundary  
\*ANX ORD.\* 96-12 (1996-08-19) City (2015-09-25) SOS

UNINCORPORATED AREA

Blue Lick Rd. (KSR #1603) (RM Varies)

THE PURPOSE OF THIS MAP IS TO PROVIDE A RESOLUTION TO ANNEXATIONS FOR THE CITY OF HILLVIEW. THIS WORK DOES NOT REPRESENT A BOUNDARY SURVEY AND IS NOT INTENDED FOR LAND TRANSFER NOR TO ESTABLISH BOUNDARY LINES.

STATE OF KENTUCKY  
PAUL BRADLEY ARMSTRONG  
#3334  
LICENSED PROFESSIONAL LAND SURVEYOR

DRAWN BY: JAP  
CHECKED BY: PBA

SURVEYORS CERTIFY THAT THIS RESOLUTION PLAT DEPICTING ORIGINAL ANNEXATION ORDINANCE 98-15 MAP SHOWN HEREON IS A CORRECT DELINEATION OF THE PARCEL TO BE ANNEXED AND THAT THIS PARCEL IS CONTIGUOUS TO THE PRESENT CORPORATE LIMITS OF THE CITY OF HILLVIEW, KENTUCKY. I FURTHER CERTIFY THAT THIS MAP WAS PREPARED UNDER MY PERSONAL SUPERVISION. NO FIELD WORK WAS PERFORMED AND THIS IS NOT A BOUNDARY SURVEY. APPROXIMATE PROPERTY LINES SHOWN HEREON ARE FROM RECORD DEEDS, PLATS, RIGHT-OF-WAY PLANS AND EXISTING CITY ORDINANCES AS PROVIDED TO ME BY THE CITY OF HILLVIEW.

Paul Bradley Armstrong #3334  
PAUL BRADLEY ARMSTRONG  
P.L.S. #3334  
DATE 10-26-16