



CITY OF HOPKINSVILLE  
KENTUCKY

42240-0707

T. MARK WITHERS, II  
CAO/CITY CLERK

P.O. BOX 707  
502/887-4000

March 24, 1998

TDD 887-4287

RECEIVED

MAR 26 1998

SECRETARY OF STATE  
COMMONWEALTH OF KY

Ms. Kandie Atkinson ✓  
Land Office  
Secretary of State  
700 Capitol Avenue, Suite 152  
Frankfort KY 40601

Dear Kandie:

I am resubmitting copies of the following annexation ordinances, with certifications and maps to be recorded by your office:

ORDINANCE NO. 25-87 (Southeast)  
ORDINANCE NO. 26-87 (Northeast)  
ORDINANCE NO. 11-90 (Trover Clinic)  
ORDINANCE NO. 20-90 (Stadium Property)  
ORDINANCE NO. 17-91 (Hunter's Ridge)  
ORDINANCE NO. 32-91 (West)

I believe all ordinances were submitted within 60 days of being adopted, but understand you're unable to locate them.

Kindest regards,

T. Mark Withers, II  
CAO/City Clerk

cc: Secretary of State John Y. Brown, III  
annexation file

TMW/lm

ORDINANCE NO. 20-90

AN ORDINANCE ANNEXING TERRITORY INTO  
THE CITY OF HOPKINSVILLE, KENTUCKY

NOW, THEREFORE, BE IT ORDAINED BY THE CITY COUNCIL OF THE CITY OF  
HOPKINSVILLE, KENTUCKY, AS FOLLOWS:

SECTION ONE

The City Council does hereby declare an area described in  
Exhibit A to be annexed into the City limits of Hopkinsville.  
Exhibit A is attached hereto and incorporated herein by the  
reference as if fully set forth.

SECTION TWO

The City Council does hereby declare that an Ordinance of  
Intent No. 12-90 was adopted pursuant to KRS 81A.420 and pub-  
lished pursuant to KRS 424.130 and 424.140 on the 14th day of  
September, 1990, and as stipulated in KRS 81A.412, the affected  
property owners have waived the 60-day remonstrance period and  
requested to be annexed into the City of Hopkinsville.

SECTION THREE

The City Council declares that City taxes will be in effect  
on the 1st day after publication of this ordinance.

SECTION FOUR

Any and all existing ordinances inconsistent with this ordi-  
nance are repealed.

SECTION FIVE

If any section, subsection, sentence, clause, phrase or  
portion of this ordinance is for any reason held invalid or  
unconstitutional by any court of competent jurisdiction, such  
portion shall be deemed a separate, distinct and independent  
provision and such holding shall not affect the validity of the  
remaining portions thereof.

SECTION SIX

This ordinance shall take effect immediately after passage and publication according to law.

PUBLICLY READ AND PASSED FIRST TIME: September 18, 1990

PUBLICLY READ AND PASSED SECOND TIME: October 2, 1990

APPROVED: William Wallace Bryan, Jr.  
William Wallace Bryan, Jr.  
Mayor

ATTEST: T. Mark Withers, II.  
T. Mark Withers, II.  
CAO/City Clerk

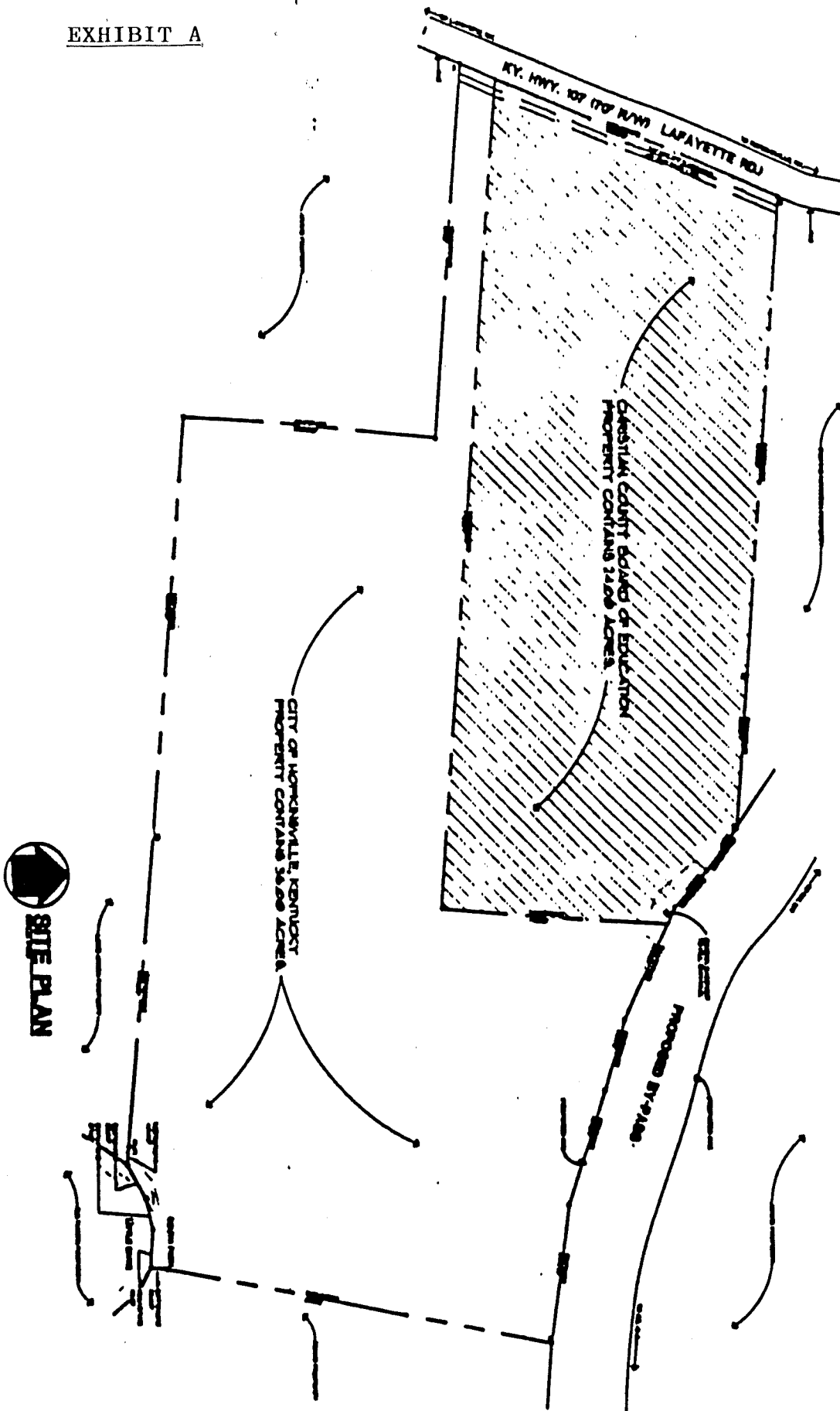

 SITE PLAN

Charles W. Billingsley Surveying Company

P.O. Box 238

750 West 15th Street  
HOPKINSVILLE, KENTUCKY 42240

Phones: Office 885-9893 - Home 235-5585

August 21, 1990

Property of City of Hopkinsville &  
Christian County Board of Education  
Purchased from Francis & George L. Atkins, Jr.  
Christian County, Kentucky

Property located in Christian County, Kentucky, on the East side of Ky. Hwy. 107 (Lafayette Road), approximately 0.2 mile South of Hopkinsville, Ky. City Limits.

Beginning at an iron stake in the East right of way of Ky. Hwy. 107, stake being a common corner between Atkins and Harrison properties, stake located South 15 degrees 49 minutes 12 seconds West, 1,002.13 feet from the centerline of Existing Foston Chapel Road and Proposed By-Pass; Thence South 85 degrees 53 minutes 49 seconds East with South line of Harrison property 1,033.03 feet to an iron stake; Thence South 85 degrees 49 minutes 24 seconds East with said property 330.67 feet to an iron stake in fence and the South right of way of Proposed South By-Pass of Hopkinsville; Thence South 55 degrees 30 minutes 20 seconds East with said right of way 111.90 feet to an iron stake; Thence South 48 degrees 41 minutes 00 seconds East with right of way 106.04 feet to an iron stake; Thence South 66 degrees 07 minutes 13 seconds East with right of way 260.97 feet to an iron stake; Thence with proposed right of way next several calls;

Thence S 74 deg 25 min 39 sec E, 156.42 feet to an iron stake;  
Thence S 71 deg 43 min 15 sec E, 259.34 feet to an iron stake;  
Thence S 82 deg 14 min 11 sec E, 304.70 feet to an iron stake located 188.79 feet from a Proposed exit of By-Pass, stake also being a new corner to Atkins property; Thence South 10 degrees 45 minutes 12 seconds West with a new line through said property 851.29

# Charles W. Billingsley Surveying Company

P.O. Box 238

750 West 15th Street  
HOPKINSVILLE, KENTUCKY 42240

---

Phones: Office 885-9893 - Home 235-5585

feet to an iron stake on bank of South Fork Little River; Thence South 07 degrees 18 minutes 30 seconds West, 35.00 feet to the centerline of South Fork Little River; Thence North 86 degrees 42 minutes 14 seconds West with Martin property and centerline of said river 83.18 feet to a point; Thence South 77 degrees 44 minutes 42 seconds West with centerline of river 67.62 feet to a point; Thence South 63 degrees 33 minutes 47 seconds West with centerline of river 83.00 feet to a point; Thence North 85 degrees 30 minutes 30 seconds West with Orten property 40.00 feet to an existing iron stake; Thence North 85 degrees 30 minutes 30 seconds West with Orten property 668.58 feet to an iron stake; Thence North 85 degrees 42 minutes 19 seconds West with a new line through Atkins property 900.00 feet to a nail in concrete; Thence North 04 degrees 17 minutes 41 seconds East with another new line through Atkins property 550.00 feet to an iron stake; Thence North 86 degrees 02 minutes 09 seconds West with another new line through Atkins property 812.21 feet to an iron stake in East right of way of Ky. Hwy. 107; Thence North 22 degrees 45 minutes 38 seconds East with said right of way 750.00 feet to the beginning.

Property containing 60.00 acres, more or less.

Property is subject to any previous recorded easements or rights of way of record.

## CERTIFICATION

I, T. Mark Withers, II, City Clerk of the City of Hopkinsville, hereby certify that the foregoing is a true and accurate copy of Ordinance No. 20-90 of the City of Hopkinsville introduced and given first reading on September 18, 1990 and given second reading and enacted on October 2, 1990, and I am the custodian of the original, which is maintained at the Lackey Municipal Building, 101 N. Main Street, Hopkinsville, Kentucky 42240.

10-9-90

Date  
Seal



T. Mark Withers, II  
CAO/City Clerk

OVERSIZE MAP INCLUDED WITH  
SUBMISSION.

To research the map, contact the  
Office of Secretary of State  
or the County Clerk.