



CITY OF HOPKINSVILLE
KENTUCKY
42240-0707

T. MARK WITHERS, II
CAO/CITY CLERK

P.O. BOX 707
502/887-4000

March 24, 1998

TDD 887-4287

RECEIVED

MAR 26 1998

SECRETARY OF STATE
COMMONWEALTH OF KY

Ms. Kandie Atkinson ✓
Land Office
Secretary of State
700 Capitol Avenue, Suite 152
Frankfort KY 40601

Dear Kandie:

I am resubmitting copies of the following annexation ordinances, with certifications and maps to be recorded by your office:

ORDINANCE NO. 25-87 (Southeast)
ORDINANCE NO. 26-87 (Northeast)
ORDINANCE NO. 11-90 (Trover Clinic)
ORDINANCE NO. 20-90 (Stadium Property)
ORDINANCE NO. 17-91 (Hunter's Ridge)
ORDINANCE NO. 32-91 (West)

I believe all ordinances were submitted within 60 days of being adopted, but understand you're unable to locate them.

Kindest regards,

T. Mark Withers, II
CAO/City Clerk

cc: Secretary of State John Y. Brown, III
annexation file

TMW/lm

ORDINANCE NO. 32-91

AN ORDINANCE ANNEXING TERRITORY INTO
THE CITY OF HOPKINSVILLE, KENTUCKY

NOW, THEREFORE, BE IT ORDAINED BY THE CITY COUNCIL OF THE CITY OF
HOPKINSVILLE, KENTUCKY, AS FOLLOWS:

SECTION ONE

The City Council of the City of Hopkinsville does hereby
state and declare an area described in Exhibit A to be annexed
into the City limits of Hopkinsville. Exhibit A is attached
hereto and incorporated herein by the reference as if fully set
forth.

SECTION TWO

The City Council of the City of Hopkinsville does hereby
declare that an Ordinance of Intent No. 25-91 was adopted pursu-
ant to KRS 81A.420 and to be published pursuant to KRS 424.130
and 424.140; and that all property owners involved have requested
to be annexed into the City of Hopkinsville.

SECTION THREE

The City Council of the City of Hopkinsville declares that
the service delivery plan and City taxes will be in effect on the
1st day after publication of this ordinance.

SECTION FOUR

Any and all existing ordinance inconsistent with this ordi-
nance are repealed.

SECTION FIVE

If any section, subsection, sentence, clause, phrase or
portion of this ordinance is for any reason held invalid or
unconstitutional by any court of competent jurisdiction, such
portion shall be deemed a separate, distinct and independent
provision and such holding shall not affect the validity of the
remaining portions thereof.

SECTION SIX

This ordinance shall take effect immediately after passage and publication according to law.

PUBLICLY READ AND PASSED FIRST TIME: December 3, 1991

PUBLICLY READ AND PASSED SECOND TIME: December 17, 1991

APPROVED: William Wallace Bryan Jr
William Wallace Bryan Jr
Mayor

ATTEST: T. Mark Withers, II.
T. Mark Withers, II.
CAO/City Clerk

Charles W. Billingsley Surveying Company

P. O. Box 238

750 West 15th Street

HOPKINSVILLE, KENTUCKY 42241

Phones: Office 885-9893; Home 885-7553

September 30, 1991

City of Hopkinsville

(West Annexation)

Hopkinsville, Kentucky

Property located on the South side of Kentucky Hwy 272 approximately 0.1 mile West of existing City limits.

Beginning at an iron stake in the South right of way of Kentucky Hwy 272, stake being 609.33 feet West of centerline of bridge over North Fork Little River, stake also being a corner to Newton and Gilliam properties; Thence South 06 degrees 39 minutes 41 seconds West with said property and also Voetberg property 554.93 feet to an iron stake; Thence North 82 degrees 39 minutes 41 seconds East with Voetberg property 289.97 feet to an iron stake; Thence South 78 degrees 41 minutes 31 seconds East with said property 196.90 feet to a point; Thence South 27 degrees 40 minutes 27 seconds East, 121.96 feet to a point in centerline of North Fork Little River; Thence with centerline of said river next several calls;

Thence South 24 deg. 27 min. 56 sec. West 150.80 feet to a point;
" South 30 " 58 " 36 " West 199.07 feet to a point;
" South 33 " 24 " 29 " West 436.55 Feet to a point;
" South 40 " 34 " 54 " West 327.87 feet to a point;
" South 43 " 54 " 09 " West 473.60 feet to a point;
" South 55 " 54 " 35 " West 239.31 feet to a point;
" South 74 " 23 " 14 " West 149.06 feet to a point;
" South 80 " 56 " 10 " West 184.80 feet to a point being a corner between Newton and Lewis properties; Thence South 74 degrees 37 minutes 37 seconds West with centerline of river 538.79 feet to a point; Thence South 37 degrees 23 minutes 35 seconds West with centerline of river 82.14 feet to a corner of Lewis and Cambridge Heights Subdivision; Thence South 24 degrees 39 minutes 54 seconds East with centerline of river 124.42 feet to a point; Thence South 35 degrees 52 minutes 25 seconds East with river 176.47 feet to a point; Thence South 30 degrees 44 minutes 40 seconds East with river 625.60 feet to a point, corner of Millbrook Subdivision No. 1; Thence South 82 degrees 13 minutes 22 seconds West with said subdivision 45.00 feet to an iron stake; Thence South 82 degrees 13 minutes 22 seconds West with said subdivision 320.56 feet to an existing iron stake; Thence South 83 degrees 22 minutes 03 seconds West with Millbrook Subdivision No. 1 a distance of 480.00 feet to an existing iron stake; Thence South 83 degrees 21 minutes 44 seconds West with said subdivision 510.06 feet to an iron stake; Thence South 83 degrees 35 minutes 41 seconds West with beforesaid subdivision 437.22 feet to an iron stake in Mill creek Subdivision; Thence North 01 degrees 05 minutes 46 seconds East with said subdivision 390.31 feet to an existing iron stake;

City of Hopkinsville
(West Annexation)
Continued

Thence North 02 degrees 03 minutes 45 seconds East with Hunter's Ridge Subdivision 992.84 feet to an iron stake; Thence North 00 degrees 57 minutes 17 seconds East with Chesley W. Dunn property 2,370.17 feet to an iron stake in right of way of Kentucky Hwy 272; Thence South 81 degrees 02 minutes 16 seconds East with said right of way and Lewis property 870.03 feet to an existing iron stake; Thence South 81 degrees 03 minutes 16 seconds East with L. Wyatt property 273.92 feet to an iron stake; Thence with said right of way and Newton property next several calls; Thence South 81 degrees 13 minutes 31 seconds East with right of way 882.02 feet to a stake; Thence South 80 degrees 41 minutes 05 seconds East with right of way 200.47 feet to a stake; Thence South 80 degrees 51 minutes 40 seconds East with right of way 200.05 feet to a stake; Thence South 83 degrees 24 minutes 25 seconds East with right of way 199.85 feet to a stake; Thence South 86 degrees 41 minutes 52 seconds East with right of way 194.70 feet to the beginning.

Property contains 188.82 acres more or less.

Property is subject to any previous recorded easements or rights of way of record.

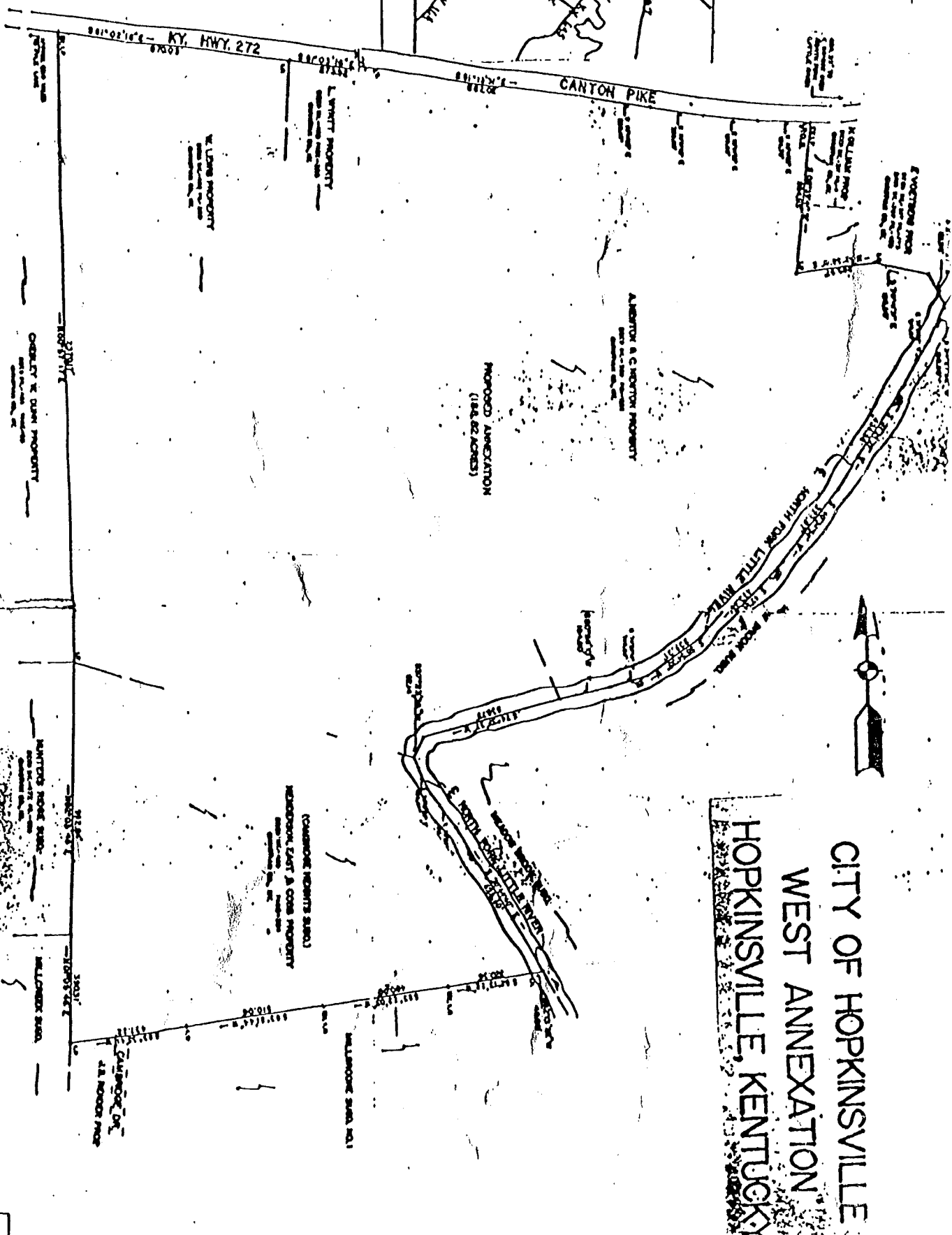
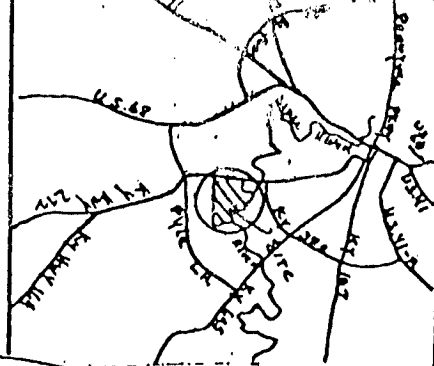

CERTIFICATION

I, T. Mark Withers, II, City Clerk of the City of Hopkinsville, hereby certify that the foregoing is a true and accurate copy of Ordinance No. 32-91 of the City of Hopkinsville introduced and given first reading on December 3, 1991 and given second reading and enacted on December 17, 1991 and I am the custodian of the original, which is maintained at the Lackey Municipal Building, 101 N. Main Street, Hopkinsville, Kentucky 42240.

12-23-91

Date
Seal



T. Mark Withers, II
CAO/City Clerk

OVERSIZE MAP INCLUDED WITH
SUBMISSION.

To research the map, contact the
Office of Secretary of State
or the County Clerk.