

I certify I am the duly qualified City Clerk of the City of Jeffersonville, Kentucky, and the foregoing 2 pages of Ordinance No. 2001-6 is a true, correct and complete copy duly adopted by the City Commission at a duly convened meeting held on December 27, 2001, all as appears in the official records of said City.

WITNESS, my hand and (Seal or the Seal of the City), this 26<sup>th</sup> day of April, 2012.

Stacey C. Honeywell  
City Clerk

Seal:

RECEIVED AND FILED  
DATE April 30, 2012

ALISON LUNDERGAN GRIMES  
SECRETARY OF STATE  
COMMONWEALTH OF KENTUCKY  
BY Harlie Adkinson

ORDINANCE NO. 2001-6

1st Reading: 11-27-01  
2nd Reading: 12-18-01  
Date of Publication: 12-27-01

AN ORDINANCE ANNEXING TO THE CITY OF JEFFERSONVILLE  
PROPERTY ON COMPTON ROAD

BE IT ORDAINED by the City of Jeffersonville, Kentucky, that:

1. The City of Jeffersonville hereby annexes to the city boundary that certain tract of land consisting of 18.29 acres owned by Hester Compton and Carma Compton, and Mack Arthur Compton and Margaret Compton.
2. That this property is adjacent to the City of Jeffersonville and is suitable for development for urban purposes without unreasonable delay.
3. That the tracts hereby annexed are more particularly described as follows:

The purpose of this legal description is to annex a certain area of land into the Jeffersonville City limits being 300 ft. on each side of the Compton Road extension and extending 300 ft. beyond the end of said road and is more exactly described as follows:

Beginning at a P/K Nail set in the centerline of Compton Road, Tabor Road and a private driveway; thence with the centerline of Tabor Road for the following calls; thence with an Arc Radius to the left 148.30 feet and a Chord Bearing N 74 deg. 35 min. 15 sec. W, 73.07 feet to a P/K Nail set; thence N 87 deg. 40 min. 48 sec. W, 252.24 feet to a P/K Nail set in the centerline of Tabor Road a corner to the Mack Arthur and Margaret Compton property (D.B. 158, page 510); thence with the Compton line for the following calls; thence N 27 deg. 21 min. 57 sec. E, 584.29 feet to an iron pin set; thence N 27 deg. 53 min. 33 sec. E, 872.55 feet to an iron pin set; thence S 62 deg. 06 min. 27 sec. E, 600.00 feet to an iron pin set; thence S 27 deg. 53 min. 33 sec. W, 869.80 feet to an iron pin set; thence S 27 deg. 21 min. 57 sec. W, 336.26 feet to a P/K Nail set in the centerline of a private Driveway; thence with the centerline of the private driveway N 84 deg. 59 min. 13 sec. W, 324.37 feet to the point of beginning containing an area of 796,776.5 square feet (18.29 Acres).

This parcel of land was surveyed by Alan Justice Engineering and Surveying, Inc., during the month of March 2001. All iron pins set are 1/2" rebar marked with I.D. caps. The basis of bearing for this survey was a magnetic bearing

observed March 20, 2001. This is a Class B survey and the unadjusted error of closure of the random traverse was 1 in 15,182.

4. That the owners of the property listed in Paragraph One of this ordinance have signed consent forms agreeing to the annexation, which consent forms are attached hereto as "Exhibit A".
5. This Ordinance shall become effective upon its passage, approval and publication as required by law.

1  
Josephine T. Hester  
Mayor

ATTEST:

Robin Meadows  
City Clerk

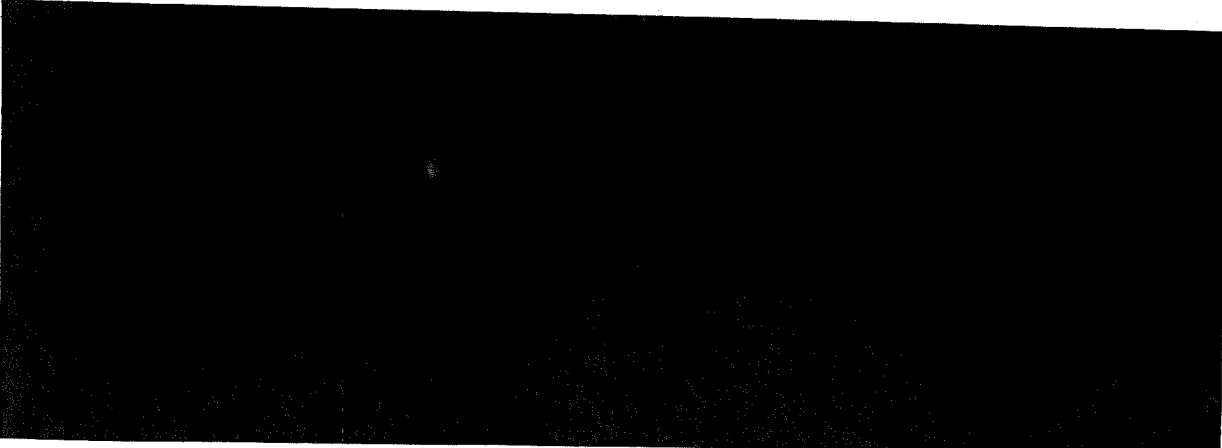

I, Stacey C. Honeycutt, City Clerk of the City of Jeffersonville do hereby certify that, the above Resolution 2010-02 is a true and correct copy as was presented to the City Commission of the City of Jeffersonville at their regular schedule meeting dated September 27, 2010. Page Count 2

Given under my hand this 26<sup>th</sup> day of April, 2012.

Stacey C. Honeycutt  
City Clerk

Seal:

RECEIVED AND FILED  
DATE April 30, 2012  
\_\_\_\_\_  
ALISON LUNDERGAN GRIMES  
SECRETARY OF STATE  
COMMONWEALTH OF KENTUCKY  
BY Barbie Adams

RESOLUTION 2010-02

A RESOLUTION ADOPTING A MODERN AND ACCURATE LEGAL DESCRIPTION OF TERRITORY PREVIOUSLY ANNEXED BY ORDINANCE.

WHEREAS, the City of Jeffersonville has enacted numerous ordinances annexing property into the corporate limits of the City of Jeffersonville; and

WHEREAS, each individual annexation contains a prior survey oft prepared by now unknown individual, and further references documentation that is no longer in existence, and

WHEREAS, the City wishes to provide a modern, accurate, easily identifiable legal description reflecting bearings and coordinates based upon the state plane coordinate system, including relevant GPS and GIS data, same having been certified by a professional land surveyor for each prior annexation; and

WHEREAS, the city wishes to comply with the requirements of Amended KRS 81A.4 70 effective July 13, 2004, and

WHEREAS, the City does not intend to amend or replace its prior ordinance annexing, but rather to interpret the defined boundaries of the territory previously annexed and adopt a modern and accurate legal description of territory previously annexed.

NOW THEREFORE, BE IT RESOVED BY THE BOARD OF COMMISSIONER'S OF THE CITY OF JEFFERSONVILLE, KENTUCKY:

SECTION 1. That the Board of Commissioner's of the City of Jeffersonville hereby adopts the following legal description, and a plat attached hereto as prepared by Alan Justice, Licensed Professional Land Surveyor No. 2360 by new survey as an accurate depiction of the property previously annexed into the corporate city limits of the City of Jeffersonville by Ordinance 2001-6 dated December 27, 2001, a copy of which is attached hereto as Exhibit "2", and hereby adopts said new legal description and plat as the official legal description and plat to be adopted by the City for all purposes when referencing this prior annexation.

Beginning a point located N 34 deg. 51 min. 40 sec. W, 365.75 feet from the intersection of Compton Road and Tabor Road; thence N 20 deg. 14 min. 48 sec. E, 253.16 feet to a point; thence N 20 deg. 46 min. 24 sec. E, 872.55 feet to a point; thence S 69 deg. 13 min. 36 sec. E, 600.00 feet to a point; thence S 20 deg. 46 min. 24 sec. W, 833.84 feet to a point; thence S 84 deg. 44 min. 45 sec. W, 665.13 feet to a point of beginning.

SECTION 2. This new legal description as prepared by Alan Justice a Licensed Professional Land Surveyor No. 2360 is as follows:

CERTIFICATION

I, Stacey Honeycutt, Clerk of the City of Jeffersonville do hereby certify that, the above Resolution 2010-02 is a true and correct copy as was presented to the Board of Commissioner's of the City of Jeffersonville at their regular schedule meeting dated

Sept. 27<sup>th</sup>, 2010.

Given under my hand this 27<sup>th</sup> day of September, 2010.

(SEAL)

**LEGEND**

× POINT

— CENTERLINE

--- REFERENCE LOCATIONS

⇄ EXISTING CITY LIMITS

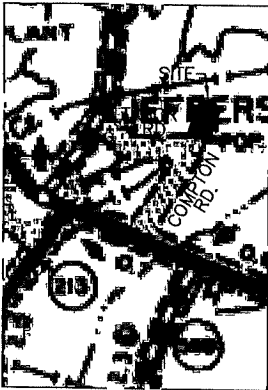

VICINITY MAP  
(NOT TO SCALE)

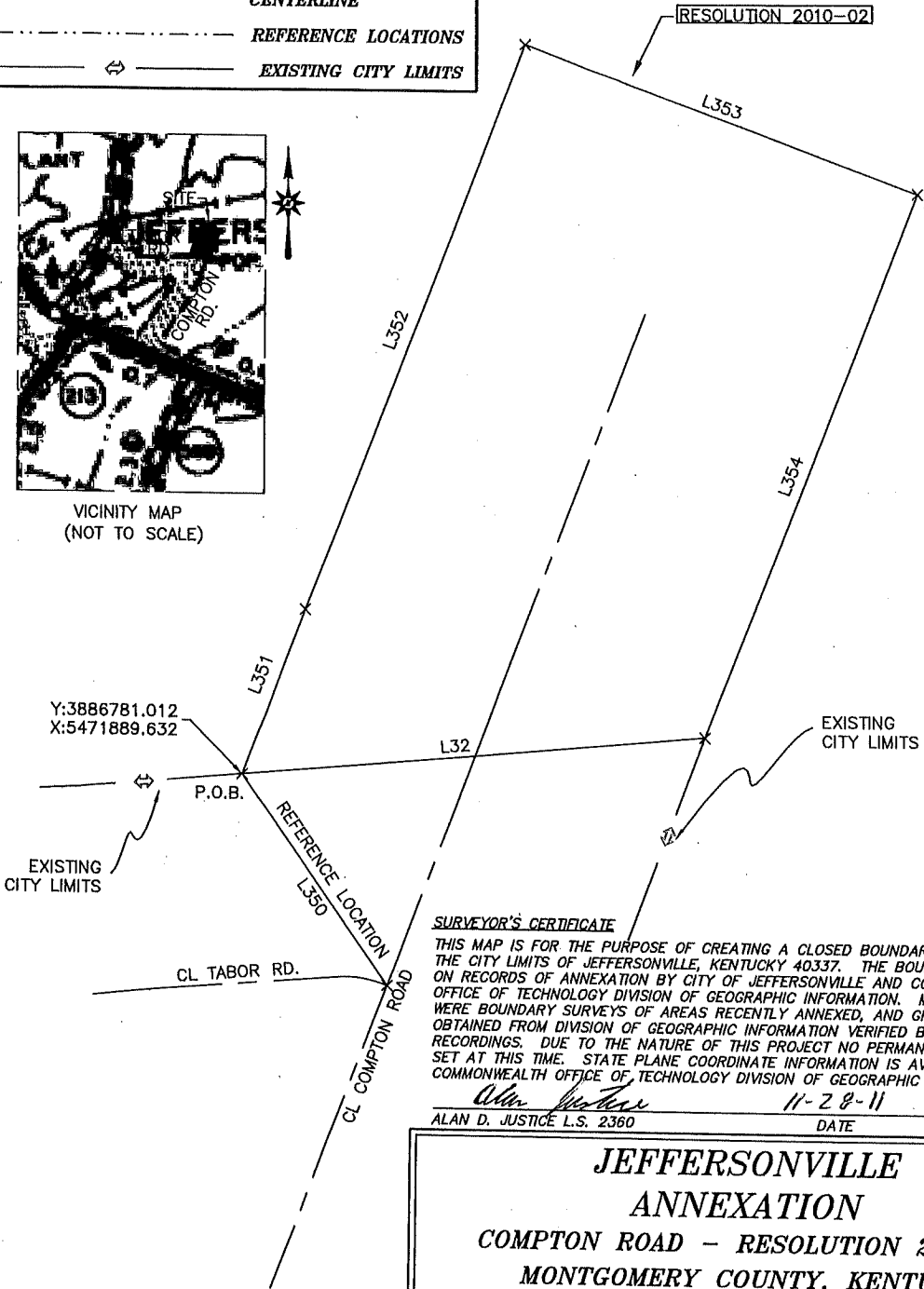

**SURVEYOR'S CERTIFICATE**

THIS MAP IS FOR THE PURPOSE OF CREATING A CLOSED BOUNDARY THAT DEFINES THE CITY LIMITS OF JEFFERSONVILLE, KENTUCKY 40337. THE BOUNDARY IS BASED ON RECORDS OF ANNEXATION BY CITY OF JEFFERSONVILLE AND COMMONWEALTH OFFICE OF TECHNOLOGY DIVISION OF GEOGRAPHIC INFORMATION. METHODS OF SURVEY WERE BOUNDARY SURVEYS OF AREAS RECENTLY ANNEXED, AND GIS INFORMATION OBTAINED FROM DIVISION OF GEOGRAPHIC INFORMATION VERIFIED BY FIELD GPS RECORDINGS. DUE TO THE NATURE OF THIS PROJECT NO PERMANENT MARKERS WERE SET AT THIS TIME. STATE PLANE COORDINATE INFORMATION IS AVAILABLE THROUGH COMMONWEALTH OFFICE OF TECHNOLOGY DIVISION OF GEOGRAPHIC INFORMATION.

*Alan Justice*  
ALAN D. JUSTICE L.S. 2360 11-28-11  
DATE

**JEFFERSONVILLE  
ANNEXATION  
COMPTON ROAD - RESOLUTION 2010-02  
MONTGOMERY COUNTY, KENTUCKY**

LINE	BEARING	DISTANCE
L32	S 84°44'45" W	665.13'
L350	N 34°51'40" W	365.75'
L351	N 20°14'48" E	253.16'
L352	N 20°46'24" E	872.55'
L353	S 69°13'36" E	600.00'
L354	S 20°46'24" W	833.84'

**ALAN JUSTICE**  
ENGINEERING & SURVEYING, INC.  
Alan D. Justice P.E., L.S.  
300B Mayville Road,  
Mt. Sterling, Ky 40669  
Phone: (855) 498-4887

STATE OF KENTUCKY  
ALAN JUSTICE  
L.S. 2360  
LICENSED PROFESSIONAL LAND SURVEYOR

DRAWN BY:	A.D.S.	DATE:	03/03/11
CHECKED BY:	A.D.J.	SCALE:	1" = 200'
REVISED:	11/28/11		

GRAPHIC SCALE  
0' 200' 400' 600'  
( IN FEET )  
1 Inch = 200 ft.

**NOTES**

1. THE BASIS OF BEARING FOR THIS SURVEY WAS FROM GPS NORTH.
2. THE SURVEY SHOWN HEREON IS SUBJECT TO ANY EASEMENTS, RESTRICTIONS, OR CEMETERIES EITHER IMPLIED OR OF RECORD.
3. THIS SURVEY DOES NOT GUARANTEE ACCESS RIGHTS TO ANY LAND SHOWN HEREON.
4. GPS COORDINATES ARE FROM KY SINGLE ZONE COORDINATES.

ORTHING	EASTING	STATION	BEARING	DISTANCE	✓ vs Plat ✓ vs LEGN	> Both OKAY
259638.455	2394720.101	0.000				
259875.968	2394807.709	253.155	N 20°14'48" E	253.155	✓	L351
260691.798	2395117.178	1125.709	N 20°46'24" E	872.554	✓	L352
260478.996	2395678.172	1725.709	S 69°13'36" E	600.000	✓	L353
259699.364	2395382.435	2559.548	S 20°46'24" W	833.839	✓	L354
259638.455	2394720.101	3224.676	S 84°44'45" W	665.128	✓	L32
259638.455	2394720.101	3224.676	N 90°00'00" E	0.000		

Closure Error Distance > 0.000

Total Distance > 3224.676

Polyline Area: 587906.2 sq ft, 13.496 acres