



# Louisville Metro Council

601 West Jefferson Street • (502) 574-1100 • Louisville, Kentucky 40202 • [www.louisvilleky.gov](http://www.louisvilleky.gov)

I, KAY Q. GRISSETT ASSISTANT CLERK OF THE LOUISVILLE METRO COUNCIL OF THE LOUISVILLE/JEFFERSON COUNTY METRO GOVERNMENT AND CUSTODIAN OF THE ORIGINAL ROLLS OF CITY OF LOUISVILLE ORDINANCES, JEFFERSON COUNTY ORDINANCES, LOUISVILLE JEFFERSON COUNTY METRO GOVERNMENT ORDINANCES, PUBLIC RECORDS, PAPERS, AND DOCUMENTS OF THE FORMER BOARD OF ALDERMEN OF THE CITY OF LOUISVILLE, FISCAL COURT OF JEFFERSON COUNTY AND LOUISVILLE METRO GOVERNMENT, AND PURSUANT TO SECTION 83A.060 OF THE KENTUCKY REVISED STATUTES, I DO HEREBY CERTIFY THAT THE ATTACHED IS A FULL AND TRUE COPY OF LOUISVILLE METRO GOVERNMENT:

ORDINANCE 65, SERIES 1982 (AS AMENDED)

AN ORDINANCE ANNEXING TO THE CITY OF LOUISVILLE, KENTUCKY, A CERTAIN TRACT OF UNINCORPORATED TERRITORY.

DATED THIS 8<sup>TH</sup> DAY OF JUNE 2010.

*Kay Q. Grissett*

KAY Q. GRISSETT, ASSISTANT CLERK  
LOUISVILLE METRO COUNCIL  
LOUISVILLE/JEFFERSON  
COUNTY METRO GOVERNMENT

SEAL:

RECEIVED AND FILED  
DATE August 10, 2010

TREY GRAYSON  
SECRETARY OF STATE  
COMMONWEALTH OF KENTUCKY  
BY Heather Adkins

AN ORDINANCE ANNEXING TO THE CITY OF LOUISVILLE,  
KENTUCKY, A CERTAIN TRACT OF UNINCORPORATED  
TERRITORY.

WHEREAS, pursuant to the order of Judge Earl O'Bannon in  
Thomas W. Bullitt, et al vs. City of Louisville, et al, the City  
has held two public hearings and prepared a service plan report;

WHEREAS, the findings in the service plan report are herein  
incorporated by reference in this ordinance;

NOW, THEREFORE, be it ordained by the Board of Aldermen of  
the City of Louisville:

Section 1. That pursuant to the consent of the owners of  
the real property, the following described territory be and is  
hereby annexed to the City of Louisville, Jefferson County,  
Kentucky:

BEGINNING at a point in the north right-of-way  
line of Interstate 64 where said line intersects  
with the present east boundary line of the City of  
Louisville as established by its Ordinance No.  
136, Series 1978; thence continuing in a generally  
northwestwardly direction with the North right-of-  
way line of Interstate 64, which line is also the  
present boundary line of the City of Louisville as  
established by its Ordinance No. 136, Series 1978;  
to its intersection with the southerly line of a  
remainder of the Arterburn Estate tract; thence in a  
northeastwardly direction with the southeasterly line  
of said Arterburn Estate tract, a distance of  
1987.42 feet, more or less, to the northeasterly line  
of said Arterburn Estate tract; thence in a  
northwestwardly direction with the northeasterly line  
of said Arterburn Estate tract, a distance of 2427.52  
feet, more or less, to its intersection with the  
southeasterly right of way line of the off ramp  
leading from the Henry Watterson Expressway  
to Shelbyville Road; thence northeastwardly  
with the southeasterly right-of-way line of the  
off-ramp leading from the Henry Watterson Express-  
way to Shelbyville Road to its intersection with  
the present, southerly right-of-way line of Shel-  
byville Road; thence eastwardly with the present  
southerly right-of-way line of Shelbyville Road to  
its intersection with the westerly line of a tract  
of land leased to Ford Leasing Development Company  
by Thomas W. Bullitt and Citizens Fidelity Bank &  
Trust Co., as Co-Trustees, as described and shown  
on lease of record in Deed Book 4410, Page 456, in

the office of the Jefferson County, Kentucky, Court Clerk; thence southwardly with the westerly line of said tract leased to Ford Leasing Development Company 599.30 feet to a point; thence eastwardly with the southerly line of said tract leased to Ford Leasing Development Company 508.25 feet to its intersection with the westerly line of Oxmoor Lane as shown on plat of Oxmoor Shopping Center, Section 1, of record in Plat and Subdivision Book 26, Page 89, in the aforesaid Office; thence northwardly with the easterly line of said tract leased to Ford Leasing Development Company, which line is also the aforesaid westerly line of Oxmoor Lane, to the intersection of said line with the present, south right-of-way line of Shelbyville Road; thence eastwardly with the present, south right-of-way line of Shelbyville Road to the corner common to the Edwin Stich Tract, as described in deed of record in Deed Book 1924, Page 168, in the aforesaid Office; thence in a southeastwardly direction with the line common to the aforesaid Edwin Stich Tract, the westerly line of Earl and Edwin Stich Tract as described in deed of record in Deed Book 4000, Page 445 in the aforesaid office and the westerly line of Hurstbourne Section No. 1-A as shown on the Plat of Record in Plat Book 23, Page 25 in the aforesaid office to a northerly line of said Hurstbourne Section No. 1-A; thence in a southwestwardly direction with said northerly line of Hurstbourne Section No. 1-A to another westerly line of said Hurstbourne Section No. 1-A; thence again in a southeasterly direction with said westerly line of Hurstbourne Section No. 1-A and the westerly line of Hurstbourne Section No. 8-A, as shown on the Plat of Record in Plat Book 31, Page 86 in the aforesaid Office, to the southeasterly line of the terminus of Lyndon Lane as shown on said Plat of Hurstbourne Section No. 8-A; thence with the arc of a curve to the right having a radius of 540.00 feet and a chord of South 24°38'16" West, 147.77 feet to a point; thence with the arc of a curve to the left having a radius of 30 feet and a chord of South 01°30'34" East, 33.56 feet to a point; thence South 35°31'15" East, 37.47 feet to a point; thence South 54°28'45" West, 80.00 feet to a point; thence with the arc of a curve to the left, having a radius of 30 feet and a chord of North 85°42'23" West, 46.09 feet to a point:

Thence South 44°06'30" West, 151.98 feet to a point;

Thence South 35°27'51" East, 840.86 feet to a point;

Thence South 31°59'06" East, 287.20 feet to a point;

Thence South 38°10'11" East, 730.39 feet to a point;

Thence South 25°32'20" East, 494.73 feet to a point;

Thence South 34°24'08" East, 587.99 feet to a point;

Thence South 45°00'00" East, 310.86 feet to a point;

Thence South 12°31'01" West, 154.92 feet to a point;

Thence South 01°34'44" East, 123.66 feet to a point;

Thence South 53°21'18" West, 404.42 feet to a point;

Thence South 36°16'11" East, 396.64 feet to a point;

Thence South 69°59'03" East, 281.62 feet to a point;

Thence South 20°00'57" West, 187.92 feet to a point;

Thence South 36°16'11" East, 65.00 feet to a point;

in the northerly line of the Commonwealth of Kentucky tract, as described in Deed of Record in Deed Book 4187, Page 250 in the aforesaid office; thence in a generally northwestwardly direction with the northerly line of said Commonwealth of Kentucky tract a distance of 34.2 feet, more or less, to the most westerly corner of that tract; thence southeastwardly with the westerly line of said Commonwealth of Kentucky tract 348.69 feet to the north right-of-way line of interstate 64; thence northwestwardly with the north right-of-way line of Interstate 64 to the point of beginning.

Section 2. This Ordinance shall take effect upon its passage, approval, and upon the occurrence of any other steps required by law.

Claudia L. Washington C.B.A. Walter H. Carrell P.B.A.  
Harvey S. ... Mayor

APPROVED: Apr. 16, 1982

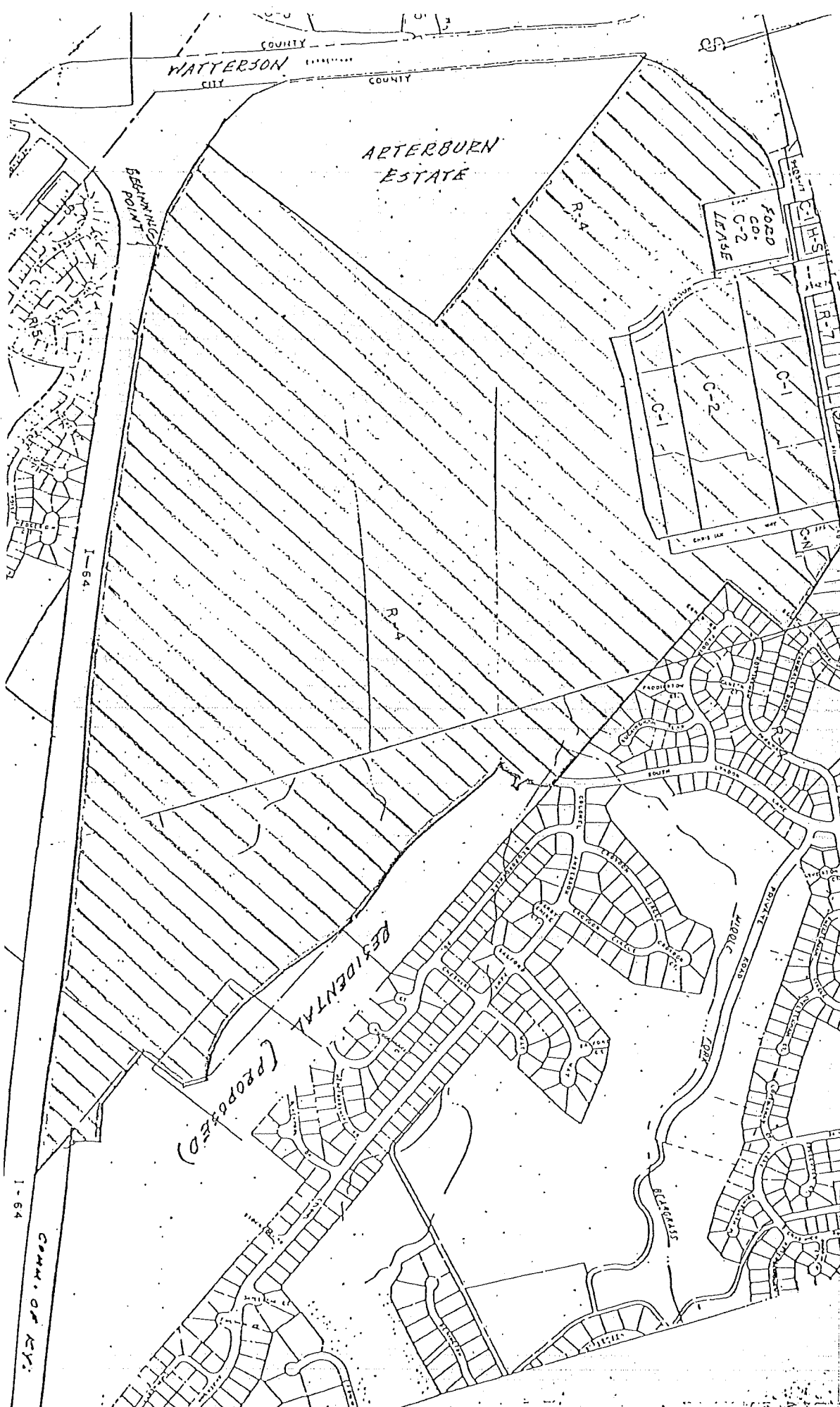

OVERSIZE MAP INCLUDED WITH  
SUBMISSION.

To research the map, contact the  
Office of Secretary of State  
or the County Clerk.