

RECEIVED

JAN 17 1991

ORDINANCE ANNEXING TO THE CITY LIMITS OF THE CITY OF MADISONVILLE CERTAIN REAL PROPERTY LOCATED NEAR MADISONVILLE  
SECRETARY OF STATE COMMONWEALTH OF KY

BE IT ORDAINED BY THE CITY OF MADISONVILLE, KENTUCKY, AS FOLLOWS:

Section 1: Pursuant to KRS 81A.400, the City of Madisonville, Kentucky, has stated its intention to annex certain real property adjacent to Madisonville. An accurate description of the boundary of the unincorporated territory proposed for annexation is set forth on Exhibit "A", attached hereto and made a part hereof. A map of the territory is set forth on Exhibit "B", attached hereto and made a part hereof.

Section 2: The City of Madisonville has declared it desirable to annex the unincorporated territory described in Exhibit "A" and shown on Exhibit "B". Said territory shall be, and hereby is, annexed into the City of Madisonville, Kentucky.

Section 3: As required by law, the Hopkins County Joint Planning Commission conducted a public hearing and has made its recommendation regarding appropriate zoning for the property proposed to be annexed.

Section 4: The property annexed hereby is adjacent or contiguous to the City's boundaries and, by reason of population density, commercial, industrial, institutional, or governmental use of land or subdivision of land, is urban in character and suitable for development for urban purposes without unreasonable delay.

Section 5: This Ordinance shall be effective upon publication.

The foregoing Ordinance is read to and presented to a regular meeting of the City Council of Madisonville, Kentucky, for first reading on the 5 day of November, 1990, and the second reading on the 19 day of November, 1990. Motion was made by Councilmember Simmons, seconded by Councilmember Hill, that the Ordinance be adopted as the law of the City of Madisonville, Kentucky, to be effective immediately upon publication thereof, as required by law.

Upon vote being taken thereon, the votes were cast as follows:

COUNCILMEMBER	YEA	NAY
James L. Gill	<input checked="" type="checkbox"/>	<input type="checkbox"/>
Rudy Stone	<input checked="" type="checkbox"/>	<input type="checkbox"/>
Vickie Nance	<input checked="" type="checkbox"/>	<input type="checkbox"/>
D. W. Riley	<input checked="" type="checkbox"/>	<input type="checkbox"/>
Jim Haywood	<input checked="" type="checkbox"/>	<input type="checkbox"/>

Bob Simmons

✓

It appearing that 6 Councilmember(s) voted for the Motion and 0

Councilmember(s) voted against it, the Mayor announced that the Motion was passed and that the above Ordinance would be published, as required by law, and would be effective immediately upon publication thereof, unless otherwise stated.

Dated this the 20 day of November, 1990.

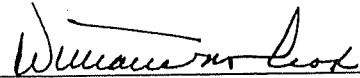
  
\_\_\_\_\_  
William M. Cox, Mayor  
City of Madisonville, Kentucky

Attest:

  
\_\_\_\_\_  
Gina Munger, Clerk/Treasurer  
City of Madisonville, Kentucky

ORDINANCE ANNEXING TO THE CITY LIMITS OF THE  
CITY OF MADISONVILLE CERTAIN REAL PROPERTY  
LOCATED NEAR MADISONVILLE

BE IT ORDAINED BY THE CITY OF MADISONVILLE, KENTUCKY, AS FOLLOWS:

Section 1: Pursuant to KRS 81A.400, the City of Madisonville, Kentucky, has stated its intention to annex certain real property adjacent to Madisonville. An accurate description of the boundary of the unincorporated territory proposed for annexation is set forth on Exhibit "A", attached hereto and made a part hereof. A map of the territory is set forth on Exhibit "B", attached hereto and made a part hereof.

Section 2: The City of Madisonville has declared it desirable to annex the unincorporated territory described in Exhibit "A" and shown on Exhibit "B". Said territory shall be, and hereby is, annexed into the City of Madisonville, Kentucky.

Section 3: As required by law, the Hopkins County Joint Planning Commission conducted a public hearing and has made its recommendation regarding appropriate zoning for the property proposed to be annexed.

Section 4: The property annexed hereby is adjacent or contiguous to the City's boundaries and, by reason of population density, commercial, industrial, institutional, or governmental use of land or subdivision of land, is urban in character and suitable for development for urban purposes without unreasonable delay.

Section 5: This Ordinance shall be effective upon publication.

The foregoing Ordinance is read to and presented to a regular meeting of the City Council of Madisonville, Kentucky, for first reading on the 5 day of Nov, 1990, and the second reading on the 19 day of Nov, 1990. Motion was made by Councilmember Simmons, seconded by Councilmember Nance, that the Ordinance be adopted as the law of the City of Madisonville, Kentucky, to be effective immediately upon publication thereof, as required by law.

Upon vote being taken thereon, the votes were cast as follows:

COUNCILMEMBER	YEA	NAY
James L. Gill	<u>✓</u>	_____
Rudy Stone	<u>✓</u>	_____
Vickie Nance	<u>✓</u>	_____
D. W. Riley	<u>✓</u>	_____
Jim Haywood	<u>✓</u>	_____

Bob Simmons

✓

It appearing that 6 Councilmember(s) voted for the Motion and 0

Councilmember(s) voted against it, the Mayor announced that the Motion was passed and that the above Ordinance would be published, as required by law, and would be effective immediately upon publication thereof, unless otherwise stated.

Dated this the 20 day of November, 1990.

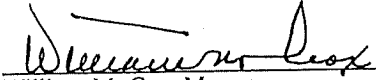
  
\_\_\_\_\_  
William M. Cox, Mayor  
City of Madisonville, Kentucky

Attest:

  
\_\_\_\_\_  
Gina Munger, Clerk/Treasurer  
City of Madisonville, Kentucky

COPY

ORDINANCE ANNEXING TO THE CITY LIMITS OF THE  
CITY OF MADISONVILLE CERTAIN REAL PROPERTY  
LOCATED NEAR MADISONVILLE

BE IT ORDAINED BY THE CITY OF MADISONVILLE, KENTUCKY, AS FOLLOWS:

Section 1: Pursuant to KRS 81A.400, the City of Madisonville, Kentucky, has stated its intention to annex certain real property adjacent to Madisonville. An accurate description of the boundary of the unincorporated territory proposed for annexation is set forth on Exhibit "A", attached hereto and made a part hereof. A map of the territory is set forth on Exhibit "B", attached hereto and made a part hereof.

Section 2: The City of Madisonville has declared it desirable to annex the unincorporated territory described in Exhibit "A" and shown on Exhibit "B". Said territory shall be, and hereby is, annexed into the City of Madisonville, Kentucky.

Section 3: As required by law, the Hopkins County Joint Planning Commission conducted a public hearing and has made its recommendation regarding appropriate zoning for the property proposed to be annexed.

Section 4: The property annexed hereby is adjacent or contiguous to the City's boundaries and, by reason of population density, commercial, industrial, institutional, or governmental use of land or subdivision of land, is urban in character and suitable for development for urban purposes without unreasonable delay.

Section 5: This Ordinance shall be effective upon publication.

The foregoing Ordinance is read to and presented to a regular meeting of the City Council of Madisonville, Kentucky, for first reading on the 3 day of Dec, 1990, and the second reading on the 17 day of Dec, 1990. Motion was made by Councilmember Simmons, seconded by Councilmember Haywood, that the Ordinance be adopted as the law of the City of Madisonville, Kentucky, to be effective immediately upon publication thereof, as required by law.

Upon vote being taken thereon, the votes were cast as follows:

COUNCILMEMBER	YEA	NAY
James L. Gill	<input checked="" type="checkbox"/>	<input type="checkbox"/>
Rudy Stone	<input checked="" type="checkbox"/>	<input type="checkbox"/>
Vickie Nance	<input checked="" type="checkbox"/>	<input type="checkbox"/>
D. W. Riley	<input checked="" type="checkbox"/>	<input type="checkbox"/>
Jim Haywood	<input checked="" type="checkbox"/>	<input type="checkbox"/>

Bob Simmons

It appearing that 6 Councilmember(s) voted for the Motion and 0

Councilmember(s) voted against it, the Mayor announced that the Motion was passed and that the above Ordinance would be published, as required by law, and would be effective immediately upon publication thereof, unless otherwise stated.

Dated this the 18 day of Dec, 1990.

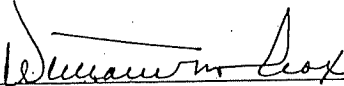
  
\_\_\_\_\_  
William M. Cox, Mayor  
City of Madisonville, Kentucky

Attest:

  
\_\_\_\_\_  
Gina Munger, Clerk/Treasurer  
City of Madisonville, Kentucky

## BOUNDARY DESCRIPTIONS

## TRACT I - RIDGEWOOD HEIGHTS SUBDIVISION

Beginning at a point in the West right-of-way of Island Ford Road at the Southeast corner of the Lawrence Hawkins tract; said point has Kentucky State Plane coordinates of North 378,676.84 feet and East 1,498,834.77 feet and is located approximately 0.95 miles Northeast of the Pennyrite Parkway; thence with the West right-of-way of Island Ford Road South 20 degrees 00 minutes 26 seconds West 397.00 feet to the Northeast corner of the William Lantrip tract; thence with the North line of Lantrip North 68 degrees 28 minutes 34 seconds West 845.61 feet; North 67 degrees 31 minutes 34 seconds West 225.01 feet to the Northwest corner of Lantrip; thence South 27 degrees 11 minutes 09 seconds West 433.87 feet; thence South 27 degrees 58 minutes 22 seconds West 653.46 feet; thence South 26 degrees 13 minutes 48 seconds West 329.77 feet to a point in the North line of Ridgewood Subdivision; thence with the North line of Ridgewood Subdivision North 48 degrees 15 minutes West 186.99 feet; North 0 degrees 20 minutes 46 seconds West 397.01 feet; North 5 degrees 22 minutes 24 seconds East 241.11 feet; North 46 degrees 15 minutes 54 seconds West 511.20 feet; North 38 degrees 57 minutes 41 seconds West 418.01 feet; North 24 degrees 45 minutes 48 seconds West 176.55 feet; North 37 degrees 59 minutes West 275.00 feet; thence leaving Ridgewood Subdivision North 26 degrees 21 minutes 02 seconds East 754.60 feet; North 45 degrees 45 minutes West 86.82 feet; thence North 57 degrees 33 minutes 19 seconds East 51.38 feet; North 35 degrees 16 minutes 13 seconds East 200.00 feet; South 54 degrees 34 minutes 06 seconds East 456.03 feet; South 53 degrees 03 minutes 39 seconds East 510.05 feet; South 49 degrees 54 minutes 39 seconds East 825.25 feet to a point in the West line of the Lawrence Hawkins tract; thence South

27 degrees 11 minutes 09 seconds West 34.37 feet to the Southwest corner of Hawkins; thence with Hawkins' South line South 68 degrees 22 minutes 52 seconds East 1020.94 feet to the beginning, containing 63.06 acres.

TRACT II - WILLIAM E. LANTRIP

A certain tract or parcel of land located in Hopkins County, Kentucky, on the waters of Elk Creek and lying on the West side of the Island Ford Road, more particularly bounded and described as follows;

Beginning at a point on the West side of the Island Ford Road, at the Northeast corner of the tract of which this conveyance is a part; running thence West 210 feet to a marker, a new corner; thence South 105 feet to a point, a new corner; thence East 210 feet to the West side of the Island Ford Road, to a point, a new corner; thence North with the Island Ford Road 105 feet to the beginning, containing approximately one half of an acre, and being a rectangular tract of land 105 x 210 feet off of the North side of the James Austin Potts property.

Exhibit B

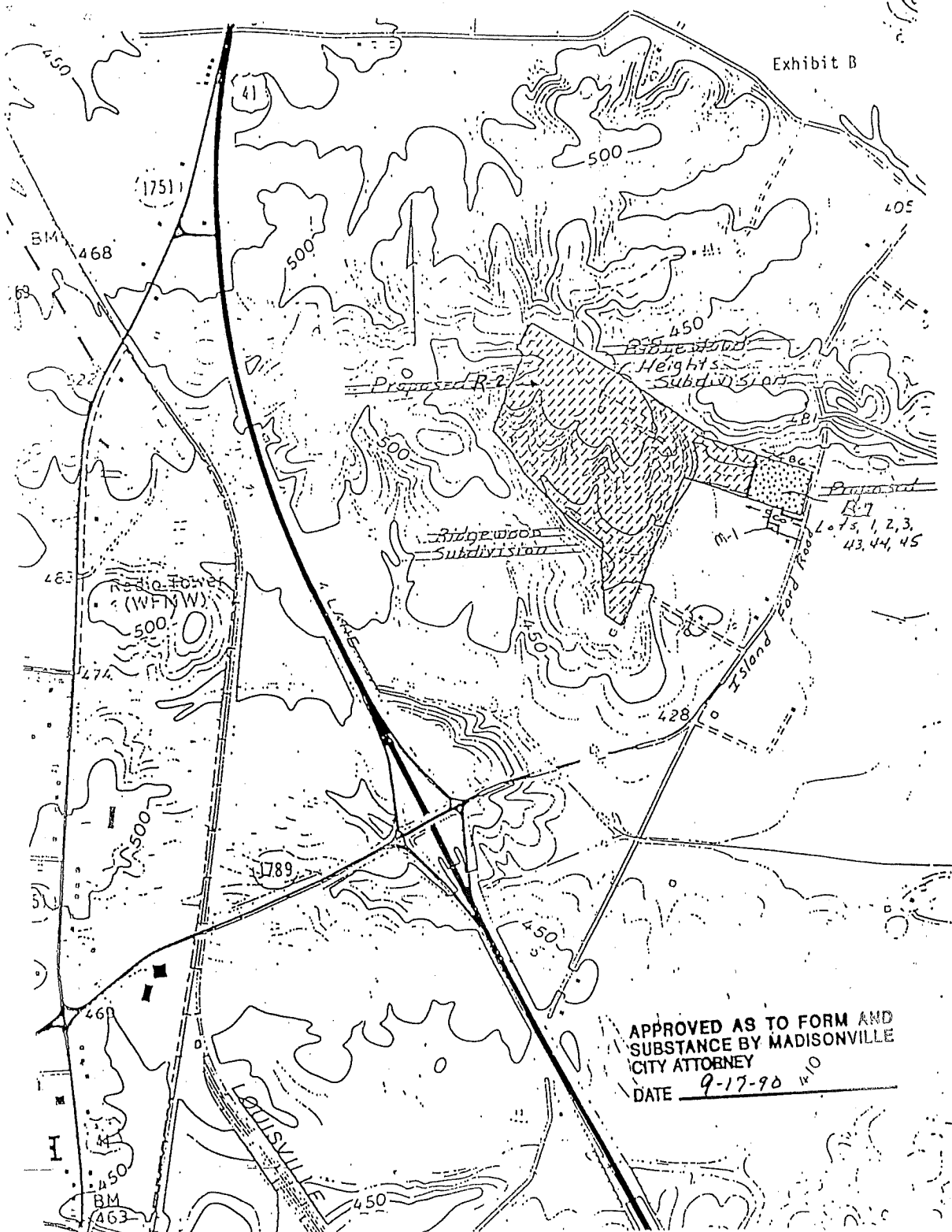

APPROVED AS TO FORM AND  
SUBSTANCE BY MADISONVILLE  
CITY ATTORNEY  
DATE 9-17-90 WIO

LEGAL DESCRIPTION FOR  
ANNEXATION PLAN OF  
THE CITY OF MADISONVILLE KENTUCKY

(FEBRUARY 5, 1990)  
(REVISED OCTOBER 18, 1990)

TRACT II REVISED

Beginning at a point, said point being the intersection of the North right-of-way line of East Center Street (KY 70) and the West right-of-way line of the Pennyrile Parkway, thence running with the North right-of-way line of East Center Street in a Westerly and Northeasterly direction to the existing City Limits Line between Jerry's Restaurant and Walter Ruby, thence running with the existing City Limits Line in a Northwesterly direction to its intersection with the East right-of-way line of the CSXT Railroad, thence running in a Northwesterly direction with said right-of-way line of the CSXT Railroad to the intersection with the Southeast right-of-way line of the connector track between the main line of the CSXT Railroad and the Central City Branch, thence running in a Northeasterly direction with the Southeast right-of-way line of the connector track between the CSXT Railroad main line and the Central City Branch of the CSXT Railroad to the South right-of-way line of the CSXT Railroad, Central City Branch, thence crossing the CSXT Railroad, Central City Branch, to the North right-of-way of said Central City Branch, thence running in a Westerly and Northerly direction with said right-of-way line to the South right-of-way line of a railroad spur line to Goodyear, thence following the said right-of-way line of said spur line to the East line of Whittington Drive, thence

running in a Southerly direction with said right-of-way line and the Whittington Estate and continuing in an Easterly direction of the Whittington Estate to the West right-of-way line of the Pennyrile Parkway, thence running in a Southerly direction with said right-of-way line to the point of beginning.

Ronald R. Johnson, P.E.

R.P.E. #5502  
R.L.S. #1052

(Rev. October 18, 1990)

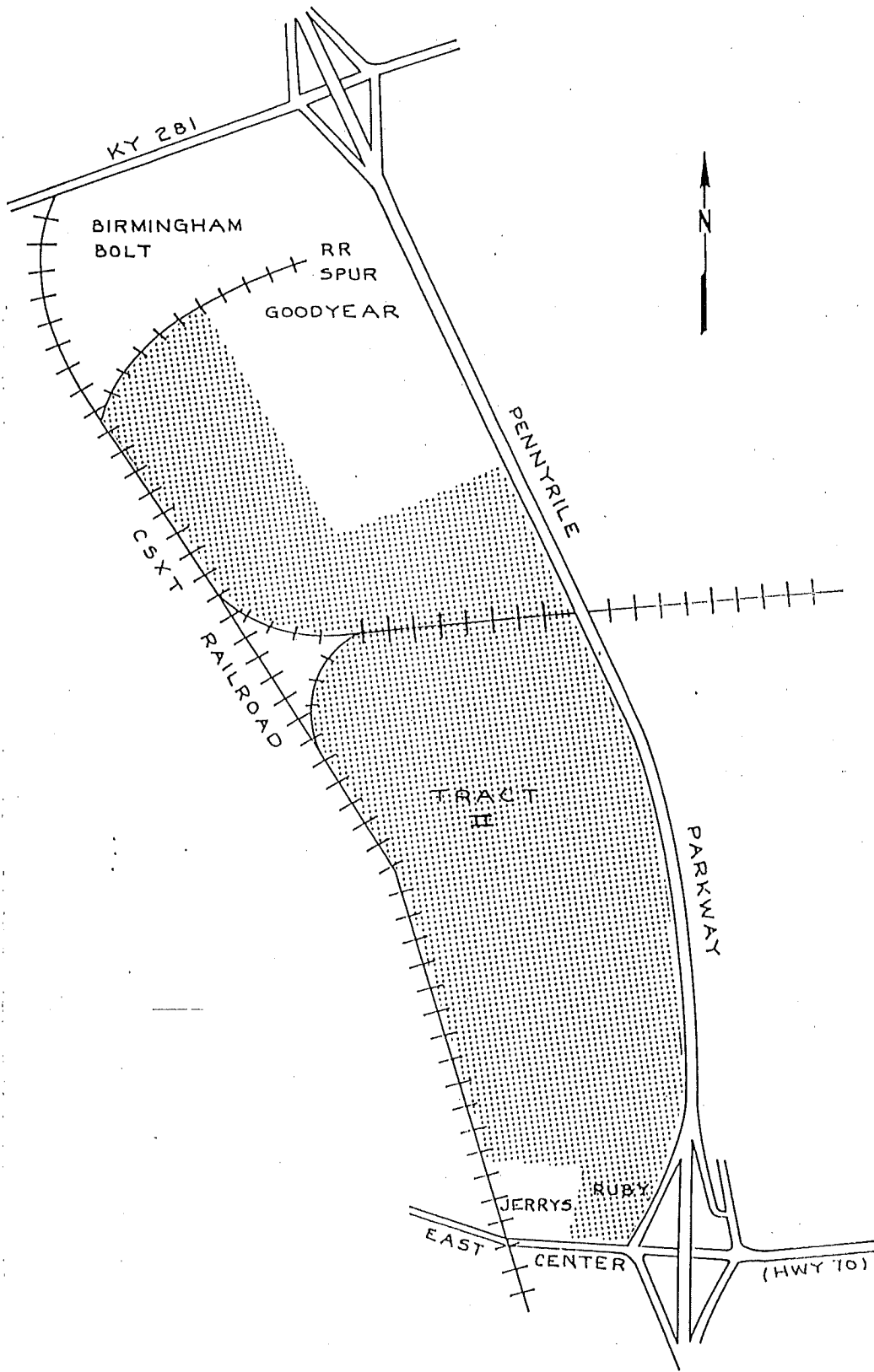

EXHIBIT "B"

LEGAL DESCRIPTION

TRACT IIIA

Beginning at a point, said point being on the existing City Limits on the East right-of-way of Stagecoach Road, and also being directly across Stagecoach Road from the Southeast corner of Dennis & Mary Burden and the Northeast corner of Forest A. & Brenda Hanke, thence running across Stagecoach Road and along the South property line of Dennis & Mary Burden to the Southwest corner of Dennis & Mary Burden, thence running in a Westerly direction along the North line of Jack Brooks to a point, said point being at the Northeast corner of Lot 16 of the Abbott Woods Subdivision, thence running along the North line of said subdivision to the Northwest corner of Lot 15 of said subdivision, thence running in a Southerly direction along the West side of said subdivision to a point, said point being the Northeast corner of Lot 15 of the Oakwood Hills Subdivision, thence running in a Westerly direction along the North side of the Oakwood Hills Subdivision to the Northwest corner of the Oakwood Hills Subdivision, thence running in a Southerly direction to the Existing City Limits at the Northwest corner of the right-of-way of Buffalo Trace Road, thence continuing in a Southerly direction along the Existing City Limits to the Northeast corner of the Fairway Subdivision, thence running in a Westerly direction along the North side of the Fairway Subdivision and the North side of Jerry Markham's property to the East line of the City of Madisonville property now being used by the Boy Scouts, thence running along the East, North and West sides of said property to the Southwest corner

of said property, which is on the Russell Lutz property line, thence running in a Southerly direction along the East line of Russell Lutz to the North line of property owned by the City of Madisonville, thence running in a Westerly direction along the North line of the City of Madisonville property to the Northeast corner of Rod Jessup's property, thence running in a Southerly direction along the West side of the City of Madisonville property to the Northeast corner of Hillus Camplin, thence running along the East and South side of Hillus Camplin to the East right-of-way of Tucker Schoolhouse Road, thence running in a Southerly direction along said right-of-way to the Northwest corner of James McCay, thence running along the North side of James McCay and continuing along the North side of Wallace Bowles to the Southeast corner of Wallace Bowles, thence running in a Westerly direction along the South side of Wallace Bowles to the Existing City Limits, thence continuing in a Westerly direction with the Existing City Limits to the East right-of-way of Tucker Schoolhouse Road, thence running Northerly along said right-of-way to the Southwest corner of Hillus Camplin, thence running directly across Tucker Schoolhouse Road to the West right-of-way of said road, thence running in a Southerly direction along the West right-of-way of said road to the existing city limits at the Northeast corner of the City of Madisonville Industrial Park property, thence running Southerly along the existing city limits on the West right-of-way of Tucker Schoolhouse Road, thence continuing with the existing City limits Easterly and Southerly along the toe of the dam on lake PeeWee to the existing city limits on the high water mark of Lake PeeWee, thence continuing with the existing city limits around the East and North sides of Lake PeeWee, thence continuing Easterly

with the existing city limits along the South side of the Lakeshore Country Club, thence continuing Northerly with the existing city limits to the Northeast corner of the Fairway subdivision, thence continuing with the existing city limits to the point of beginning.

Ronald R. Johnson, P.E.

R.P.E. #5502  
R:L.S. #1052

June 1, 1990

