

CITY OF MILLERSBURG
MILLERSBURG, KENTUCKY 40348

To: Secretary of State
From: City of Millersburg
Date: August 28, 1980
Subject: Incorporation of city

SECRETARY OF STATE
RECEIVED

AUG 28 1980

COMMONWEALTH OF KENTUCKY

For your records:

Name of city - Millersburg

Year incorporated - 1893

Present classification - 5th Class

Present boundaries - Map is enclosed with city limits outlined
in red.

If I can be of further assistance, please advise.

Yours truly,

Chontrelle Layson, Mayor

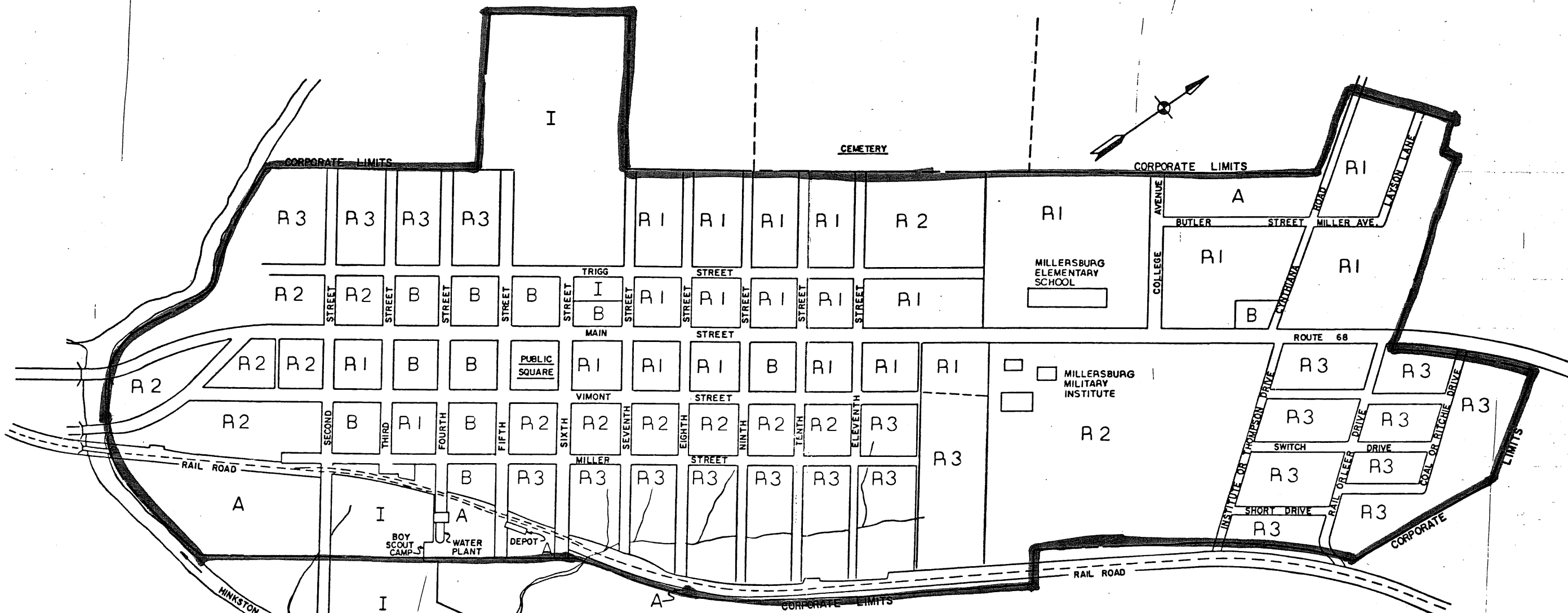

THIS IS TO CERTIFY THAT THIS IS THE OFFICIAL ZONING MAP REFERRED TO IN SECTION 2.12 OF THE CITY OF MILLERSBURG, KENTUCKY ZONING ORDER, ADOPTED BY THE CITY COUNCIL OF THE CITY OF MILLERSBURG, KENTUCKY.

MAYOR

CITY CLERK

OFFICIAL ZONING MAP
CITY OF
MILLERSBURG, KENTUCKY

MAP COURTESY OF
W.R. STAMLER CORP.

FEBRUARY 5, 1980