

Nicholasville

August 5, 2011

Office of Secretary of State
Land Office Branch
700 Capital Avenue, Suite 80
Frankfort, KY 40601

RECEIVED AND FILED
DATE August 8, 2011

ELAINE N. WALKER
SECRETARY OF STATE
COMMONWEALTH OF KENTUCKY
BY Gandie Adkins

Enclosed please find Ordinance 803-2011 establishing a decree of annexation into the City of Nicholasville. As per KRS 81A.470, I am forwarding copies of these Ordinances to your office.

Sincerely,

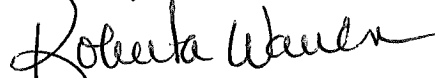

Roberta Warren
City Clerk

Enclosures: ORDINANCE 803-2011

RECEIVED AND FILED
DATE August 8, 2011

ORDINANCE 803-2011

ELAINE N. WALKER
SECRETARY OF STATE
COMMONWEALTH OF KENTUCKY
BY Randie Johnson

AN ORDINANCE ESTABLISHING A DECREE OF ANNEXATION OF
THE HEREINAFTER DESCRIBED PARCEL OF LAND INTO THE CITY
OF NICHOLASVILLE, KENTUCKY

WHEREAS, on FEBRUARY 16, 2011 the City of Nicholasville
by and through its Board of Commissioners passed an Ordinance of
Intent to annex all of the property known and described herein as
Exhibit "A";

WHEREAS, no protest or petition has been filed with the Mayor
of the City of Nicholasville within the sixty (60) days after the
date of the enactment of the Ordinance of Intent;

WHEREAS, the property described in Exhibit A was adjacent or
contiguous to the city's boundaries at the time the annexation
proceeding was begun;

WHEREAS, by reason or population density, commercial,
industrial, institutional, or governmental use of land, or
subdivision of land, is urban in character or suitable for
development for urban purposes without unreasonable delay;

WHEREAS, the City of Nicholasville is still desirous of
extending its corporate city limits by annexing the property known

and described herein as Exhibit "A";

NOW THEREFORE BE AND IT IS HEREBY ORDAINED that based on the findings in the aforesaid preambles which are incorporated by reference the property described herein as Exhibit "A" is annexed into the City Limits of the City of Nicholasville, Jessamine County, Kentucky and a map is attached hereto and identified as Exhibit "B", in accordance with KRS 81A.420.

FIRST READING

DATED: JUNE 27, 2011

ATTEST: Roberta Warren
CITY CLERK

[Signature]
MAYOR

SECOND READING

DATED: JULY 11, 2011

ATTEST: Roberta Warren
CITY CLERK

[Signature]
MAYOR

NOTICE OF ENACTMENT
OF ORDINANCE
Notice is hereby given that the
Nicholasville City Commission on
July 2011 enacted an ordinance, the
full text of which is available for
inspection in the office of the City
Clerk, 517 N. Main Street,
Nicholasville, KY. The ordinance by
title and summary:
ORDINANCE 803-2011:
AN ORDINANCE ESTABLISHING A
DECREE OF ANNEXATION OF THE
HEREINAFTER DESCRIBED PARCEL OF
LAND INTO THE CITY OF
NICHOLASVILLE, KENTUCKY
(Russell Marshall, Jr. Living Trust,
109 Court Row, Nicholasville, KY
40356 for approximately 21.89 acres
of property located at 405 Danville
Road, Loop 1, PVA Parcel
#048-00-00-024.00,
Nicholasville, Kentucky 40356)
Roberta Warren, City Clerk
Published 07/21/11

APPLICATION FOR ANNEXATION
CITY OF NICHOLASVILLE

The undersigned does hereby request annexation of the following property described hereafter.

1. Name of Applicant William Kent Marshall, in his capacity as Administrator of the Estate of Russell Marshall, Jr.
Address 336 Bennett Drive, Nicholasville, KY 40356
Phone Number: Home 859-887-9256 Business 859-269-8806
2. Legal Owner of Land Estate of Russell Marshall, Jr.
Address 336 Bennett Drive, Nicholasville, KY 40356
Phone Number: Home 859-887-9286 Business _____
3. Location Description (Tax or other identification) _____
405 Danville-Loop 1
Map#048-00-00-024.00

(In addition, please attach a metes and bounds description of the property.)

4. Total Acreage ~~21.50~~ 21.89
5. Public services provided by the following utilities:

Water	<u>City of Nicholasville</u>
Sewer	<u>City of Nicholasville</u>
Electric	<u>KU</u>
Gas	<u>N/A</u>
Telephone	<u>Windstream</u>

6. Requests for annexation of property shall include the following:

- a) A plat (map) drawn to scale of the property. Five (5) copies required.
- b) A list of the names and addresses of those property owners and/or registered voters who reside in such area.

- c) A letter which states the following:

1. That the present or future owner(s) of the property will not request the City of Nicholasville to extend water and/or sewer service to the subject property.
2. That it will be the owner(s) responsibility and expense to connect into the City of Nicholasville's existing water and/or sewer lines at a point designated by the City.

- d) The Board of Commission may require additional information, conditions and material other than those listed previously.
7. Cost of annexation shall be borne by the applicant.
8. Upon application to the Board of City Commissioners for annexation, and after the adoption of the ordinance stating the City's intention to annex, the property owner shall make application for an amendment to the Official Zoning Map.

The Board of Commission shall not act upon a proposed annexation until it shall have received the written recommendation of the Planning commission regarding the zone map amendment application. The applicant does hereby agree to extend a waiver for the zone change request in the event that annexation should not occur before the ninety (90) day requirement for action by the Board of Commission upon the Planning Commission's recommendation.

The applicant may withdraw the request for annexation and zone change anytime prior to a final decision by the Board of Commission.

9. It is understood that this request for annexation may be denied by the Board of Commission for any reason.

Applicant: William Kent Marshall
William Kent Marshall, Administrator of the
Estate of Russell Marshall, Jr.
Owner: William Kent Marshall
William Kent Marshall, Administrator of the
Estate of Russell Marshall, Jr.

Date: 07/13/10

Date: 07/13/10

0 250 500 1,000 Feet

NOTE: Property Location is approximate.

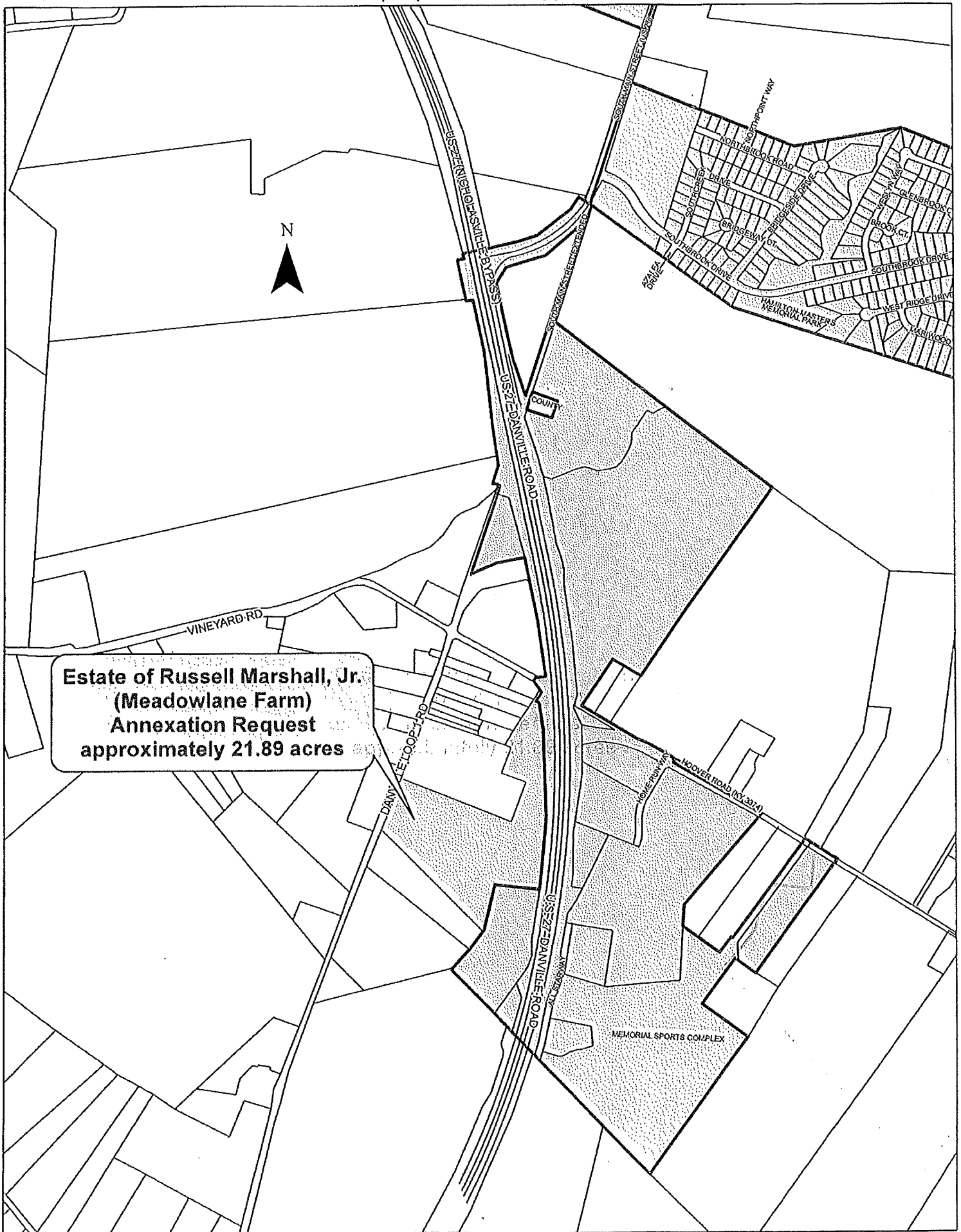

I certify I am the duly qualified City Clerk of the City of Nicholasville, Kentucky and the foregoing four (4) pages of Ordinance 803-2011 is a true, correct and complete copy duly adopted by the City Commission at a duly convened meeting held on June 11, 2011 all as appears in the official records of said city.

WITNESS, my hand and the Seal of the City of Nicholasville, this 5th day of August 2011.

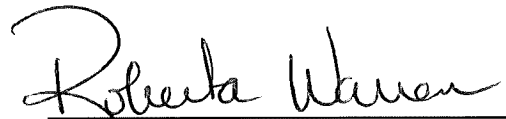

Roberta Warren, City Clerk

Seal

MEADOWLANE FARM

A CERTAIN TRACT OF LAND LOCATED IN JESSAMINE COUNTY, KENTUCKY AND MORE FULLY DESCRIBED AS FOLLOWS: SAID PROPERTY BEING PVA PARCEL 048-00-00-024.00 AND OF RECORD IN DEED BOOK 484, PAGE 673 AND PLAT CABINET 7, SLIDE 158-C IN THE JESSAMINE COUNTY COURTHOUSE.

Beginning at a point in the centerline of Danville Road Loop 1 or KY 3027 thence, along said centerline for the following call, N 20-26-50 E 416.41 feet; thence, leaving said centerline for the following calls; S 69-34-26 E, 901.95 feet; thence N 20-25-35 E, 334.59 feet; thence N 69-37-40 W, 196.76 feet; thence N 20-22-03 E, 201.16 feet; thence N 70-36-44 W, 39.54 feet; thence N 33-45-22 E, 110.99 feet; thence N 33-41-30 E, 297.79 feet to a point in the right-of-way of U.S. 27; thence along said right-of-way for the following calls, S 63-49-21 E, 28.62 feet; thence S 09-38-33 E, 206.28 feet; thence S 02-28-23 E, 688.96 feet; thence S 04-31-12 W, 492.71 feet; thence S 06-46-12 W, 49.46 feet; thence leaving said right-of-way for the following calls; N 84-51-21 W, 344.84 feet; thence S 12-15-47 W, 354.39 feet; thence N 46-45-59 W, 1110.66 feet to the point of beginning and containing 21.89 acres, more or less.

OVERSIZE MAP INCLUDED WITH
SUBMISSION.

To research the map, contact the
Office of Secretary of State
or the County Clerk.