



City of Owensboro
Kentucky
TEL. (502) 685-8200

P. O. BOX 847
OWENSBORO, KENTUCKY 42302
RECEIVED

November 18, 1987

NOV 19 1987

SECRETARY OF STATE
COMMONWEALTH OF KY

Hon. Drexell R. Davis
Office of Secretary of State
Commonwealth of Kentucky
Frankfort, KY 40601

Attention: Marvin Thornton
Land Office

Gentlemen:

Re: Final annexations of three
parcels of property into
the City of Owensboro, Kentucky

Enclosed herewith are the papers evidencing final annexation of three parcels of property into the City of Owensboro, Kentucky, for recording in the office of the Secretary of State as follows:

1. Unit 2 in Brookhill Subdivision - 9.7 acres
2. South side of Ford Avenue in the 1800-2000 block, west of Lewis Lane - 8.5 acres
3. Unit 2-G in Lakewood Subdivision - 5.783 acres

Your attention to this matter is appreciated.

Sincerely,

Carol Blake
City Clerk

Enclosures

ORDINANCE NO. 67-87

AN ORDINANCE ANNEXING TO THE CITY OF OWENSBORO, KENTUCKY, CERTAIN UNINCORPORATED TERRITORY IN THE COUNTY OF DAVIESS ADJOINING THE PRESENT BOUNDARY LINE OF THE CITY, BEING UNIT NO. 2 IN BROOKHILL SUBDIVISION (LOCATED IN THE 4100 AND 4200 BLOCKS OF BROOKHILL DRIVE AND IN THE 2500 BLOCK OF LITTLE BROOK TRAIL), CONTAINING 9.7 ACRES, MORE OR LESS.

WHEREAS, by Ordinance No. 57-87, heretofore passed by the Board of Commissioners of the City of Owensboro, Kentucky, on October 20, 1987, the City proposed to annex certain territory hereinafter more particularly described, and

WHEREAS, said ordinance has been published in the official newspaper for the city and a waiver of the sixty (60) day waiting period from the owner of the property to be annexed has been received.

NOW, THEREFORE, BE IT ORDAINED BY THE CITY OF OWENSBORO, KENTUCKY, AS FOLLOWS:

SECTION 1. There is hereby annexed to the City of Owensboro, Kentucky, and its boundary line is hereby extended so as to include within the limits of the City of Owensboro that certain territory in the County of Daviess, State of Kentucky, adjoining and being adjacent to the present boundary line of the City of Owensboro, Kentucky, more particularly described as follows:

BEGINNING at a point in the west line of Kenneth Westerfield and the northeast corner of Brookhill Subdivision and being in the present city limits; thence with the north line of said subdivision and with the present city limit line south 67 degrees 29 minutes west 471 feet more or less to a point at the northwest corner of Brookhill Subdivision; thence generally with a ditch and leaving the present city limits north 29 degrees 30 minutes west 360 feet more or less to a point; thence north 15 degrees 10 minutes west 85 feet more or less to a point; thence leaving the ditch north 65 degrees 16 minutes east 118 feet more or less to a point; thence north 24 degrees 44 minutes west 557 feet more or less to a point; thence north 65 degrees 16 minutes east 370 feet more or less to a point in the west line of Kenneth Westerfield; thence

with the line of Westerfield south 24 degrees 44 minutes east 1,015 feet more or less to the point of beginning and containing 9.7 acres, more or less.

SECTION 2. Any dedicated streets, alleys, or easements constituting any portion of the property to be annexed are hereby accepted by the City of Owensboro pursuant to KRS 82.400(2).

INTRODUCED AND PUBLICLY READ ON FIRST READING, this the 4th day of November, 1987.

PUBLICLY READ AND FINALLY APPROVED ON SECOND READING, this the 17th day of November, 1987.

/s/ Jack C. Fisher
Mayor

ATTEST:

/s/ Carol Blake
City Clerk

C E R T I F I C A T I O N

I, Carol Blake, City Clerk of the City of Owensboro, Kentucky, do hereby certify that the foregoing is a true and correct copy of Ordinance No. 67-87, duly adopted by the Board of Commissioners of the City of Owensboro, Kentucky on November 17, 1987, the original of which is on file in the office of the City Clerk.

This the 18th day of November, 1987.

Carol Blake
City Clerk

ANNEXATION REQUESTED BY:

John M. Wells
4358 Brookhill Drive
Owensboro, Kentucky 42301
Phone: 684-8901 (502)

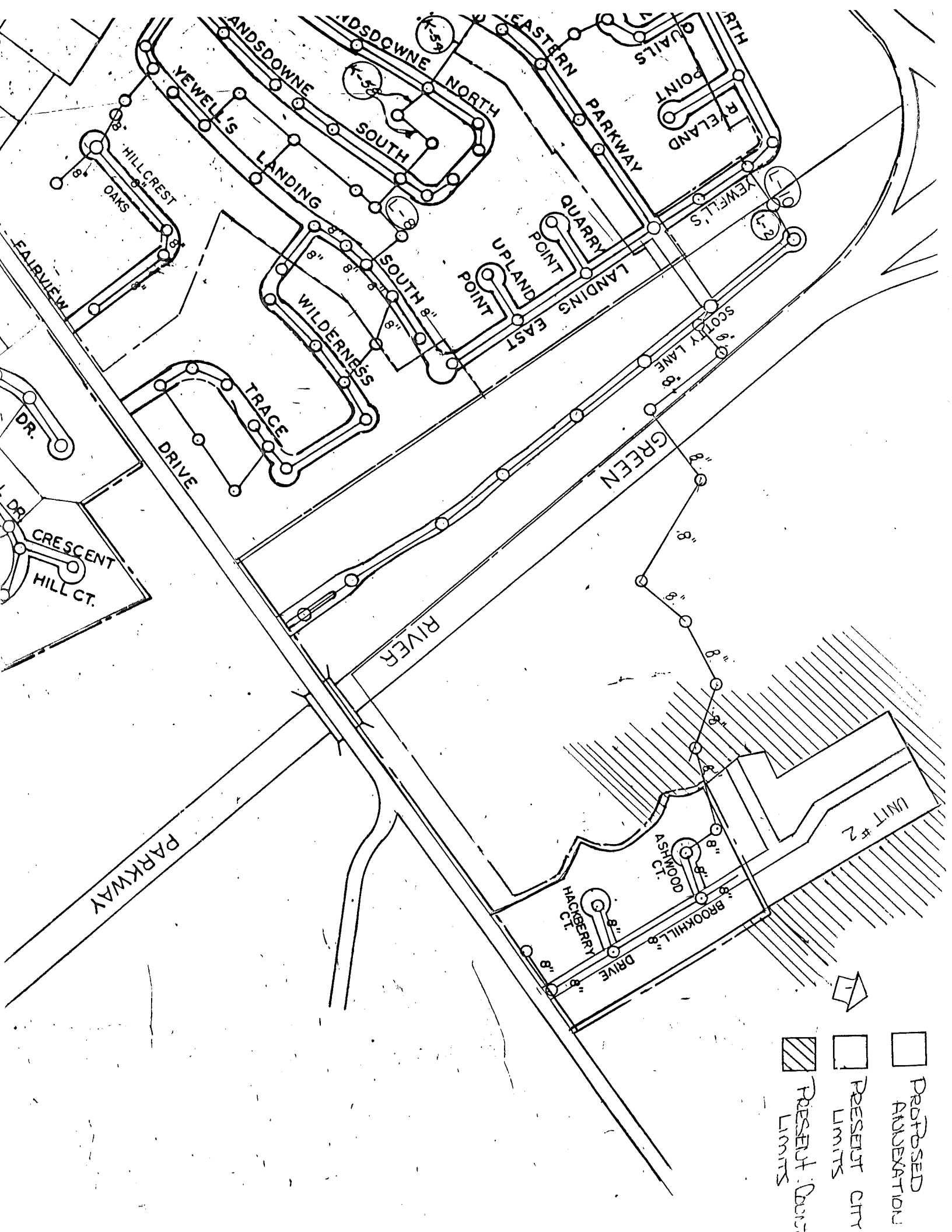

- ☐ PROPOSED ADDITION
- ☐ PRESENT CITY LIMITS
- ☐ PRESENT COUNTY LIMITS