



City of Owensboro
Kentucky
TEL. (502) 685-8200

P. O. BOX 847
OWENSBORO, KENTUCKY 42302

June 8, 1988

SECRETARY OF STATE
RECEIVED
JUN 09 1988
Commonwealth of Kentucky

Hon. Bremer Ehrler
Office of Secretary of State
Commonwealth of Kentucky
Frankfort, KY 40601

Attention: Marvin Thornton
Land Office

Gentlemen:

Re: Final annexation
4610 South Frederica Street
Owensboro, Kentucky

Enclosed herewith are the papers evidencing final annexation of 4610 South Frederica Street (Towne Square North Shopping Center), containing 0.308 acres, into the City of Owensboro, Kentucky, for recording in the office of the Secretary of State.

Your attention to this matter is appreciated.

Sincerely,

Carol Blake
Carol Blake
City Clerk

Enclosures

ORDINANCE NO. 15-88

AN ORDINANCE ANNEXING TO THE CITY OF OWENSBORO, KENTUCKY, CERTAIN UNINCORPORATED TERRITORY IN THE COUNTY OF DAVIESS ADJOINING THE PRESENT BOUNDARY LINE OF THE CITY, BEING A PORTION OF 4610 SOUTH FREDERICA STREET (TOWNE SQUARE NORTH SHOPPING CENTER), CONTAINING 0.308 ACRES, MORE OR LESS.

WHEREAS, by Ordinance No. 13-88, heretofore passed by the Board of Commissioners of the City of Owensboro, Kentucky, on May 3, 1988, the City proposed to annex certain territory hereinafter more particularly described, and

WHEREAS, said ordinance has been published in the official newspaper for the city and a waiver of the sixty (60) day waiting period from the owner of the property to be annexed has been received.

NOW, THEREFORE, BE IT ORDAINED BY THE CITY OF OWENSBORO, KENTUCKY, AS FOLLOWS:

SECTION 1. There is hereby annexed to the City of Owensboro, Kentucky, and its boundary line is hereby extended so as to include within the limits of the City of Owensboro that certain territory in the County of Daviess, State of Kentucky, adjoining and being adjacent to the present boundary line of the City of Owensboro, Kentucky, more particularly described as follows:

BEGINNING at an iron pin, said pin being in the south line of the Tom Goetz property, and being south 73 degrees 49 minutes 23 seconds east and 64.22 feet from the northwest corner to the Towne Square North property; thence north 73 degrees 51 minutes 25 seconds east, 131.67 feet to an iron pin; thence south 77 degrees 57 minutes 55 seconds east 130.00 feet to an iron pin, said pin being in the east property line of the Tom Goetz property; thence with Goetz east line and with the present city limits south 16 degrees 12 minutes 50 seconds west, 79.00 feet to an iron pin; thence with the present city limits north 73 degrees 49 minutes 23 seconds west, 240.92 feet to the point of beginning and containing 0.308 acres, more or less.

SECTION 2. Any dedicated streets, alleys, or easements constituting any portion of the property to be annexed are hereby accepted by the City of Owensboro pursuant to KRS 82.400(2).

INTRODUCED AND PUBLICLY READ ON FIRST READING, this the 17th day of May, 1988.

PUBLICLY READ AND FINALLY APPROVED ON SECOND READING, this the 7th day of June, 1988.

/s/ David Adkisson
Mayor

ATTEST:

/s/ Carol Blake
City Clerk

C E R T I F I C A T I O N

I, Carol Blake, City Clerk of the City of Owensboro, Kentucky, do hereby certify that the foregoing is a true and correct copy of Ordinance No. 15-88, duly adopted by the Board of Commissioners of the City of Owensboro, Kentucky, on June 7, 1988, the original of which is on file in the office of the City Clerk.
This the 8th day of June, 1988.

Carol Blake
City Clerk

ANNEXATION REQUESTED BY:

David Hocker & Associates (by Gary Joy)
P. O. Box 1539
Owensboro, Kentucky 42302
Phone: 502-926-2616

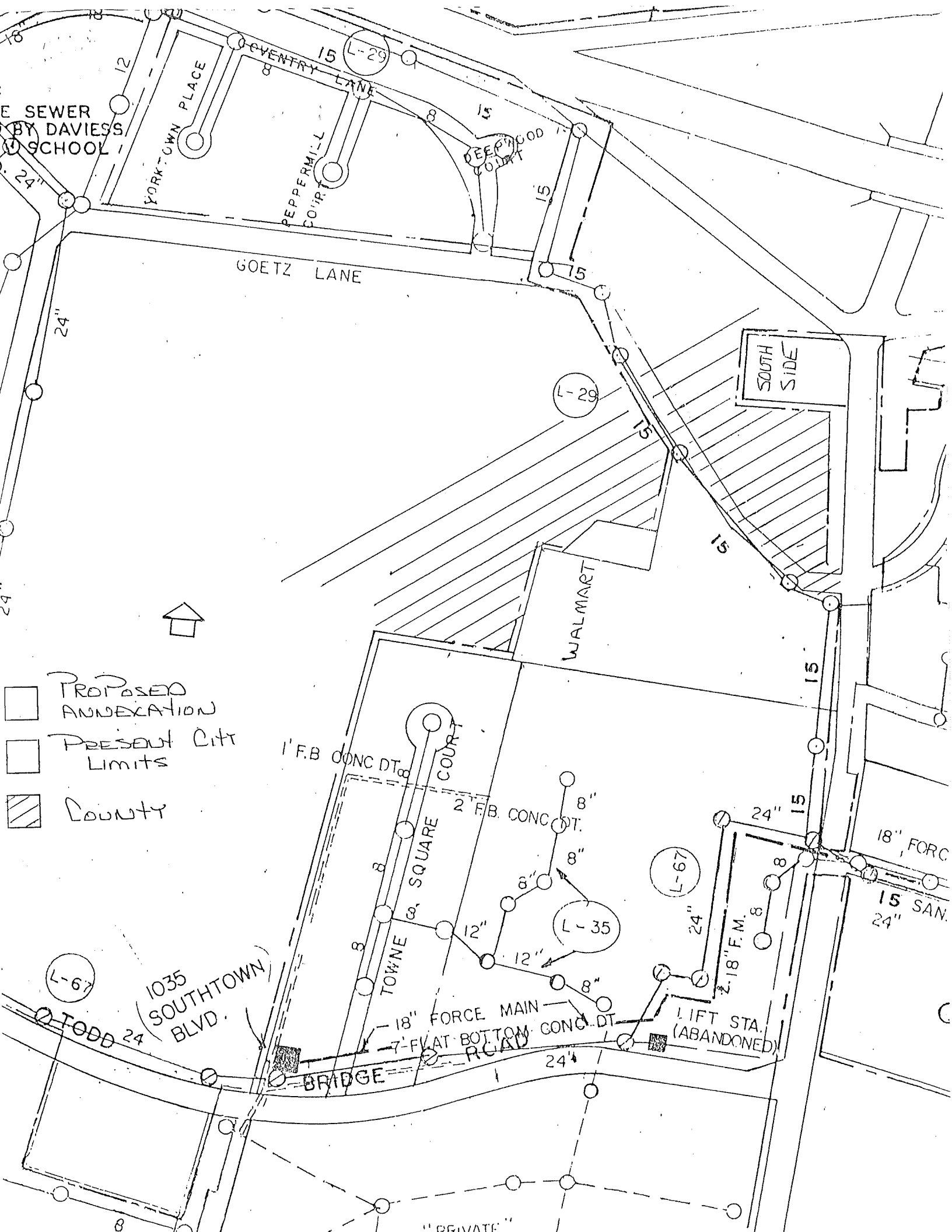

E SEWER
BY DAVIESS
SCHOOL

YORKTOWN PLACE

PEPPERMILL COURT

DEEPWOOD COURT

GOETZ LANE

SOUTH
SIDE

WALMAST

- PROPOSED ANNEXATION
- PRESSENT City Limits
- County

1' F.B. CONC. DT.

TOWNE SQUARE COURT

2' F.B. CONC. DT.

TOWNE SQUARE COURT

L-67

1035 SOUTHTOWN BLVD.

TODD 24"

BRIDGE

ROAD

24"

18" FORCE MAIN

7' FLAT BOTTOM CONC. DT.

L-35

L-67

LIFT STA. (ABANDONED)

2' 18" F.M.

18" FORC

15" SAN.

"PRIVATE"