



City of Owensboro
Kentucky
TEL. (502) 685-8200

P. O. BOX 847
OWENSBORO, KENTUCKY 42302

July 3, 1990

RECEIVED
JUL 05 1990
SECRETARY OF STATE
COMMONWEALTH OF KY

Hon. Bremer Ehrler
Office of Secretary of State
Commonwealth of Kentucky
Frankfort, KY 40601

Attention: Arthur Vogedes
Land Office

Gentlemen:

Re: Final annexation of
1835 Hacienda Lane

Enclosed herewith are the papers evidencing final annexation of 1835 Hacienda Lane into the City of Owensboro, Kentucky, for recording in the office of the Secretary of State.

Thank you for your continued assistance and cooperation.

Sincerely,

Carol Blake
City Clerk

Enclosures

ORDINANCE NO. 29-90

AN ORDINANCE ANNEXING TO THE CITY OF OWENSBORO, KENTUCKY, CERTAIN UNINCORPORATED TERRITORY IN THE COUNTY OF DAVIESS ADJOINING THE PRESENT BOUNDARY LINE OF THE CITY, BEING PROPERTY LOCATED AT 1835 HACIENDA LANE, CONTAINING 0.918 ACRES, MORE OR LESS.

WHEREAS, by Ordinance No. 27-90, heretofore passed by the Board of Commissioners of the City of Owensboro, Kentucky, on May 29, 1990, the City proposed to annex certain territory hereinafter more particularly described, and

WHEREAS, said ordinance has been published in the official newspaper for the city and the sixty (60) day waiting period has been waived in accordance with KRS 81A.412 by virtue of said owners application for annexation.

NOW, THEREFORE, BE IT ORDAINED BY THE CITY OF OWENSBORO, KENTUCKY, AS FOLLOWS:

SECTION 1. There is hereby annexed to the City of Owensboro, Kentucky, and its boundary line is hereby extended so as to include within the limits of the City of Owensboro that certain territory in the County of Daviess, State of Kentucky, adjoining and being adjacent to the present boundary line of the City of Owensboro, Kentucky, more particularly described as follows:

BEGINNING at a point being the S.E. property corner to 1835 Hacienda Lane and being in the north margin of Hacienda Lane; thence with the north margin of Hacienda Lane S 50 degrees 37 minutes W 115 feet to a point; thence N 49 degrees 22 minutes W 216 feet to a point; thence N 40 degrees 38 minutes E 22 feet to a point; thence N 49 degrees 22 minutes W 65.88 feet to a point being in the present city limits; thence continuing with the city limits N 38 degrees 31 minutes E to a point; thence S 39 degrees 23 minutes E 311.91 feet to the point of beginning and containing 0.918 acres, more or less.

SECTION 2. Any dedicated streets, alleys, or easements constituting any portion of the property to be annexed are hereby accepted by the City of Owensboro pursuant to KRS 82.400(2).

INTRODUCED AND PUBLICLY READ ON FIRST READING, this the

26th day of June, 1990.

PUBLICLY READ AND FINALLY APPROVED ON SECOND READING, this

the 3rd day of July, 1990.

/s/ David C. Adkisson

Mayor

ATTEST:

Carol Blake
City Clerk

C E R T I F I C A T I O N

I, Carol Blake, City Clerk of the City of Owensboro, Kentucky, do hereby certify that the foregoing is a true and correct copy of Ordinance No. 29-90, duly adopted by the Board of Commissioners of the City of Owensboro, Kentucky, on July 3, 1990, the original of which is on file in the office of the City Clerk.

This the 3rd day of July, 1990.

Carol Blake
Carol Blake, City Clerk

ANNEXATION REQUESTED BY:

Steve and Gloria Baker
1841 Hacienda Lane
Owensboro, Kentucky 42303

Phone: (502) 683-3969

ON DOTTED SEWER

- PROPOSED ANNEXATION
- PRESIDENT CITY LIMITS
- PRESIDENT COUNTY LINE

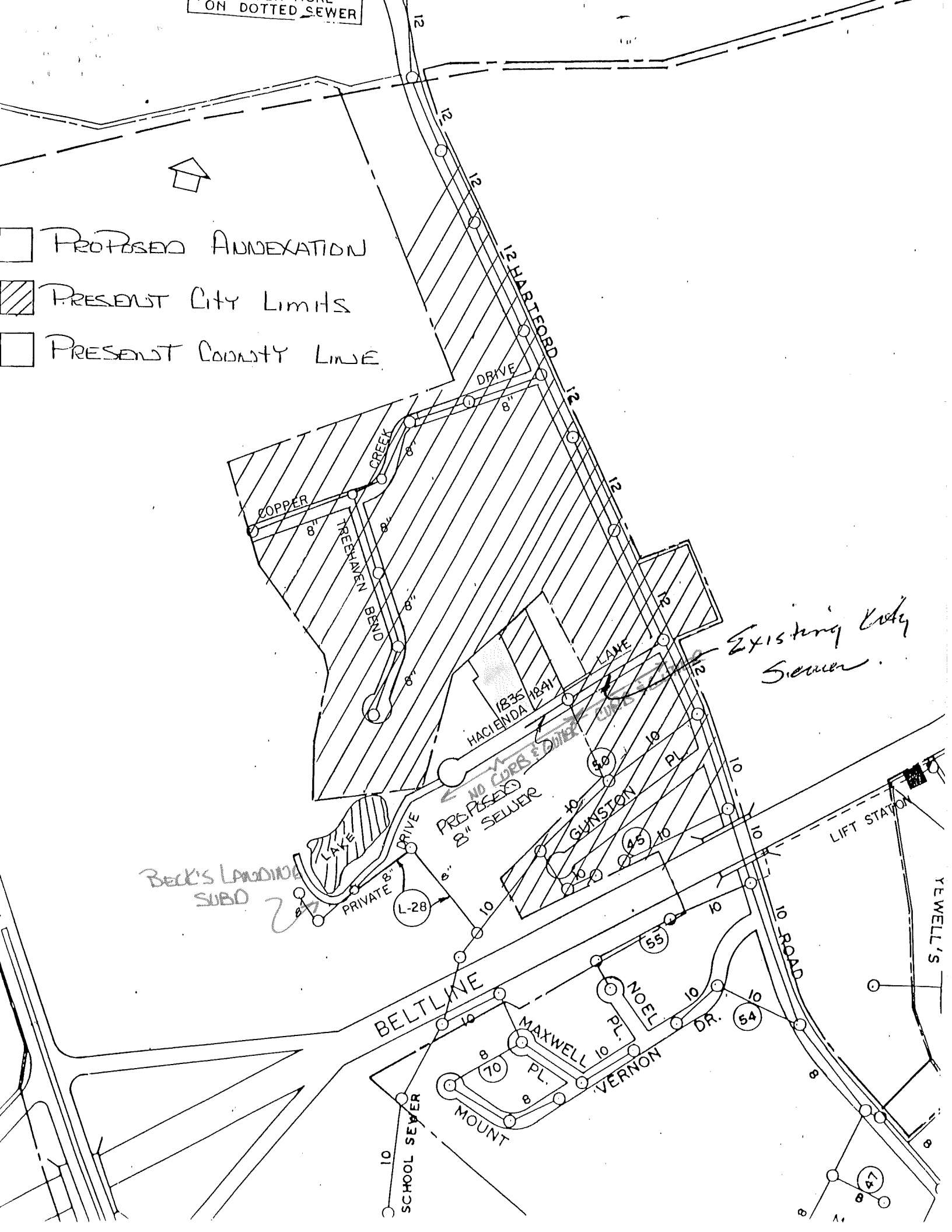

Existing City
Sewer.