



City of Owensboro  
Kentucky  
TEL. (502) 685-8200

P. O. BOX 847  
OWENSBORO, KENTUCKY 42302

November 21, 1990

RECEIVED

NOV 23 1990

SECRETARY OF STATE  
COMMONWEALTH OF KY

Hon. Bremer Ehrler  
Office of Secretary of State  
Commonwealth of Kentucky  
Frankfort, KY 40601

Attention: Arthur Vogedes  
Land Office

Gentlemen:

Re: Final annexation of:

1. Tracts A & B in  
Landsdowne Subdivision
2. Unit No. 3 of Hillcrest  
Oaks Subdivision

Enclosed herewith are the papers evidencing final annexation of Tracts A & B in Landsdowne Subdivision, and Unit No. 3 of Hillcrest Oaks Subdivision into the City of Owensboro, Kentucky, for recording in the office of the Secretary of State.

Thank you for your continued assistance and cooperation.

Sincerely,

Carol Blake  
City Clerk

Enclosures



City of Owensboro  
Kentucky  
TEL. (502) 685-8200

P. O. BOX 847  
OWENSBORO, KENTUCKY 42302

November 21, 1990

RECEIVED

NOV 23 1990

SECRETARY OF STATE  
COMMONWEALTH OF KY

Hon. Bremer Ehrler  
Office of Secretary of State  
Commonwealth of Kentucky  
Frankfort, KY 40601

Attention: Arthur Vogedes  
Land Office

Gentlemen:

Re: Final annexation of:

1. Tracts A & B in  
Landsdowne Subdivision
2. Unit No. 3 of Hillcrest  
Oaks Subdivision

Enclosed herewith are the papers evidencing final annexation of Tracts A & B in Landsdowne Subdivision, and Unit No. 3 of Hillcrest Oaks Subdivision into the City of Owensboro, Kentucky, for recording in the office of the Secretary of State.

Thank you for your continued assistance and cooperation.

Sincerely,

Carol Blake  
City Clerk

Enclosures

ORDINANCE NO. 63-90

AN ORDINANCE ANNEXING TO THE CITY OF OWENSBORO, KENTUCKY, CERTAIN UNINCORPORATED TERRITORY IN THE COUNTY OF DAVIESS ADJOINING THE PRESENT BOUNDARY LINE OF THE CITY, BEING UNIT NO. 3 OF HILLCREST OAKS SUBDIVISION, CONTAINING 4.43 ACRES, MORE OR LESS.

WHEREAS, by Ordinance No. 50-90, heretofore passed by the Board of Commissioners of the City of Owensboro, Kentucky, on October 16, 1990, the City proposed to annex certain territory hereinafter more particularly described, and

WHEREAS, said ordinance has been published in the official newspaper for the city and the sixty (60) day waiting period has been waived in accordance with KRS 81A.412 by virtue of said owners application for annexation.

NOW, THEREFORE, BE IT ORDAINED BY THE CITY OF OWENSBORO, KENTUCKY, AS FOLLOWS:

SECTION 1. There is hereby annexed to the City of Owensboro, Kentucky, and its boundary line is hereby extended so as to include within the limits of the City of Owensboro that certain territory in the County of Daviess, State of Kentucky, adjoining and being adjacent to the present boundary line of the City of Owensboro, Kentucky, more particularly described as follows:

BEGINNING at an iron pin in the south margin of Wilderness Trace, said iron pin being in the northwest corner of Lot No. 394, Unit No. 2 Hillcrest Oaks Subdivision and also being in the present city limits; thence with the present city limits south 34 degrees 32 minutes east 141.00 feet, south 55 degrees 28 minutes west 198.17 feet, south 32 degrees 11 minutes west 342.77 feet, north 57 degrees 49 minutes west 171.78 feet; north 60 degrees 34 minutes west 165.97 feet; north 35 degrees 36 minutes east 8.04 feet; north 34 degrees 55 minutes east 343.59 feet; north 34 degrees 54 minutes east 120.83 feet, north 57 degrees 28 minutes east 151.09 feet; south 41 degrees 26 minutes east 141.31 feet to an iron pin in the north margin of Wilderness Trace; thence south 75 degrees 18 minutes east 66.06 feet to point of beginning and containing 4.43 acres, more or less.

SECTION 2. Any dedicated streets, alleys, or easements constituting any portion of the property to be annexed are hereby accepted by the City of Owensboro pursuant to KRS 82.400.

INTRODUCED AND PUBLICLY READ ON FIRST READING, this the  
6th day of November, 1990.

PUBLICLY READ AND FINALLY APPROVED ON SECOND READING, this  
the 20th day of November, 1990.

/s/ David C. Adkisson  
Mayor

ATTEST:

/s/ Carol Blake  
City Clerk

C E R T I F I C A T I O N

I, Carol Blake, City Clerk of the City of Owensboro, Kentucky, do hereby certify that the foregoing is a true and correct copy of Ordinance No. 63-90, duly adopted by the Board of Commissioners of the City of Owensboro, Kentucky, on November 20, 1990, the original of which is on file in the office of the City Clerk.

This the 21st day of November, 1990.

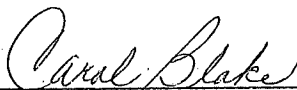
  
Carol Blake, City Clerk

ANNEXATION REQUESTED BY:

Jagoe Development Corporation  
c/o William Jagoe  
2350 Tamarack Road  
Owensboro, KY 42301

Phone: 502-684-0639

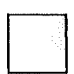
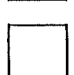
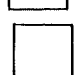
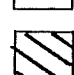
-  PROPOSED ANNEXATION
-  PRESENT CITY LIMITS
-  PRESENT COUNTY LINE
-  ANNEXATION IN PROGRESS

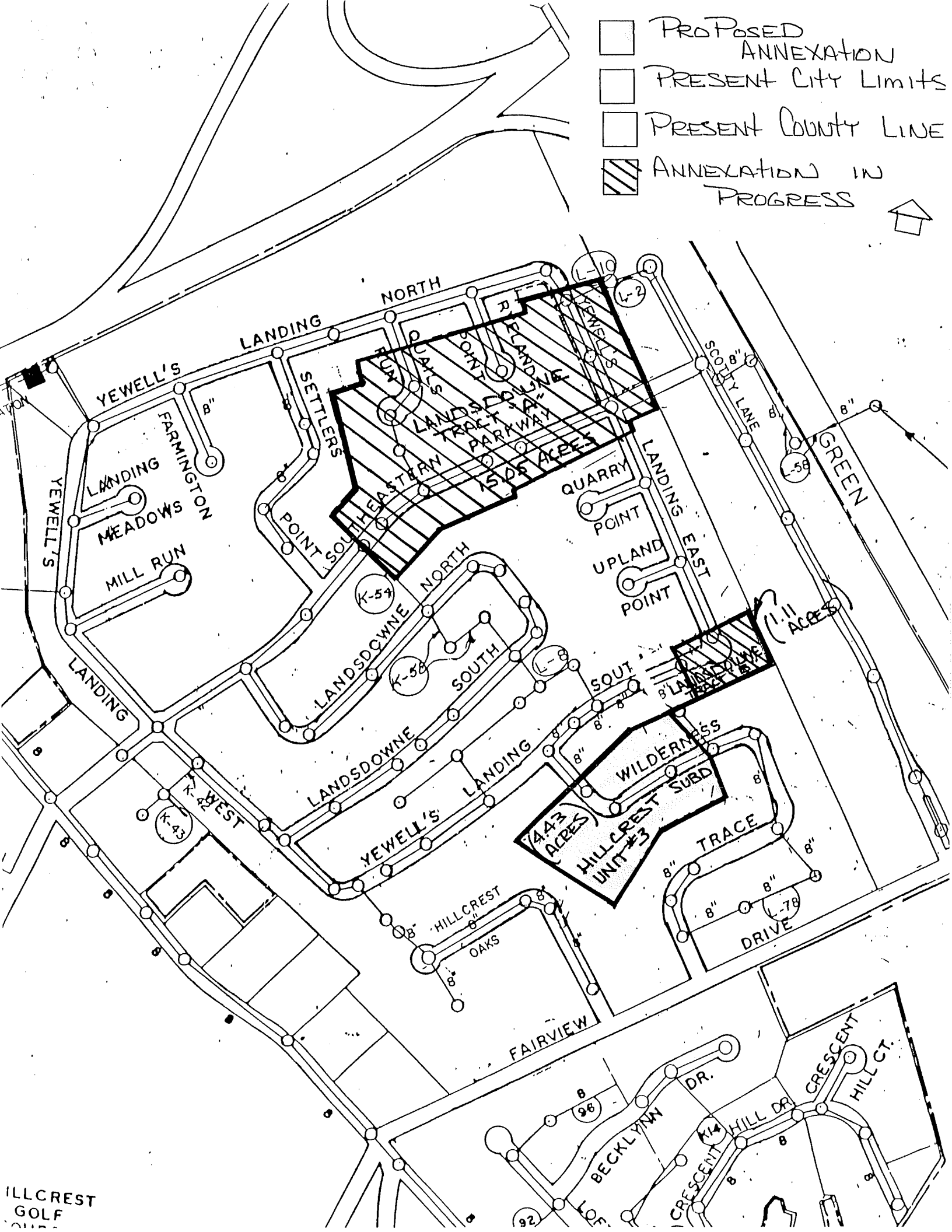

ORDINANCE NO. 63-90

AN ORDINANCE ANNEXING TO THE CITY OF OWENSBORO, KENTUCKY, CERTAIN UNINCORPORATED TERRITORY IN THE COUNTY OF DAVIESS ADJOINING THE PRESENT BOUNDARY LINE OF THE CITY, BEING UNIT NO. 3 OF HILLCREST OAKS SUBDIVISION, CONTAINING 4.43 ACRES, MORE OR LESS.

WHEREAS, by Ordinance No. 50-90, heretofore passed by the Board of Commissioners of the City of Owensboro, Kentucky, on October 16, 1990, the City proposed to annex certain territory hereinafter more particularly described, and

WHEREAS, said ordinance has been published in the official newspaper for the city and the sixty (60) day waiting period has been waived in accordance with KRS 81A.412 by virtue of said owners application for annexation.

NOW, THEREFORE, BE IT ORDAINED BY THE CITY OF OWENSBORO, KENTUCKY, AS FOLLOWS:

SECTION 1. There is hereby annexed to the City of Owensboro, Kentucky, and its boundary line is hereby extended so as to include within the limits of the City of Owensboro that certain territory in the County of Daviess, State of Kentucky, adjoining and being adjacent to the present boundary line of the City of Owensboro, Kentucky, more particularly described as follows:

BEGINNING at an iron pin in the south margin of Wilderness Trace, said iron pin being in the northwest corner of Lot No. 394, Unit No. 2 Hillcrest Oaks Subdivision and also being in the present city limits; thence with the present city limits south 34 degrees 32 minutes east 141.00 feet, south 55 degrees 28 minutes west 198.17 feet, south 32 degrees 11 minutes west 342.77 feet, north 57 degrees 49 minutes west 171.78 feet; north 60 degrees 34 minutes west 165.97 feet; north 35 degrees 36 minutes east 8.04 feet; north 34 degrees 55 minutes east 343.59 feet; north 34 degrees 54 minutes east 120.83 feet, north 57 degrees 28 minutes east 151.09 feet; south 41 degrees 26 minutes east 141.31 feet to an iron pin in the north margin of Wilderness Trace; thence south 75 degrees 18 minutes east 66.06 feet to point of beginning and containing 4.43 acres, more or less.

SECTION 2. Any dedicated streets, alleys, or easements constituting any portion of the property to be annexed are hereby accepted by the City of Owensboro pursuant to KRS 82.400.

INTRODUCED AND PUBLICLY READ ON FIRST READING, this the  
6th day of November, 1990.

PUBLICLY READ AND FINALLY APPROVED ON SECOND READING, this  
the 20th day of November, 1990.

/s/ David C. Adkisson  
Mayor

ATTEST:

/s/ Carol Blake  
City Clerk

C E R T I F I C A T I O N

I, Carol Blake, City Clerk of the City of Owensboro, Kentucky, do hereby certify that the foregoing is a true and correct copy of Ordinance No. 63-90, duly adopted by the Board of Commissioners of the City of Owensboro, Kentucky, on November 20, 1990, the original of which is on file in the office of the City Clerk.

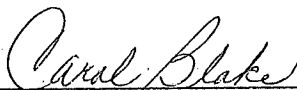

This the 21st day of November, 1990.

  
Carol Blake, City Clerk

ANNEXATION REQUESTED BY:

Jagoe Development Corporation  
c/o William Jagoe  
2350 Tamarack Road  
Owensboro, KY 42301

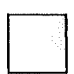
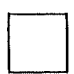
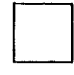
Phone: 502-684-0639

-  PROPOSED ANNEXATION
-  PRESENT CITY LIMITS
-  PRESENT COUNTY LINE
-  ANNEXATION IN PROGRESS

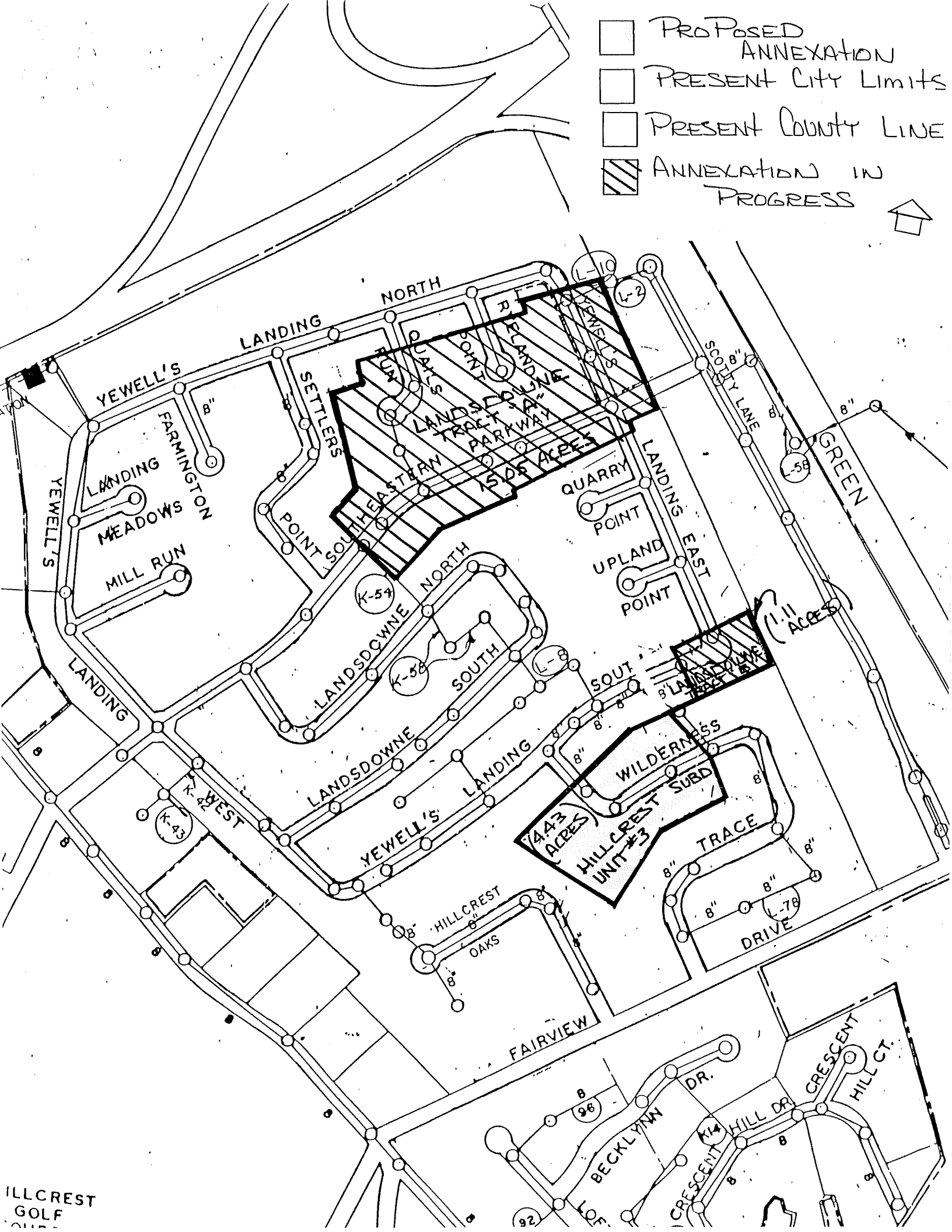

HILLCREST GOLF COURSE