



City of Owensboro
Kentucky
TEL. (502) 685-8200

P. O. BOX 847
OWENSBORO, KENTUCKY 42302

November 21, 1990

RECEIVED

NOV 23 1990

SECRETARY OF STATE
COMMONWEALTH OF KY

Hon. Bremer Ehrler
Office of Secretary of State
Commonwealth of Kentucky
Frankfort, KY 40601

Attention: Arthur Vogedes
Land Office

Gentlemen:

Re: Final annexation of:

1. Tracts A & B in
Landsdowne Subdivision
2. Unit No. 3 of Hillcrest
Oaks Subdivision

Enclosed herewith are the papers evidencing final annexation of Tracts A & B in Landsdowne Subdivision, and Unit No. 3 of Hillcrest Oaks Subdivision into the City of Owensboro, Kentucky, for recording in the office of the Secretary of State.

Thank you for your continued assistance and cooperation.

Sincerely,

Carol Blake
City Clerk

Enclosures

ORDINANCE NO. 62-90

AN ORDINANCE ANNEXING TO THE CITY OF OWENSBORO, KENTUCKY, CERTAIN UNINCORPORATED TERRITORY IN THE COUNTY OF DAVIESS ADJOINING THE PRESENT BOUNDARY LINE OF THE CITY, BEING TRACTS A & B IN LANDSDOWNE SUBDIVISION, CONTAINING 16.16 ACRES, MORE OR LESS.

WHEREAS, by Ordinance No. 49-90, heretofore passed by the Board of Commissioners of the City of Owensboro, Kentucky, on October 16, 1990, the City proposed to annex certain territory hereinafter more particularly described, and

WHEREAS, said ordinance has been published in the official newspaper for the city and the sixty (60) day waiting period has been waived in accordance with KRS 81A.412 by virtue of said owners application for annexation.

NOW, THEREFORE, BE IT ORDAINED BY THE CITY OF OWENSBORO, KENTUCKY, AS FOLLOWS:

SECTION 1. There is hereby annexed to the City of Owensboro, Kentucky, and its boundary line is hereby extended so as to include within the limits of the City of Owensboro that certain territory in the County of Daviess, State of Kentucky, adjoining and being adjacent to the present boundary line of the City of Owensboro, Kentucky, more particularly described as follows:

Landsdowne Subdivision - Tract "A"

BEGINNING at a point in the west margin of Southeastern Parkway, said point being the corner to Lot No. 182, Unit No. 4 Landsdowne Subdivision and also being in the present city limits; thence with the present city limits north 54 degrees 35 minutes west 115 feet; north 35 degrees 26 minutes east 140.05 feet; north 29 degrees 36 minutes west 118.61 feet; north 30 degrees 47 minutes west 273.86 feet; north 59 degrees 13 minutes east 140.00 feet; north 30 degrees 47 minutes west 70.00 feet; north 59 degrees 13 minutes east 566.26 feet; north 30 degrees 56 minutes west 50.00 feet; north 59 degrees 13 minutes east 55.00 feet; north 64 degrees 21 minutes east 80.00 feet; north 74 degrees 34 minutes east 144.00 feet to a point in line of Fairview Heights Subdivision; thence with line of Fairview Heights Subdivision South 30 degrees 55 minutes east 561.66 feet; thence leaving line of Fairview Heights Subdivision

South 59 degrees 05 minutes west 115.00 feet;
south 30 degrees 55 minutes east 43.34 feet;
south 59 degrees 05 minutes west 405.00 feet;
south 27 degrees 25 minutes east 45.10 feet;
south 47 degrees 04 minutes west 307.43 feet;
south 35 degrees 51 minutes west 208.22 feet;
north 58 degrees 33 minutes west 115.31 feet;
north 29 degrees 35 minutes west 55.19 feet to
the point of beginning and containing 15.05
acres, more or less.

Landsdowne Subdivision - Tract "B"

BEGINNING at a point in the west line of Fairview Heights Subdivision and the east line of Landsdowne Subdivision, said point being 784.43 feet north of the north margin of Fairview Drive and being the northeast corner of Hillcrest Oaks Subdivision Unit No. 3, said point also being in the present city limits; thence with the present city limits south 57 degrees 28 minutes west 245.80 feet; north 32 degrees 32 minutes west 196.67 feet; north 57 degrees 28 minutes east 245.80 feet to a point in the west line of Fairview Heights Subdivision; thence south 32 degrees 32 minutes east 196.67 feet to the point of beginning and containing 1.11 acres, more or less.

SECTION 2. Any dedicated streets, alleys, or easements constituting any portion of the property to be annexed are hereby accepted by the City of Owensboro pursuant to KRS 82.400.

INTRODUCED AND PUBLICLY READ ON FIRST READING, this the

6th day of November, 1990.

PUBLICLY READ AND FINALLY APPROVED ON SECOND READING, this

the 20th day of November, 1990.

/s/ David C. Adkisson

Mayor

ATTEST:

/s/ Carol Blake

City Clerk

C E R T I F I C A T I O N

I, Carol Blake, City Clerk of the City of Owensboro, Kentucky, do hereby certify that the foregoing is a true and correct copy of Ordinance No. 62-90, duly adopted by the Board of Commissioners of the City of Owensboro, Kentucky, on November 20, 1990, the original of which is on file in the office of the City Clerk.

This the 21st day of November, 1990.



Carol Blake

Carol Blake, City Clerk

ANNEXATION REQUESTED BY:

Jagoe Development Corp., 2350 Tamarack Road, Owensboro, KY 42301
Phone: 502-684-0639

Attn: William Jagoe

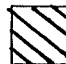
-  PROPOSED ANNEXATION
-  PRESENT CITY LIMITS
-  PRESENT COUNTY LINE
-  ANNEXATION IN PROGRESS

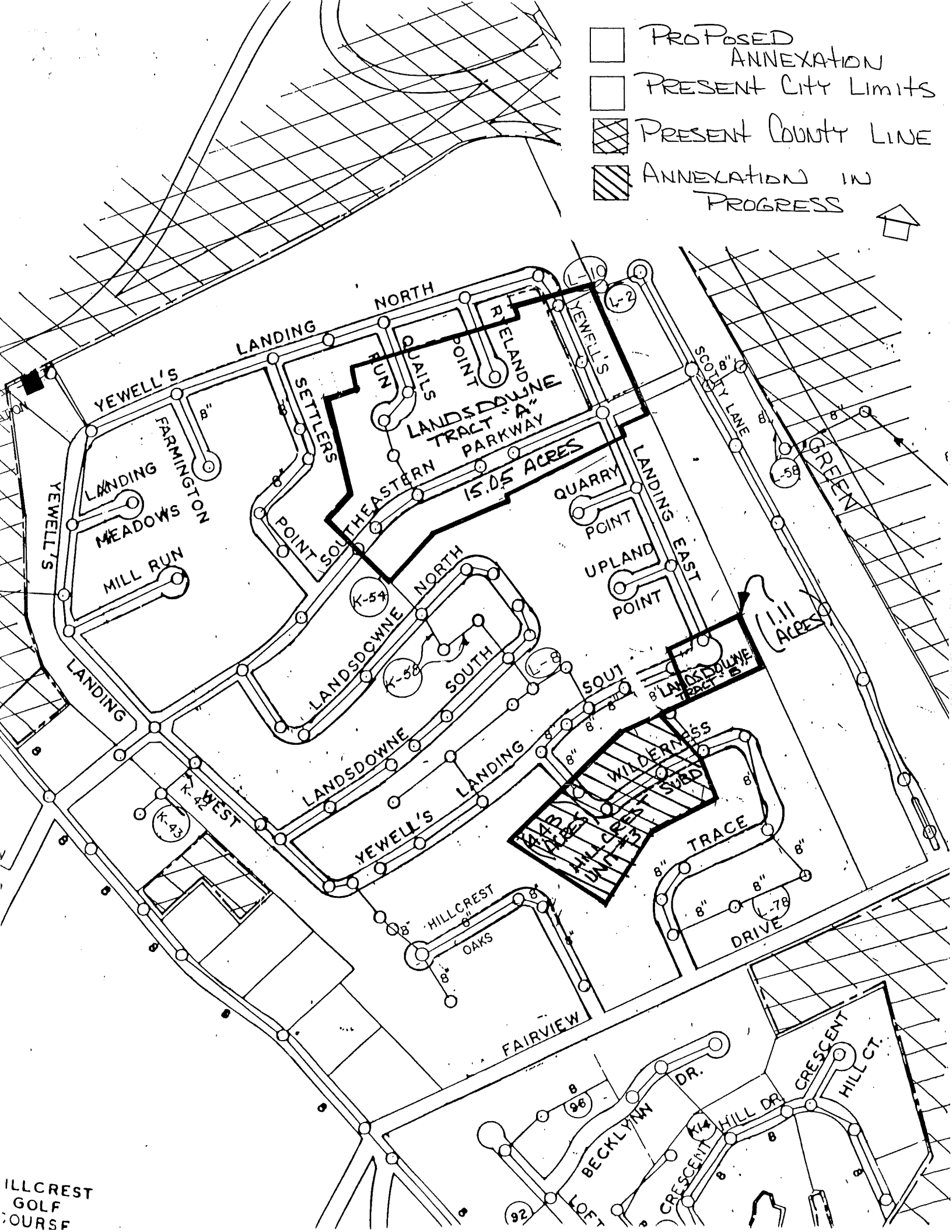

HILLCREST GOLF COURSE