



City of Owensboro
Kentucky

P.O. BOX 10003
OWENSBORO, KENTUCKY 42302-9003

MAYOR
WAYMOND MORRIS
MAYOR PRO-TEM
R.L. MCFARLAND, SR.
COMMISSIONERS
HOWARD WHITEHOUSE
ALAN BRADEN
OLIVE BURROUGHS

April 17, 1996

RECEIVED

APR 22 1996

SECRETARY OF STATE
COMMONWEALTH OF KY

Hon. John Y. Brown, III
Office of Secretary of State
Commonwealth of Kentucky
Frankfort, KY 40601

Attention: Kandie Adkinson
Land Office

Gentlemen:

Re: Final annexation of
Fulton Drive Extension

Enclosed herewith are the papers evidencing final annexation of property located in the 300 block of Fulton Drive, and known as the Fulton Drive extension, containing 0.483 acres, into the City of Owensboro, Kentucky, for recording in the office of the Secretary of State.

Thank you for your continued assistance and cooperation.

Sincerely,

Carol Blake
Carol Blake
City Clerk

Enclosures

ORDINANCE NO. 21-96

AN ORDINANCE ANNEXING TO THE CITY OF OWENSBORO, KENTUCKY, CERTAIN UNINCORPORATED TERRITORY IN THE COUNTY OF DAVIESS ADJOINING THE PRESENT BOUNDARY LINE OF THE CITY, BEING PROPERTY LOCATED IN THE 300 BLOCK OF FULTON DRIVE, AND KNOWN AS THE FULTON DRIVE EXTENSION, CONTAINING 0.483 ACRES, MORE OR LESS.

WHEREAS, the Board of Commissioners for the City of Owensboro, Kentucky, make the following findings of fact:

(1) The Board of Commissioners has determined that the property described hereinbelow is adjacent or contiguous to the city's boundaries and that it is by reason of population density, commercial, industrial, institutional or governmental use of land, or subdivision of land, urban in character and suitable for development for urban purposes without unreasonable delay.

(2) That it is deemed desirable and it is hereby proposed to annex to the City of Owensboro by extending the boundary line of the city so as to include the same, that certain territory which is now embraced within the County of Daviess adjoining the present boundary line of the City of Owensboro, as more particularly described herein. The Board further finds that no part of the area to be annexed is presently within the boundary of any other incorporated city.

(3) That the fee simple owners of record of the territory to be annexed have previously consented in writing to the annexation proposed, and have otherwise waived all rights under KRS 81A.412, 81A.420 and 81A.425, which consent and waiver is on file with the office of the City Engineer.

NOW, THEREFORE, BE IT ORDAINED BY THE CITY OF OWENSBORO, KENTUCKY, AS FOLLOWS:

SECTION 1. The findings of fact recited in the preamble hereinabove are hereby adopted, affirmed and incorporated by reference as if fully set forth herein.

SECTION 2. There is hereby annexed to the City of Owensboro, Kentucky, and its boundary line is hereby extended so as to include within the limits of the City of Owensboro that certain territory in the County of Daviess, State of Kentucky, adjoining and being adjacent to the present boundary line of the City of Owensboro, Kentucky, more particularly described as follows:

BEGINNING at point in the south margin of Southtown Boulevard and being in the present city limit line, said point also being approximately 1,123.74 feet east of the east margin of Frederica Street; thence with the south margin of Southtown Boulevard and with the present city limit line south 72 degrees 01 minutes 45 seconds east 30 feet to point being the northwest corner to Lot #300 Southtown Boulevard and being in the east margin of the proposed Fulton Drive Extension; thence with the east margin of the proposed Fulton Drive Extension and leaving the present city limit line south 16 degrees 52 minutes 40 seconds west approximately 345 feet to a point being in the Wal-Mart property line, said point is also in the present city limit line; thence with the present city limit line north 72 degrees 49 minutes 45 seconds west approximately 80 feet to a point in the west margin of the proposed Fulton Drive Extension; thence with the west margin of the proposed Fulton Drive Extension north 16 degrees 50 minutes 10 seconds east approximately 190 feet to a point; thence south 72 degrees 01 minutes 45 seconds east approximately 50 feet to a point; thence north 16 degrees 52 minutes 40 seconds 155 feet to the point of beginning and containing 0.483 acres, more or less.

SECTION 3. That the territory annexed herein is zoned A-U Urban Agriculture, as illustrated by the zoning map attached hereto and incorporated by reference herein.

SECTION 4. Any dedicated streets, alleys, or easements constituting any portion of the property to be annexed are hereby accepted by the City of Owensboro pursuant to KRS 82.400.

INTRODUCED AND PUBLICLY READ ON FIRST READING, this the 2nd day of April, 1996.

PUBLICLY READ AND FINALLY APPROVED ON SECOND READING, this the 16th day of April, 1996.

ATTEST:

City Clerk

A TRUE COPY ATTEST:

 Mayor
City Clerk (4-17-96)

ANNEXATION REQUESTED BY: Harry Holder Estate, Owensboro National Bank, Trustee,
c/o Jack M. Diamond, V.P. & Sec./Tr. (926-3232). Hon. John Thacker, Attorney
(502-926-4500)

CONSENT AND WAIVER OF STATUTORY RIGHTS

I(We) solemnly swear and affirm that I am (we are) the fee simple record owner(s) of property located at Fulton Drive Extension in Daviess County, Kentucky. I(We) hereby request, and consent to, annexation of the property more particularly described hereinabove. I(We) further acknowledge and agree, that by executing this instrument, I(We) knowingly and voluntarily waive those rights otherwise afforded me (us) by KRS 81A.420 and 81A.425, as authorized in KRS 81A.412, on this the 8th day of March, 19 96.

Witness:

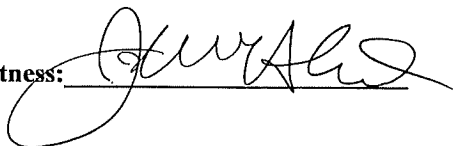

Signature (s) of
Record Owner (s) of Property:

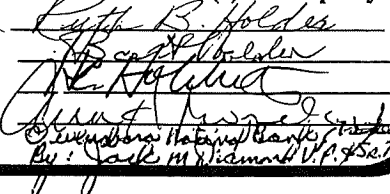
By: Jack M. Williams, V.P. & Sec.

FOR FINANCE DEPARTMENT USE ONLY:

Annexation Fee

Amount: _____

Acreage Fee

Amount: _____

Received by Finance Department

Date: _____

Initialed By: _____

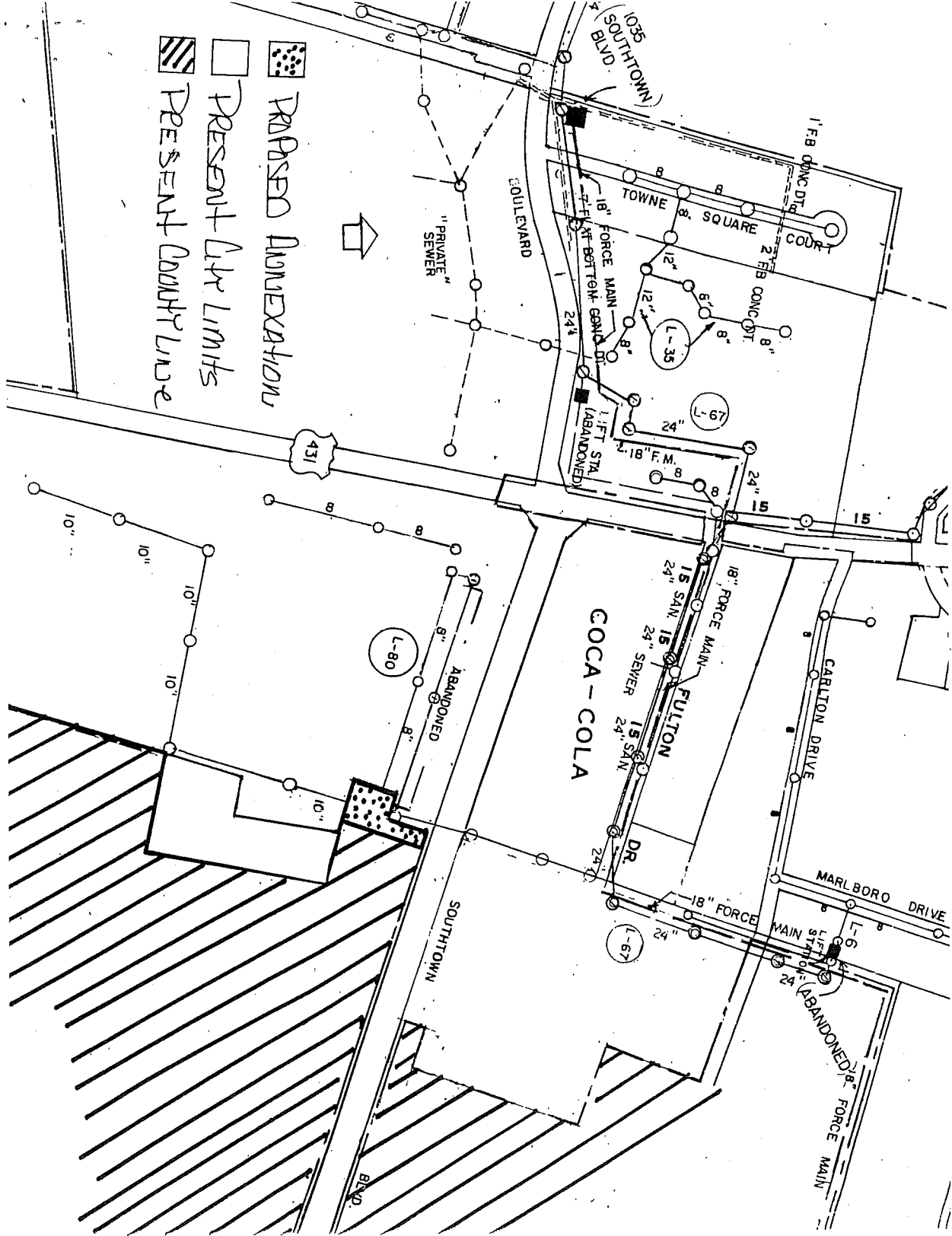

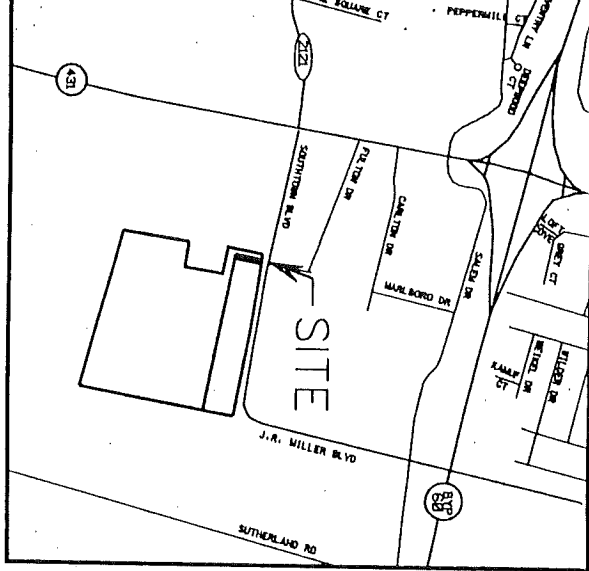

B-4

- PROPOSED ANNEXATION
- PRESENT CITY LIMITS
- PRESENT COUNTY LINE

