

Lenita Smith
City Clerk



CITY OF PADUCAH

P.O. Box 2267
Paducah, KY 42002-2267
(502) 444-8507

July 19, 1994

I hereby certify that the attached is a true and correct copy
of an ordinance adopted by the City of Paducah on April 10,
1990.

Sammara S. Brock

Asst. City Clerk

AN ORDINANCE FINALIZING THE ANNEXATION OF CERTAIN PROPERTY LYING ADJACENT TO THE CORPORATE LIMITS OF THE CITY, AND DEFINING ACCURATELY THE BOUNDARY OF SAID PROPERTY TO BE INCLUDED WITHIN SAID CORPORATE LIMITS

WHEREAS, a tract of property west of and adjacent to the present city limits, along Holt Road and U.S. Highway 60, is urban in character and suitable for development for urban purposes without unreasonable delay; and

WHEREAS, the property is contiguous to the present corporate limits of the City, and it is desirable and necessary to annex the hereinafter described property; and

WHEREAS, said tract of land is not within the boundary of another incorporated city; and

WHEREAS, KRS 81A.412 provides that a city may annex any area which meets the necessary requirements if each of the owners of record of such land consent in writing to the annexation; and

WHEREAS, the owners have requested such annexation in writing to the Mayor and Board of Commissioners of the City of Paducah; and

WHEREAS, the Board of Commissioners of the City of Paducah have enacted Ordinance 90-03-4384 expressing the intentions of the City of Paducah to annex and make a part of the City of Paducah the territory described below; and

NOW, THEREFORE, BE IT ORDAINED BY THE CITY OF PADUCAH, KENTUCKY:

SECTION 1. That the hereinafter described property be annexed to, and be made a part of, the City of Paducah, Kentucky;

ADOPTED

the said real property being more particularly and accurately described as follows:

Beginning at a point in the north right-of-way line of U.S. Highway 60, said point located at the intersection of the east right-of-way line of Holt Road if extended across U.S. Highway 60; thence in a southerly direction along said east right-of-way line of Holt Road if extended, a distance of 1,036.36' more or less, to a point; thence continuing in a southerly direction along said east right-of-way line of Holt Road, a distance of 526.6' more or less, to a point; thence in a westerly direction a distance of 250' to a point; thence in a southerly direction a distance of 790.0' more or less to a point, said point located in the north property line of the Frank Gourieux property tract 91; thence in a westerly direction along said Gourieux tract, a distance of 1,030' more or less, to a point; thence in a southerwesterly direction a distance of 1,304' more or less, to a point, said point located in the north right-of-way line of Henson Road; thence in a southwesterly direction along the north right-of-way line of Henson Road, a distance of 818' more or less, to a point; thence in a westerly direction continuing with the north right-of-way line of Henson Road, a distance of 675' more or less, to a point; thence in a northerly direction a distance of 640.3' more or less, to a point, said point located between lots 61A and 61B as recorded in Deed Book 434, Page 377; thence in a westerly direction between lots 61A and 61B, a distance of 200' more or less, to a point, said point located in the east right-of-way line of Olivet Church Road; thence in a northerly direction with the east right-of-way line of Olivet Church Road, a distance of 950' more or less, to a point; thence in a westerly direction a distance of 154.6' more or less to a point, said point located in the southwest corner of lot 1 recorded in Deed Book 616 Page 235; thence in a northerly direction a distance of 100' more or less, to a point; thence in a northerly direction, a distance of 164.5' more or less, to a point, said point located in the south right-of-way line of U.S. Highway 60; thence in an easterly direction along said south right-of-way line of U.S. Highway 60, a distance of 1,074' more or less, to a point, said point located at the intersection of the east right-of-way line of

a future street reservation and the south right-of-way line of U.S. Highway 60; thence in a southerly direction a distance of 200' more or less; thence continuing in a southerly direction along an arc, said arc being the east right-of-way line of a future road, a distance of 195.93' more or less, to a point; thence in a southwesterly direction along said arc, a distance of 50.05' more or less, to a point; thence in a southwesterly direction, a distance of 51.45' more or less, to a point; thence in an easterly direction, a distance of 406.32' more or less, to a point; thence in a southerly direction, a distance of 212.2' to a point; thence in a southeasterly direction, a distance of 88.35' more or less, to a point; thence in an easterly direction, a distance of 502.4' more or less; to a point; thence in a northerly direction, a distance of 788.39' more or less, to a point; thence in an easterly direction, a distance of 323' more or less, to a point; thence in a northerly direction, a distance of 120' more or less, to a point; thence continuing in a northerly direction, a distance of 180' more or less, to a point; thence in a northeasterly direction, a distance of 350' more or less, to a point; thence in a southeasterly direction, a distance of 126.26' more or less, to a point; thence in a northeasterly direction, a distance of 220' more or less, to a point; thence in a northerly direction a distance of 499.85' more or less, to a point, said point located in the north right-of-way line of U.S. Highway 60; thence in a northeasterly direction along said north right-of-way line of U.S. Highway 60, a distance of 334.92' more or less, to the point of beginning.

SECTION 2. This final ordinance of annexation shall be read on two separate days and upon publication the territory described above shall become a part of the City of Paducah, Kentucky, for all purposes.

Sculline *Gerry B. Montgomery*
MAYOR

Introduced by the Board of Commissioners March 27, 1990

Adopted by the Board of Commissioners April 10, 1990

Recorded by Lenita Smith, City Clerk, April 10, 1990

Published by The Paducah Sun April 21, 1990

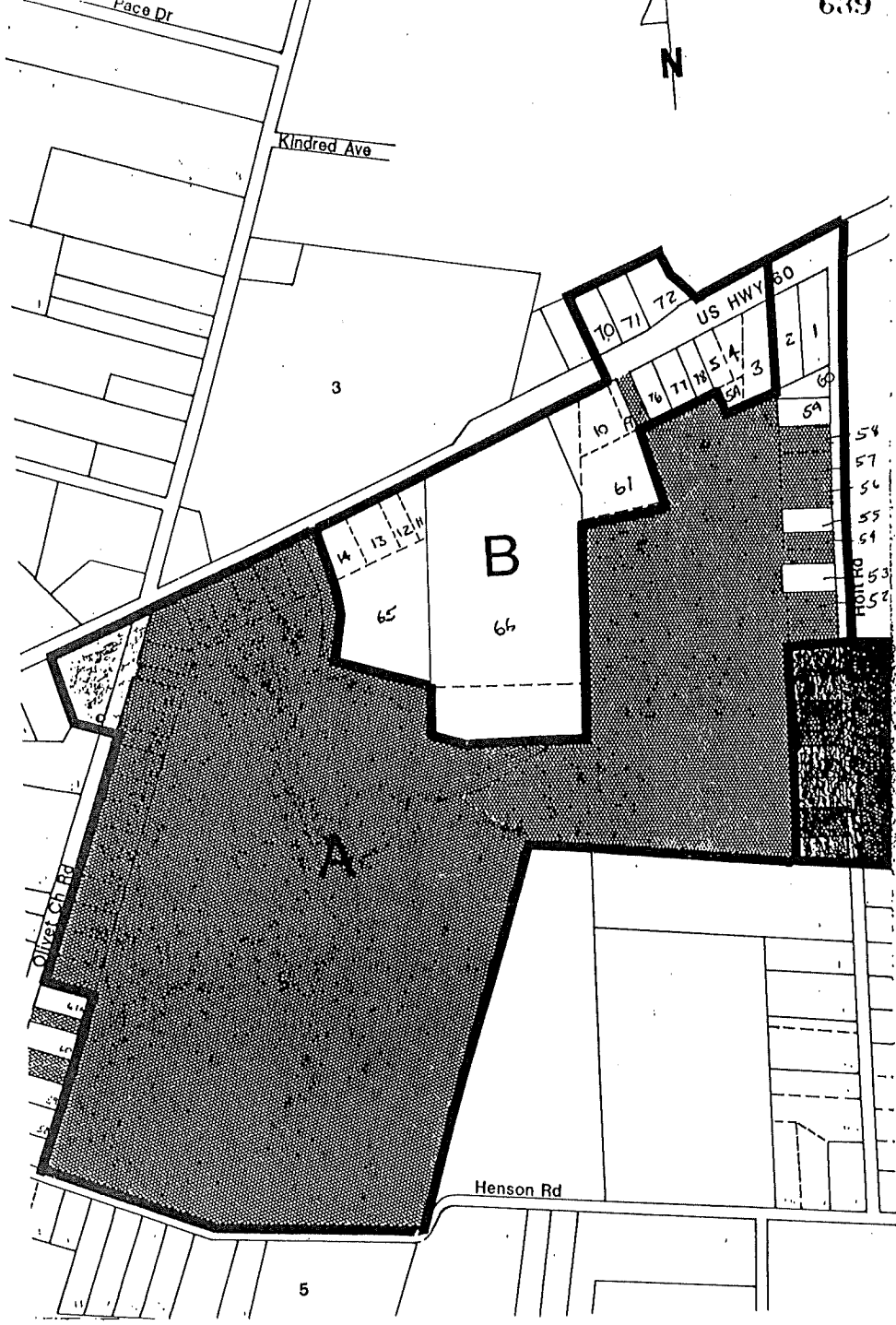

HOLT RD. AREA ANNEXATION:

PHASE A ☐ ANNEXED TERRITORY
 PHASE B ☐ PROPOSED - FUTURE
 PHASE C ☒ PROPOSED - FUTURE
 POWELL ☒
 Ownership

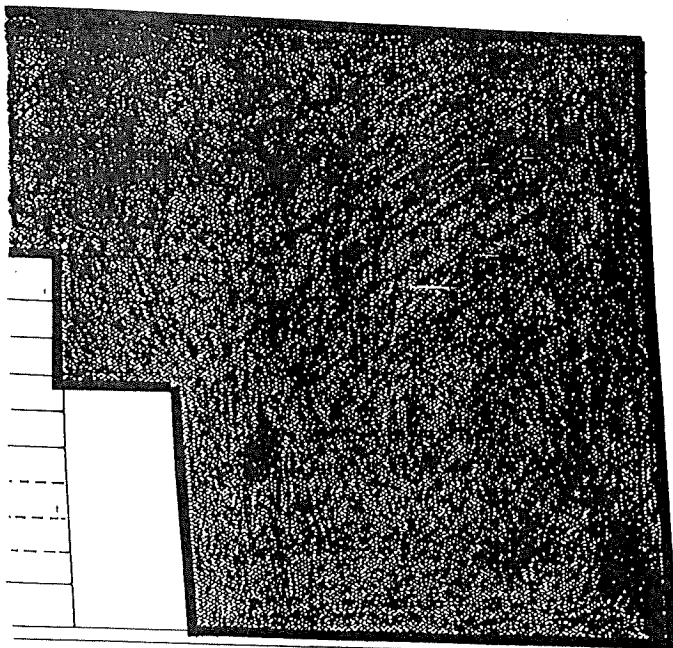

STATE OF KENTUCKY } SCT
COUNTY OF McCracken }

I, Martha Nell Bradford, Clerk of the County Court for the County and State
aforesaid, do certify that the foregoing instrument of writing was lodged for
record on the 10th day of May 1990
at 4:25 P M. o'clock, and I have recorded the same together with this and
the foregoing certificate in my office in

Deed Book No. 737 Page No. 631
Given under my hand this 10th day of May 1990

MARTHA NELL BRADFORD, CLERK

By Marlene Stubblefield D.C.

LIST OF NAMES AND ADDRESSES OF PROPERTY OWNERS
AND/OR REGISTERED VOTERS
CHARLES BELL - TRACT A ANNEXATION
HOLT ROAD AND HIGHWAY 60

Comes the City of Paducah, Kentucky, and hereby submits for filing and recordation a list of the names and addresses of the property owners and/or registered voters within the area annexed by the City of Paducah on Holt Road. Simultaneous with the filing of this list of names and addresses, the City of Paducah has also filed for recordation a map depicting the area annexed, which area is reflected as Tract A on said map. The lot designation as reflected on the list of names and addresses reflects the individual lot owned and/or resided upon by said individual as referenced on the map. The names and addresses of the owners of said tract are as follows:

| <u>LOT</u> | <u>NAME</u> | <u>ADDRESS</u> |
|------------|---|-----------------------|
| 1 | West, Loreen L. | 2935 Holt Road |
| 2 | Higdon, Mark | 5152 Highway 60 |
| 60 | Walls, Robert L. Walls, Nancy Deane Carter | 2911 Holt Road |
| 59 | Allcock, Richard N. Allcock, JoAnne | 2901 Holt Road |
| 58 | Coldwell Banker | 2855 Holt Road |
| 57 | Powell, Lee | 2550 Irvin Cobb Drive |
| 56 | Powell, Lee | 2550 Irvin Cobb Drive |
| 55 | Duperrier, Doris Williams, Larry | 2811 Holt Road |
| 54 | Powell, Lee | 2550 Irvin Cobb Drive |
| 53 | Hammonds, George L. Hammonds, Glenda | 2751 Holt Road |
| 52 | Powell, Lee | 2550 Irvin Cobb Drive |
| 51 | " | " |

| <u>LOT</u> | <u>NAME</u> | <u>ADDRESS</u> |
|------------|----------------------|-----------------------|
| 56 | Powell, Lee | 2550 Irvin Cobb Drive |
| 61B | " | " |
| 62 | " | " |
| 63 | " | " |
| 64 | " | " |
| 65 | " | " |
| 66 | " | " |
| 67 | " | " |
| 68 | " | " |
| 69 | " | " |
| 24 | " | " |
| 23 | " | " |
| 22 | " | " |
| 21 | " | " |
| 20 | " | " |
| 19 | " | " |
| 18 | " | " |
| 17 | " | " |
| 16 | " | " |
| 15 | " | " |
| 0 | Quinnelly, Thomas E. | 5251 Ogilvie Avenue |

Attest:

Lanita Smith
City Clerk

Gerry B. Montgomery
Mayor

STATE OF KENTUCKY)

COUNTY OF McCRACKEN)

Subscribed, sworn, and acknowledged before me by Gerry
Montgomery, Mayor, and Lenita Smith, City Clerk, this 25th day
of July, 1994.

My commission expires 2/25/96.

Laura A. Knowles
NOTARY PUBLIC, STATE AT LARGE

This instrument prepared by:

David Emmons
DENTON & KEULER
P. O. Box 929
Paducah, KY 42002-0929

14049