



P.O. Box 304, Park City, Kentucky 42160

Mayor  
David Lyons

City Administrator  
Jason W. Nuetzman

Commissioners  
Emma Boards  
Charles France  
Kevin Moran  
Donna Elmore

City Clerk  
Pauline Toms

July 8, 2005

To: Barren County Clerk; Kentucky Secretary of State; Department for Local Government

Re: Certification filings under KRS 81A.470

I certify I am the duly qualified representative of the City of Park City, Kentucky, and the two (2) foregoing pages of Ordinance No. 115 is a true, correct and complete copy duly adopted by the City Commission at a duly convened meeting held on October 4<sup>th</sup>, 1976, all as appears in the official records of said City.

WITNESS, my hand and Seal of Park City, Kentucky, this 8<sup>th</sup> day of July, 2005.

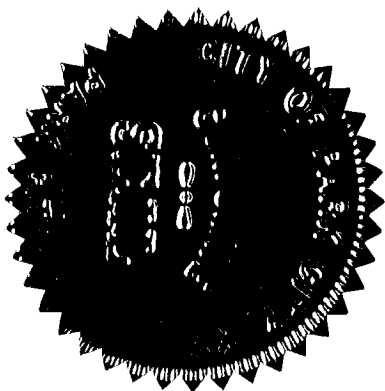

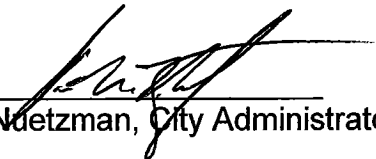
  
\_\_\_\_\_  
Jason W. Nuetzman, City Administrator

RECEIVED AND FILED  
DATE July 27, 2005

\_\_\_\_\_  
TREY GRAYSON  
SECRETARY OF STATE  
COMMONWEALTH OF KENTUCKY  
BY Kandice Adkins



ORDINANCE ANNEXING TERRITORY INTO  
THE TOWN OF PARK CITY, KENTUCKY

WHEREAS, the Town Board of Trustees of the Town of Park City, Barren County, Kentucky, has by Ordinance No. 110 adopted on October 7, 1974, stated its intention to annex the unincorporated territory hereinafter described into the City of Park City; and

WHEREAS, said Ordinance No. 110 was duly published in the Glasgow Daily Times in accordance with Chapter 424 of the Kentucky Revised Statutes on the 10th day and again on the 28th day of October, 1974; and

WHEREAS, more than 30 days has elapsed since the first enactment of said Ordinance following by publication of its adoption and no petition has been filed in the Barren Circuit Court protesting said annexation;

NOW THEREFORE, BE IT ORDAINED that the Town Board of Trustees of Park City, Kentucky does hereby annex into the city limits of Park City, Kentucky, the following described previously unincorporated territory:

A certain parcel of land located in Park City, Ky., and being more clearly described as follows:

Beginning at concrete monument on Tunnel Hill on the North East side of Park City, said monument being a corner in the existing city limits of said City, also the center line of the L & N Railroad; thence with the center line of said Railroad N 72 deg. 52' E 1595.07 feet to a P.K. nail in the center of said Railroad, said nail being opposite a woven wire fence; thence with said fence S 12 deg. 35' E 1645.52 feet to an iron pin in the North edge of U. S. 31-W; thence

continuing on with the same line crossing U. S. 31-W, S 12 deg. 35' E 1168.02 feet to a concrete monument; thence S 72 deg. 21' W 2807.10 feet to a post in an existing fence line; thence continuing with said line S 72 deg. 21' W 245.48 feet to a point in the existing City Limits of Park City; thence with the existing city limits N 17 deg. 39' W 2106.29 feet to a point in the existing city limits; thence S 85 deg. 31' E 265.00 feet; thence with the same line S 85 deg. 31' E 761.00 feet to a point, said point being in the East line of a Cemetery; thence with the Cemetery and existing city limits N 17 deg. 53' W 1103.49 feet to a point in the center line of the L & N Railroad; thence with the center of said Railroad N 70 deg. 50' E 760.00 feet to a concrete monument, being the point of beginning and containing 185 acres more or less as per survey of July 19, 1974.

A map of the above annexation is on file with the City Clerk.

This the 4<sup>th</sup> day of October, 1974.

  
\_\_\_\_\_  
ROBERT KING, CHAIRMAN  
TOWN BOARD OF TRUSTEES

ATTEST:

  
\_\_\_\_\_  
PAULINE TOMS, CITY CLERK

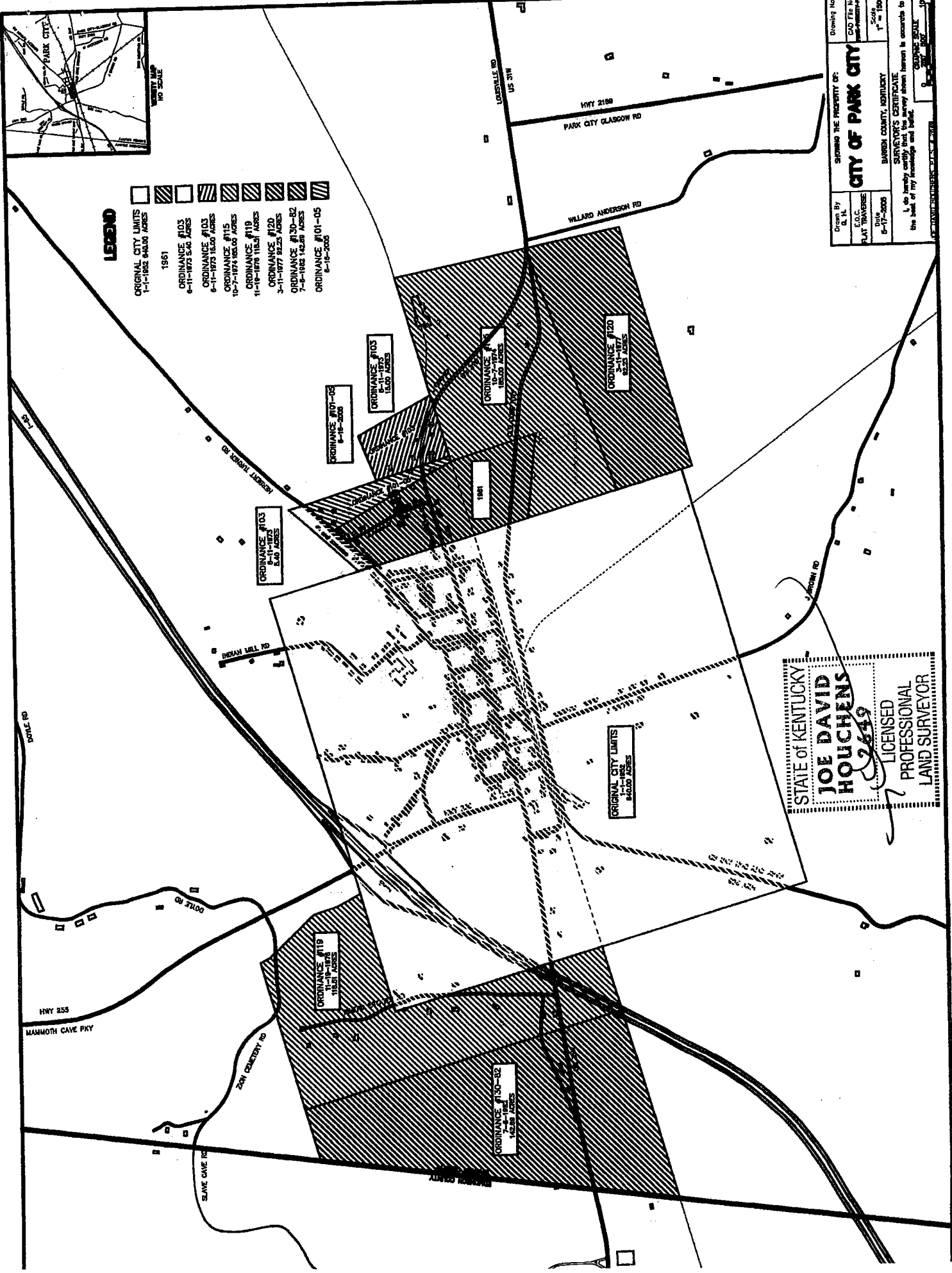

**LEGEND**

- 1961
- ORIGINAL CITY LIMITS  
1-1-1862 840.00 ACRES
- ORDINANCE #103  
6-11-1973 3.96 ACRES
- ORDINANCE #103  
6-11-1973 16.00 ACRES
- ORDINANCE #115  
10-7-1974 185.00 ACRES
- ORDINANCE #119  
11-19-1978 115.7 ACRES
- ORDINANCE #120  
3-11-1977 22.25 ACRES
- ORDINANCE #130-32  
7-9-1982 14.88 ACRES
- ORDINANCE #101-05  
6-18-2005

Drawing No. \_\_\_\_\_  
 CAD File No. \_\_\_\_\_  
 DATE: \_\_\_\_\_  
 SCALE: 1" = 1500'

**CITY OF PARK CITY**  
 BARREN COUNTY, KENTUCKY

SURVEYOR'S CERTIFICATE  
 I do hereby certify that the survey shown herein is accurate to the best of my knowledge and belief.

DATE: \_\_\_\_\_  
 SURVEYOR: \_\_\_\_\_

STATE OF KENTUCKY  
**JOE DAVID HOUCHENS**  
 2649  
 LICENSED PROFESSIONAL LAND SURVEYOR