

RECEIVED AND FILED
DATE May 13, 2019

ALISON LUNDERGAN GRIMES
SECRETARY OF STATE
COMMONWEALTH OF KENTUCKY
BY Kandice Adkinson

CERTIFICATE

I, the undersigned, hereby certify that I am the duly qualified and acting City Clerk of the City of Prestonsburg, Kentucky, that the foregoing is a full, true, and correct copy of a Resolution/Ordinance adopted by the City Council of said City at a meeting duly held on June 18, 2018; that said official action appears as a matter of public record in the official records or journal of the governing authority; that said meeting was held in accordance with all applicable requirements of Kentucky Law, including KRS 61.810, 61.815, 61.820, and 61.825; that a quorum was present at said meeting; that said official action has not been modified, amended, revoked or repealed and is now in full force and effect.

IN TESTIMONY WHEREOF, witness my signature this 25 day of July, 2018.

Sharon Setser
Sharon Setser, City Clerk

RESOLUTION NO. _____

ORDINANCE NO. 11-2018

ORDINANCE NO. 11-2018

AN ORDINANCE OF THE CITY OF PRESTONSBURG, KENTUCKY ANNEXING INTO THE CITY CORPORATE LIMITS CERTAIN REAL PROPERTY LOCATED FROM THE EXISTING CITY LIMITS OF RT 302 INCLUDING ALL RIGHT OF WAYS ALONG ROADWAY ENDING AT EXISTING CORPORATE CITY LIMITS ON RT 302

WHEREAS, the City Council has determined that no part of the area to be annexed shall be included in the boundary of another city; and,

WHEREAS, pursuant to KRS 81A.425, notice was sent by first-class mail to affected property owner; and,

WHEREAS, said notice was mailed no later than fourteen (14) days prior to the meeting to which the ordinance proposing the annexation and stating the intention of the City of Prestonsburg to annex the territory received its second reading; and,

WHEREAS, Ordinance No. 08-2014, proposing the annexation was duly read in accordance with the Kentucky Revised Statutes, and was published and went into effect on April 28, 2014; and,

WHEREAS, more than sixty (60) days have elapsed since Ordinance No. 08-2014 went into effect, and no opposition was received from the property owner to the proposed annexation; and,

WHEREAS, all notices required by the Kentucky Revised Statutes have been provided and/or published according to law,

NOW, THEREFORE, BE IT ORDAINED by the City Council of the City of Prestonsburg, Kentucky that the City of Prestonsburg hereby ratifies the Mayor's signature upon and approves any all documents necessary to effectuate the intent of this ordinance including, but not limited to the Consent to Annexation and, further, the City hereby annexes the following described unincorporated area and makes it a part of the City of Prestonsburg, Kentucky.

See property description attached as Exhibit A and Incorporated herein by reference.

This Ordinance shall take effect upon its passage, approval, and publication. If any section, subsection, sentence, clause, phrase or portion of this ordinance is for any reason deemed separate, distinct, and independent provision, and such holding shall not affect the validity of the remaining portions.

SO RESOLVED, ORDAINED AND ADOPTED THIS 18 DAY OF June, 2018.

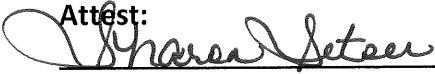

Les Stapleton, Mayor

Attest:

Sharon Setser, City Clerk

ORDINANCE NO. 08-2014

AN ORDINANCE OF THE CITY OF PRESTONSBURG, KENTUCKY BY WHICH THE CITY STATES ITS INTENT TO ANNEX INTO THE CITY CORPORATE LIMITS CERTAIN REAL PROPERTY LOCATED FROM THE EXISTING CITY LIMITS OF RT 302 INCLUDING ALL RIGHT OF WAYS ALONG ROADWAY ENDING AT EXISTING CORPORATE CITY LIMITS ON RT 302

WHEREAS, a certain tract and boundary of unincorporated territory as more specifically described herein below, and as reflected by the Annexation Map hereto attached as Exhibit "A" is under consideration to be annexed and incorporated into the city limits of Prestonsburg, pursuant to KRS Chapter 81A; and,

WHEREAS, the area is herein below more particularly described, and reflected in Exhibit "A" hereto (Proposed Annexation Map) lies adjacent to or is contiguous to the City of Prestonsburg's current boundaries and is urban in character; and,

WHEREAS, the Prestonsburg City Council having considered the matter and determined after due discussion and deliberation that it is in the best interest of the City and best interest of the property owners whose property is contained within the area proposed to be annexed; and,

WHEREAS, the City Council, through passage of this ordinance set forth herein below, declares it desirable to annex into the corporate limits of the City of Prestonsburg that certain are more fully described below;

NOW, THEREFORE, IT IS HEREBY RESOLVED AND IS HEREBY ORDAINED BY THE CITY OF PRESTONSBURG, KENTUCKY AS FOLLOWS;

Section I. The Annexation Map attached hereto as Exhibit "A" reflects the description as hereinabove and is incorporated herein by reference as a part thereof.

Section II. Upon enactment of this ordinance on second reading and publication the territory shall become a part of the City of Prestonsburg in accordance with KRS 81A.412.

SO RESOLVED, ORDAINED AND ADOPTED THIS 28th DAY OF APRIL, 2014.

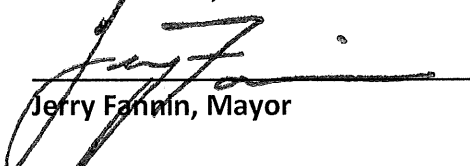

Jerry Fannin, Mayor
Attest:



Sharon Setser, City Clerk

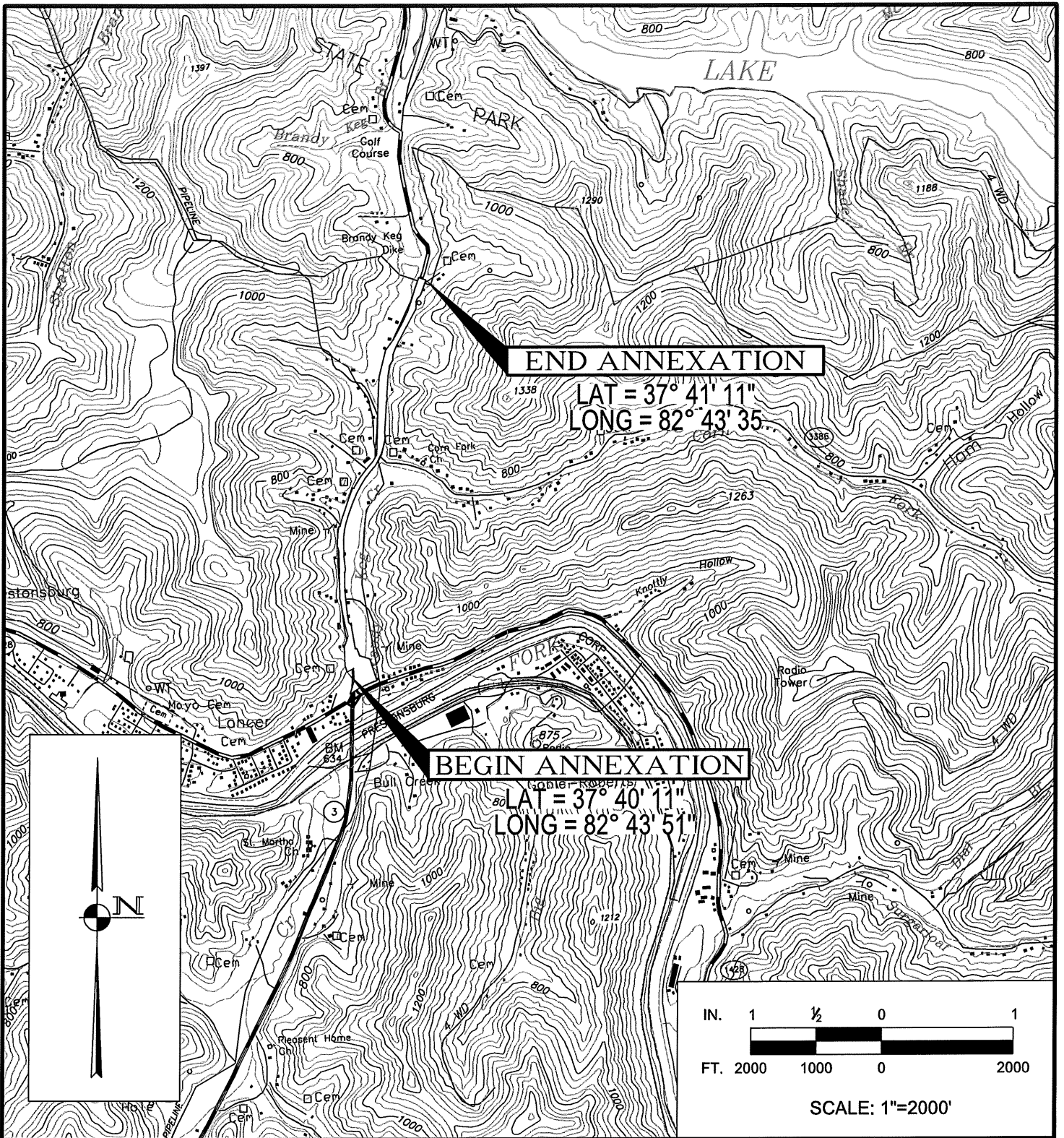

**CITY of PRESTONSBURG
PROPOSED ANNEXATION
Route 302 to Corporate Limits**

w.o. 8551

date: 12/12/13

- Prepared By -

BOCOOK ENGINEERING, INC
CONSULTING ENGINEERS

312 TENTH STREET
PAINTSVILLE, KY 41240
(606) 789-5961 - phone
(606) 789-7671 - facsimile



259 N. ARNOLD AVE.
PRESTONSBURG, KY 41653
(606) 886-7884 - phone
(606) 886-7895 - facsimile

Ky. Rt. 302 North to Prestonsburg corporate limits

Beginning at a point situated at the western right-of-way line of Ky. Rt. 302; said point being on the corporate limits of Prestonsburg and having a northing of 2,141,139.64 and an easting of 2,514,168.69; thence leaving the corporate limits and with the right-of-way for the next fourteen (14) courses and distances:

- 1) N15°33'46"W, 109.16'
- 2) N02°43'06"W, 277.47'
- 3) N19°41'40"E, 167.01'
- 4) N15°25'18"W, 171.87'
- 5) N11°48'02"W, 154.58'
- 6) N09°13'20"W, 202.40'
- 7) N17°52'49"W, 51.67'
- 8) N02°01'06"E, 76.70'
- 9) N03°37'21"W, 111.34'
- 10) N01°30'01"W, 200.73'
- 11) N88°40'58"E, 5.00'
- 12) N01°19'02"W, 315.00'
- 13) N15°21'12"W, 103.08'
- 14) N06°47'59"E, 35.13'

to the beginning of a curve to the right labeled C1 having a radius of 1196.00', an arc length of 256.02', a chord length of 255.53' and a chord bearing of N 04°55'16" E; thence S78°56'48"E, 15.00' to the beginning of a curve to the right labeled C2 having a radius of 1181.00', an arc length of 167.69', a chord length of 167.55' and a chord bearing of N 15°07'17" E; thence continuing with the right-of-way for the next three (3) courses and distances:

- 1) N17°56'54"E, 192.49'
- 2) N19°34'27"E, 248.56'
- 3) S63°42'31"E, 20.00'

to the beginning of a curve to the right labeled C3 having a radius of 1462.49', an arc length of 367.25', a chord length of 366.29' and a chord bearing of N 33°29'07" E; thence N40°56'12"E, 70.37' to the beginning of a curve to the left labeled C4 having a radius of 606.63', an arc length of 173.01', a chord length of 172.43' and a chord bearing of N 32°48'03" E; thence continuing with the right-of-way for the next eight (8) courses and distances:

- 1) N01°25'25"E, 944.34'
- 2) N03°18'19"E, 244.71'
- 3) N13°32'36"E, 376.12'

- 4) N36°12'57"E, 218.62'
- 5) N27°56'38"E, 250.20'
- 6) N25°39'12"E, 200.00'
- 7) N17°39'10"E, 347.66'
- 8) N19°21'14"E, 202.86'

to a point on the city of Prestonsburg's corporate limits; thence leaving the right-of-way and with the corporate limits, crossing Rt. 302, S71°18'42"E, 115.28' to a point on the eastern right-of-way of Rt. 302; thence with the right-of-way for the next eight (8) courses and distances:

- 1) S19°05'17"W, 156.55'
- 2) S23°22'57"W, 100.12'
- 3) S47°05'06"W, 55.90'
- 4) S20°31'12"W, 50.00'
- 5) S01°13'48"W, 105.95'
- 6) S28°10'44"W, 306.32'
- 7) S27°59'20"W, 245.40'
- 8) S25°39'12"W, 53.39'

to the beginning of a curve to the left labeled C5 having a radius of 1392.53', an arc length of 163.99', a chord length of 163.89' and a chord bearing of S 21°58'28" W; thence continuing with the right-of-way for the next ten (10) courses and distances:

- 1) S02°51'15"W, 82.08'
- 2) S30°30'14"W, 101.37'
- 3) S08°07'54"W, 155.10'
- 4) S03°15'46"W, 290.53'
- 5) S08°11'24"E, 50.99'
- 6) S14°25'48"W, 50.99'
- 7) S03°07'12"W, 450.00'
- 8) S02°35'26"E, 100.50'
- 9) S11°40'16"W, 156.89'
- 10) S16°56'09"W, 52.34'

thence crossing Corn Fork road S25°29'41"W, 210.36' to the beginning of a curve to the right labeled C6 having a radius of 676.56', an arc length of 44.66', a chord length of 44.66' and a chord bearing of S 39°04'42" W; thence S40°56'12"W, 70.21' to the beginning of a curve to the left labeled C7 having a radius of 1392.51', an arc length of 516.19', a chord length of 513.24' and a chord bearing of S 30°03'12" W; thence S19°26'12"W, 263.81' to the beginning of a curve to the left labeled C8 having a radius of 1106.00', an arc length of 386.87', a chord length of 384.90' and a chord bearing of S 09°09'36" W; thence continuing with the right-of-way for the next six (6) courses and distances:

- 1) S01°45'48"E, 18.46'
- 2) S01°16'31"E, 187.92'



- 3) S07°29'14"E, 186.08'
- 4) S08°08'57"W, 60.83'
- 5) S88°40'58"W, 5.00'
- 6) S01°19'02"E, 146.20'

to the beginning of a curve to the left labeled C9 having a radius of 2820.00', an arc length of 116.71', a chord length of 116.70' and a chord bearing of S 02°31'58" E; thence continuing with the right-of-way for the next seven (7) courses and distances: }

- 1) S83°52'34"W, 5.00'
- 2) S06°07'26"E, 384.08'
- 3) S11°49'20"E, 105.82'
- 4) S40°15'40"E, 60.14'
- 5) S09°36'59"E, 357.95'
- 6) N79°25'07"E, 23.00'
- 7) S21°02'42"E, 119.30'

thence crossing Brandy Keg creek S73°06'55"E, 157.22'; thence S18°20'53"E, 346.46' to a point on the northern right-of-way of Rt. 1428 (South Lake Dr.); thence leaving the right-of-way of Rt. 302 and with the right-of-way of Rt. 1428

- 1) S70°18'31"W, 41.64'
- 2) S67°35'00"W, 11.58'
- 3) S68°30'43"W, 70.97'
- 4) S64°24'01"W, 87.82'
- 5) S64°24'01"W, 73.68'

thence crossing Rt. 302 S57°01'21"W, 163.56' to a point on the western right-of-way of Rt. 302; said point being situated on the corporate limits of the city of Prestonsburg; thence leaving the right-of-way of Rt. 1428 and with the right-of-way of Rt. 302 and the corporate limits for the next three (3) courses and distances:

- 1) N16°09'55"E, 210.14'
- 2) N02°34'12"W, 184.01'
- 3) S61°33'48"W, 113.45'

to the beginning and containing 16.73 acres more or less.

 Peter Howard, PLS #3949
 Bocook Engineering Company, Inc.
 259 N. Arnold Ave.
 Prestonsburg, Ky. 41653
 Date: December 22nd, 2013



3

OVERSIZE MAP INCLUDED WITH
SUBMISSION.

To research the map, contact the
Office of Secretary of State
or the County Clerk.