

**ORDINANCE NO. 06-2019**

**AN ORDINANCE OF THE CITY OF PRESTONSBURG, KENTUCKY ANNEXING INTO THE CITY LIMITS CERTAIN REAL PROPERTY LOCATED FROM THE EXISTING CITY LIMITS OF WEST PRESTONSBURG TO DAVID, KENTUCKY INCLUDING ALL RAILWAY AND RIGHT OF WAYS FROM MILEPOST 0.0 AND ENDING AT MILEPOINT 10.1 AS FURTHER DESCRIBED IN EXHIBIT A**

**WHEREAS**, the City Council has determined that no part of area to be annexed shall be included in the boundary of another city; and,

**WHEREAS**, the property is owned by the City of Prestonsburg and the City declares it desirable to annex the property further described in this ordinance and its attachment (Exhibit A):

**NOW, THEREFORE, BE IT ORDAINED** by the City of Prestonsburg, as follows:

1. Pursuant to KRS 81A.420, the City of Prestonsburg hereby declares it desirable to annex and hereby publishes through the enactment of this ordinance the territory described and shown on the map attached to this ordinance as Exhibit A. Exhibit A is incorporated into this ordinance by reference as if copied in full.
2. All prior Municipal Orders or Ordinances or parts of any Municipal Order or Ordinance in conflict herewith repealed and the provisions of this Ordinance are hereby declared to be severable and, if any section, phrase or provision shall, for any reason, be declared invalid, such declaration of invalidity shall not affect the validity of the remainder of this Ordinance.
3. This Ordinance is adopted pursuant to KRS 83A.060 in that it was introduced on September 16, 2019, with the second reading on October 21, 2019, and said Ordinance shall be in full force and effect upon signature, recordation and publication in accordance with KRS 81A.060 and KRS Chapter 424.

**SO RESOLVE, ORDAINED AND ADOPTED THIS 21<sup>ST</sup> DAY OF OCTOBER, 2019.**

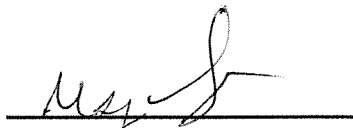

**LES STAPLETON, MAYOR**

**ATTEST:**

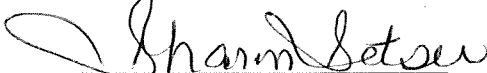

**SHARON SETSER, CITY CLERK**

**RECEIVED AND FILED**  
**DATE** April 6, 2020

**MICHAEL G. ADAMS**  
**SECRETARY OF STATE**  
**COMMONWEALTH OF KENTUCKY**  
**BY** Kandice Adkins

**CERTIFICATE**

I, the undersigned, hereby certify that I am the duly qualified and acting City Clerk of the City of Prestonsburg, Kentucky, that the foregoing is a full, true, and correct copy of a Resolution/Ordinance adopted by the City Council of said City at a meeting duly held on Oct 21, 2019; that said official action appears as a matter of public record in the official records or journal of the governing authority; that said meeting was held in accordance with all applicable requirements of Kentucky Law, including KRS 61.810, 61.815, 61.820, and 61.825; that a quorum was present at said meeting; that said official action has not been modified, amended, revoked or repealed and is now in full force and effect.

IN TESTIMONY WHEREOF, witness my signature this 15 day of November, 2019.

\_\_\_\_\_  
**Sharon Setser, City Clerk**

RESOLUTION NO. \_\_\_\_\_

ORDINANCE NO. DL-2019

This instrument prepared by  
or under the direction of:

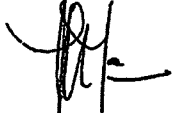

Kim R. Bongiovanni  
Assistant General Counsel  
Law Department  
500 Water Street  
Jacksonville, Florida 32202

### QUITCLAIM DEED

THIS QUITCLAIM DEED, made this 4 day of January, 2019, between CSX TRANSPORTATION, INC., a Virginia corporation, whose mailing address is 500 Water Street, Jacksonville, Florida 32202, hereinafter called "Grantor", and the CITY OF PRESTONSBURG, KENTUCKY, a municipality of the Commonwealth of Kentucky, whose mailing address is 200 North Lake Drive, Prestonsburg, Kentucky 41653, hereinafter called "Grantee", WITNESSETH:

(Wherever used herein, the terms "Grantor" and "Grantee" may be construed in the singular or plural as the context may require or admit, and for purposes of exceptions, reservations and/or covenants, shall include the heirs, legal representatives and assigns of individuals or the successors and assigns of corporations.)

THAT Grantor, for and in consideration of the sum of THREE HUNDRED NINETY THOUSAND AND NO/100 DOLLARS (\$390,000.00), cash in hand paid, the receipt and sufficiency of which is hereby acknowledged, Grantor does hereby RELEASE, REMISE and forever QUITCLAIM unto Grantee, its successors and assigns, all right, title and interest of Grantor, if any, in and to that certain tract or parcel of land situate, lying and being in the County of Floyd, Commonwealth of Kentucky, hereinafter designated "the Premises," more particularly described in Exhibit A, attached hereto and incorporated herein, and containing 165.98 acres, more or less.

EXCEPTING unto Grantor all mineral rights, if any, including but not limited to oil, gas and coal, and the constituents of each, underlying the Premises; and RESERVING the right for Grantor, its successors and assigns, to remove the same; HOWEVER, Grantor will not drill or permit drilling on the surface of the Premises without the prior written consent of Grantee, which consent shall not be unreasonably withheld.

**EXCEPTING** unto Grantor the ownership of all railroad tracks and other track material (including switches, signals and ballast), hereinafter "the Track", within or on the Premises; and **RESERVING** unto Grantor a railroad easement over the entirety of the Premises, for the continued location, maintenance, use, repair, replacement and removal of the Track, **TOGETHER WITH** the right of ingress and egress to and from the Track until removal. Said reserved railroad easement shall automatically terminate and all title in the Premises vest in Grantee upon cessation of use and removal of the Track by Grantor. Grantor shall remove the Track, other than ballast, at its expense, within one hundred, eighty (180) days after Closing.

**TO HAVE AND TO HOLD** the Premises, and all the estate, right, title, lien, interest and claim whatsoever of Grantor therein, either in law or equity, and all improvements thereon and appurtenances thereto, unto the proper use, benefit and enjoyment of Grantee, Grantee's heirs and assigns or successors and assigns, forever; **SUBJECT** to reservations, easements, covenants, restrictions and limitations of record or platted, all existing public utilities and roadways, and all existing encroachments, ways and servitudes, howsoever created.

Grantee acknowledges that the Premises conveyed hereunder has been historically used for railroad industrial operations and is being conveyed for use only as a recreational trail. Grantee, by acceptance of this deed, hereby covenants that it, its successors, heirs, legal representatives or assigns shall not use the Premises for any purpose other than a recreational trail and that the Premises will not be used for (a) any residential purpose of any kind or nature (residential use shall be defined broadly to include, without limitation, any use of the Premises by individuals or families for purposes of personal living, dwelling, or overnight accommodations, whether such uses are in single family residences, apartments, duplexes, or other multiple residential dwellings, trailers, trailer parks, camping sites, motels, hotels, or any other dwelling use of any kind), (b) any public or private school, day care, or any organized long-term or short-term child care of any kind, or (c) any agricultural purpose that results in, or could potentially result in, the human consumption of crops or livestock raised on the property (agricultural purpose shall be defined broadly to include, without limitation, activities such as food crop production, dairy farming, livestock breeding and keeping, and cultivation of grazing land that would ultimately produce, or lead to the production of, a product that could be consumed by a human). By acceptance of this deed, Grantee further covenants that it, its successors, heirs, legal representatives or assigns shall not use the groundwater underneath the Premises for human consumption, irrigation, or other purposes.

Grantee, by acceptance of this deed, covenants and represents that Grantee owns property adjoining the Premises and has access to the Premises through Grantee's adjoining property or through other property not owned by Grantor. Grantee, on its behalf, its heirs, personal representatives, successors and assigns, releases Grantor, its successors and assigns, from any responsibility, obligation or liability to provide access to the Premises through land now owned or subsequently acquired by Grantor. Should Grantee ever convey the Premises, or any portion thereof, to a third party, Grantee will provide access to the Premises through Grantee's adjoining property or through other property not owned by Grantor.

Prior to commencement of any development or construction on the Premises, Grantee shall construct and maintain, at Grantee's sole cost and expense, an adequate and suitable fence along the eastern line of the Premises which adjoins Grantor's railroad track for so long as a railroad track exists on the adjoining railroad operating property. The fence shall be of a type satisfactory to Grantor and reasonably sufficient to keep persons and vehicles from trespassing on Grantor's adjoining operating property.

Grantee, by acceptance of this deed, hereby covenants that it, its successors, heirs, legal representatives or assigns shall maintain the existing drainage on the Premises in such a manner as not to impair adjacent railroad operating property drainage and not to redirect or increase the quantity or velocity of surface water runoff or any streams into Grantor's drainage system or upon the adjacent railroad operating property or other lands and facilities of Grantor. If the Premises or existing drainage are modified or improved, Grantee agrees to construct and maintain, in accordance with all applicable statutes, ordinances, building and subdivision codes, covenants and restrictions, an adequate drainage system from the Premises to the nearest public or non-Grantor owned drainage or storm sewer system, in order to prevent the discharge of roof, surface, stream and other drainage waters upon railroad operating property or other adjacent lands and facilities of Grantor.

Grantee and Grantor agree and acknowledge the covenants and easements contained in this Deed shall be covenants "in gross" and easements "in gross" which shall remain binding on Grantee, its successors, heirs, legal representatives and assigns regardless of whether Grantor continues to own property adjacent to the Premises. Grantee acknowledges Grantor will continue to have a substantial interest in enforcement of the said covenants and easements whether or not Grantor retains title to property adjacent to the Premises.

Said covenant(s) shall run with title to the Premises conveyed, and bind upon Grantee, Grantee's heirs, legal representatives and assigns, or corporate successors and assigns, and anyone claiming title to or holding Premises through Grantee.

Grantor, by its undersigned officer, hereby certifies that the full value of all land or property conveyed hereby, or the actual consideration for the release of all property rights quitclaimed hereby, is \$390,000.00, including any property exchanged and any financing. The Grantees execute this deed for the sole purpose of certifying the consideration pursuant to KRS 382.135.

[THE REMAINDER OF THIS PAGE INTENTIONALLY LEFT BLANK]

IN WITNESS WHEREOF, CSX TRANSPORTATION, INC., pursuant to due corporate authority, has caused its name to be signed hereto by its officers hereunto duly authorized and its corporate seal, duly attested, to be hereunto affixed.

Signed, sealed and delivered  
in the presence of:

CSX TRANSPORTATION, INC.:

  
\_\_\_\_\_

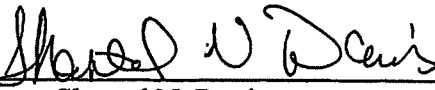
By:   
Name: Shantel N. Davis  
Title: Vice President  
Real Estate and Facilities

\_\_\_\_\_

Attest  (SEAL)  
Secretary

Print Name: STEVEN ARMBRUST  
ASST. CORPORATE SECRETARY

This instrument prepared by  
or under the direction of:

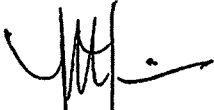

Kim R. Bongiovanni  
Assistant General Counsel  
Law Department  
500 Water Street  
Jacksonville, Florida 32202

STATE OF FLORIDA        )  
                                      ) SS.  
COUNTY OF DUVAL        )

I, Jennifer Bryan, a Notary Public of the State of Florida and the County of Duval, do certify that, on the date below, before me in said County came Shantel N. Davis (X) to me known, and/or ( ) proven by satisfactory current evidence to be the person whose name is subscribed, acknowledged and sworn to the above instrument, who, being by me first duly sworn, did make oath, acknowledge and say that: she is Vice President - Real Estate and Facilities of CSX Transportation, Inc., the corporation described in and which executed said instrument; she is fully informed of the contents of the instrument; she knows the seal of said corporation; the seal affixed to said instrument is such seal; it was so affixed by authority of the Board of Directors of said corporation; she signed her name thereto for said corporation pursuant to Board authority; and instrument is the free act and deed of said corporation; and the conveyance herein is not part of a transaction, sale, lease, exchange or other transfer or conveyance of all or substantially all of the property and/or assets of the Grantor.

IN WITNESS WHEREOF, I hereunto set my hand and official seal, this 3<sup>rd</sup> day of January, 2019.

My commission expires on:



Jennifer Bryan (SEAL)  
Notary Public  
Print Name: Jennifer Bryan

GRANTEE:

Signed, sealed and delivered  
in the presence of:

CITY OF PRESTONSBURG, KENTUCKY:

  
\_\_\_\_\_

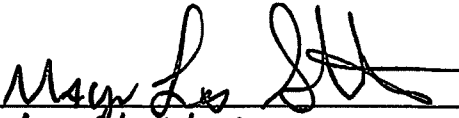
By:   
Name: Les Stapleton  
Title: MAYOR

STATE OF KENTUCKY

COUNTY OF FLOYD

The foregoing deed of conveyance and consideration certificate were produced,  
acknowledged and sworn to before me by Mayor Les Stapleton, Grantee, this 4 day  
of January, 2019.

My commission expires: 11/2/2021.

  
MARIE L. OSBORNE  
NOTARY PUBLIC

**In Care-Of Address For Property Tax Bill Is:**  
200 North Lake Drive  
Prestonsburg, Kentucky 41653  
c/o The City of Prestonsburg, Kentucky



**END ANNEXATION**

LAT = 37° 36' 5.2"  
LONG = 82° 53' 47.1"

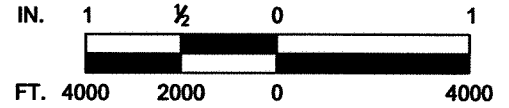
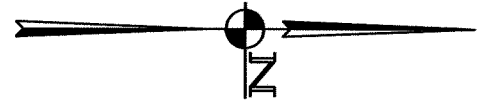

SCALE: 1"=4000'

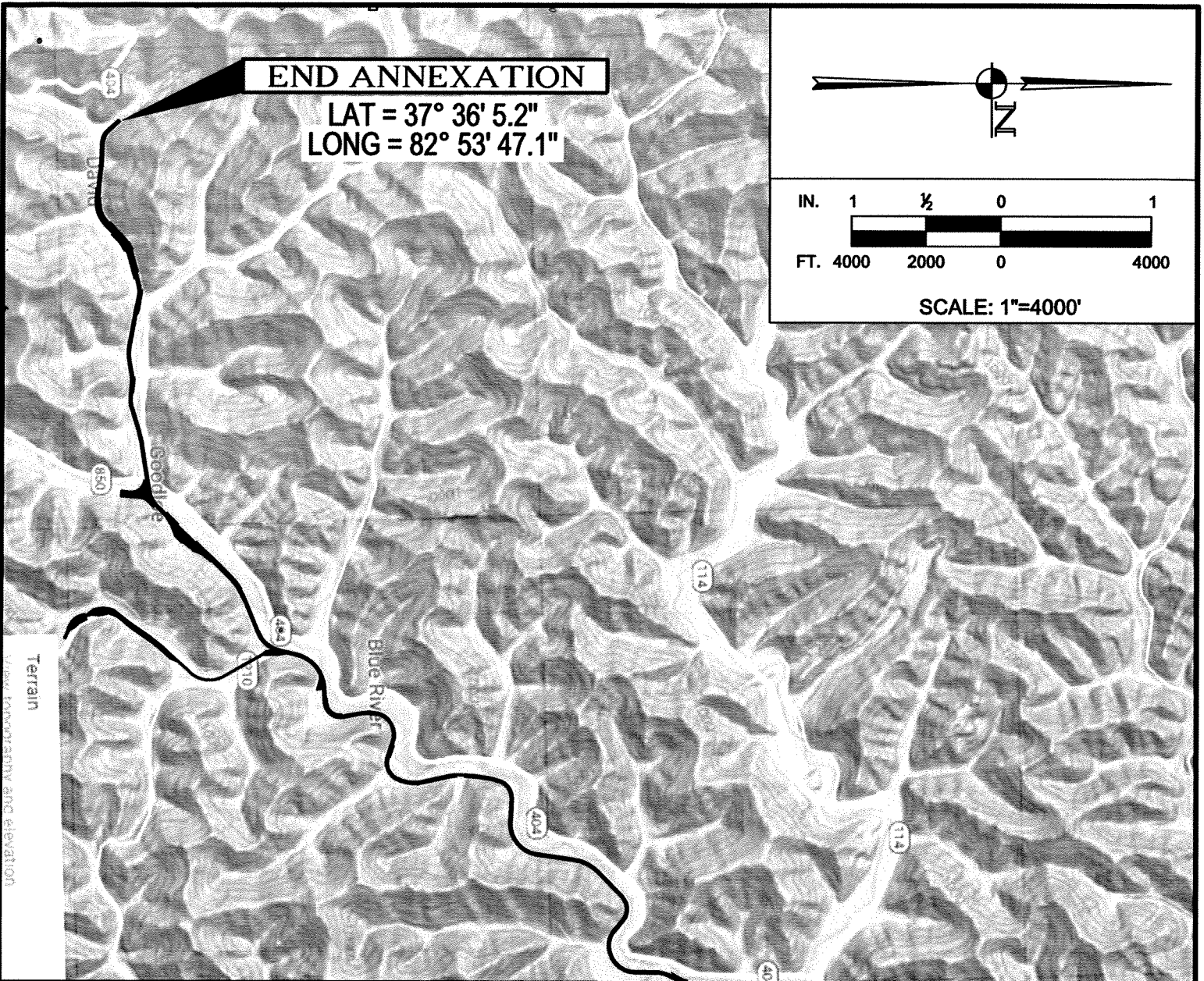

**CITY of PRESTONSBURG  
PROPOSED ANNEXATION  
Rails to Trails - W. Prestonsburg to David**

w.o. 9615annexrtotrail

date: 11/06/19

- Prepared By -

**BOCOOK ENGINEERING, INC**  
CONSULTING ENGINEERS

312 TENTH STREET  
PAINTSVILLE, KY 41240  
(606) 789-5961 - phone  
(606) 789-7671 - facsimile



259 N. ARNOLD AVE.  
PRESTONSBURG, KY 41653  
(606) 886-7884 - phone  
(606) 886-7895 - facsimile

**BEGIN ANNEXATION**

LAT = 37° 40' 18.8"  
LONG = 82° 46' 52.2"

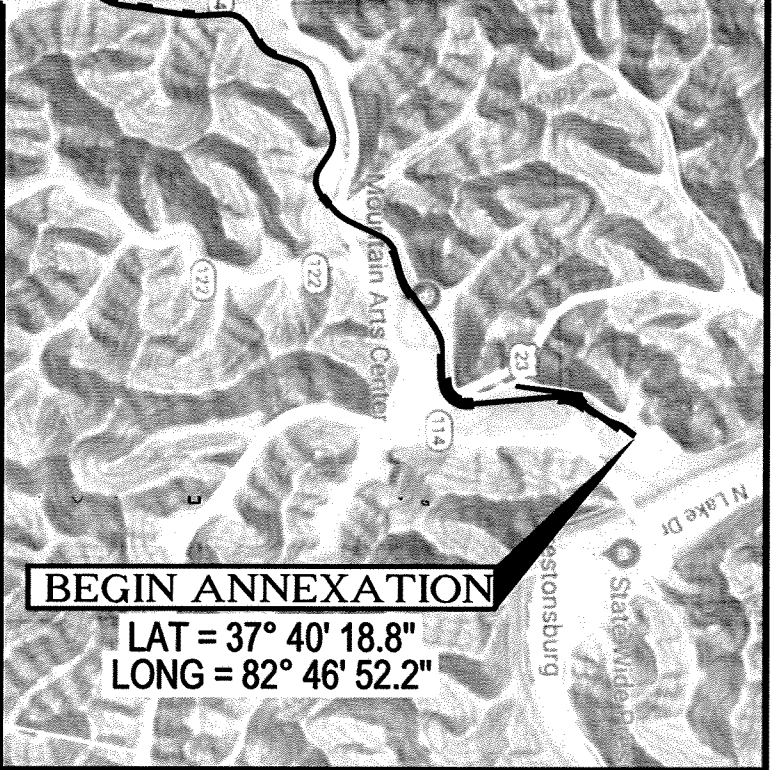

**LEGAL DESCRIPTION**

FIVE PARCELS OF LAND LOCATED IN THE COMMUNITY OF WEST PRESTONSBURG IN THE CITY OF PRESTONSBURG, FLOYD COUNTY, KENTUCKY, AND ENCOMPASSING THE CSXT RAIL ROAD RIGHT OF WAY FOR APPROXIMATELY 10 MILES TO THE COMMUNITY OF DAVID, FLOYD COUNTY, KENTUCKY, SAID PARCELS OF LAND BEING KNOWN AS THE CHESAPEAKE AND OHIO RAILWAY COMPANY MIDDLE CREEK BRANCH RAIL LINE AND BEING ALL OF RECORD SOURCE DEED BOOK 643 PAGE 57 AND BEING MORE PARTICULARLY DESCRIBED AS FOLLOWS:

BLOCK A: ✓

**BEGINNING** on an iron pin set on the western right of way of the CSXT railroad, said iron pin being on the right of way of Harkins Avenue and Duncan Street and having KY State Plane NAD83 south zone coordinates of north 2,140,966.96 and east 2,498,893.78; thence leaving the right of way of Harkins Avenue and with the right of way of the railroad and Duncan Street N 36°14'51" E 300.00 feet to an iron pin set, said iron pin being on the right of way of Stanley Avenue; thence leaving the right of way of Duncan Street and with the right of way of Stanley Avenue and the railroad S 53°45'09" E 125.00 feet to an iron pin set, said iron pin being a point in the center of an unnamed and abandoned alley way; thence leaving the right of way of Stanley Avenue and with the right of way of the railroad and the center of said alley S 36°14'51" W 210.00 feet to an un-monumented point; thence leaving the center of the alley and with the railroad right of way S 53°45'09" E 5.00 feet to an un-monumented point, said point being on the eastern right of way of said alley and the railroad right of way; thence S 36°14'51" W 90.00 feet to an un-monumented point, said point being in the rear corner of a building encroachment and being on the right of way of Harkins Avenue; thence with the right of way of Harkins Avenue and the railroad N 53°45'09" W 130.00 feet to the **BEGINNING** and containing 37,950.00 square feet or 0.87 acres.

BLOCK B: ✓

**BEGINNING** on an iron pin set on the western right of way of the CSXT railroad, said iron pin being on the right of way of Stanley Avenue and Duncan Street and having KY State Plane NAD83 south zone coordinates of north 2,141,241.16 and east 2,499,094.82; thence leaving the right of way of Stanley Avenue and with the right of way of the railroad and Duncan Street N 36°14'51" E 270.00 feet to a PK nail set, said PK nail being on the right of way of an unnamed and abandoned alley way; thence leaving the right of way of Duncan Street and with the right of way of said alley and the railroad S 53°45'09" E 120.00 feet to an iron pin set, said iron pin being right of way of said alley; thence continuing with the right of way of the alley and railroad S 36°14'51" W 270.00 feet to an iron pin set on the right of way of Stanley Avenue; thence leaving the right of way of said alley and with the right of way of Stanley Avenue and the railroad N 53°45'09" W 120.00 feet to the **BEGINNING** and containing 32,400.00 square feet or 0.74 acres.

*Thomas E. Nairn*



BLOCK C:

**BEGINNING** on a PK nail set on the western right of way of the CSXT railroad, said PK nail being on the right of way of Duncan Street and the right of way of an abandoned and unnamed alley way, said PK nail having KY State Plane NAD83 south zone coordinates of north 2,141,464.83 and east 2,499,263.29; thence leaving the right of way of said alley and with the right of way of the railroad and Duncan Street N 36°14'51" E 182.02 feet to a PK nail set, said PK nail being on the right of way of Railroad Avenue; thence leaving the right of way of Duncan Street and with the right of way of Railroad Avenue and the railroad S 25°06'40" E 144.00 feet to an un-monumented point, said point being referenced from two iron pins set on line S 25°03'40" E 26.14 feet and N 36°14'16" E 23.93 feet, thence leaving the right of way of Railroad Avenue and with the right of way of the railroad S 36°14'51" W 113.00 feet to an iron pin set on the right of way of the unnamed and abandoned alley; thence with the right of way of said alley and with the right of way of the railroad N 53°45'09" W 126.38 feet to the **BEGINNING** and containing 18,642.46 square feet or 0.43 acres.

TRACT 1:

For clarification purposes the following legal description contains line and curve data depicting the boundary survey of the railroad right of way. Each line and curve segment is noted with the prefix "L" for line and "C" for curve. These line and curve numbers correspond with the line and curve numbers contained on the accompanying survey plat described by this legal description.

**BEGINNING** on an iron pin set on the eastern right of way of the CSXT railroad, said iron pin having KY State Plane NAD83 south zone coordinates of north 2,140,522.35 and east 2,498,840.61; thence with the right of way of the railroad:

- L1: S 36°14'51" W 550.00 feet to an iron pin set
- L2: S 53°45'09" E 30.00 feet to an iron pin set
- L3: S 36°14'51" W 330.00 feet to an iron pin set
- L4: N 67°38'53" E 96.15 feet to an iron pin set
- L5: S 35°12'54" W 149.37 feet to an un-monumented point in Middle Creek
- C1: curve to the left having a radius of 623.64 feet an arc length of 431.68 feet and a chord bearing and distance S 11°15'11" W 423.11 feet to an iron pin set
- L6: N 73°44'37" W 109.56 feet to an un-monumented point in Middle Creek
- L7: S 05°09'30" E 463.77 feet to an iron pin set
- L8: S 05°09'12" E 476.16 feet to an iron pin set
- L9: S 05°09'26" E 870.04 feet to an iron pin set
- L10: N 84°50'36" E 50.00 feet to an un-monumented point in Middle Creek
- L234: S 05°09'24" E 71.70 feet to an un-monumented point in Middle Creek
- C2: curve to the right having a radius of 599.06 feet an arc length of 989.10 feet and a chord bearing and distance S 42°08'36" W 880.52 feet to an un-monumented point in Middle Creek

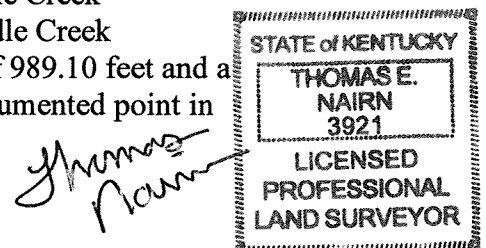

L11: S 00°35'15" E 20.00 feet to an un-monumented point in Middle Creek  
 L12: S 89°26'36" W 544.10 feet to an un-monumented point in Middle Creek  
 L13: N 00°33'24" W 70.00 feet to an iron pin set  
 C3: curve to the left having a radius of 905.37 feet an arc length of 536.46 feet and a chord bearing and distance S 72°28'06" W 528.65 feet to an iron pin set  
 L14: S 55°29'36" W 845.77 feet to an iron pin set next to a right of way monument  
 L15: S 34°30'24" E 70.00 feet to a PK nail set  
 L16: S 55°29'36" W 125.79 feet to an un-monumented point in Middle Creek  
 C4: curve to the right having a radius of 1075.37 feet an arc length of 345.34 feet and a chord bearing and distance S 64°41'36" W 343.86 feet to an iron pin set  
 L17: S 73°53'36" W 419.44 feet to an iron pin set  
 C5: curve to the left having a radius of 596.78 feet an arc length of 165.07 feet and a chord bearing and distance S 65°58'10" W 164.54 feet to an un-monumented point in Middle Creek  
 L18: N 31°57'16" W 70.00 feet to an iron pin set  
 C6: curve to the left having a radius of 666.78 feet an arc length of 385.22 feet and a chord bearing and distance S 41°29'40" W 379.89 feet to an un-monumented point  
 L19: S 24°56'36" W 704.23 feet to a PK nail set in an 18" birch tree next to a right of way monument found  
 C7: curve to the right having a radius of 1,005.37 feet an arc length of 394.81 feet and a chord bearing and distance S 36°11'36" W 392.27 feet to an iron pin set  
 L20: S 47°26'36" W 147.90 feet to an iron pin set  
 L21: S 61°30'20" E 31.72 feet to an iron pin set  
 L22: S 47°26'36" W 270.10 feet to an iron pin set  
 L23: N 42°33'24" W 30.00 feet to an iron pin set  
 C8: curve to the right having a radius of 528.34 feet an arc length of 699.28 feet and a chord bearing and distance S 85°21'36" W 649.34 feet to an iron pin set next to a right of way monument found  
 L24: N 56°43'24" W 350.26 feet to an iron pin set  
 C9: curve to the left having a radius of 523.69 feet an arc length of 500.72 feet and a chord bearing and distance N 84°06'54" W 481.86 feet to an iron pin set next to a right of way monument found  
 L25: S 68°29'35" W 531.24 feet to an iron pin set  
 L26: S 68°29'39" W 591.33 feet to an iron pin set next to a right of way monument found  
 C10: curve to the left having a radius of 510.26 feet an arc length of 467.32 feet and a chord bearing and distance S 42°35'51" W 451.16 feet to an iron pin set next to a right of way monument found  
 L27: S 17°29'36" W 471.00 feet to an iron pin set next to a right of way monument found  
 C11: curve to the right having a radius of 623.69 feet an arc length of 456.10 feet and a chord bearing and distance S 38°26'36" W 446.00 feet to an iron pin set next to a right of way monument found  
 L28: S 59°23'36" W 375.30 feet to an iron pin set next to a right of way monument found

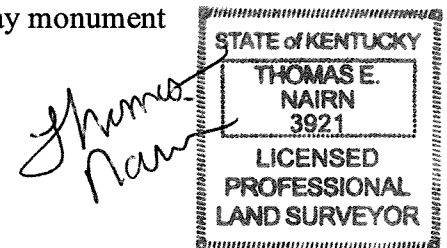

C12: curve to the left having a radius of 523.69 feet an arc length of 580.24 feet and a chord bearing and distance S 27°39'06" W 551.01 feet to an iron pin set next to a right of way monument found

L29: S 04°16'56" E 412.56 feet to an iron pin set next to a right of way monument found

C13: curve to the right having a radius of 1,960.08 feet an arc length of 429.90 feet and a chord bearing and distance S 02°00'04" W 429.04 feet to an iron pin set next to a right of way monument found

L30: S 08°17'05" W 704.21 feet to an iron pin set

L31: S 08°26'40" W 722.63 feet to an iron pin set

C14: curve to the right having a radius of 667.11 feet an arc length of 262.95 feet and a chord bearing and distance S 18°50'29" W 261.25 feet to an iron pin

L32: S 28°13'08" W 198.80.00 feet to an iron pin set

L33: S 27°31'16" W 109.61 feet to an iron pin set

C15: curve to the left having a radius of 541.99 feet an arc length of 251.63 feet and a chord bearing and distance S 14°07'07" W 249.37 feet to an un-monumented point in a drain

L34: S 00°33'10" W 619.77 feet to an iron pin set next to a right of way monument found

C16: curve to the right having a radius of 766.60 feet an arc length of 1,284.41 feet and a chord bearing and distance S 48°45'03" W 1,139.36 feet to an iron pin set

C17: curve to the right having a radius of 598.81 feet an arc length of 358.86 feet and a chord bearing and distance N 66°48'08" W 353.51 feet to an un-monumented point

L35: N 50°47'57" W 371.75 feet to an iron pin set

C18: curve to the left having a radius of 420.59 feet an arc length of 363.68 feet and a chord bearing and distance N 75°05'34" W 352.45 feet to an iron pin set

C19: curve to the left having a radius of 476.72 feet an arc length of 263.60 feet and a chord bearing and distance S 62°40'31" W 260.26 feet to an iron pin set next to a right of way monument found

L36: S 45°38'41" W 908.88 feet to an iron pin set next to a right of way monument found

C20: curve to the left having a radius of 1,136.12 feet an arc length of 720.22 feet and a chord bearing and distance S 26°32'48" W 708.22 feet to an iron pin set next to a right of way monument found

L37: S 08°03'56" W 734.90 feet to an iron pin set next to a right of way monument found

L38: S 08°03'57" W 279.02 feet to an iron pin set next to a right of way monument found

C21: curve to the right having a radius of 871.53 feet an arc length of 1,258.52 feet and a chord bearing and distance N 50°39'16" E 1,151.99 feet to an iron pin set

L160: N 86°44'41" W 17.26 feet to an iron pin set next to a right of way monument found

L39: N 86°59'56" W 249.97 feet to an iron pin set

L40: N 86°59'56" W 370.20 feet to an iron pin set next to a right of way monument found

C22: curve to the left having a radius of 428.34 feet an arc length of 393.07 feet and chord bearing and distance S 66°42'44" W 379.42 feet to an iron pin set

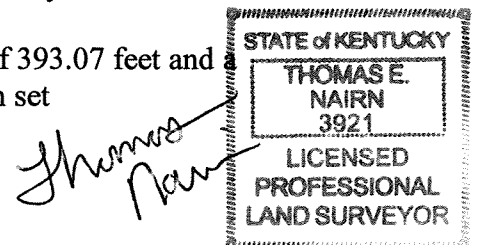

C23: curve to the left having a radius of 428.34 feet an arc length of 151.93 feet and a chord bearing and distance S 30°15'44" W 151.13 feet to an iron pin set next to a right of way monument found

C24: curve to the left having a radius of 1,860.08 feet an arc length of 485.89 feet and a chord bearing and distance S 12°37'04" W 484.50 feet to an iron pin set next to a right of way monument found

L235: S 05°08'04" W 10.00 feet to an iron pin set

L41: S 05°08'04" W 149.57 feet to an iron pin set

L42: S 05°08'04" W 322.43 feet to an un-monumented point

L43: N 84°51'56" W 25.00 feet to an un-monumented point

L44: S 05°08'04" W 79.10 feet to an un-monumented point

C25: curve to the left having a radius of 1,121.28 feet an arc length of 36.33 feet and a chord bearing and distance S 04°12'22" W 36.33 feet to an un-monumented point

C26: curve to the left having a radius of 1,121.28 feet an arc length of 81.97 feet and a chord bearing and distance S 01°11'01" W 81.95 feet to an un-monumented point

L45: N 89°05'22" E 35.00 feet to an un-monumented point

C27: curve to the left having a radius of 1,086.28 feet an arc length of 224.13 feet and a chord bearing and distance S 06°49'17" E 223.73 feet to an un-monumented point

L46: S 12°43'56" E 589.57 feet to an iron pin set

L47: S 12°43'56" E 162.29 feet to an iron pin set

C28: curve to the right having a radius of 1,015.37 feet an arc length of 118.77 feet and a chord bearing and distance S 09°22'53" E 118.70 feet to an iron pin set

L48: S 83°58'11" W 10.00 feet to an iron pin set

C29: curve to the right having a radius of 1,250.19 feet an arc length of 233.08 feet and a chord bearing and distance S 01°33'33" W 232.74 feet to an iron pin set

C30: curve to the right having a radius of 1,005.37 feet an arc length of 393.08 feet and a chord bearing and distance S 18°46'01" W 390.58 feet to an iron pin set

C31: curve to the right having a radius of 528.34 feet an arc length of 723.71 feet and a chord bearing and distance S 69°12'34" W 668.45 feet to an iron pin set next to a right of way monument found

L49: N 71°32'56" W 436.61 feet to an iron pin set next to a right of way monument found

C32: curve to the left having a radius of 526.18 feet an arc length of 889.77 feet and a chord bearing and distance S 59°28'46" W 787.48 feet to an un-monumented point

C33: curve to the left having a radius of 1,129.45 feet an arc length of 420.70 feet and a chord bearing and distance S 00°09'31" W 418.27 feet to an iron pin set

L50: S 10°33'59" E 487.47 feet to an un-monumented point next to a right of way marker found

C34: curve to the right having a radius of 459.84 feet an arc length of 770.41 feet and a chord bearing and distance S 38°22'37" W 683.42 feet to an iron pin set

L51: S 86°39'20" W 342.33 feet to a PK nail set in asphalt driveway

L52: S 03°02'56" E 164.00 feet to an un-monumented point

L53: N 75°30'18" W 188.33 feet to an un-monumented point

L54: N 72°10'43" W 71.74 feet to an un-monumented point

C35: curve to the left having a radius of 566.10 feet an arc length of 150.12 feet and a chord bearing and distance N 87°16'00" W 149.69 feet to an un-monumented point

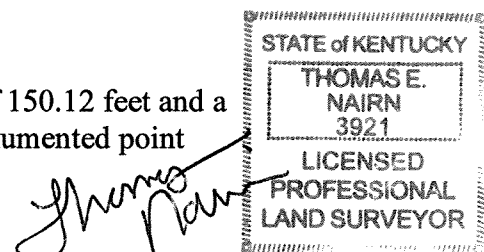



L55: S 64°14'12" W 15.70 feet to an un-monumented point  
 C36: curve to the left having a radius of 911.75 feet an arc length of 807.84 feet and a chord bearing and distance S 38°15'17" W 781.67 feet to an iron pin  
 L56: S 12°40'16" W 102.82 feet to an iron pin set  
 L57: S 12°43'31" W 169.34 feet to an iron pin set  
 C37: curve to the right having a radius of 754.97 feet an arc length of 430.91 feet and a chord bearing and distance S 16°51'24" W 425.08 feet to an iron pin  
 C38: curve to the right having a radius of 859.23 feet an arc length of 603.75 feet and a chord bearing and distance S 47°53'19" W 591.41 feet to an iron pin set  
 L58: S 67°43'57" W 135.72 feet to an iron pin set  
 L59: S 67°36'04" W 776.10 feet to an iron pin set next to a right of way monument found  
 C39: curve to the left having a radius of 1,884.71 feet an arc length of 766.23 feet and a chord bearing and distance S 55°52'37" W 760.96 feet to an iron pin set next to a right of way monument found  
 L60: S 44°08'05" W 625.66 feet to an iron pin set next to a right of way monument found  
 L61: S 45°51'56" E 20.00 feet to an iron pin set  
 L62: S 41°16'19" W 300.08 feet to an un-monumented point  
 L63: S 20°15'30" W 267.75 feet to an iron pin set  
 L64: N 53°13'38" W 18.46 feet to an iron pin set  
 C40: curve to the right having a radius of 529.19 feet an arc length of 128.24 feet and a chord bearing and distance S 34°59'45" W 127.93 feet to an iron pin set  
 L65: S 40°51'24" W 46.70 feet to an iron pin set  
 C41: curve to the right having a radius of 1,566.91 feet an arc length of 66.68 feet and a chord bearing and distance S 36°16'26" W 66.67 feet to an iron pin set  
 C42: curve to the right having a radius of 575.89 feet an arc length of 69.02 feet and a chord bearing and distance S 39°58'56" W 68.98 feet to an un-monumented point  
 L66: S 07°11'12" W 49.14 feet to an un-monumented point  
 L67: S 44°18'43" W 165.11 feet to an un-monumented point  
 C43: curve to the right having a radius of 752.67 feet an arc length of 93.88 feet and a chord bearing and distance S 45°57'24" W 93.82 feet to an un-monumented point  
 L68: S 69°26'51" W 204.56 feet to an un-monumented point  
 C44: curve to the left having a radius of 4,488.0 feet an arc length of 136.25 feet and a chord bearing and distance S 64°10'41" W 136.25 feet to an iron pin an un-monumented point  
 C45: curve to the left having a radius of 827.26 feet an arc length of 153.05 feet and a chord bearing and distance S 58°00'29" W 152.83 feet to an un-monumented point  
 C46: curve to the left having a radius of 898.19 feet an arc length of 68.27 feet and a chord bearing and distance S 54°53'07" W 68.26 feet to an un-monumented point  
 C47: curve to the left having a radius of 191.70 feet an arc length of 69.23 feet and a chord bearing and distance S 46°48'43" W 68.86 feet to an iron pin set  
 L69: S 44°26'17" W 361.89 feet to an iron pin set next to a right of way monument found  
 C48: curve to the right having a radius of 645.43 feet an arc length of 397.01 feet and a chord bearing and distance S 62°39'10" W 390.78 feet to an iron pin set  
 L70: S 80°35'04" W 621.34 feet to an iron pin set

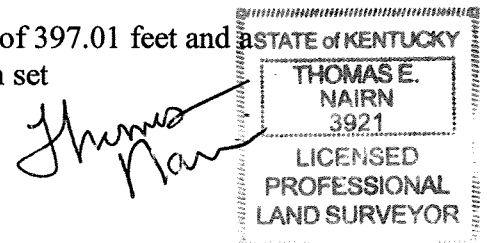

L71: S 80°35'04" W 754.50 feet to an iron pin set  
 C49: curve to the left having a radius of 2,133.03 feet an arc length of 262.97 feet and a chord bearing and distance S 76°16'31" W 262.80 feet to an iron pin set  
 L72: S 72°29'04" W 684.00 feet to an iron pin set next to a right of way monument found  
 C50: curve to the right having a radius of 723.31 feet an arc length of 308.03 feet and a chord bearing and distance S 84°50'14" W 305.71 feet to an iron pin set next to a right of way monument found  
  
 L73: N 84°58'54" W 366.96 feet to an iron pin set next to a right of way monument found  
 C51: curve to the left having a radius of 689.43 feet an arc length of 229.72 feet and a chord bearing and distance S 86°58'00" W 228.66 feet to an iron pin set  
 L74: S 79°06'34" W 343.24 feet to an iron pin set next to a right of way monument found  
 C52: curve to the right having a radius of 1,043.95 feet an arc length of 382.03 feet and a chord bearing and distance S 89°36'12" W 379.90 feet to an iron pin set  
 L75: N 79°45'58" W 571.19 feet to an iron pin set  
 L76: N 79°46'02" W 601.46 feet to an iron pin set  
 L77: N 10°58'24" W 15.02 feet to an iron pin set  
 L78: N 79°45'56" W 233.96 feet to a PK nail set  
 C53: curve to the left having a radius of 543.07 feet an arc length of 298.67 feet and a chord bearing and distance S 86°26'54" W 294.92 feet to an iron pin set  
 L79: S 74°35'06" W 155.52 feet to an iron pin set  
 L80: S 15°25'33" E 35.00 feet to an iron pin set  
 L81: S 74°40'13" W 119.91 feet to an iron pin set  
 L82: S 74°35'06" W 470.60 feet to an iron pin set  
 C54: curve to the left having a radius of 980.98 feet an arc length of 195.67 feet and a chord bearing and distance S 69°52'09" W 195.34 feet to an iron pin set  
 L83: S 24°50'02" E 45.00 feet to an iron pin set  
 C55: curve to the left having a radius of 901.83 feet an arc length of 402.48 feet and a chord bearing and distance S 54°13'21" W 399.15 feet to an iron pin set  
 L84: S 45°33'54" W 178.57 feet to an iron pin set  
 L85: N 44°25'59" W 35.01 feet to an iron pin set  
 L86: S 45°53'37" W 278.42 feet to an iron pin set  
 C56: curve to the right having a radius of 882.35 feet an arc length of 300.60 feet and a chord bearing and distance S 54°25'35" W 299.15 feet to an iron pin set  
 C57: curve to the right having a radius of 899.74 feet an arc length of 423.22 feet and a chord bearing and distance S 76°21'16" W 419.32 feet to an iron pin set  
 C58: curve to the right having a radius of 1,801.37 feet an arc length of 248.32 feet and a chord bearing and distance N 85°52'13" W 248.13 feet to an iron pin set  
 L87: N 84°22'20" W 134.30 feet to an iron pin set  
 L88: N 00°32'21" E 17.00 feet to an iron pin set  
 L89: N 83°27'27" W 78.81 feet to an iron pin set  
 L90: N 83°31'26" W 124.47 feet to an iron pin set  
 L91: N 84°08'45" W 121.39 feet to an iron pin set

  
 STATE of KENTUCKY  
 THOMAS E. NAIRN  
 3921  
 LICENSED PROFESSIONAL LAND SURVEYOR



C59: curve to the left having a radius of 8,270.87 feet an arc length of 209.04 feet and a chord bearing and distance N 83°36'07" W 209.04 feet to an un-monumented point  
 L236: N 83°13'54" W 68.11 feet to an un-monumented point  
 C60: curve to the left having a radius of 842.12 feet an arc length of 210.41 feet and a chord bearing and distance N 87°06'05" W 209.86 feet to an iron pin set  
 C61: curve to the left having a radius of 1,649.99 feet an arc length of 104.57 feet and a chord bearing and distance N 88°41'01" W 104.56 feet to an iron pin set  
 L92: N 89°52'13" W 240.27 feet to an iron pin set  
 C62: curve to the right having a radius of 537.96 feet an arc length of 446.75 feet and a chord bearing and distance N 65°29'36" W 434.03 feet to an iron pin set  
  
 L93: N 41°28'56" W 402.83 feet to an iron pin set at end of the railroad right of way thence crossing the right of way  
 L93A: N 48°31'04" E 100.00 feet to an iron pin set  
 L94: S 41°28'56" E 402.83 feet to an iron pin set  
 C63: curve to the left having a radius of 438.01 feet an arc length of 362.11 feet and a chord bearing and distance S 65°26'15" E 351.88 feet to an iron pin set  
 L95: S 89°40'46" E 238.31 feet to an iron pin set  
 C64: curve to the right having a radius of 6,918.85 feet an arc length of 106.51 feet and a chord bearing and distance S 88°48'59" E 106.51 feet to an iron pin set  
 C65: curve to the right having a radius of 1,034.63 feet an arc length of 227.82 feet and a chord bearing and distance S 86°36'01" E 227.36 feet to an un-monumented point  
 L237: S 83°13'54" E 68.11 feet to an iron pin set  
 L96: S 83°45'46" E 102.54 feet to an iron pin set  
 L97: S 84°07'02" E 106.72 feet to an iron pin set  
 L98: S 83°13'08" E 114.90 feet to an iron pin set  
 L99: S 83°36'32" E 114.67 feet to an iron pin set  
 L100: S 84°35'37" E 88.62 feet to an iron pin set  
 L101: N 00°30'56" E 10.00 feet to an iron pin set  
 L102: S 84°19'21" E 119.07 feet to an iron pin set  
 L103: S 83°40'43" E 141.77 feet to an iron pin set  
 L104: N 00°33'12" E 30.00 feet to an iron pin set  
 C66: curve to the left having a radius of 882.27 feet an arc length of 344.26 feet and a chord bearing and distance N 84°09'59" E 342.08 feet to an iron pin set  
 C67: curve to the left having a radius of 798.28 feet an arc length of 366.16 feet and a chord bearing and distance N 58°45'39" E 362.96 feet to an iron pin set  
 L105: N 44°26'36" W 28.39 feet to an iron pin set  
 L106: N 45°34'04" E 459.17 feet to an iron pin set  
 C68: curve to the right having a radius of 1,314.01 feet an arc length of 262.77 feet and a chord bearing and distance N 49°18'18" E 262.33 feet to an iron pin set  
 L107: N 33°50'56" W 20.00 feet to an iron pin set  
 C69: curve to the right having a radius of 1,175.54 feet an arc length of 271.83 feet and a chord bearing and distance N 61°46'50" E 271.23 feet to an iron pin set  
 L108: S 22°35'57" E 30.00 feet to an iron pin set  
 C70: curve to the right having a radius of 1,059.08 feet an arc length of 169.63 feet and a chord bearing and distance N 70°59'42" E 169.45 feet to an iron pin set  
 L109: N 74°35'06" E 440.51 feet to an iron pin set

*Thomas E. Nairn*

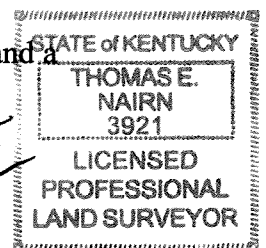

L110: S 15°24'48" E 30.18 feet to an un-monumented point  
 L111: N 74°35'16" E 305.53 feet to an iron pin set  
 C71: curve to the right having a radius of 577.00 feet an arc length of 154.32 feet and a chord bearing and distance N 80°06'17" E 153.86 feet to an iron pin set  
 L112: N 03°49'54" W 30.23 feet to an iron pin set  
 C72: curve to the right having a radius of 882.49 feet an arc length of 195.00 feet and a chord bearing and distance S 87°59'51" E 194.60 feet to an iron pin set  
 L113: S 79°46'00" E 398.30 feet to an un-monumented point  
 L114: S 00°40'57" E 14.27 feet to an un-monumented point  
 L115: S 79°46'05" E 76.00 feet to an un-monumented point  
 L116: S 10°13'53" W 30.01 feet to an un-monumented point  
 L117: S 79°45'58" E 392.47 feet to an iron pin set  
 L118: S 79°45'54" E 489.78 feet to an iron pin set  
 C73: curve to the left having a radius of 934.64 feet an arc length of 344.01 feet and a chord bearing and distance N 89°37'59" E 342.07 feet to an iron pin set  
 L119: N 79°06'39" E 343.23 feet to an un-monumented point  
 C74: curve to the right having a radius of 662.41 feet an arc length of 97.06 feet and a chord bearing and distance N 81°36'57" E 96.98 feet to an un-monumented point  
 L120: N 05°10'56" W 30.00 feet to an un-monumented point  
 C75: curve to the right having a radius of 758.52 feet an arc length of 168.03 feet and a chord bearing and distance S 89°49'57" E 167.69 feet to an un-monumented point  
 L121: S 85°08'39" E 277.27 feet to an iron pin set  
 L122: S 05°31'41" W 30.00 feet to an iron pin set  
 L123: S 84°28'46" E 89.71 feet to an iron pin set next to a right of way monument found  
 C76: curve to the left having a radius of 616.43 feet an arc length of 267.89 feet and a chord bearing and distance N 84°57'44" E 265.79 feet to an iron pin set  
 L124: N 72°29'04" E 684.00 feet to an iron pin set  
 C77: curve to the right having a radius of 2,231.01 feet an arc length of 277.10 feet and a chord bearing and distance N 76°17'19" E 276.93 feet to a PK nail set in the edge of route 404  
 L125: N 80°35'02" E 754.50 feet to a PK nail set in the edge of route 404  
 L126: N 80°35'04" E 621.34 feet to an un-monumented point  
 C78: curve to the left having a radius of 545.35 feet an arc length of 335.05 feet and a chord bearing and distance N 62°37'05" E 329.81 feet to an un-monumented point in the left fork of Middle Creek  
 L127: N 44°26'18" E 360.14 feet to an un-monumented point in the left fork of Middle Creek  
 L128: N 45°54'56" W 30.00 feet to an iron pin set  
 L129: N 44°05'04" E 450.00 feet to an iron pin set  
 L130: S 45°54'56" E 30.00 feet to an un-monumented point in the left fork of Middle Creek  
 L131: N 44°05'04" E 650.00 feet to an un-monumented point in the left fork of Middle Creek  
 L132: N 45°54'56" W 30.00 feet to an iron pin set  
 L133: N 44°05'04" E 350.00 feet to an iron pin set  
 L134: N 44°08'01" E 295.12 feet to an un-monumented point in the left fork of Middle Creek

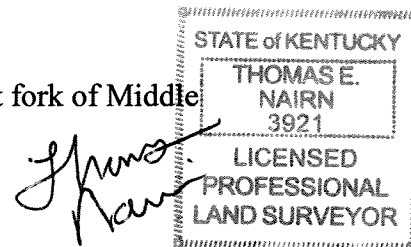

L135: N 44°08'06" E 630.42 feet to an iron pin set  
 C79: curve to the right having a radius of 2,059.44 feet an arc length of 494.25 feet and a chord bearing and distance N 51°14'23" E 493.07 feet to an iron pin set  
 L136: S 31°45'54" E 30.00 feet to an un-monumented point in the left fork of Middle Creek  
 C80: curve to the right having a radius of 1,960.08 feet an arc length of 320.41 feet and a chord bearing and distance N 62°55'05" E 320.05 feet to an un-monumented point in the left fork of Middle Creek  
 L137: N 67°36'04" E 776.10 feet to an iron pin set  
 L138: N 67°36'04" E 138.91 feet to an iron pin set next to a right of way monument found  
 C81: curve to the left having a radius of 763.51 feet an arc length of 735.31 feet and a chord bearing and distance N 40°08'23" E 707.22 feet to an iron pin set  
 L139: N 12°46'48" E 372.76 feet to an iron pin set  
 L140: N 13°07'40" E 94.74 feet to an iron pin set  
 C82: curve to the right having a radius of 1,004.16 feet an arc length of 1,309.35 feet and a chord bearing and distance N 49°55'51" E 1,218.54 feet to an iron pin set next to a right of way monument found  
 L141: N 86°57'04" E 279.50 feet to an un-monumented point in the left fork of Middle Creek  
 L142: N 03°02'56" W 30.00 feet to an iron pin set  
 L143: N 86°57'04" E 111.60 feet to an iron pin set  
 C83: curve to the left having a radius of 321.05 feet an arc length of 545.63 feet and a chord bearing and distance N 39°00'07" E 482.30 feet to an iron pin set  
 L144: N 80°34'32" E 30.00 feet to an un-monumented point in the left fork of Middle Creek  
 L145: N 10°22'00" W 495.98 feet to an iron pin set  
 C84: curve to the right having a radius of 1,217.75 feet an arc length of 458.62 feet and a chord bearing and distance N 00°07'05" E 455.91 feet to an un-monumented point in the left fork of Middle Creek  
 C85: curve to the right having a radius of 625.36 feet an arc length of 1,059.29 feet and a chord bearing and distance N 59°35'50" E 937.12 feet to an iron pin set  
 L146: S 72°40'35" E 90.13 feet to an iron pin set  
 L147: N 18°27'04" E 30.00 feet to an iron pin set  
 L148: S 71°32'56" E 346.00 feet to an un-monumented point in the left fork of Middle Creek  
 L149: S 18°27'04" W 30.00 feet to an iron pin set  
 C86: curve to the left having a radius of 428.24 feet an arc length of 586.60 feet and a chord bearing and distance N 69°12'34" E 541.80 feet to an iron pin set  
 C87: curve to the left having a radius of 905.26 feet an arc length of 353.94 feet and a chord bearing and distance N 18°46'01" E 351.69 feet to an iron pin set  
 C88: curve to the left having a radius of 1,172.54 feet an arc length of 209.34 feet and a chord bearing and distance N 01°40'34" E 209.06 feet to an iron pin set next to a right of way monument found  
 L150: N 83°58'11" E 10.00 feet to an iron pin set

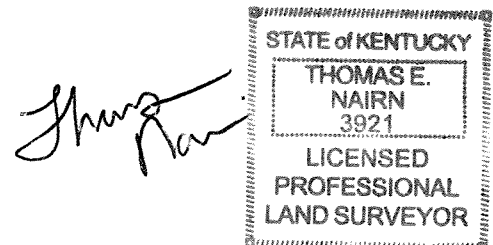

C89: curve to the left having a radius of 915.37 feet an arc length of 107.07 feet and a chord bearing and distance N 09°22'53" W 107.01 feet to an iron pin set next to a right of way monument found

L151: N 12°43'56" W 162.29 feet to an iron pin set

L152: N 12°43'56" W 589.57 feet to an un-monumented point

C90: curve to the right having a radius of 1,186.28 feet an arc length of 331.48 feet and a chord bearing and distance N 04°43'38" W 330.41 feet to an un-monumented point

C91: curve to the right having a radius of 1,186.28 feet an arc length of 38.44 feet and a chord bearing and distance N 04°12'22" E 38.43 feet to an un-monumented point

L153: N 05°08'04" E 79.10 feet to an un-monumented point

L154: N 84°51'56" W 10.00 feet to an un-monumented point

L155: N 05°08'04" E 322.43 feet to an un-monumented point

L156: N 05°08'04" E 149.57 feet to an un-monumented point

L157: N 05°08'04" E 10.00 feet to an un-monumented point

C92: curve to the right having a radius of 1,960.08 feet an arc length of 512.01 feet and a chord bearing and distance N 12°37'04" E 510.55 feet to an iron pin set

C93: curve to the right having a radius of 528.34 feet an arc length of 187.40 feet and a chord bearing and distance N 30°15'44" E 186.42 feet to an iron pin set

C94: curve to the right having a radius of 528.34 feet an arc length of 484.83 feet and a chord bearing and distance N 66°42'44" E 468.00 feet to an iron pin set

L158: S 86°59'56" E 370.20 feet to an iron pin set

L159: S 86°59'56" E 249.97 feet to an un-monumented point in the left fork of Middle Creek

L161: S 84°46'14" E 16.24 feet to an un-monumented point in the left fork of Middle Creek

C95: curve to the left having a radius of 754.43 feet an arc length of 603.41 feet and a chord bearing and distance N 69°23'31" E 587.46 feet to an iron pin set

C96: curve to the left having a radius of 806.09 feet an arc length of 490.33 feet and a chord bearing and distance N 28°46'07" E 482.81 feet to an un-monumented in the left fork of Middle Creek

L162: N 08°31'46" E 290.25 feet to an iron pin set next to a right of way monument found

L163: N 08°12'45" E 739.30 feet to an iron pin set

C97: curve to the right having a radius of 1,220.87 feet an arc length of 784.06 feet and a chord bearing and distance N 26°27'07" E 770.65 feet to an un-monumented point in the left fork of Middle Creek

L164: N 44°56'58" E 139.54 feet to an un-monumented point in the left fork of Middle Creek

L165: N 45°41'53" E 770.93 feet to an un-monumented point in the left fork of Middle Creek

C99: curve to the right having a radius of 603.52 feet an arc length of 341.78 feet and a chord bearing and distance N 64°18'07" E 337.23 feet to an iron pin set

C98: curve to the right having a radius of 539.23 feet an arc length of 244.62 feet and a chord bearing and distance S 84°42'11" E 242.53 feet to an un-monumented point in the left fork of Middle Creek

*Thomas Nairn*

STATE of KENTUCKY
THOMAS E. NAIRN 3921
LICENSED PROFESSIONAL LAND SURVEYOR

C100: curve to the right having a radius of 555.67 feet an arc length of 184.70 feet and a chord bearing and distance S 60°49'10" E 183.85 feet to an iron pin set next to a right of way monument found  
L166: S 50°47'52" E 371.75 feet to an iron pin set  
C101: curve to the left having a radius of 508.65 feet an arc length of 302.01 feet and a chord bearing and distance S 66°45'31" E 297.59 feet to an iron pin set  
C103: curve to the left having a radius of 666.47 feet an arc length of 1,116.99 feet and a chord bearing and distance N 48°45'03" E 990.77 feet to an iron pin set  
L167: N 00°33'09" E 620.01 feet to an iron pin set  
C104: curve to the right having a radius of 891.96 feet an arc length of 298.20 feet and a chord bearing and distance N 14°08'38" E 296.82 feet to an iron pin set  
L168: N 27°40'52" E 110.21 feet to an iron pin set  
L169: S 60°10'02" W 98.54 feet to an un-monumented point in the left fork of Middle Creek  
L170: N 28°39'05" E 282.79 feet to an iron pin set  
C105: curve to the left having a radius of 514.28 feet an arc length of 211.63 feet and a chord bearing and distance N 18°50'34" E 210.14 feet to an un-monumented point in the left fork of Middle Creek  
L171: S 80°58'02" E 50.00 feet to an iron pin set next to a right of way monument found  
L172: N 08°33'27" E 421.33 feet to an iron pin set  
L173: N 81°42'56" W 50.00 feet to an un-monumented point in the left fork of Middle Creek  
L174: N 08°17'04" E 300.00 feet to an un-monumented point in the left fork of Middle Creek  
L175: S 81°42'56" E 50.00 feet to an iron pin set  
L176: N 08°17'04" E 650.00 feet to an iron pin set  
L177: N 81°42'56" W 50.00 feet to an iron pin set  
L178: N 08°17'04" E 54.21 feet to an iron pin set  
C106: curve to the left having a radius of 1,810.08 feet an arc length of 185.56 feet and a chord bearing and distance N 05°20'51" E 185.48 feet to an iron pin set  
L179: S 87°35'21" E 50.00 feet to an un-monumented point in the left fork of Middle Creek  
C107: curve to the left having a radius of 1,860.08 feet an arc length of 217.28 feet and a chord bearing and distance N 00°56'09" W 217.16 feet to an un-monumented point in the left fork of Middle Creek  
L180: N 04°16'56" W 412.90 feet to an iron pin set  
C108: curve to the right having a radius of 623.69 feet an arc length of 691.04 feet and a chord bearing and distance N 27°39'06" E 656.23 feet to an un-monumented point in Middle Creek  
L181: N 59°23'36" E 328.60 feet to an un-monumented point in Middle Creek  
L182: N 30°36'24" W 50.00 feet to an iron pin set  
L183: N 59°23'36" E 46.70 feet to an iron pin set  
C109: curve to the left having a radius of 473.69 feet an arc length of 346.40 feet and a chord bearing and distance N 38°26'36" E 338.74 feet to an iron pin set  
L184: N 17°29'36" E 34.30 feet to an iron pin set  
L185: S 72°30'24" E 50.00 feet to an un-monumented point in Middle Creek  
L186: N 17°29'36" E 436.70 feet to an iron pin set

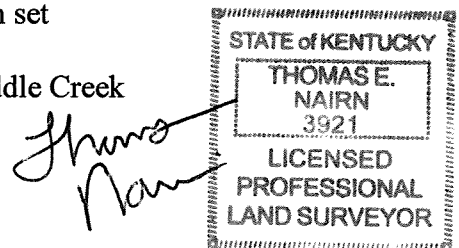

C110: curve to the right having a radius of 610.33 feet an arc length of 556.32 feet and a chord bearing and distance N 42°39'41" E 537.26 feet to an iron pin set  
 L187: N 68°29'38" E 595.61 feet to an iron pin set  
 L188: N 68°29'35" E 526.96 feet to an iron pin set  
 C111: curve to the right having a radius of 623.69 feet an arc length of 596.34 feet and a chord bearing and distance S 84°06'54" E 573.88 feet to an iron pin set  
 L189: S 56°43'24" E 350.26 feet to an iron pin set  
 C112: curve to the left having a radius of 428.34 feet an arc length of 566.92 feet and a chord bearing and distance N 85°21'36" E 526.44 feet to an iron pin set  
 L190: N 42°33'24" W 30.00 feet to an iron pin set  
 L191: N 47°26'36" E 229.00 feet to an iron pin set  
 L192: N 69°09'12" E 11.62 feet to an iron pin set  
 L193: S 48°33'14" E 25.84 feet to an iron pin set  
 L194: N 47°26'41" E 162.61 feet to a PK nail set  
 C113: curve to the left having a radius of 905.37 feet an arc length of 355.54 feet and a chord bearing and distance N 36°11'36" E 353.26 feet to an iron pin set  
  
 L195: N 24°56'36" E 704.23 feet to an un-monumented point  
 C114: curve to the right having a radius of 766.78 feet an arc length of 457.51 feet and a chord bearing and distance N 42°02'11" E 450.75 feet to an un-monumented point  
 L196: N 74°28'31" E 461.33 feet to an iron pin set  
 L197: N 71°37'46" E 159.43 feet to an iron pin set  
 C115: curve to the left having a radius of 905.37 feet an arc length of 290.75 feet and a chord bearing and distance N 61°19'06" E 289.50 feet to an iron pin set  
 L198: N 52°07'06" E 125.79 feet to an iron pin set  
 L199: N 55°29'36" E 50.00 feet to an iron pin set  
 L200: N 55°29'36" E 795.77 feet to an iron pin set  
 C116: curve to the right having a radius of 1,005.37 feet an arc length of 305.32 feet and a chord bearing and distance N 64°11'36" E 304.14 feet to an iron pin set  
 L201: N 88°18'47" E 793.31 feet to an iron pin set  
 L202: N 11°27'24" W 128.31 feet to an iron pin set  
 L203: N 89°26'36" E 61.58 feet to an iron pin set  
 C117: curve to the left having a radius of 349.06 feet an arc length of 416.38 feet and a chord bearing and distance N 55°16'14" E 392.13 feet to a PK nail set  
 L204: S 68°54'07" E 45.60 feet to an iron pin set  
 L205: N 00°39'57" E 247.56 feet to an iron pin set  
 L206: N 84°50'36" E 70.00 feet to an iron pin set  
 L207: N 05°09'24" W 825.00 feet to an iron pin set  
 L208: N 05°09'28" W 518.88 feet to an iron pin set  
 L209: N 05°09'18" W 446.12 feet to an iron pin set  
 L210: S 08°02'12" W 909.33 feet to an iron pin set  
 L211: N 68°39'46" W 82.53 feet to an iron pin set  
 L218: N 06°59'57" E 89.37 feet to an un-monumented point in a drain  
 L212: N 07°04'06" E 758.35 feet to an iron pin set  
 L213: N 07°04'09" E 413.19 feet to an iron pin set  
 L214: N 07°31'58" E 128.46 feet to an iron pin set  
 L215: N 81°10'16" E 66.80 feet to an iron pin set



STATE OF KENTUCKY
THOMAS E. NAIRN
3921
LICENSED PROFESSIONAL LAND SURVEYOR

L216: N 52°10'39" E 136.34 feet to a PK nail set in an asphalt road  
 L217: S 53°45'09" E 40.00 feet to an iron pin set  
 C118: curve to the left having a radius of 3,765.15 feet an arc length of 601.53 feet and a chord bearing and distance N 33°08'24" E 600.89 feet to an iron pin set  
 L219: N 19°50'50" E 156.36 feet to an iron pin set  
 L220: N 18°10'59" E 10.52 feet to an iron pin set  
 L221: N 19°59'14" E 125.00 feet to an iron pin set  
 L240: N 36°14'51" E 40.00 feet to an iron pin set  
 L222: N 36°14'51" E 300.00 feet to an iron pin set  
 L238: S 53°45'09" E 120.00 feet to an iron pin set  
 L232: S 36°14'51" W 300.00 feet to an iron pin set  
 L239: S 36°14'05" W 40.01 feet to an iron pin set  
 L233: S 53°45'09" E 100.00 feet to feet to the **BEGINNING** and containing 6,106,881.57 square feet or 140.19 acres.

In addition to the above described property referenced as Tract 1; there are three parcels of land included in this conveyance known as Parcel 3, Parcel 5 and Parcel 6 as indicated on Right of Way and Track Map V-32-E / 5 of The Chesapeake and Ohio Railway Company, Middle Creek Branch, dated February 1, 1942. Said parcels of land containing 79,829.43 square feet or 1.83 acres as calculated from said map and not computed by field survey.

TRACT 2: (Rte. 1210 Spur)

**BEGINNING** on an iron pin set on the southern right of way of the CSXT railroad, said iron pin having KY State Plane NAD83 south zone coordinates of north 2,119,224.95 and east 2,481,216.33; thence leaving the main line and with the right of way of the route 1210 spur track of the railroad:

L1: S 11°14'32" E 226.70 feet to an iron pin set  
 L2: S 01°06'41" E 413.04 feet to a PK nail set  
 L3: S 29°30'36" E 468.07 feet to an iron pin set  
 L4: S 29°30'36" E 731.20 feet to an iron pin set  
 C1: curve to the right having a radius of 746.78 feet an arc length of 933.00 feet and a chord bearing and distance S 06°16'54" W 873.49 feet to an unmonumented point  
 L5: S 42°04'24" W 96.51 feet to an unmonumented point  
 L6: S 42°04'24" W 377.50 feet to an unmonumented point  
 L7: S 20°16'19" W 215.41 feet to a PK nail set  
 L8: S 42°04'24" W 398.80 feet to an iron pin set  
 C2: curve to the left having a radius of 1,800.08 feet an arc length of 245.58 feet and a chord bearing and distance S 38°09'54" W 245.39 feet to an iron pin set  
 L9: S 34°15'24" W 740.64 feet to a PK nail set  
 L10: S 39°51'17" W 410.06 feet to an iron pin set  
 C3: curve to the left having a radius of 646.78 feet an arc length of 263.61 feet and a chord bearing and distance S 22°34'51" W 261.79 feet to an iron pin set

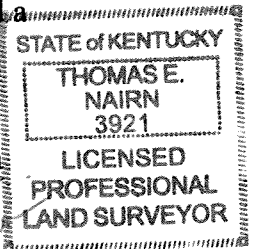

L11: S 16°01'46" E 139.17 feet to an iron pin set  
 L12: S 07°05'43" E 124.76 feet to an iron pin set  
 L13: S 04°50'01" W 204.95 feet to an iron pin set  
 L14: S 19°09'36" E 135.72 feet to an iron pin set  
 L15: N 69°00'25" E 85.04 feet to an iron pin set  
 L16: S 19°09'36" E 48.60 feet to an iron pin set  
 C4: curve to the left having a radius of 639.49 feet an arc length of 329.31 feet and a chord bearing and distance S 33°54'45" E 325.68 feet to an iron pin set  
 L17: S 30°50'04" E 196.97 feet to an iron pin set  
 C5: curve to the left having a radius of 724.49 feet an arc length of 53.04 feet and a chord bearing and distance S 65°45'45" E 53.03 feet to an iron pin set  
 L18: S 67°51'36" E 179.07 feet to an iron pin set  
 L19: S 21°56'11" W 74.99 feet to an iron pin set  
 L20: N 67°51'36" W 179.07 feet to an iron pin set  
 C6: curve to the left having a radius of 794.49 feet an arc length of 32.17 feet and a chord bearing and distance N 66°42'00" W 32.17 feet to an iron pin set  
 L21: N 72°31'42" W 107.11 feet to an unmonumented point  
 C7: curve to the right having a radius of 524.04 feet an arc length of 625.54 feet and a chord bearing and distance N 37°54'37" W 589.05 feet to an unmonumented point  
 L22: N 69°01'04" E 22.01 feet to an iron pin set  
 L23: N 19°09'36" W 38.28 feet to an iron pin set  
 L24: N 39°12'24" W 212.90 feet to an iron pin set  
 L25: N 17°45'25" W 28.61 feet to an iron pin set  
 C8: curve to the right having a radius of 816.78 feet an arc length of 542.63 feet and a chord bearing and distance N 01°16'32" E 532.71 feet to an iron pin set  
  
 L26: N 37°37'28" E 525.25 feet to an iron pin set  
 L27: N 34°15'24" E 700.00 feet to an unmonumented point  
 L28: N 39°58'03" E 100.50 feet to an iron pin set  
 L29: N 34°15'24" E 40.64 feet to an iron pin set  
 C9: curve to the right having a radius of 1940.08 feet an arc length of 264.68 feet and a chord bearing and distance N 38°09'54" E 264.47 feet to an iron pin set  
 L30: N 42°04'24" E 976.30 feet to an unmonumented point  
 L31: N 42°04'24" E 96.51 feet to an unmonumented point  
 C10: curve to the left having a radius of 686.78 feet an arc length of 858.04 feet and a chord bearing and distance N 06°16'54" E 803.31 feet to an iron pin set  
 L32: N 29°30'36" W 731.20 feet to an iron pin set  
 L33: N 29°30'36" W 468.07 feet to an iron pin set  
 L34: N 40°06'28" W 136.50 feet to an iron pin set  
 L35: N 12°56'42" W 157.65 feet to an iron pin set  
 C11: curve to the left having a radius of 754.97 feet an arc length of 430.91 feet and a chord bearing and distance N 16°51'24" E 425.08 feet to the **BEGINNING** and containing 792,642.62 square feet or 18.20 acres.

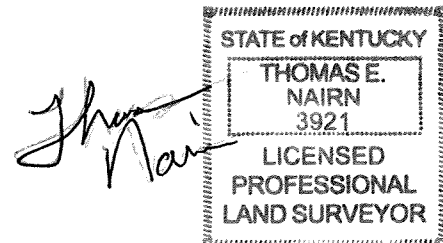



TRACT 3: (Rte. 850 Spur)

**BEGINNING** on an iron pin set on the southern right of way of the CSXT railroad, said iron pin having KY State Plane NAD83 south zone coordinates of north 2,115,683.12 and east 2,477,274.63; thence leaving the main line and with the right of way of the route 850 spur track of the railroad:

- L1: S 45°42'34" E 21.99 feet to an iron pin set next to a right of way monument found
- L2: S 44°43'34" W 190.62 feet to an iron pin set next to a right of way monument found
- C1: curve to the left having a radius of 422.84 feet an arc length of 281.42 feet and a chord bearing and distance S 24°27'38" W 276.26 feet to an iron pin set next to a right of way monument found
- L3: S 04°17'59" W 498.29 feet to an iron pin set
- L4: N 84°12'51" W 125.00 feet to an iron pin set
- L5: N 03°51'46" E 209.89 feet to an iron pin set
- C2: curve to the left having a radius of 363.76 feet an arc length of 261.88 feet and a chord bearing and distance N 11°15'48" W 256.26 feet to an iron pin set
- L6: S 81°30'13" W 179.37 feet to an unmonumented point in the creek
- L7: N 61°02'42" E 159.33 feet to an unmonumented point in the creek
- C3: curve to the left having a radius of 363.76 feet an arc length of 251.60 feet and a chord bearing and distance N 61°41'05" W 246.61 feet to an iron pin set
- L8: N 09°50'40" E 23.56 feet to a CSXT right-of-way monument found on the southern right of way of the mainline railroad; thence continuing with the mainline right of way
- L9: N 80°35'04" E 338.95 feet to an iron pin set
- C4: curve to the left having a radius of 645.43 feet an arc length of 397.01 feet and a chord bearing and distance N 62°39'10" E 390.78 feet to the **BEGINNING** and containing 162,260.08 square feet or 3.72 acres.

All iron pins set are 5/8 inch rebar, 18 inches long with a 2 inch aluminum cap stamped "Bocook Engineering PLS 3921", all PK nails set are 1.5 inches long and are magnetic and have a 2 inch diameter metal disk bearing PLS#3921. This description is based on a survey made by Thomas E. Nairn, PLS #3921 under his direct supervision, on September 18, 26, 28, 29, October 03, 04, 06, 09, 11, 12, 16, 20, 24, 26, 27, 30, 31, November 01, 02, 06, 07, 09, 13, 15, 28, December 11, 13, 14, 20, 21, 22, and 28, 2017 and January 08, 19, 22, 24, February 05, 12, 15, 21, 22, March 07, 19, April 04, 12 and 20, May 24, and 25, June 8, 12, 14, 15, and 18, 2018. This survey was done by the method of GPS observation having a precision of +/-0.05' + 100 PPM and by the method of random traverse and side shots having survey closures of 1:15,455 and 1:26,720 and was not adjusted and is an "Urban Survey", and a "Rural Survey" the accuracy and precision of said survey meets all the specifications of an "Urban Survey" and "Rural Survey". The completion date of field surveying was June 18, 2018.

Thomas E. Nairn PLS #3921  
Bocook Engineering Company, Inc.  
259 N. Arnold Ave.  
Prestonsburg, Ky. 41653  
Date: July 05, 2018  
Revised Date: April 1, 2020

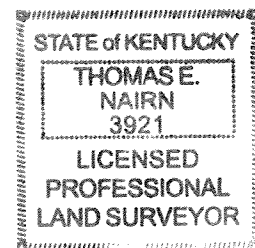

**OVERSIZE MAPS INCLUDED WITH  
SUBMISSION.**

To research the maps, contact the  
Office of Secretary of State  
or the County Clerk.