

RECEIVED

Amended by map filed Oct. 25, 1983

AUG 19 1983

CITY OF PROSPECT

SECRETARY OF STATE  
COMMONWEALTH OF KY.

Map and list of property owners of annexation of the City of Prospect, Kentucky, by Ordinance No. 103, Series 1983, a copy of which is attached hereto and incorporated herein by reference:

Map of annexed area attached;

Registered voters residing in annexed area: None;

Property owners of annexed area:

Name/Address	County Tax District	Block	Lot(s)
Warben, Inc. c/o Hermitage Farm Goshen, KY 40026 and 2800 Citizens Plaza Louisville, KY 40202	1	3	71,80

This information provided pursuant to KRS 81A.475.

Prepared by:

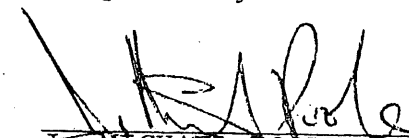
  
 J. MICHAEL POOLE, City Attorney  
 600 Starks Bldg.  
 Louisville, KY 40202  
 587-6838

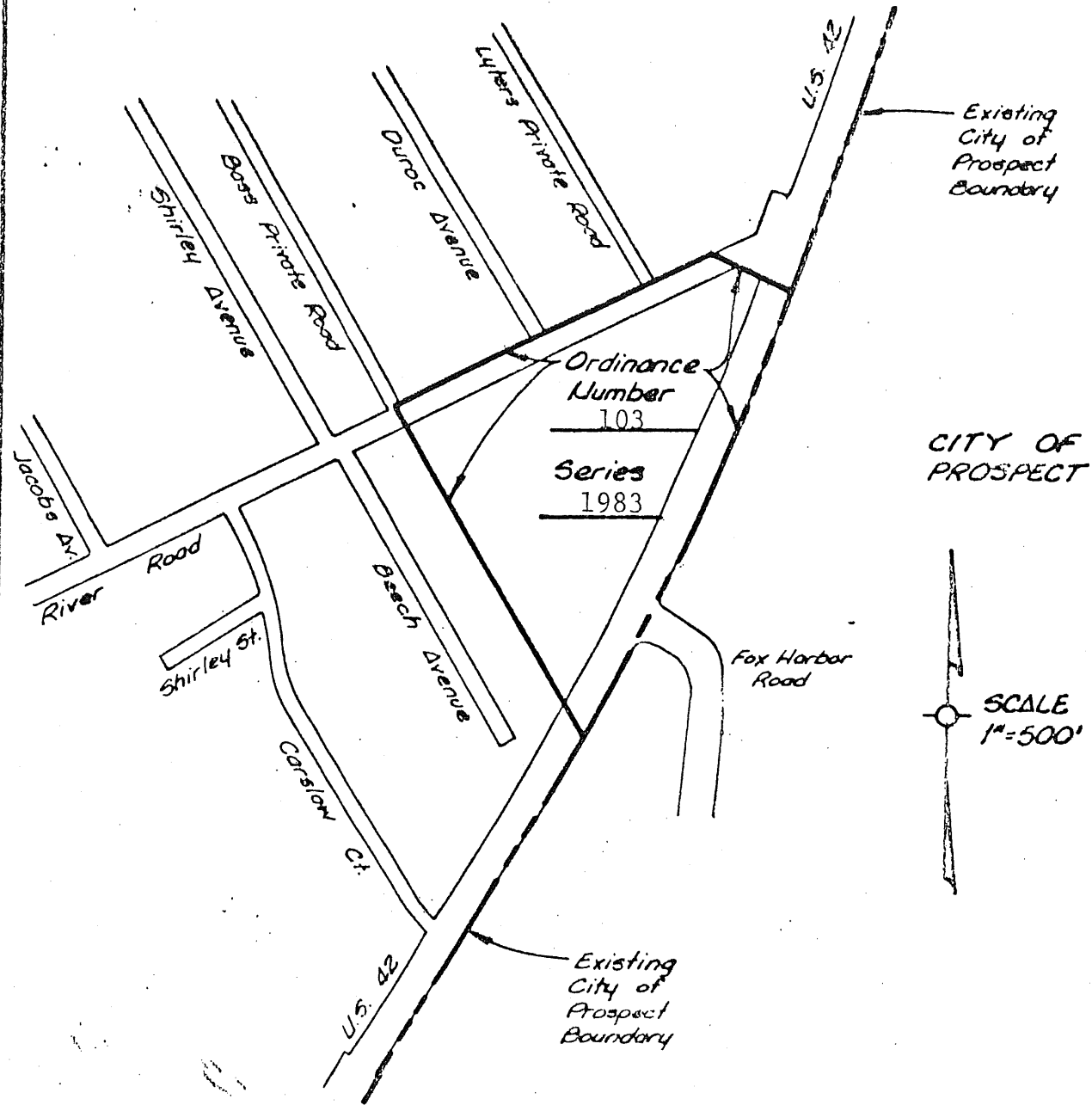

CITY OF PROSPECT, KY.  
ANNEXATION

Ordinance Number 103  
Series 1983

CITY OF PROSPECT

Ordinance No.103 , Series 1983

AN ORDINANCE ANNEXING TO THE CITY OF PROSPECT A CERTAIN TRACT OF LAND IN THE COUNTY OF JEFFERSON AND ADJOINING THE WESTERLY BOUNDARY OF THE EXISTING CITY FRONTING ON U.S. HIGHWAY 42, SAID AREA BEING MORE PARTICULARLY HEREINAFTER DESCRIBED.

WHEREAS, by Ordinance No. 101, Series 1982, the city proposed to annex the hereinafter described area, and,

WHEREAS, said ordinance and notice relating thereto was published in the Louisville Times as a legal notice on November 26, 1982, and February 12, 1983, and

WHEREAS, the last date for filing of any petition in opposition was February 19, 1983, and no petition or remonstrance was filed, now, therefore,

BE IT ORDAINED BY THE CITY OF PROSPECT:

Section 1. There is hereby annexed to the City of Prospect, Kentucky, and the boundary is hereby extended as to include within the boundaries of the City of Prospect, a certain tract of land which was formerly embraced with the county of Jefferson and which is adjacent to and contiguous with the present City boundary line and more particularly described as follows:

Beginning at a point in the East right-of-way line of U.S. Highway 42, said point being the intersection of said East right-of-way line and the extension of the South line of the tract conveyed to Warben, Inc., by Deed Book 3848, Page 76 of record in the Office of the Clerk of Jefferson County, said point also being in the existing boundary of the City of Prospect; thence leaving said East line of U.S. Highway 42 and following the extension of the South line of the Warben, Inc. tract, to a point in the center of U.S. Highway 42; thence with the South line of said tract North 34° 40' West 1009.58 feet to a point in the East line of River Road; thence with the East line of River Road North 62° 49' feet East 1085.4 feet more or less to the Northwest corner of the tract conveyed

by Deed Book 4865, Page 855 of record in the aforesaid Clerk's Office; thence with the North line of the aforesaid last mentioned tract South 71° 41' 50" East 98.1 feet to a point in the West line of U.S. Highway 42; thence continuing South 71° 41' 50" East with the extension of the North line of said tract to the point of intersection of said extension and the East right-of-way line of U.S. Highway 42; thence with the East line of U.S. Highway 42 and the existing City boundary in a Southerly direction 1300 feet more or less to the point of beginning.

Section 2. All ordinances heretofore duly adopted and in force in the present City of Prospect shall equally apply to the area described in this ordinance.

Section 3. Immediately upon the passage hereof, the City Clerk is authorized and directed to publish this ordinance pursuant to KRS Chapter 424 and said ordinance shall be in full force and effect from and after its enactment and publication.

FIRST READING held this 21st day of February, 1983.

PASSED, APPROVED AND ENACTED this 28th day of March, 1983.

VETOED:

APPROVED:

\_\_\_\_\_  
JOHN EVANS, MAYOR

  
\_\_\_\_\_  
JOHN EVANS, MAYOR

DATE: \_\_\_\_\_

DATE: March 28, 1983

ATTEST:

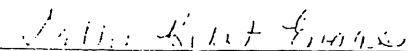
  
CITY CLERK