

CITY OF PROSPECT
P.O. Box 1
Prospect, Kentucky 40059

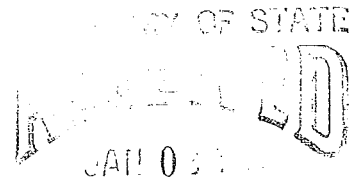

Commonwealth of Kentucky

December 27, 1985

Mr. Drex Davis
Secretary of State
Capitol Building
Frankfort, Kentucky 40601

Dear Mr. Davis:

On Saturday, December 28, 1985, the City of Prospect's annexation of four tracts surrounding the present City boundaries becomes effective. Enclosed please find the following:

1. A copy of Ordinance #143, Series 1985: An Ordinance Annexing to the City of Prospect Certain Tracts of Land Lying North and West of the Existing City Boundary Fronting on U.S. Highway 42 and on Harrods Creek, containing land descriptions of the areas annexed to the City.
2. Four (4) maps showing the location of the newly annexed areas.
3. A listing of property owners affected by the annexation.

If you require any additional information or have any questions, please don't hesitate to call Prospect City Hall (228-1121).

Sincerely,

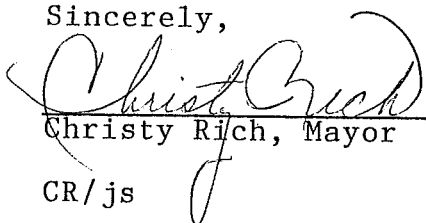
Christy Rich, Mayor

CR/js

Enclosures

Recd.
1/5/86

CITY OF PROSPECT

Ordinance no. 143, Series 1985

AN ORDINANCE ANNEXING TO THE CITY OF PROSPECT CERTAIN TRACTS OF LAND LYING NORTH AND WEST OF THE EXISTING CITY BOUNDARY FRONTING ON U.S. HIGHWAY 42 AND ON HARRODS CREEK.

WHEREAS, by Ordinance No. 124, Series 1984, the City proposed to annex the hereinafter described areas, and,

WHEREAS, said Ordinance and notice relating thereto was published in the Louisville Times as a legal notice on August 24, 1985, and October 12, 1985, and

WHEREAS, the last date for filing of any petition in opposition was October 23, 1985, and no petition or remonstrance was filed, now, therefore,

BE IT ORDAINED BY THE CITY OF PROSPECT:

Section I. There is hereby annexed to the City of Prospect, Kentucky, and the boundary is hereby extended as to include within the boundaries of the City of Prospect, certain tracts of land which was formerly embraced with the county of Jefferson and which is adjacent to and contiguous with the present City boundary line and more particularly described as follows:

(SEE ATTACHED DESCRIPTION)

TRACT 1

Beginning at a point in the existing boundary of the City of Prospect as established by Codified Ordinance 110.1P, Series 1982 said point also being the most Easterly corner of Tract #2 conveyed to the V. V. Cooke Foundation Corporation, by Deed Book 3748, Page 236 of Record in the Office of the Clerk of Jefferson County; said point also being in the Southerly line of Harrods Creek; thence Northwesterly with the Northeasterly line of said last mentioned tract 3,600 feet more or less to the Jefferson County-Oldham County line; thence leaving the existing boundary of the City of Prospect and with the aforesaid Jefferson County-Oldham County line in Southeasterly direction 4,750 feet more or less to the Southerly line of Harrods Creek; thence with the Southerly line of Harrods Creek in a Southwesterly direction 2,100 feet more or less to the Point of Beginning.

TRACT II

Beginning at a point in the Westerly line of U.S. Highway 42, said point being the point of intersection of said line of U.S. Highway 42 with an extension of the Northerly line of the Brownsboro Prospect Turnpike Road, also known as Covered Bridge Road, said point also being in the existing boundary of the City of Prospect as established by Codified Ordinance No. 110.1P series 1974; thence with the Westerly line of U.S. Highway 42 and the existing boundary of the City of Prospect in a Southerly direction 3750 feet more or less to the point of intersection of said line of U.S. Highway 42 with the Northerly line of the tract of Record in Deed Book 4865, Page 855 in the Office of the Clerk of Jefferson County; thence leaving the West line of U.S. Highway 42 and with the North line of the aforesaid tract North 71 degrees 41 minutes 50 seconds West 98.1 feet to a point in the East line of River Road; thence with said line of River Road in a Southwesterly direction 300 feet more or less to the point of intersection of said line of River Road with an extension of the Southwesterly line of the tract conveyed to Brown by Deed Book 2037, Page 509 of Record in the Office of the Clerk of Jefferson County, Kentucky; thence leaving said line of River Road and the existing boundary of the City of Prospect and with said extension of said line of Brown in a Northwesterly direction to a point in the Northwesterly line of River Road, said point also being the Southeasterly corner of the aforesaid Brown tract; thence with Brown North 37 degrees 30 minutes West 1834.96 feet; thence North 38 degrees 10 minutes West 793.94 feet; thence North 38 degrees 48 minutes West 1070.64 feet to a corner common to the tracts of Record in Deed Book 2037, Page 509 and Deed Book 1928, Page 202 in the aforesaid Clerk's Office; thence with the Southwest line of the tract of Record in Deed Book 1928, Page 202 North 38 degrees 48 minutes West 515 feet to a point, said point being a corner common to the tracts of Record in Deed Book 1928, Page 202 and Deed Book 1901, Page 285; thence with the Southwest line of the tract conveyed to George G. Brown by Deed Book 1901, Page 285 North 31 degrees 15 minutes West 902.55 feet to a stone; thence North 39 degrees 5 minutes West 1650 feet to the top of the bank of the Ohio River; thence North 78 degrees West 287.1 feet to the low water mark of said river; thence with the low water mark of the Ohio River in a Northerly direction 4750 feet more or less to the point of intersection of said low water mark with the Oldham County, Jefferson County line; thence leaving the low water line of the Ohio River and with the Oldham County-Jefferson County line in a Southeasterly direction 3300 feet more or less to a point in the West line of Rose Island Road; thence leaving the aforesaid county line and

with the West line of Rose Island Road in a Southerly, then Southeasterly, Southerly, Southeasterly, Northeasterly and Southeasterly direction to the point of intersection of said line of Rose Island Road with the Westerly line of U.S. Highway 42; thence with the Westerly line of U.S. Highway 42 in a Southerly direction 600 feet more or less to the Point of Beginning.

TRACT III

Beginning at a point in the existing boundary of the City of Prospect as established by Ordinance 105 Series 1982, said point also being the Southeasterly corner of Lot 28 of the Carslaw Addition of Record in Plat Book 4, Page 73 in the Office of the Clerk of Jefferson County, Kentucky; thence with a line of the aforesaid Carslaw Addition South 58 degrees 25 minutes West 278 feet to a point in the Northeast line of Carslaw Court; thence crossing Carslaw Court South 58 degrees 25 minutes West 40 feet to a point in the Southwest line of Carslaw Court; as shown in Plat and Subdivision Book 4, Page 73; thence with said line of Carslaw Court North 35 degrees 15 minutes West 140 feet; thence leaving Carslaw Court South 58 degrees 25 minutes West 278.0 feet; thence South 35 degrees 15 minutes East 140 feet to a point in the Northwest line of the tract conveyed to Blanche Pinnell by Deed Book 1724, Page 388 of Record in the aforesaid Clerk's Office; thence with the Northwest line of the Pinnell tract South 60 degrees 56 minutes 42 seconds West 667 feet more or less to a corner in said Pinnell tract; thence leaving said line of said Pinnell tract and the existing boundary of the City of Prospect and with the South line of the tract conveyed to Helm and Blair of Record in Deed Book 5463, Page 528 in the aforesaid Clerk's Office North 61 degrees 44 minutes 18 seconds West 796.00 feet to an iron pipe in the Southeast right-of-way line of Upper River Road; thence with Upper River Road North 23 degrees 32 minutes 04 seconds East 416.49 feet to a pipe; thence North 26 degrees 45 minutes 32 seconds East 111.94 feet to a pipe; thence North 26 degrees 08 minutes 55 seconds East 129.81 feet to a pipe; thence North 30 degrees 40 minutes 03 seconds East 73.52 feet to a pipe; thence North 36 degrees 54 minutes 35 seconds East 65.02 feet to a pipe; thence North 45 degrees 49 minutes 19 seconds East 86.59 feet to a pipe; thence North 55 degrees 19 minutes 13 seconds East 98.19 feet to a pipe; thence North 61 degrees 13 minutes 42 seconds East 206.04 feet to an iron pipe, said pipe being a corner common to the aforesaid Helm and Blair and to the aforesaid Carslaw addition of Record in Plat Book 4, Page 73 in the aforesaid Clerk's Office; thence with the Southwesterly line of the Carslaw Addition South 35 degrees 15 minutes East 799.61 feet to an iron pipe, said point being the Northwest corner of Lot 36 of the aforesaid Carslaw Addition of Record in Plat Book 4, Page 73 in the aforesaid Clerk's Office; thence with the line common to Lots 35 and 36 of said Carslaw Addition North 58 degrees 25 minutes East 280 feet more or less to a point in the Southwesterly right of way line of Carslaw Court, said point also being a corner common to Lots 35 and 36 of the aforesaid Carslaw Addition; thence with said line of

Carslaw Court South 35 degrees 15 minutes East 150 feet more or less to a point, said point being the point of intersection of the Southwesterly line of Carslaw Court with an extension of the Northerly line of the lot conveyed to Phillip Cochran by Deed Book 4616, Page 8 of Record in the aforesaid Clerk's Office; thence with said extension of said line North 62 degrees 10 minutes East to a point in the Northeasterly line of Carslaw Court; thence with the aforesaid line of Cochran North 62 degrees 10 minutes East 280 feet to a point, said point being a corner common to B.A. Crabtree and to Bruce White; thence with the Easterlymost lines of Lots 27 and 28 of the aforesaid Carslaw Addition South 35 degrees 15 minutes East 172.5 feet to the Point of Beginning.

TRACT IV

Beginning at a point in the existing boundary of the City of Prospect as established by Ordinance No. 105, Series 1982, said point also being the Northwesterlymost corner of the tract conveyed to The First Baptist Church of Prospect by Deed Book 2372, Page 299 of Record in the Office of the Clerk of Jefferson County, Kentucky; thence with the existing boundary of the City of Prospect, with said tract South 63 degrees 39 minutes 33 seconds East 731.59 feet to a point in the West line of U.S. Highway 42; thence with said line of U.S. Highway 42 in a Southwesterly direction to the point of intersection of said line with the extension of the North line of the tract conveyed to Warfels Marina and Boat Sales, Inc., of Record in Deed Book 4338, Page 555 in the aforesaid Clerk's Office; thence with said extension of said line in an Easterly direction to its point of intersection with the East line of U.S. Highway 42 said point being in the existing boundary of the City of Prospect as established by Ordinance No. 100, Series 1982; thence with the East line of U.S. Highway 42 and a curve to the left a chord of which is South 20 degrees 28 minutes 38 seconds West 195.13 feet; thence North 70 degrees 50 minutes 43 seconds West 20.00 feet; thence with a curve to the left a chord of which is South 18 degrees 41 minutes 40 seconds West 68.25 feet; thence with a curve to the left a chord of which is South 15 degrees 20 minutes 30 seconds West 422.89 feet; thence South 77 degrees 50 minutes 45 seconds East 50.00 feet; thence with a curve to the left a chord of which is South 10 degrees 46 minutes 27 seconds West 252.28 feet; thence South 9 degrees 03 minutes 57 seconds West 342.94 feet; thence South 80 degrees 56 minutes 23 seconds East 70.00 feet; thence South 9 degrees 03 minutes 57 seconds West 62.27 feet to the centerline of Harrods Creek; thence with the centerline of Harrods Creek and the existing boundary of the City of Prospect as established by Ordinance 100, Series 1982, South 89 degrees 59 minutes 38 seconds East 10.14 feet; thence South 56 degrees 29 minutes 38 seconds East 165.00 feet; thence South 35 degrees 59 minutes 38 seconds East 132.00 feet; thence South 17 degrees 44 minutes 38 seconds East 295.00 feet to the Southeast corner of the aforesaid tract of Record in Deed Book 4338, Page 555; thence continuing with the existing boundary of the City of Prospect as established by Codified Ordinance No. 110.2P, Series 1974 and with the Southerly line of Harrods Creek 2,900 feet more or less to the point of intersection of said line of Harrods Creek with the Easterlymost line of the tract conveyed to Dulworth Enterprises by Deed Book 4209, Page 338 of Record in the aforesaid Clerk's Office; thence leaving said line of

Harrods Creek and the existing boundary of the City of Prospect and with the lines of the tract conveyed to Dulworth Enterprises South 10 degrees 15 minutes 00 seconds West 1,235 feet more or less; thence due East 717.64 feet to a corner in the tract conveyed to William A. Gwillim by Deed Book 3323, Page 359; thence due South 791.40 feet to a point, said point being a corner to the tract conveyed to David H. Kannapell by Deed Book 2900, Page 389; thence North 89 degrees 17 minutes 20 seconds East 88.50 feet; thence South 3 degrees 57 minutes 40 seconds East 279.84 feet to the Southwest corner of the tract conveyed to Lillian B. Graves by Deed Book 4058, Page 406; thence North 80 degrees 34 minutes East 217.79 feet; thence South 49 degrees 14 minutes 27 seconds East 203.03 feet; thence South 36 degrees 17 minutes East 102 feet; thence North 53 degrees 43 minutes East 140 feet; thence South 21 degrees 15 minutes 30 seconds East 165 feet more or less to the point of intersection of the East line of the tract conveyed to Mary B. Ewing by Deed Book 761, Page 56 and the Northwesterly line of Wolf Pen Branch Road; thence with the Northwesterly line of Wolf Pen Branch Road 560 feet more or less to the point of intersection of said line of said road with the Northerly right-of-way line of the Jefferson Freeway; thence in a Westerly direction with the Northerly line of the Jefferson Freeway to the point of intersection of said line with an extension of the Westerlymost line of the existing boundary of the City of Green Spring; thence leaving the Northerly line of Jefferson Freeway and with said extension of the Westerly-most boundary of the City of Green Spring in a Southerly direction to the Northwesterlymost corner of the City of Green Spring; thence with the Westerly line of the existing boundary of the City of Green Spring in a Southerly direction to the point of intersection of the Westerlymost boundary of the City of Green Spring with the extension of the South line of Springdale Road; thence leaving the existing boundary of the City of Green Spring and following a Northwesterly course to the point of intersection of the South line of Wolf Pen Branch Road and the West line of Barbour Lane; thence with the South line of Wolf Pen Branch Road 1,700 feet more or less in a Westerly direction to the point of intersection of the South line of Wolf Pen Branch Road with the East line of U.S. Highway 42; thence continuing in a Westerly direction, crossing U.S. Highway 42 to the point of intersection of the South line of Wolf Pen Branch Road and the West line of U.S. Highway 42; thence with the Westerly line of U.S. Highway 42 in a Northerly direction 6100 feet more or less to the Southeast corner of the tract conveyed to the Fire Department by Deed Book 4903, Page 35 of Record in the aforesaid Clerk's Office; thence leaving U.S. Highway 42 and with the South line of the aforesaid tract North 65 degrees 35 minutes West 450 feet to the Southeast corner of tract #1 of Record in Deed Book

4481, Page 411 in the aforesaid Clerk's Office; thence North 65 degrees 35 minutes West 200 feet to the Southeast corner of the tract conveyed to Lentz by Deed Book 3430, Page 498 of Record in the aforesaid Clerk's Office; thence North 16 degrees 53 minutes East 247.60 feet; thence with the Northerly line of Lentz North 66 degrees 45 minutes West 172.57 feet to the Northwestern corner of Lentz; thence leaving Lentz, North 24 degrees 53 minutes East 250 feet more or less to the Southwest corner of the tract conveyed by Deed Book 2372, Page 299 of Record in the aforesaid Clerk's Office; thence with the Northwestern line of said tract North 25 degrees 44 minutes 30 seconds East 200.06 feet to the Point of Beginning.

Section II. All Ordinances heretofore duly adopted and in force in the present City of Prospect shall equally apply to the area described in this Ordinance.

Section III. Immediately upon the passage hereof, the City Clerk is authorized and directed to publish this Ordinance pursuant to KRS Chapter 424 and said Ordinance shall be in full force and effect from and after its enactment and publication.

FIRST READING held this 26 day of November, 1985.

PASSED AND APPROVED this 16 day of December, 1985.

VETOED:

APPROVED:

CHRISTINE RICH, Mayor

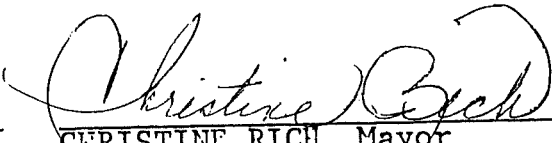

CHRISTINE RICH, Mayor

DATE: _____

DATE: December 16, 1985

ATTEST:



CITY CLERK

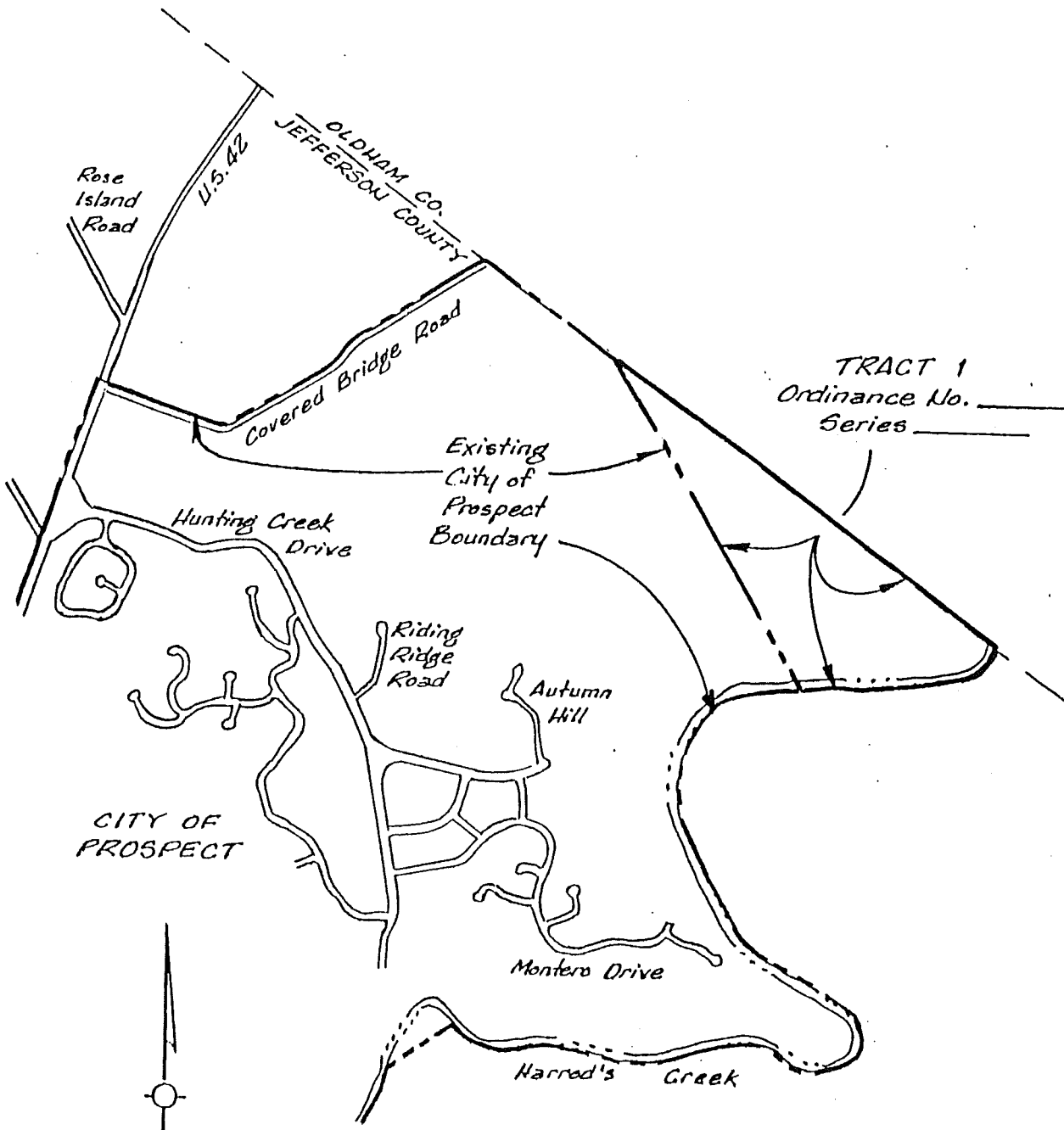

CITY OF PROSPECT

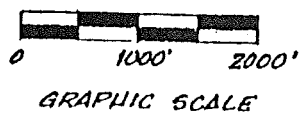
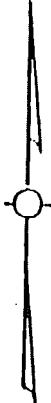

CITY OF PROSPECT, KY
ANNEXATION

Ordinance Number 143
Series 1985

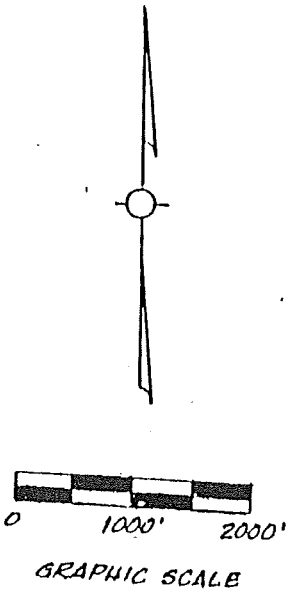
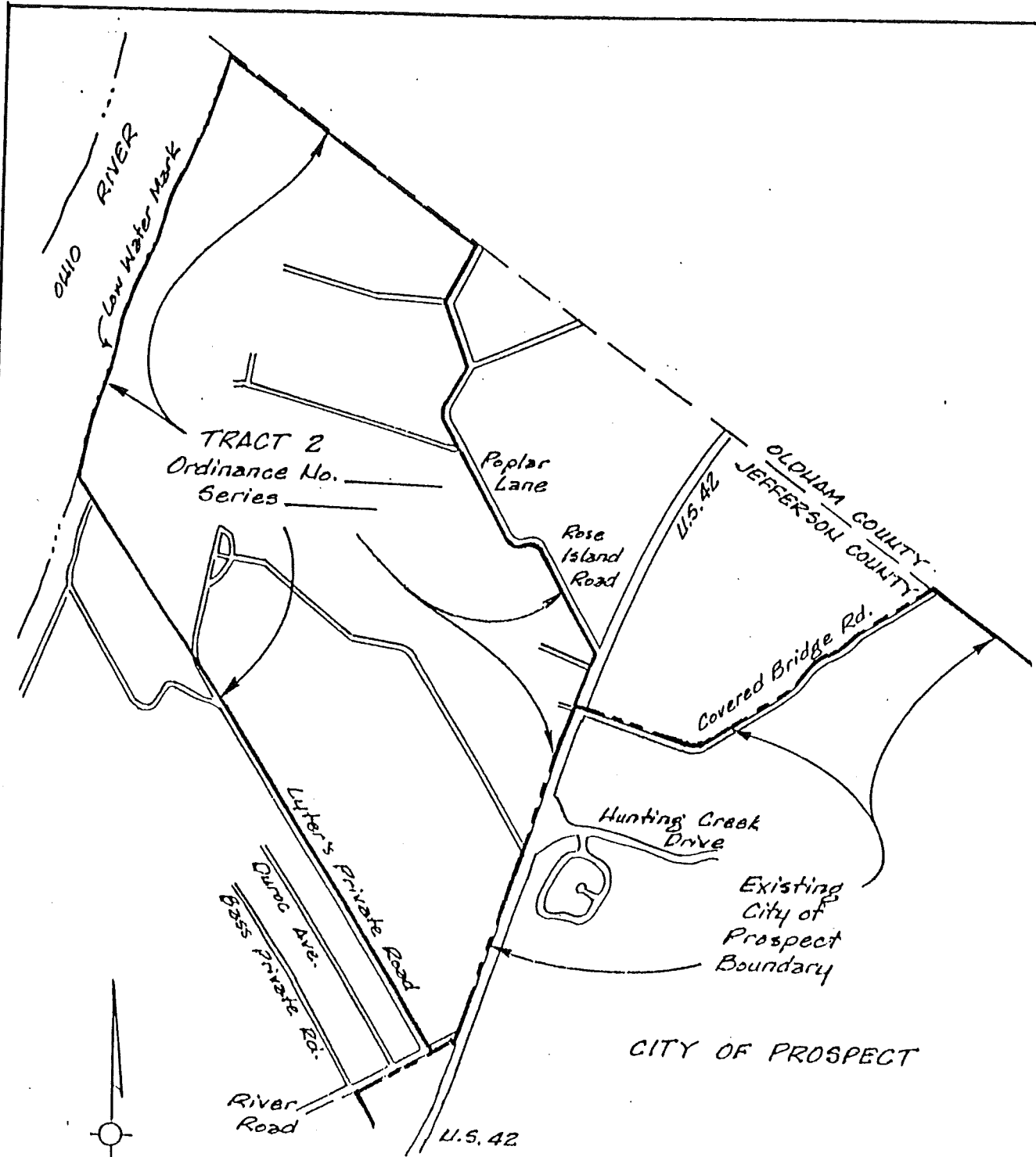

**CITY OF
PROSPECT, KY
ANNEXATION**

Ordinance Number 143
Series 1985

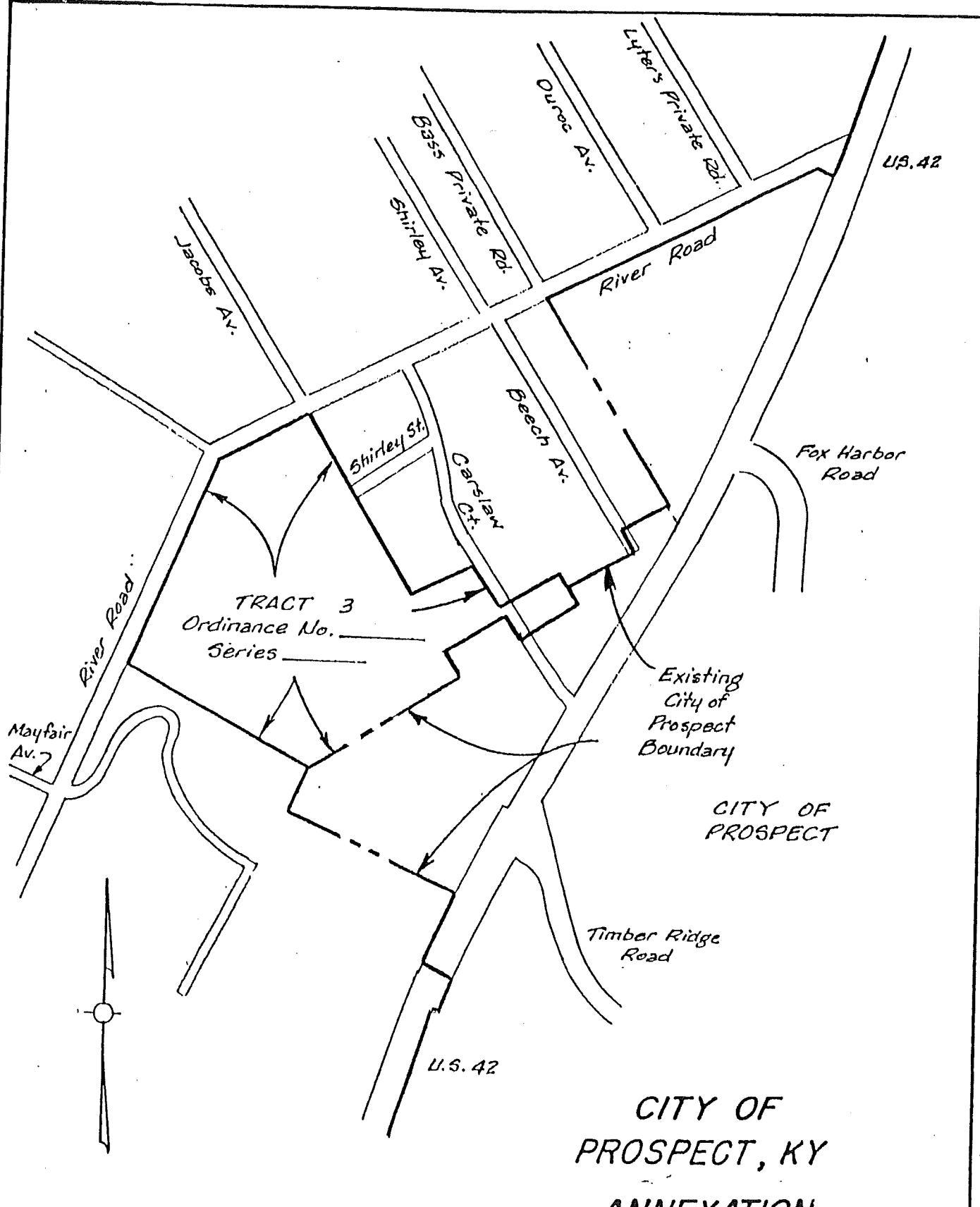

TRACT 3
Ordinance No.
Series

Existing
City of
Prospect
Boundary

CITY OF
PROSPECT

CITY OF
PROSPECT, KY
ANNEXATION

Ordinance Number 143

Series 1985

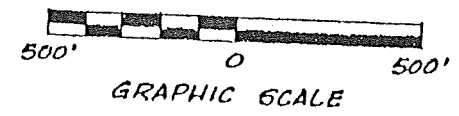
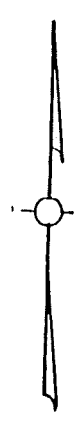

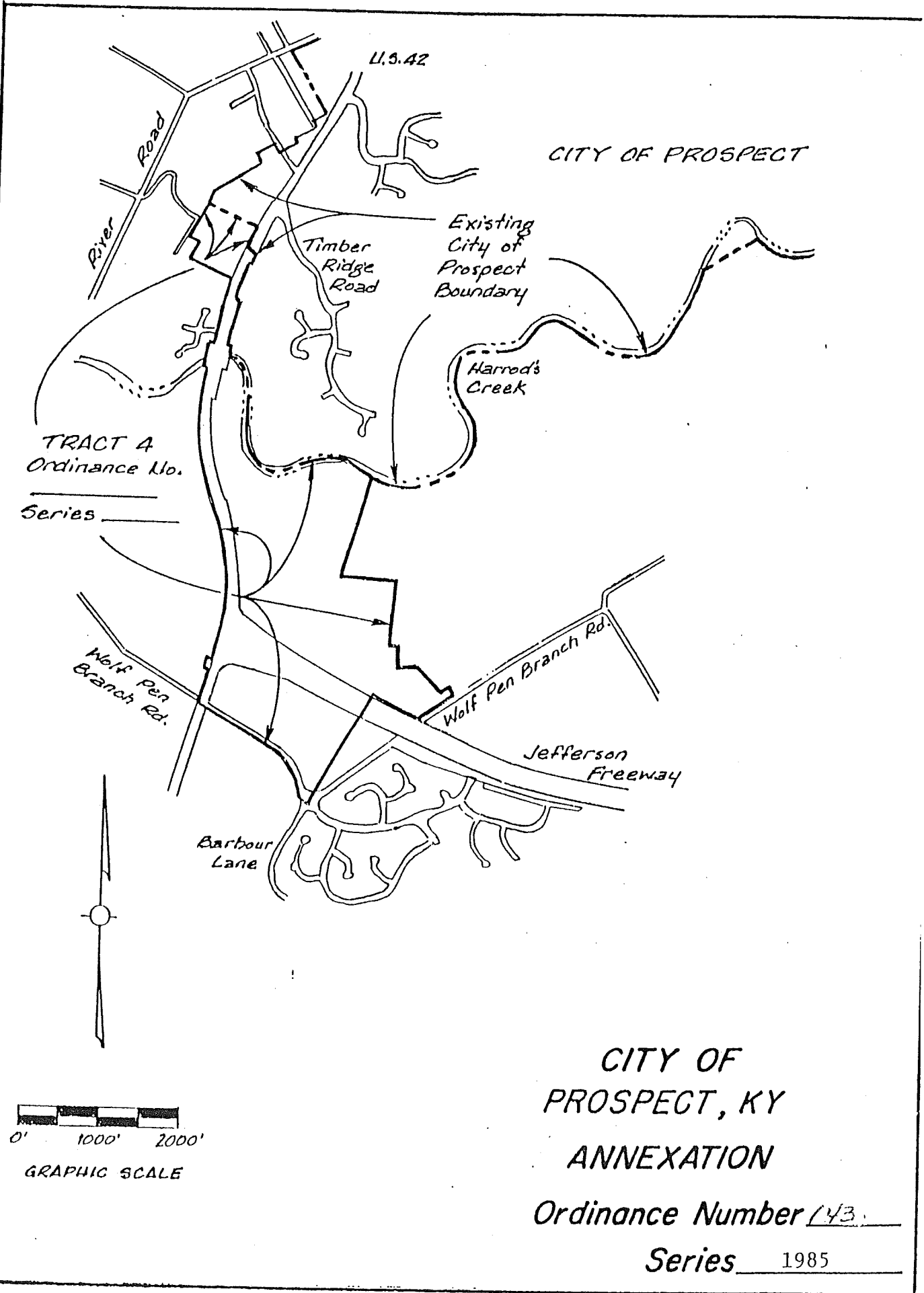

CITY OF PROSPECT

U.S. 42

River Road

Timber Ridge Road

Existing City of Prospect Boundary

Harrod's Creek

TRACT 4
Ordinance No. _____
Series _____

Wolf Pen Branch Rd.

Wolf Pen Branch Rd.

Jefferson Freeway

Barbour Lane

CITY OF
PROSPECT, KY
ANNEXATION

Ordinance Number 143

Series 1985

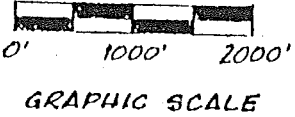

CITY OF PROSPECT

Maps and list of property owners of annexation of the City of Prospect, Kentucky, by Ordinance No. 143, Series 1985, a copy of which is attached hereto and incorporated herein by reference: Maps of annexed area attached; This information provided pursuant to KRS 81A.475 and KRS 81A.470; together with list of registered voters.

| <u>NAME/ADDRESS</u> | <u>COUNTY TAX DISTRICT</u> | <u>BLOCK</u> | <u>LOT(S)</u> |
|---|----------------------------|--------------|---------------|
| Sutcliffe, G.E. & Joan M. c/o First Kentucky Trust Co. Personal Investments P.O. Box 36010 Louisville, KY 40233 | 1 | 1 | 1 |
| Wallace, Henry F. & Sonja P.O. Box 68 Prospect, KY 40059 | 1 | 1 | 7 |
| Stone, James C., Jr. 331 Lincoln Federal Building Louisville, KY 40202 | 1 | 1 | 9 |
| Brown, George Garvin Sutherland Prospect, KY 40059 | 1 | 2 | 2 |
| Stone, James C., Jr. 331 Lincoln Federal Building Louisville, KY 40202 | 1 | 2 | 1 |
| Brown, George Garvin 1908 Howard Street Louisville, KY 40210 | 1 | 2 | 4 |
| Helm & Blair Management Inc. P.O. Box 43237 Louisville, KY 40204 | 1 | 2 | 30 |
| Stone, James C., Jr. 331 Lincoln Federal Building Louisville, KY 40202 | 1 | 3 | 12 |
| Brown, George Garvin 1908 Howard Street Louisville, KY 40210 | 1 | 3 | 24 |
| Brown, George Garvin & Gertrude 1908 Howard Street Louisville, KY 40210 | 1 | 3 | 25 |

CONTINUED ON NEXT PAGE

| <u>NAME/ADDRESS</u> | <u>COUNTY TAX DISTRICT</u> | <u>BLOCK</u> | <u>LOT(S)</u> |
|---|----------------------------|--------------|---------------|
| Albrecht, J. Jodok c/o Lindon Hill Equestrian Center Prospect, KY 40059 | 1 | 3 | 53 |
| Stone, James C., Jr. 331 Lincoln Federal Building Louisville, KY 40202 | 1 | 3 | 56 |
| Stone, James C., Jr. 331 Lincoln Federal Building Louisville, KY 40202 | 1 | 3 | 70 |
| Hill, Barret S. 14 Rio Vista Circle Louisville, KY 40207 | 1 | 6 | 32 |
| Ewing, James W. Ewing, J.H. & Elizabeth A. c/o Elizabeth A. Ewing 6906 Wolf Pen Branch Road Prospect, KY 40059 | 1 | 6 | 33 |
| Hill, Barret S. 14 Rio Vista Circle Louisville, KY 40207 | 1 | 6 | 77 |
| Dulworth Developers Inc. 7304 Arnoldtown Road Louisville, KY 40214 | 1 | 6 | 116 |
| Fries, Bernard P. & Mary 1242 Milton Avenue Louisville, KY 40217 | 1 | 6 | 136 |
| Dulworth Developers Inc. 7304 Arnoldtown Road Louisville, KY 40214 | 1 | 6 | 141 |
| Dulworth Developers Inc. 7304 Arnoldtown Road Louisville, KY 40214 | 1 | 6 | 142 |
| Dulworth Developers Inc. 7304 Arnoldtown Road Louisville, KY 40214 | 1 | 6 | 143 |
| Driesbach, Carl & Johnson, Thomas L. 812 Lyndon Lane Louisville, KY 40222 | 1 | 6 | 154 |
| Ewing, James, W. Ewing, J.H. & Elizabeth A. c/o Elizabeth A. Ewing 6906 Wolf Pen Branch Road Prospect, KY 40059 | 1 | 6 | 111 |

| <u>NAME/ADDRESS</u> | <u>COUNTY TAX DISTRICT</u> | <u>BLOCK</u> | <u>LOT(S)</u> |
|---|----------------------------|--------------|---------------|
| Prospect Place II P.O. Box 7542 Louisville, KY 40207 | 1 | 202 | 23 |
| Prospect Place II P.O. Box 7542 Louisville, KY 40207 | 1 | 202 | 24 |
| Schroer, Dorothy B. 5217 Chamberlin Lane Prospect, KY 40059 | 1 | 202 | 30 |
| Schroer, David D. P.O. Box 246 Prospect, KY 40059 | 1 | 202 | 31 |
| Prospect Place II P.O. Box 7542, Louisville, KY 40207 | 1 | 202 | 55 |
| Schroer, David 6914 Carslaw Court Prospect, KY 40059 | 1 | 202 | 58 |
| Trustees, First Baptist Church of Prospect 8911 U.S. Highway 42 Prospect, KY 40059 | 1 | 3 | 94 |
| Harrods Creek Fire Protection District 8905 U.S. Highway 42 Prospect, KY 40059 | 1 | 206 | 28 |
| Louisville Gas & Electric Co. P.O. Box 32000 Louisville, KY 40232 | 1 | 206 | 39 |
| Clifford P. & Doris Hopkins 8907 U.S. Highway 42 Prospect, KY 40059 | 1 | 206 | 25 |
| Charles A. & Alma Miller 8909 U.S. Highway 42 Prospect, KY 40059 | 1 | 206 | 26 |
| Alma H. Miller 8909 U.S. Highway 42 Prospect, KY 40059 | 1 | 206 | 43 |