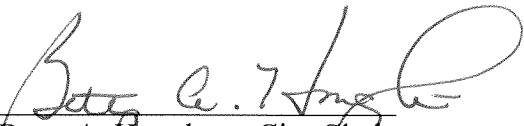

**CERTIFICATE OF CITY CLERK**

I, Betty A. Houghton, hereby certify that I am duly qualified and acting City Clerk of the City of Richmond, Kentucky, and that Ordinance 97-42 is a true and correct copy of this ordinance and was approved and adopted August 19, 1997 at a duly held City Commission meeting in accordance with all applicable requirements of Kentucky law, including KRS 61.810, 61.815, 61.820 and 61.825, that a quorum was present for this meeting and that said ordinance has not been modified, amended, revoked, or repealed and that same is now in full force and effect.

**IN TESTIMONY WHEREOF**, witness my signature as City Clerk and the official Seal of said City this the October 27, 2009.

  
Betty A. Houghton, City Clerk

(Seal of City)

RECEIVED AND FILED  
DATE October 30, 2009  
\_\_\_\_\_  
TREY GRAYSON  
SECRETARY OF STATE  
COMMONWEALTH OF KENTUCKY  
BY Handwritten Signature

ORDINANCE NO. 97-42

**AN ORDINANCE OF THE CITY OF RICHMOND, KENTUCKY, ANNEXING APPROXIMATELY 0.78 ACRES OF LAND ADJACENT TO THE CITY LIMITS.**

**WHEREAS**, the owner of record of the unincorporated territory described below would like to have annexed to the incorporated area of the City of Richmond, Kentucky, approximately 0.78 acres of land adjacent to the City Limits and,

**WHEREAS**, Fred and Susan Brammell the sole owner/owners of the land being proposed for annexation have by letter dated October 24, 1996, applied for voluntary annexation and requested their property be zoned B-3.

**WHEREAS**, it is the intent of the Richmond City Board of Commissioners to annex this land described below as per annexation procedures established by Ordinance Number 96-17, adopted February 20, 1996.

A certain tract of land situated on the south side of Kentucky Highway #52 on the north side of Old Kentucky Highway #52, approximately one mile East of the City of Richmond, Kentucky, in Madison County, Kentucky, bounded and described by survey as follows:

Beginning at an iron pin in the south right of way line of new Kentucky Highway #52, said pin being 50.00 feet south of center line station 61.00, thence with said right of way line N 88 degrees 29' E 279.20 feet to an iron pin and corner to L. Victor Welsh, thence leaving the right of way and with the line of Welsh S 21 degrees 16' W 206.40 feet to a point in the center of Old Kentucky #52, a corner, thence with the centerline of old Kentucky Highway #52 N 60 degrees 00' W 112.70 feet to a point at the east end of a bridge, a corner, thence leaving the highway with the new right of way N 20 degrees 43' E 40.00 feet to an iron pin and corner, thence continuing with the right of way N 61 degrees 17' W 143.45 feet, N 1 degree 35' E 25.00 feet to the beginning, containing 0.78 acres.

**WHEREAS**, the proposed annexation meets the requirement of KRS 81A.410, and the owner of record of such land has consented in writing to the annexation pursuant to KRS 81A.412, and

**WHEREAS**, it is declared pursuant to KRS 81A.420 that it is desirable to annex this unincorporated territory and the Richmond Planning and Zoning Commission should conducted a Public Hearing pursuant to KRS 100.209 for its recommendation

as to zone classifications and any zoning map amendments.

NOW, THEREFORE BE IT ORDAINED by the Board of Commissioners of the City of Richmond that:

**SECTION I**

The unincorporated territory described above being adjacent and contiguous to the corporate limits of the City of Richmond, Kentucky, is hereby annexed to the boundaries of the City of Richmond.

**SECTION II**

The Richmond Planning and Zoning Commission conducted a Public Hearing pursuant to KRS. 100.209 on July 23, 1997, and recommended that the zoning classifications of subject property be B-3.

**SECTION III**

The City Clerk cause this Ordinance to be published in accordance with the appropriate Kentucky Revised Statutes.

DATE OF FIRST READING: August 5, 1997

MOTION BY: Commissioner Robbins

SECONDED BY: Commissioner Tobler

VOTE:	YES	NO
Commissioner Hacker	x	
Commissioner Jones	x	
Commissioner Robbins	x	
Commissioner Tobler	x	
Mayor Durham	x	

DATE OF SECOND READING: August 19, 1997 31

MOTION BY: Commissioner Hacker

SECONDED BY: Commissioner Jones

VOTE:	YES	NO
Commissioner Hacker	x	
Commissioner Jones	x	
Commissioner Robbins	x	
Commissioner Tobler	x	
Mayor Durham	x	

*Ann A. Quirk*  
Mayor

Attest:

*Betty Anglem*  
City Clerk

← To Richmond

KY HWY 52

To Irvine →

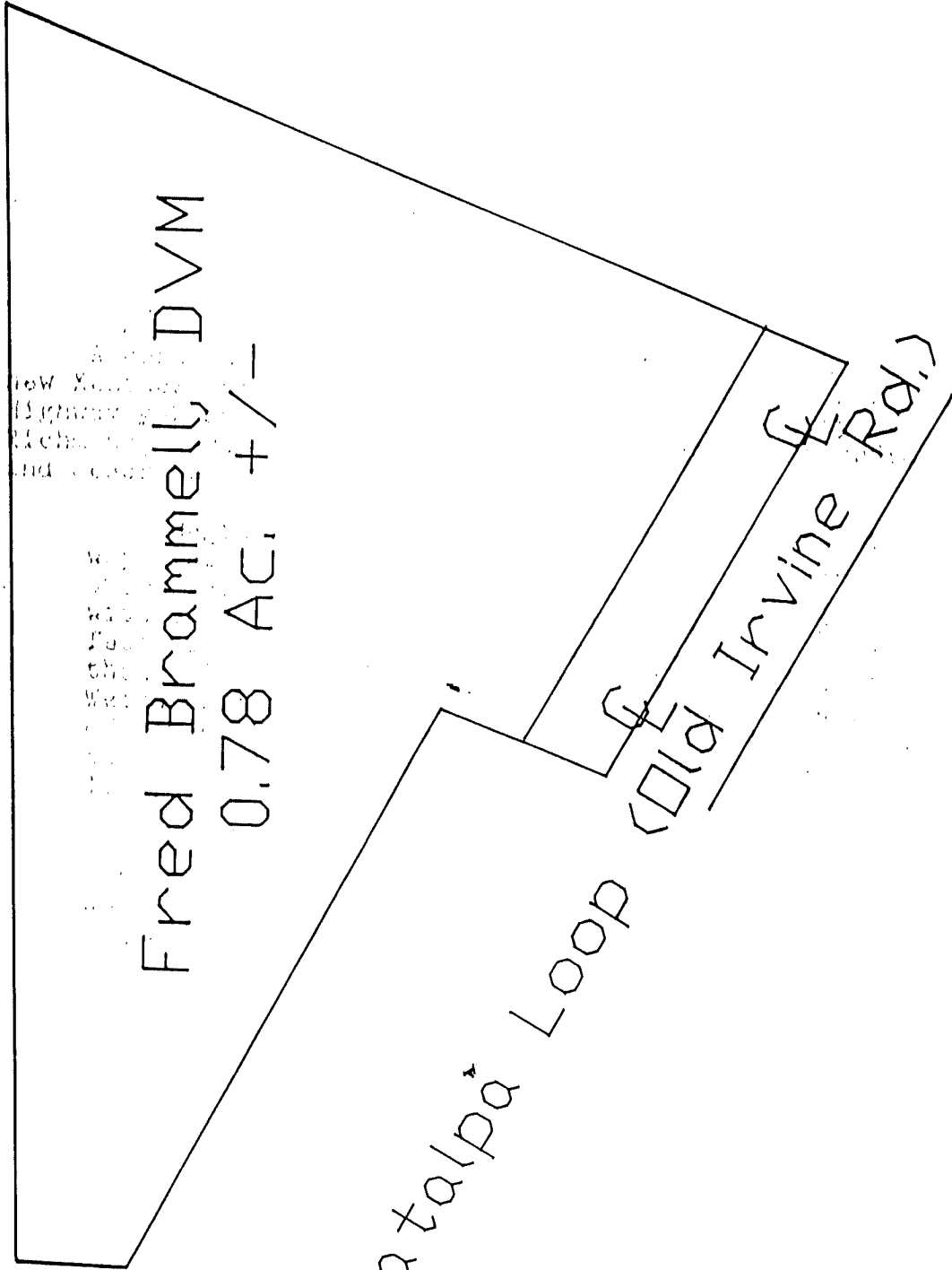

Fred Brammell, DVM  
0.78 AC, +/-

Catalpa Loop (Old Irvine Rd.)



Annexation drawing from deed;  
this is not a survey

Drawn by CMW Engineers, Inc.  
136 Big Hill Avenue  
Richmond, KY 40475  
Dwg No. 976-A2