

RECEIVE

FEB 7 2001

SECRETARY OF
COMMONWEALTH (502) 895-9444
(502) 895-0510

CITY OF ST. MATTHEWS

3940 Grandview Avenue
P. O. Box 7097
St. Matthews, Kentucky 40207

Arthur K. Draut, Mayor

Martha Schade
Bernard Bowling, Jr.
Richard Tonini
Mary Jo Nay

Toony Weiter
Gary Vincent
Kevin Eddins
Michael Cook

February 5, 2001

Secretary of State:

Enclosed are maps for the City of Broadfields and the City of
Plymouth Village.

I am still working on getting maps for Fairmeade, Cherrywood
Village, and Springlee. Will forward as soon as I get them.

Sincerely;

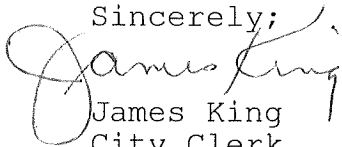

James King
City Clerk
City of St. Matthews
(502) 899-2516



MSD SERVICE REQUESTS FROM 04/01/00 TO 09/30/00

CATEGORY	REQ'D	CLOSED	OPEN
BILLING	0	0	0
DRAINAGE	0	0	0
SEWER	0	0	0
MISCELLANEOUS	1	1	0
TOTALS	1	1	0

CITY OF BROADFIELDS



BROADFIELDS
MSD NEIGHBORHOODS

Date: 07/09/00
Scale: 1" = 100'

Copyright © 2000, LINCOLN AND STEPHENSON
and LINCOLN WATER COMPANY (LWC) - 11/00
All Rights Reserved.

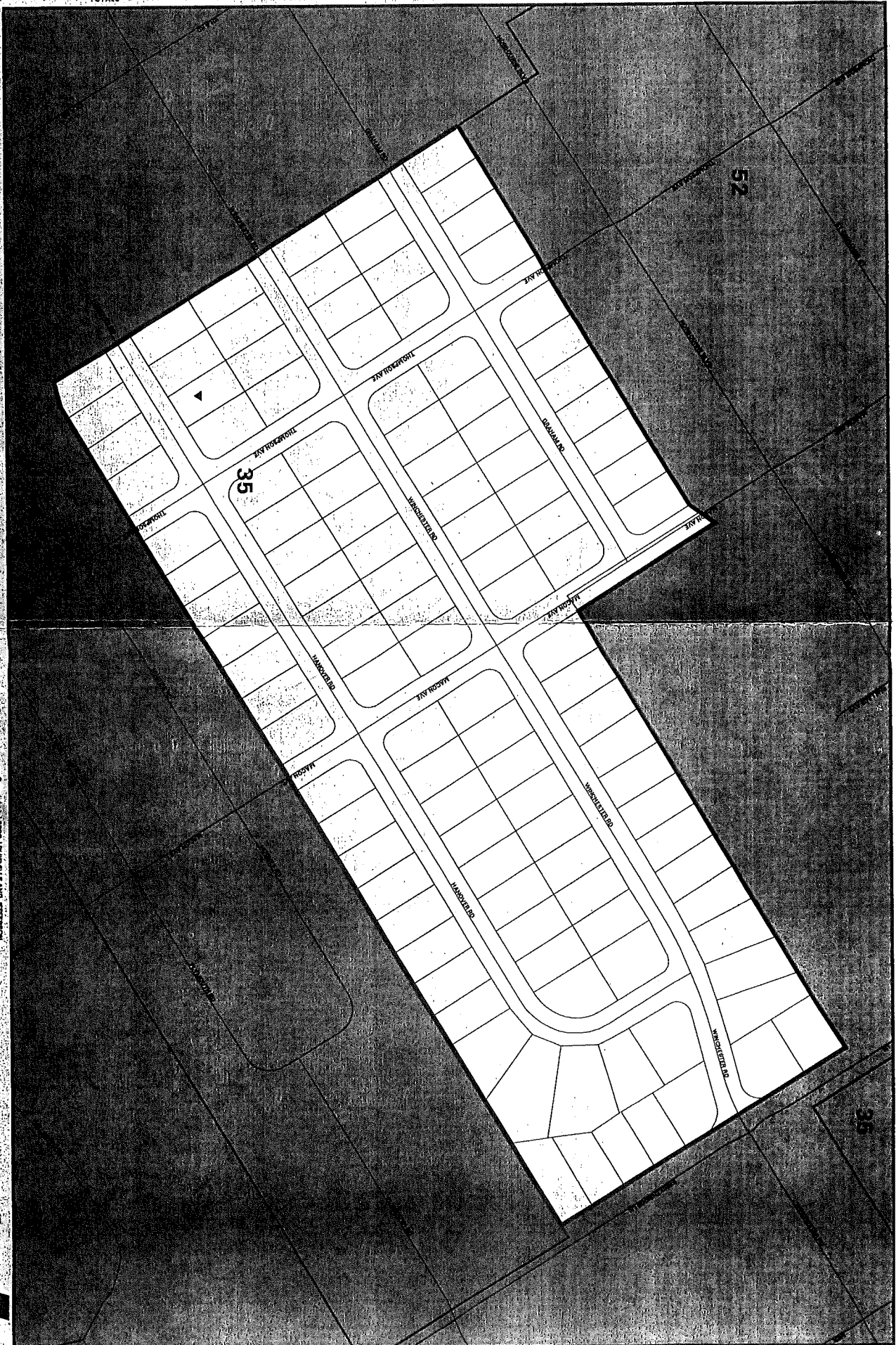



MSD SERVICE REQUESTS FROM: 04/01/00 TO: 06/30/00

CATEGORY	REQVD	CLOSED	OPEN
▲ BILLING	0	0	0
● DRAINAGE	0	0	0
◆ SEWERS	0	0	0
▼ MISCELLANEOUS	1	0	1
TOTALS	1	0	1

CITY OF PLYMOUTH VILLAGE



PLYMOUTH VILLAGE
MSD NEIGHBORHOODS

Date: 07/31/00
Scale: 1" = 100'

Copyright © 2000, LOUISVILLE AND JEFFERSON
COUNTY METROPOLITAN SEWER DISTRICT (MSD)
All Rights Reserved

