



Kentuckiana Regional Planning and Development Agency

914 EAST BROADWAY
LOUISVILLE, KENTUCKY 40204

PHONE
(502) 589-4406

June 26, 1981

RECEIVED

JUN 30 1981

SECRETARY OF STATE
COMMONWEALTH OF KY.

Ms. Libby Horn
Land Office
Office of the Secretary of State
Capitol Building
Frankfort, Kentucky 40601

Dear Ms. Horn:

On behalf of the City of Smithfield, I submit the attached boundary map in compliance with KRS 81.045.

Smithfield is a 6th class city which was incorporated in 1913.

Sincerely,

Sue Duvall
Public Administration Sepcialist

SD/ljt

Attachments

cc: Hon. Henry Belwood, Mayor
File

Henry County
Inc. March 21, 1870



CITY LIMITS

CEMETERY

CITY LIMITS

KY.

HWY.

322

CITY

KY.

CITY

LIMITS

40'

60'

35'

35'

27'

40'

27'

PLANNED DEVELOPMENT
PLANNING DEPARTMENT

APPROVED
MAY 15 1997

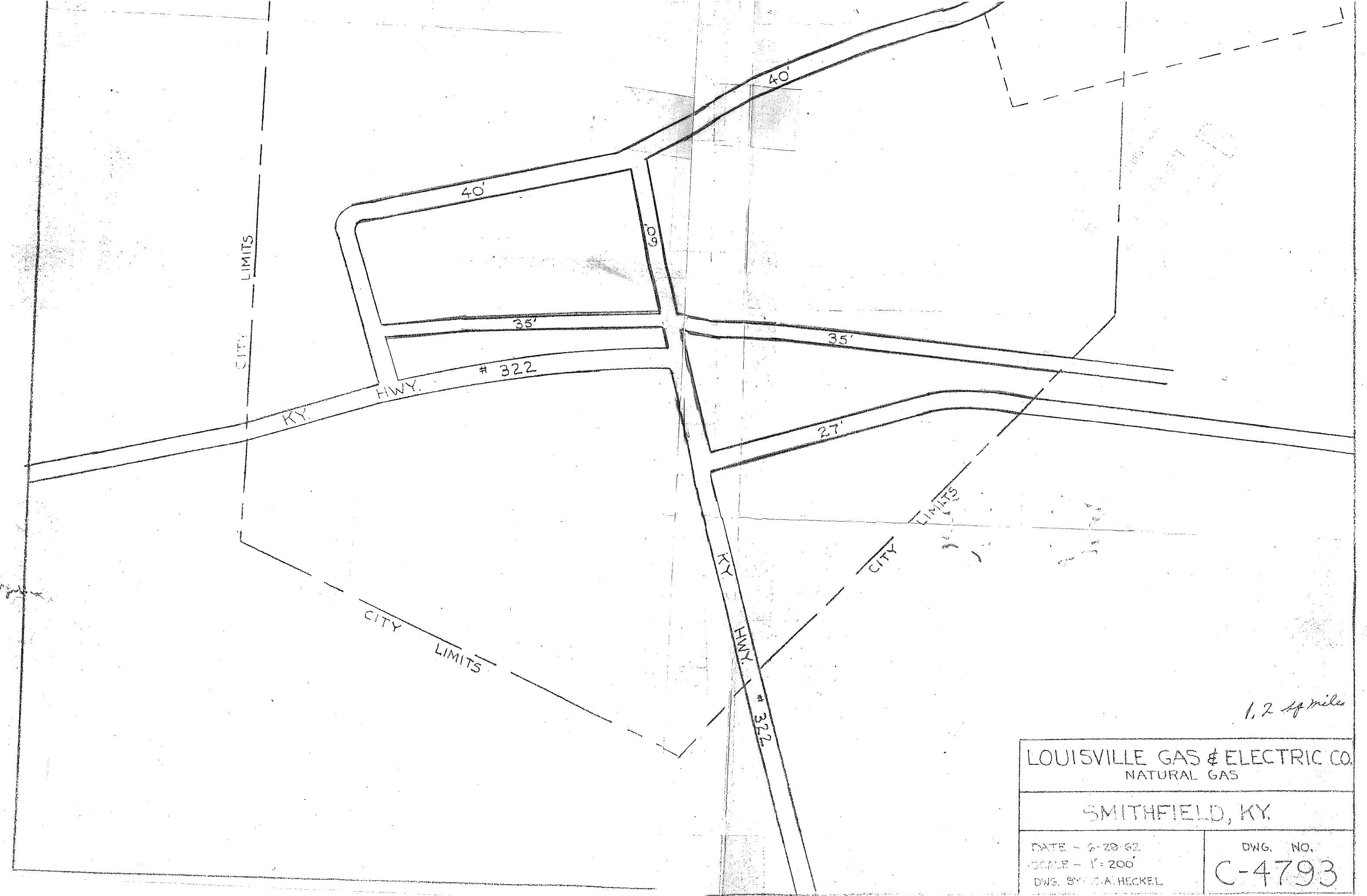

LOUISVILLE GAS & ELECTRIC CO.
NATURAL GAS

SMITHFIELD, KY.

DATE - 6-29-62
SCALE - 1" = 200'
DWG. BY - C.A. HECKEL

DWG. NO.
C-4793