

northern kentucky area development district
7505 sussex drive
florence, kentucky 41042
606-283-1885

gene archbold, executive director



SECRETARY OF STATE
SECRETARY OF STATE
RECEIVED

AUG 13 1981

July 27, 1981

COMMONWEALTH OF KENTUCKY
COMMONWEALTH OF KENTUCKY

Mayor Danny Bond
Spart-Owenton Road
Sparta, Ky. 41085

Dear Mayor Bond,

This letter is to inform you that as of today the secretary of state's office in Frankfort has still not received your city's incorporation papers. This is a very serious matter. Your city is now cut off from receiving state funds, such as municipal road aid funds, until those papers are filed. Since the papers were due on July 13, it is likely that your city will miss at least one month's payment. In order to begin receiving state funds, the following information is needed:

1. Name of the city; *SPARTA, Ky.*
2. Date of incorporation; *JAN. 3, 1852*
3. Present classification; and *CLASS 6*
4. Present boundaries. A map or plat of the boundaries of the city will satisfy the requirement for a description of the present boundaries. A description of the metes and bounds is not necessary.

This information should be mailed as soon as possible to:

Secretary of State's Office
Room 152
New Capitol Building
Frankfort, Ky. 40601

*Gallatin County
&
Owen County*

Mayor Danny Bond
Page Two
July 27, 1981

If you have any questions concerning this matter please do not hesitate to call me at (606) 283-1885.

Sincerely,

A handwritten signature in cursive script that reads "Tony Otte". The signature is written in dark ink and is positioned above the typed name.

Anthony G. Otte,
Public Administration Specialist

AGO/ak

Attachment

CC: City Attorney
City Clerk



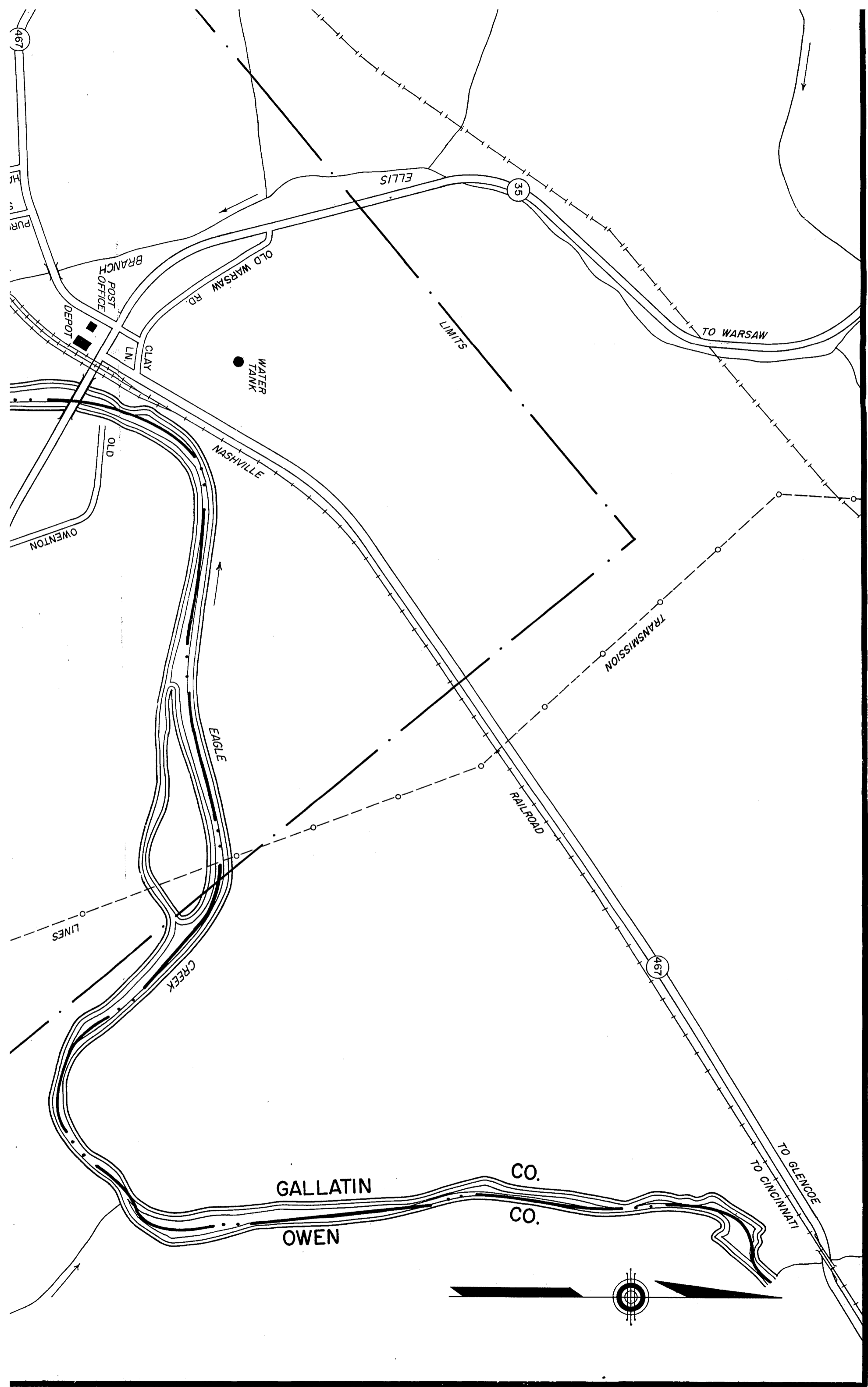



TO SANDERS

TO LOUISVILLE

LOUISVILLE

467

HAWKINS ST.
PURCELL ST.

POST OFFICE
DEPOT

OWENTON RD.

35

OWEN COUNTY
GALLATIN COUNTY

EAGLE CREEK

CORPORATE

TWOMILE OLD

LIMITS

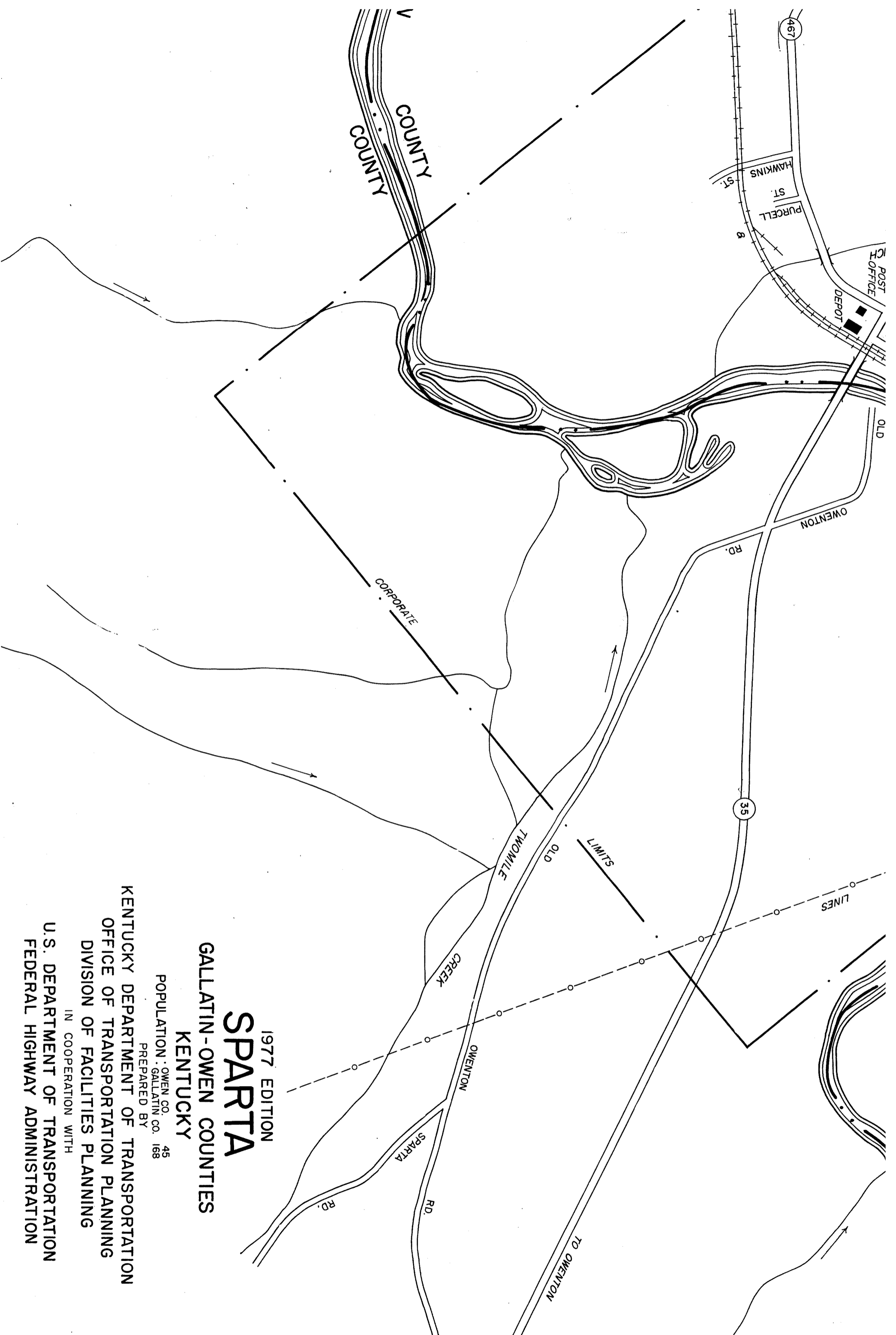

1977 EDITION
SPARTA

GALLATIN-OWEN COUNTIES
 KENTUCKY

POPULATION: OWEN CO. 45
 GALLATIN CO. 168
 PREPARED BY

KENTUCKY DEPARTMENT OF TRANSPORTATION
 OFFICE OF TRANSPORTATION PLANNING
 DIVISION OF FACILITIES PLANNING
 IN COOPERATION WITH
 U.S. DEPARTMENT OF TRANSPORTATION
 FEDERAL HIGHWAY ADMINISTRATION

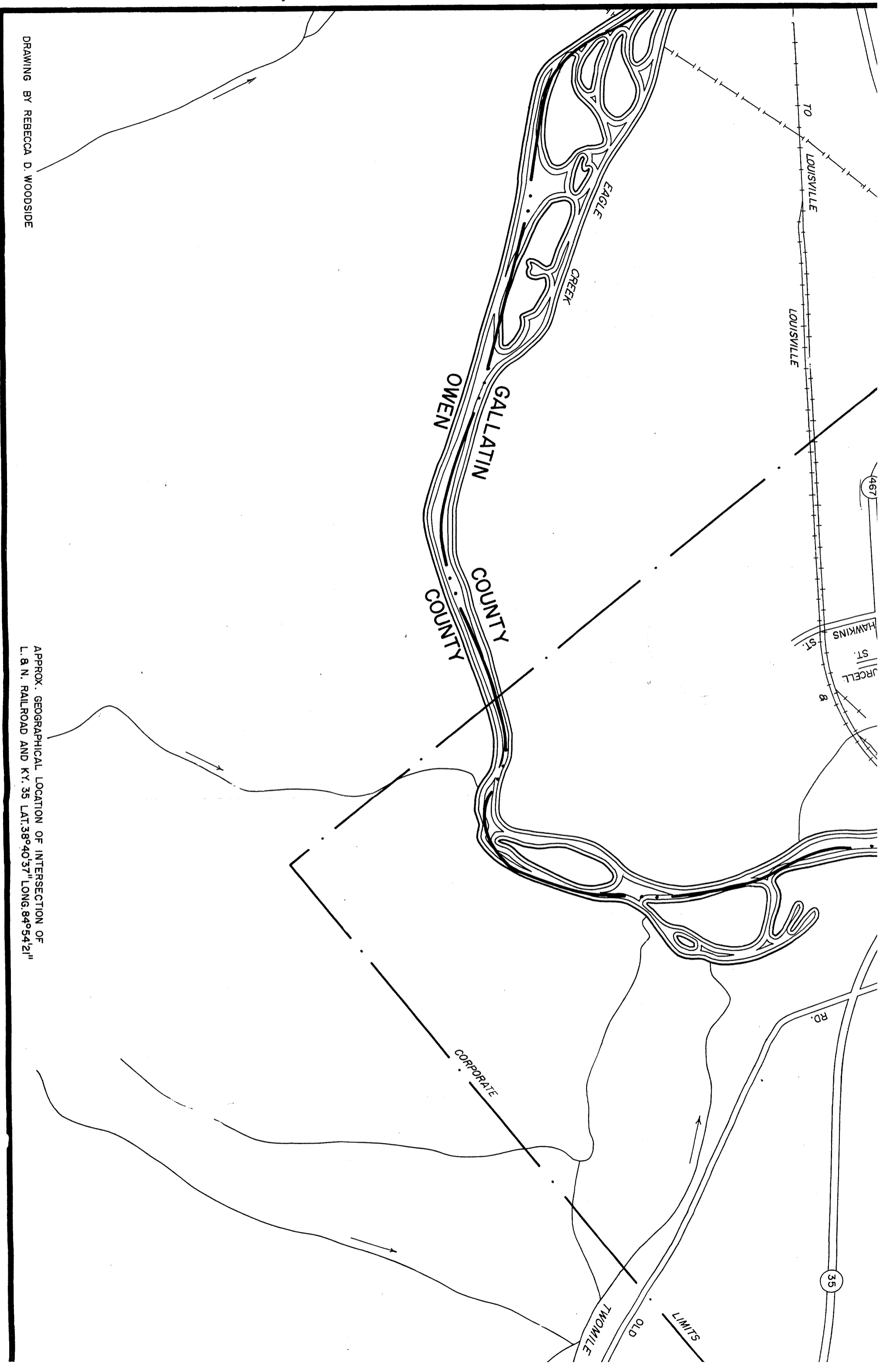

DRAWING BY REBECCA D. WOODSIDE

APPROX. GEOGRAPHICAL LOCATION OF INTERSECTION OF
L. & N. RAILROAD AND KY. 35 LAT. 38°40'37" LONG. 84°54'21"



GALLATIN COUNTY
OWEN COUNTY

HAWKINS ST.
RICE ST.

CORPORATE

TWOMILE

LIMITS

CREEK

OWENTON

SPARTA

TO OWENTON

35

1977 EDITION
SPARTA

GALLATIN-OWEN COUNTIES
KENTUCKY

POPULATION: OWEN CO. 45
GALLATIN CO. 168

PREPARED BY

KENTUCKY DEPARTMENT OF TRANSPORTATION
OFFICE OF TRANSPORTATION PLANNING
DIVISION OF FACILITIES PLANNING
IN COOPERATION WITH
U.S. DEPARTMENT OF TRANSPORTATION
FEDERAL HIGHWAY ADMINISTRATION

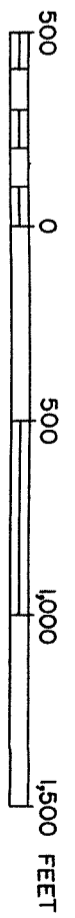

APPROX. GEOGRAPHICAL LOCATION OF INTERSECTION OF
L. & N. RAILROAD AND KY. 35 LAT. 38°40'37" LONG. 84°54'21"

BASE - MAP BY U. S. GEOLOGICAL SURVEY