

**FRANK A. ATKINS, JR.**

ATTORNEY AT LAW  
403 E. SYCAMORE STREET  
P.O. BOX 2190  
WILLIAMSBURG, KY 40769

(606) 539-9064  
FAX (606) 539-9064

June 20, 1996

Kentucky Secretary of State  
P.O. Box 718  
Frankfort, KY 40602-0718

RE: Ordinance and Map of Property  
Annexed by City of Williamsburg, KY

Dear Sir or Madam:

Pursuant to KRS 81A.470 and KRS 81A.475, enclosed is a certified copy of an ordinance adopted by the City of Williamsburg, Kentucky annexing property, together with a map of the annexed area and a metes and bounds description. The name and address of the property owner is Cumberland College, 6180 Station Drive, Williamsburg, Kentucky 40769. At the current time, there are no registered voters residing in the annexed area.

Please file the ordinance and map in your office pursuant to the statutes cited above. Thank you and please call me if you have any questions or need further information.

Very truly yours,



Frank A. Atkins, Jr.  
Williamsburg City Attorney

FAA/sa

Enclosures

map  
R  
JUN 24  
SE  
COM  
JUN 24  
9807  
D

**CITY OF WILLIAMSBURG, KENTUCKY**  
**ORDINANCE NO. 004-96**

**AN ORDINANCE OF THE CITY OF  
WILLIAMSBURG, KENTUCKY  
ANNEXING PROPERTY OF  
CUMBERLAND COLLEGE  
PURSUANT TO KRS 81A.412**

WHEREAS, Cumberland College has requested in writing that the City of Williamsburg annex 2.8 acres of real estate on Hurricane Hollow Road near the National Guard Armory, which now belongs to Cumberland College; and

WHEREAS, Cumberland College has advised the City that this property will be used by the Mountain Outreach Program, Inc., to build single family dwellings under its Hutton Woods Program; and

WHEREAS, Cumberland College has advised the City that these residences will be owned by the occupants, who will be required to pay City and County real estate taxes.

**BE IT ORDAINED BY THE CITY OF WILLIAMSBURG, KENTUCKY,**  
as follows:

Section One: Pursuant to KRS 81A.412, the City of Williamsburg does hereby annex the real property now owned by Cumberland College referred to above and which is more particularly described on the maps and plats attached hereto as Exhibits A, B, and C.

Section Two: Pursuant to the recommendations and findings of fact of the Planning and Zoning Commission of the City of Williamsburg, Kentucky, the City Council of the City of Williamsburg, Kentucky hereby establishes the zoning classification for the annexed property as R-2.

Section Three: The City Clerk shall publish said Ordinance by summary pursuant to KRS Chapter 100 and other applicable law.

Section Four: All articles and sections of ordinances in conflict herewith are hereby repealed.

First Reading: May 13, 1996

Second Reading: June 10, 1996

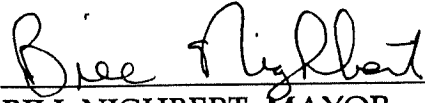
  
\_\_\_\_\_  
BILL NIGHBERT, MAYOR

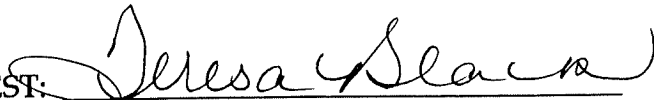
ATTEST:   
\_\_\_\_\_  
TERESA H. BLACK, CITY CLERK

I certified that this is a true copy.

  
\_\_\_\_\_  
Teresa Black, City Clerk

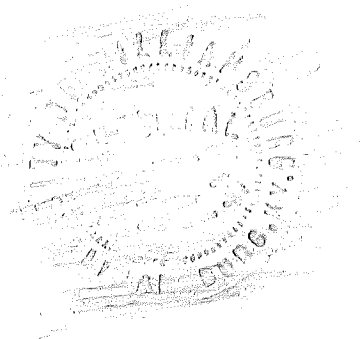





CUMBERLAND COLLEGE TRACT

JOINING ARMOY ON T. 75

DEED BOOK 129 - PAGE 43-46

5-29-1933

SCALE  
1" = 100'

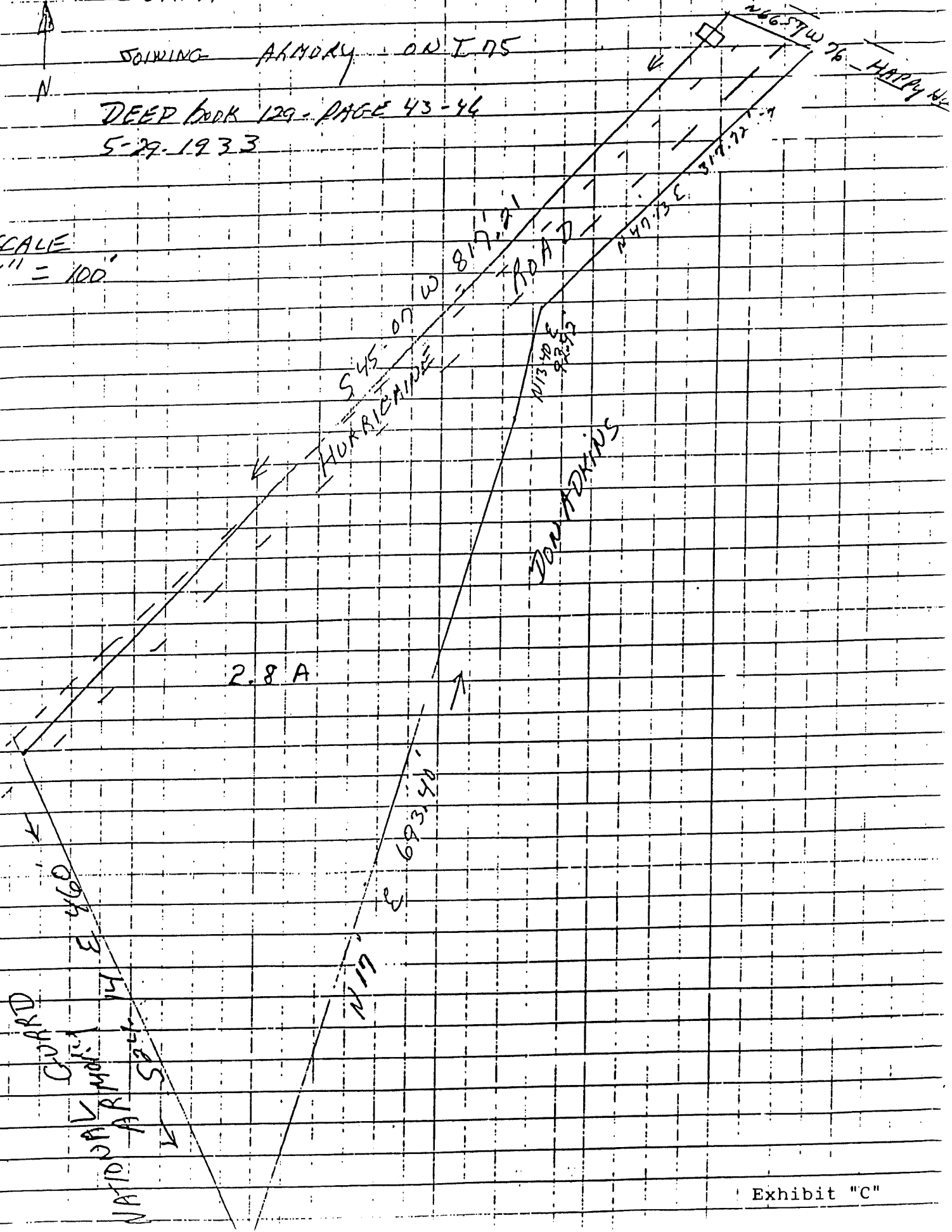

OVERSIZE MAP INCLUDED WITH  
SUBMISSION.

To research the map, contact the  
Office of Secretary of State  
or the County Clerk.